

9

2020-072923

STATE OF INDIANA
LAKE COUNTY
FILED FOR RECORD
MICHAEL B BROWN
RECORDER

2020 Oct 14 8:36 AM

RECORDATION REQUESTED BY:
Providence Bank & Trust
630 East 162nd Street
P.O. Box 706
South Holland, IL 60473

WHEN RECORDED MAIL TO:
Providence Bank & Trust
630 East 162nd Street
P.O. Box 706
South Holland, IL 60473



THIS MODIFICATION OF MORTGAGE dated September 30, 2020, is made and executed between OLTHOF HOMES-LAKE COUNTY LLC, whose address is 8051 WICKER AVE, STE A, SAINT JOHN, IN 46373-9390 (referred to below as "Grantor") and Providence Bank & Trust, whose address is 630 East 162nd Street , P.O. Box 706, South Holland, IL 60473 (referred to below as "Lender").

MORTGAGE. Lender and Grantor have entered into a Mortgage dated July 10, 2020 (the "Mortgage") which has been recorded in Lake County, State of Indiana, as follows:

Recorded July 30, 2020 as Document Number: 2020-048814.

REAL PROPERTY DESCRIPTION. The Mortgage covers the following described real property located in Lake County, State of Indiana:

See the exhibit or other description document which is attached to this Modification and made a part of this Modification as if fully set forth herein.

The Real Property or its address is commonly known as various residential lots more particularly described on Exhibit "B" attached hereto and made a part thereof, IN.

MODIFICATION. Lender and Grantor hereby modify the Mortgage as follows:

THE ORIGINAL MORTGAGE HAS BEEN AMENDED TO DELETE:

FIDELITY NATIONAL
TITLE COMPANY
FW 2003059

25
CK# 1820704772
AM

**MODIFICATION OF MORTGAGE
(Continued)**

Lot 27, commonly known as 3037 Amberleigh Lane, Schererville, Indiana, 46375 and Lot 49 commonly known as 1500 Wysteria Lane, Schererville, Indiana, 46375

THE ORIGINAL MORTGAGE HAS BEEN AMENDED TO ADD:

Amberleigh Estates Phase 2 Lots 11, 14, 15, 21, 22, 23, 24, 55, 56, 57, 58, 59, 60, 61, 62, 67, 68, 69 and 70, more particularly described on Exhibit "B" attached hereto and made a part thereof.

CONTINUING VALIDITY. Except as expressly modified above, the terms of the original Mortgage shall remain unchanged and in full force and effect and are legally valid, binding, and enforceable in accordance with their respective terms. Consent by Lender to this Modification does not waive Lender's right to require strict performance of the Mortgage as changed above nor obligate Lender to make any future modifications. Nothing in this Modification shall constitute a satisfaction of the promissory note or other credit agreement secured by the Mortgage (the "Note"). It is the intention of Lender to retain as liable all parties to the Mortgage and all parties, makers and endorsers to the Note, including accommodation parties, unless a party is expressly released by Lender in writing. Any maker or endorser, including accommodation makers, shall not be released by virtue of this Modification. If any person who signed the original Mortgage does not sign this Modification, then all persons signing below acknowledge that this Modification is given conditionally, based on the representation to Lender that the non-signing person consents to the changes and provisions of this Modification or otherwise will not be released by it. This waiver applies not only to any initial extension or modification, but also to all such subsequent actions.

GRANTOR ACKNOWLEDGES HAVING READ ALL THE PROVISIONS OF THIS MODIFICATION OF MORTGAGE AND GRANTOR AGREES TO ITS TERMS. THIS MODIFICATION OF MORTGAGE IS DATED SEPTEMBER 30, 2020.

GRANTOR:

OLTHOF HOMES-LAKE COUNTY LLC

OD ENTERPRISES, INC., Manager of OLTHOF HOMES-LAKE COUNTY LLC

By: 
TODD MATTHEW OLTHOF, President of OD ENTERPRISES, INC.

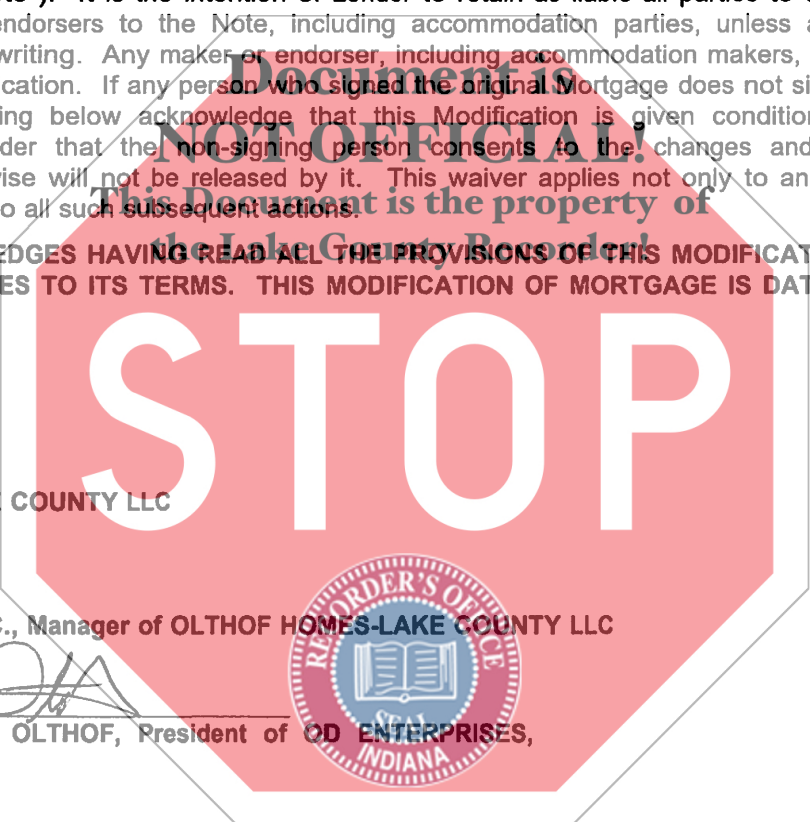

MODIFICATION OF MORTGAGE
(Continued)

LENDER:

PROVIDENCE BANK & TRUST

x [Signature]
Authorized Signer

LIMITED LIABILITY COMPANY ACKNOWLEDGMENT

Document is NOT OFFICIAL!

STATE OF INDIANA

This Document is the property of the Lake County Recorder!

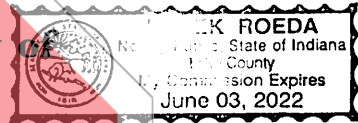

COUNTY OF LAKE

On this 28th day of SEPTEMBER, 20 20, before me, the undersigned Notary Public, personally appeared **TODD MATTHEW OLTHOF, President of OD ENTERPRISES, INC., Manager of OLTHOF HOMES-LAKE COUNTY LLC**, and known to me to be a member or designated agent of the limited liability company that executed the Modification of Mortgage and acknowledged the Modification to be the free and voluntary act and deed of the limited liability company, by authority of statute, its articles of organization or its operating agreement, for the uses and purposes therein mentioned, and on oath stated that he or she is authorized to execute this Modification and in fact executed the Modification on behalf of the limited liability company.

By [Signature] Residing at ST JOHN, LAKE CC, IN

Notary Public in and for the State of IN My commission expires 06/03/2022



MODIFICATION OF MORTGAGE
(Continued)

LENDER ACKNOWLEDGMENT

STATE OF INDIANA
COUNTY OF LAKE

)
) SS
)



Mihaela Babus, Notary Public
Lake County, State of Indiana
My Commission Expires
May 5, 2026

On this 30 day of SEPTEMBER, 20 20, before me, the undersigned Notary Public, personally appeared DEARICK MARS and known to me to be the LENDER, authorized agent for Providence Bank & Trust that executed the within and foregoing instrument and acknowledged said instrument to be the free and voluntary act and deed of Providence Bank & Trust, duly authorized by Providence Bank & Trust through its board of directors or otherwise, for the uses and purposes therein mentioned, and on oath stated that he or she is authorized to execute this said instrument and in fact executed this said instrument on behalf of Providence Bank & Trust.

By Mihaela Babus Mihaela Babus Residing at MUNSTER
Notary Public in and for the State of INDIANA My commission expires 5-5-2026

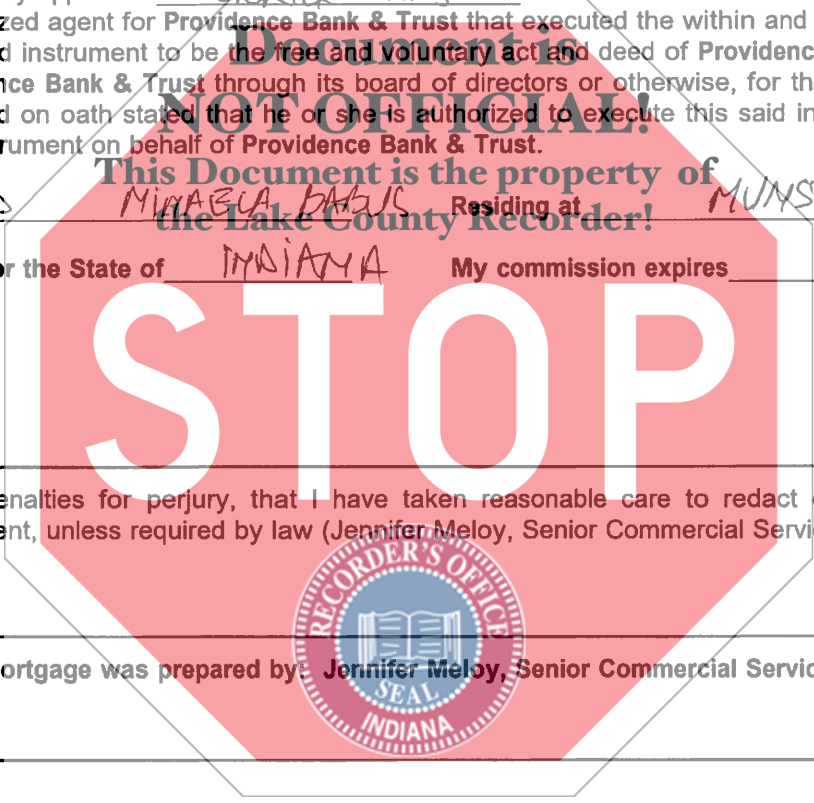

I affirm, under the penalties for perjury, that I have taken reasonable care to redact each Social Security number in this document, unless required by law (Jennifer Meloy, Senior Commercial Services Associate).

This Modification of Mortgage was prepared by: Jennifer Meloy, Senior Commercial Services Associate

CERTIFICATE OF PROOF

WITNESS to the signature(s) on the foregoing instrument to which this Proof is attached:

John Van Proyen

Witness Signature

Witness Name (John Van Proyen)

PROOF:

State of Indiana

County of Lake

Before me, a Notary Public in and for said County and State, on 09/28/2020, personally appeared John Van Proyen, the above named WITNESS to the foregoing instrument, who, being by me duly sworn, did depose and say that he knows Todd M. Olthof, President of OD Enterprises, Inc., Manager of Olthof Homes – Lake County LLC to be the individual described in and who executed the foregoing instrument; that said WITNESS was present and saw said Todd M. Olthof, President of OD Enterprises, Inc., Manager of Olthof Homes – Lake County LLC execute the same; and that said WITNESS at the same time subscribed his name as a witness thereto.

Witness my hand and Notarial Seal this 28th day of September, 2020

Signature: _____

Printed: Derek Roeda

Resident of: Lake County

State of: Indiana

My Commission Expires: 06-03-2022

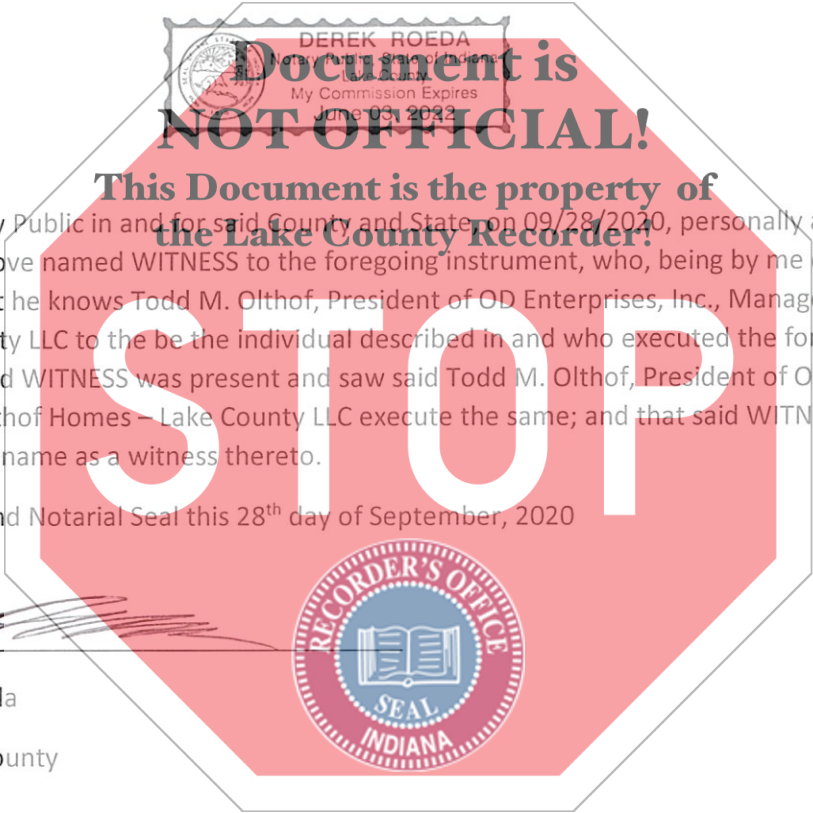

Exhibit "B"

Lot 9 in Amberleigh Estates Phase 1, an Addition to the Town of Schererville, as per plat thereof, recorded in Plat Book 112 page 61, in the Office of the Recorder of Lake County, Indiana.
PIN: 45-11-19-231-003.000-036
Address: 3018 Lavender Lane, Schererville, Indiana 46375

Lot 26 in Amberleigh Estates Phase 1, an Addition to the Town of Schererville, as per plat thereof, recorded in Plat Book 112 page 61, in the Office of the Recorder of Lake County, Indiana.
PIN: 45-11-19-230-010.000-036
Address: 3043 Amberleigh Lane, Schererville, Indiana 46375

Lots 28 in Amberleigh Estates Phase 1, an Addition to the Town of Schererville, as per plat thereof, recorded in Plat Book 112 page 61, in the Office of the Recorder of Lake County, Indiana.
PIN: 45-11-19-230-008.000-036
Address: 3031 Amberleigh Lane, Schererville, Indiana 46375

Lot 31 in Amberleigh Estates Phase 1, an Addition to the Town of Schererville, as per plat thereof, recorded in Plat Book 112 page 61, in the Office of the Recorder of Lake County, Indiana.
PIN: 45-11-19-230-004.000-036
Address: 2925 Amberleigh Lane, Schererville, Indiana 46375

Lot 32 in Amberleigh Estates Phase 1, an Addition to the Town of Schererville, as per plat thereof, recorded in Plat Book 112 page 61, in the Office of the Recorder of Lake County, Indiana.
PIN: 45-11-19-230-003.000-036
Address: 2917 Amberleigh Lane, Schererville, Indiana 46375

Lot 33 in Amberleigh Estates Phase 1, an Addition to the Town of Schererville, as per plat thereof, recorded in Plat Book 112 page 61, in the Office of the Recorder of Lake County, Indiana.
PIN: 45-11-19-230-002.000-036
Address: 2911 Amberleigh Lane, Schererville, Indiana 46375

Lot 34 in Amberleigh Estates Phase 1, an Addition to the Town of Schererville, as per plat thereof, recorded in Plat Book 112 page 61, in the Office of the Recorder of Lake County, Indiana.
PIN: 45-11-19-230-001.000-036
Address: 2905 Amberleigh Lane, Schererville, Indiana 46375

Lot 35 in Amberleigh Estates Phase 1, an Addition to the Town of Schererville, as per plat thereof, recorded in Plat Book 112 page 61, in the Office of the Recorder of Lake County, Indiana.
PIN: 45-11-19-228-001.000-036
Address: 2905 Lavender Lane, Schererville, Indiana 46375

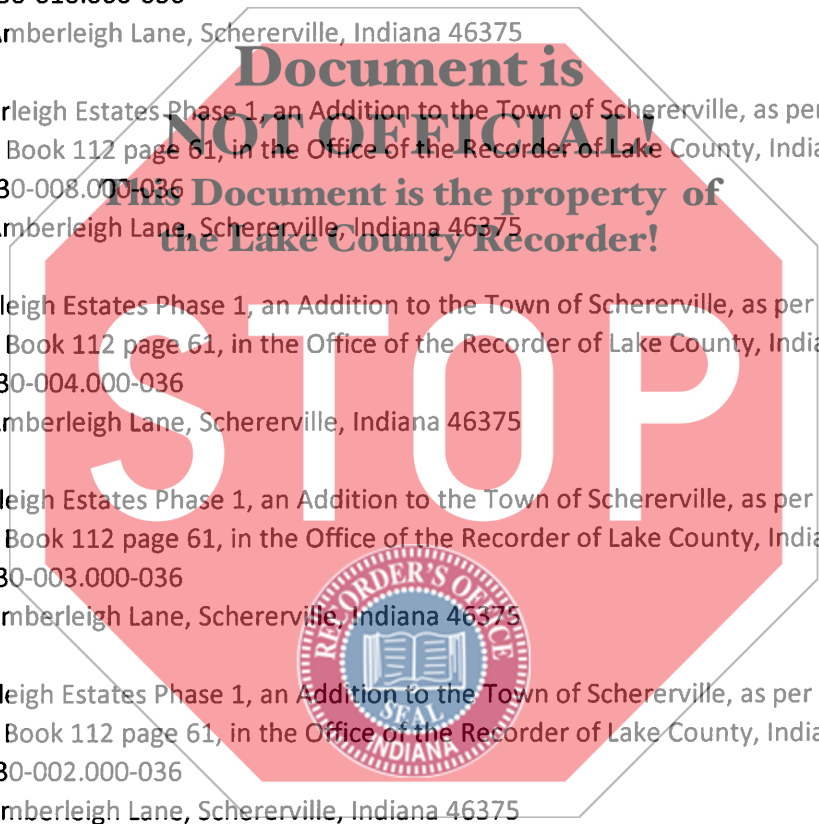

Lot 39 in Amberleigh Estates Phase 1, an Addition to the Town of Schererville, as per plat thereof, recorded in Plat Book 112 page 61, in the Office of the Recorder of Lake County, Indiana.

PIN: 45-11-19-228-005.000-036

Address: 2929 Lavender Lane, Schererville, Indiana 46375

Lot 44 in Amberleigh Estates Phase 1, an Addition to the Town of Schererville, as per plat thereof, recorded in Plat Book 112 page 61, in the Office of the Recorder of Lake County, Indiana.

PIN: 45-11-19-232-006.000-036

Address: 1540 Wysteria Lane, Schererville, Indiana 46375

Lot 11 in Amberleigh Estates Phase 2, an Addition to the Town of Schererville, Lake County, Indiana, as per plat thereof, recorded in Plat Book 113 Page 37, in the Office of the Recorder of Lake County, Indiana.

PIN: 45-11-19-231-006.000-036

Address: 3112 Rosemary Lane, Schererville, IN 46375

Lot 14 in Amberleigh Estates Phase 2, an Addition to the Town of Schererville, Lake County, Indiana, as per plat thereof, recorded in Plat Book 113 Page 37, in the Office of the Recorder of Lake County, Indiana.

PIN: 45-11-19-231-009.000-036

Address: 3130 Rosemary Lane, Schererville, IN 46375

Lot 15 in Amberleigh Estates Phase 2, an Addition to the Town of Schererville, Lake County, Indiana, as per plat thereof, recorded in Plat Book 113 Page 37, in the Office of the Recorder of Lake County, Indiana.

PIN: 45-11-19-231-010.000-036

Address: 3136 Rosemary Lane, Schererville, IN 46375

Lot 21 in Amberleigh Estates Phase 2, an Addition to the Town of Schererville, Lake County, Indiana, as per plat thereof, recorded in Plat Book 113 Page 37, in the Office of the Recorder of Lake County, Indiana.

PIN: 45-11-19-230-015.000-036

Address: 3133 Amberleigh Lane, Schererville, IN 46375

Lot 22 in Amberleigh Estates Phase 2, an Addition to the Town of Schererville, Lake County, Indiana, as per plat thereof, recorded in Plat Book 113 Page 37, in the Office of the Recorder of Lake County, Indiana.

PIN: 45-11-19-230-014.000-036

Address: 3127 Amberleigh Lane, Schererville, IN 46375

Lot 23 in Amberleigh Estates Phase 2, an Addition to the Town of Schererville, Lake County, Indiana, as per plat thereof, recorded in Plat Book 113 Page 37, in the Office of the Recorder of Lake County, Indiana.

PIN: 45-11-19-230-013.000-036

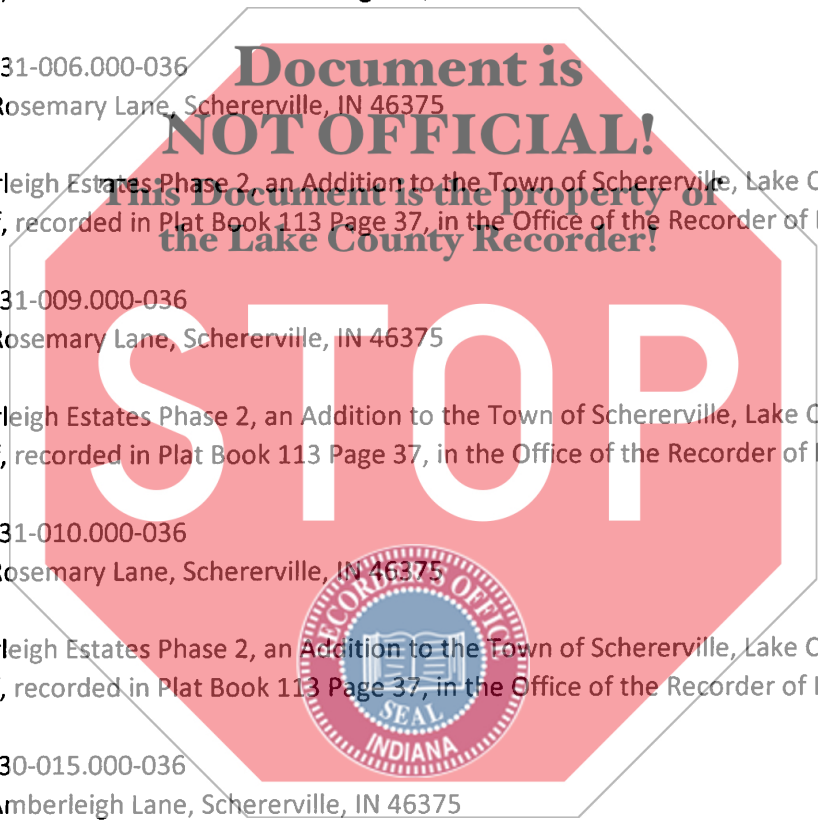

Address: 3121 Amberleigh Lane, Schererville, IN 46375

Lot 24 in Amberleigh Estates Phase 2, an Addition to the Town of Schererville, Lake County, Indiana, as per plat thereof, recorded in Plat Book 113 Page 37, in the Office of the Recorder of Lake County, Indiana.

PIN: 45-11-19-230-012.000-036

Address: 3115 Amberleigh Lane, Schererville, IN 46375

Lot 55 in Amberleigh Estates Phase 2, an Addition to the Town of Schererville, Lake County, Indiana, as per plat thereof, recorded in Plat Book 113 Page 37, in the Office of the Recorder of Lake County, Indiana.

PIN: 45-11-19-233-006.000-036

Address: 1545 Jasmine Drive, Schererville, IN 46375

Lot 56 in Amberleigh Estates Phase 2, an Addition to the Town of Schererville, Lake County, Indiana, as per plat thereof, recorded in Plat Book 113 Page 37, in the Office of the Recorder of Lake County, Indiana.

PIN: 45-11-19-234-001.000-036

Address: 1540 Jasmine Drive, Schererville, IN 46375

Lot 57 in Amberleigh Estates Phase 2, an Addition to the Town of Schererville, Lake County, Indiana, as per plat thereof, recorded in Plat Book 113 Page 37, in the Office of the Recorder of Lake County, Indiana.

PIN: 45-11-19-234-002.000-036

Address: 1532 Jasmine Drive, Schererville, IN 46375

Lot 58 in Amberleigh Estates Phase 2, an Addition to the Town of Schererville, Lake County, Indiana, as per plat thereof, recorded in Plat Book 113 Page 37, in the Office of the Recorder of Lake County, Indiana.

PIN: 45-11-19-234-003.000-036

Address: 1524 Jasmine Drive, Schererville, IN 46375

Lot 59 in Amberleigh Estates Phase 2, an Addition to the Town of Schererville, Lake County, Indiana, as per plat thereof, recorded in Plat Book 113 Page 37, in the Office of the Recorder of Lake County, Indiana.

PIN: 45-11-19-234-004.000-036

Address: 1516 Jasmine Drive, Schererville, IN 46375

Lot 60 in Amberleigh Estates Phase 2, an Addition to the Town of Schererville, Lake County, Indiana, as per plat thereof, recorded in Plat Book 113 Page 37, in the Office of the Recorder of Lake County, Indiana.

PIN: 45-11-19-234-005.000-036

Address: 1508 Jasmine Drive, Schererville, IN 46375

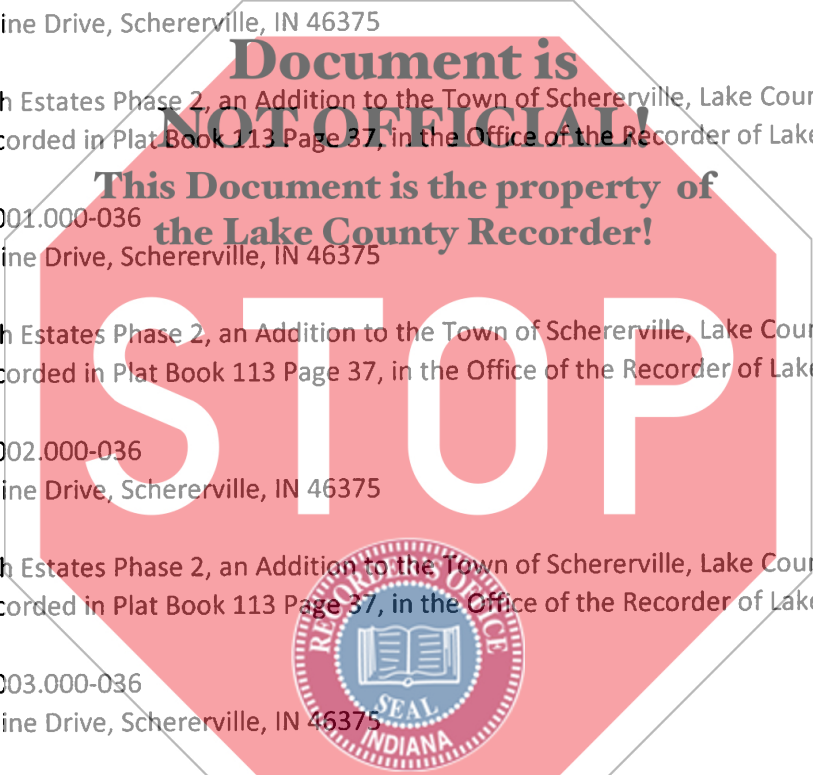

Lot 61 in Amberleigh Estates Phase 2, an Addition to the Town of Schererville, Lake County, Indiana, as per plat thereof, recorded in Plat Book 113 Page 37, in the Office of the Recorder of Lake County, Indiana.

PIN: 45-11-19-234-006.000-036

Address: 1500 Jasmine Drive, Schererville, IN 46375

Lot 62 in Amberleigh Estates Phase 2, an Addition to the Town of Schererville, Lake County, Indiana, as per plat thereof, recorded in Plat Book 113 Page 37, in the Office of the Recorder of Lake County, Indiana.

PIN: 45-11-19-234-007.000-036

Address: 3117 Rosemary Lane, Schererville, IN 46375

Lot 67 in Amberleigh Estates Phase 2, an Addition to the Town of Schererville, Lake County, Indiana, as per plat thereof, recorded in Plat Book 113 Page 37, in the Office of the Recorder of Lake County, Indiana.

PIN: 45-11-19-234-015.000-036

Address: 1532 Amberleigh Court, Schererville, IN 46375

Lot 68 in Amberleigh Estates Phase 2, an Addition to the Town of Schererville, Lake County, Indiana, as per plat thereof, recorded in Plat Book 113 Page 37, in the Office of the Recorder of Lake County, Indiana.

PIN: 45-11-19-234-014.000-036

Address: 1524 Amberleigh Court, Schererville, IN 46375

Lot 69 in Amberleigh Estates Phase 2, an Addition to the Town of Schererville, Lake County, Indiana, as per plat thereof, recorded in Plat Book 113 Page 37, in the Office of the Recorder of Lake County, Indiana.

PIN: 45-11-19-234-013.000-036

Address: 1525 Amberleigh Court, Schererville, IN 46375

Lot 70 in Amberleigh Estates Phase 2, an Addition to the Town of Schererville, Lake County, Indiana, as per plat thereof, recorded in Plat Book 113 Page 37, in the Office of the Recorder of Lake County, Indiana.

PIN: 45-11-19-234-012.000-036

Address: 1533 Amberleigh Court, Schererville, IN 46375

