

2

**2019-080765**

STATE OF INDIANA  
LAKE COUNTY  
FILED FOR RECORD  
MICHAEL B BROWN  
RECORDER

2019 Nov 22 8:36 AM

MAIL TAX BILLS TO:  
William A. Walters  
6946 Tompkins Ct.  
Scherverville, Indiana 46375

PARCEL NUMBER:  
45-11-13-127-003.000-036

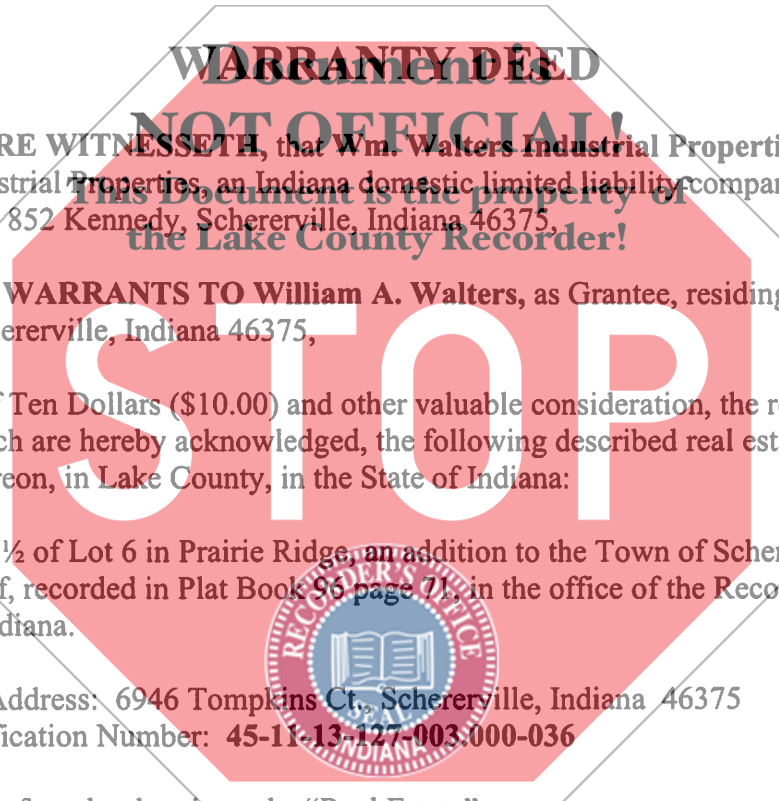

**THIS INDENTURE WITNESSETH**, that Wm. Walters Industrial Properties, LLC, a/k/a Wm. Walters Industrial Properties, an Indiana domestic limited liability company, the Grantor, having an office at 852 Kennedy, Scherverville, Indiana 46375,

**CONVEYS AND WARRANTS TO** William A. Walters, as Grantee, residing at 6946 Tompkins Ct., Scherverville, Indiana 46375,

in consideration of Ten Dollars (\$10.00) and other valuable consideration, the receipt and sufficiency of which are hereby acknowledged, the following described real estate, and all improvements thereon, in Lake County, in the State of Indiana:

The North 1/2 of Lot 6 in Prairie Ridge, an addition to the Town of Scherverville, as per plat thereof, recorded in Plat Book 96 page 71, in the office of the Recorder of Lake County, Indiana.

Common Address: 6946 Tompkins Ct., Scherverville, Indiana 46375  
Tax Identification Number: 45-11-13-127-003.000-036

Said real estate is referred to herein as the "Real Estate".

**SUBJECT TO:**

- (a) Real estate taxes for the Real Estate for 2018 payable 2019 and all subsequent years and liens arising therefrom for the Real Estate;
- (b) All covenants, conditions, easements, and restrictions of record that affect the Real Estate;
- (c) Zoning regulations, local ordinances, and other laws affecting the Real Estate; and
- (e) Any matters attributable to the acts or omissions of the Grantee, including, but not limited to, any services performed and any materials and/or equipment provided by Grantee and/or its contractors for the Real Estate.

DULY ENTERED FOR TAXATION SUBJECT  
FINAL ACCEPTANCE FOR TRANSFER

NO SALES DISCLOSURE NEEDED

NOV 22 2019

044081

JOHN E. PETALAS  
LAKE COUNTY AUDITOR

Approved Assessor's Office

By: \_\_\_\_\_

25  
CS  
RM

