

2

STATE OF INDIANA  
LAKE COUNTY  
FILED FOR RECORD

2019 037192

2019 JUN 20 AM 10: 07

MICHAEL B. BROWN  
RECORDER

**Satisfaction of Mortgage**

**Return To:**

PHOENIX CARE SYSTEMS INC  
AND WILLOWGLEN ACADEMY WISCONSIN INC  
AND WILLOWGLEN ACADEMY ILLINOIS INC  
AND WILLOWGLEN ACADEMY INDIANA INC  
1744 N FARWELL AVE  
MILWAUKEE WI 53202-1806

P.I.N. # 45-08-10-359-031.000-004 & 45-08-34-301-009.000-004

The undersigned Bank certifies that the following is fully paid and satisfied:

Document executed by WILLOWGLEN ACADEMY - INDIANA INC to bank dated 12/27/2012, and recorded in the office of the Register of Deeds of LAKE County, INDIANA, as Document Number 2013005022, in (Volume) N/A (Page) N/A.

LEGAL DESCRIPTION:  
SEE ATTACHED

STATE OF WISCONSIN  
BROWN COUNTY

On June 11, 2019, the foregoing instrument was acknowledged before me by the above named authorized agent.

THIS INSTRUMENT WAS DRAFTED BY

MERCEDES PETERSEN  
Associated Loan Services Department  
PO Box 19097  
Green Bay, WI 54307-9097  
**Account No. CIF 2999163 #87867120003**



Associated Bank, N.A.  
*Mary T Wessel*  
BY:  
Mary T Wessel, Supervisor

*Kimberly S. Andres* (SEAL)

Kimberly S. Andres  
Notary Public, State Of WISCONSIN  
My Commission Expires 05/15/21

[Corporate Seal Not Required. Sec. 706.03(2),  
Wis. Stats.]

I affirm under penalties of perjury, that I have taken reasonable care to redact each social security number in this document, unless required by law.

\$ 2500  
# 2006552317  
AB

## Must Be Attached To Mortgage Satisfaction

Lots 8 to 15, both inclusive, Block 1 in Broadhurst Subdivision, in the City of Gary, as per plat thereof, recorded in Plat Book 19 page 13, in the Office of the Recorder of Lake County, Indiana.

Address: 4955 Broadway, Gary, Indiana 46409

Tax Key Numbers:

41-0108-0008

41-108-8

41-108-9

41-108-10

41-108-39

### PARCEL 2

Parcel 1: Lots 1, 3 and 4 in Block 1 in John Gunzenhauser's First Subdivision, in the City of Gary, as per plat thereof, recorded in Plat Book 14, page 23-1/2, in the Office of the Recorder of Lake County, Indiana.

Parcel 2: Lot 1 and Lots 4 to 17, both inclusive, in Block 4 in John Gunzenhauser's Second Subdivision, in the City of Gary, as per plat thereof, recorded in Plat Book 17, page 4, in the Office of the Recorder of Lake County, Indiana.

Parcel 3: Lots 1 to 7, both inclusive, in Block 5 in John Gunzenhauser's Second Subdivision, in the City of Gary, as per plat thereof, recorded in Plat Book 17, page 4, in the Office of the Recorder of Lake County, Indiana.

Tax Key No. 45-08-10-359-031.000-004

Address: 2041 Delaware Street, Gary, IN 46407, 2033 Delaware Street, Gary, IN 46407, 2029 Delaware Street, Gary, IN 46407, 2049 Delaware Street, Gary, IN 46407, 2063 Delaware Street, Gary, IN 46407, 2065 Delaware Street, Gary, IN 46407, 300-02 East 21<sup>st</sup> Avenue, Gary, IN 46407, 304-06 East 21<sup>st</sup> Avenue, Gary, IN 46407, 308-10 East 21<sup>st</sup> Avenue, Gary, IN 46407, 312-14 East 21<sup>st</sup> Avenue, Gary, IN 46407, 316-18 East 21<sup>st</sup> Avenue, Gary, IN 46407, 320-22 East 21<sup>st</sup> Avenue, Gary, IN 46407, 324-26 East 21<sup>st</sup> Avenue, Gary, IN 46407, 2064 Delaware Street, Gary, IN 46407, 2052-56 Delaware Street, Gary, IN 46407, 2048 Delaware Street, Gary, IN 4607, 2045 Delaware Street, Gary, IN 46407, 2049-51 Delaware Street, Gary, IN 46407, 2053 Delaware Street, Gary, IN 46407, 2057 Delaware Street, Gary, IN 46407, 2061 Delaware Street, Gary, IN 46407, 400 East 21<sup>st</sup> Avenue, Gary, IN 46407

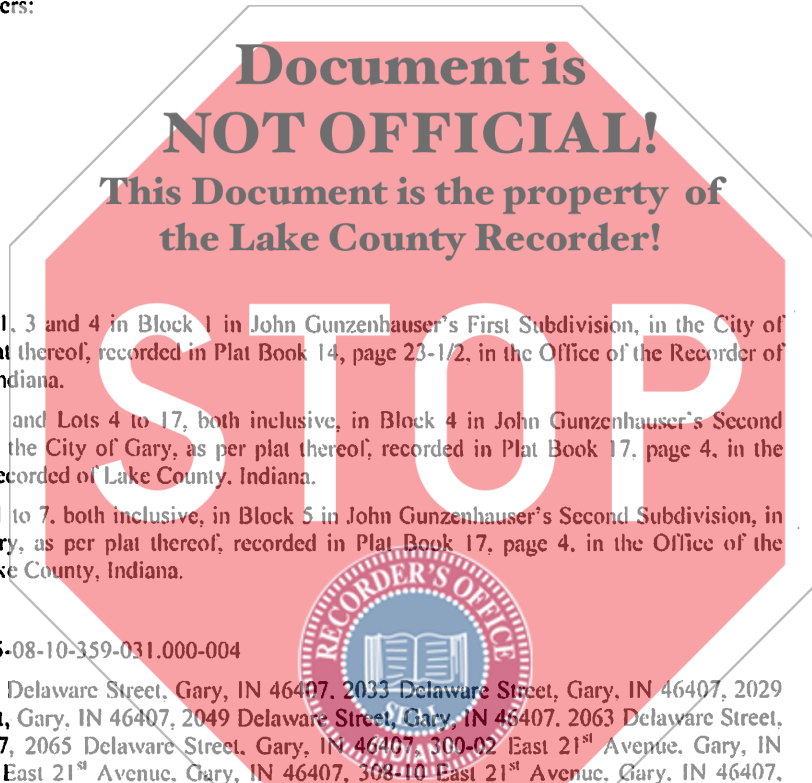

PROPERTY ADDRESS: 4955 BROADWAY & 300-324 E 21<sup>ST</sup> ST, GARY, INDIANA, 46409  
TAX ID #: 39 - 1966717