

2

MAIL TAX BILLS TO: Debra Dowden, 665 N. 700 W., Hobart, IN 46342

QUITCLAIM DEED

THIS INDENTURE WITNESSETH, that Kerri Rosenfeld, individually ("Grantor") of LAKE County in the State of INDIANA QUITCLAIM(S) to Debra Dowden, individually of LAKE County in the State of INDIANA in consideration Of One Dollar (\$1.00) and other valuable consideration, the receipt and sufficiency of which are hereby acknowledged, the following described real estate in LAKE County, in the State of Indiana:

Lots Numbered Sixteen (16) and Seventeen (17) in Block Number Six (6), as marked and laid down on the recorded Plat of Forest Park Addition, Gary, in Lake County, Indiana, as the same appears of record in Plat Book 20, Page 46, in the Recorder's Office of Lake County, Indiana.

Subject to all easements and restrictions of record.

Tax I.D. 45-08-28-303-011-000-004

Commonly known as 4161 Johnson Street, Gary, IN 46408

Dated this 22d day of March, 2019

Kerri Rosenfeld
Kerri Rosenfeld
(Print of Type)

STATE OF INDIANA)
COUNTY OF LAKE)

SS:

Before me, the undersigned, a Notary Public in and for said County and State, this 3/22, 2019, personally appeared: Kerri Rosenfeld and acknowledged the execution of the foregoing deed. In witness whereof, I have hereunto subscribed my name and affixed my official seal.

My commission Expires: 2-25-23

Signature [Signature]

Resident of Lake County

Printed Kevin W. Marshall, Notary Public

This instrument prepared by Kevin W. Marshall Attorney at Law Attorney I.D. No. 11624-71

I AFFIRM, UNDER THE PENALTIES FOR PERJURY THAT I HAVE TAKEN REASONABLE CARE TO REDACT EACH SOCIAL SECURITY NUMBER IN THIS DOCUMENT, UNLESS REQUIRED BY LAW.

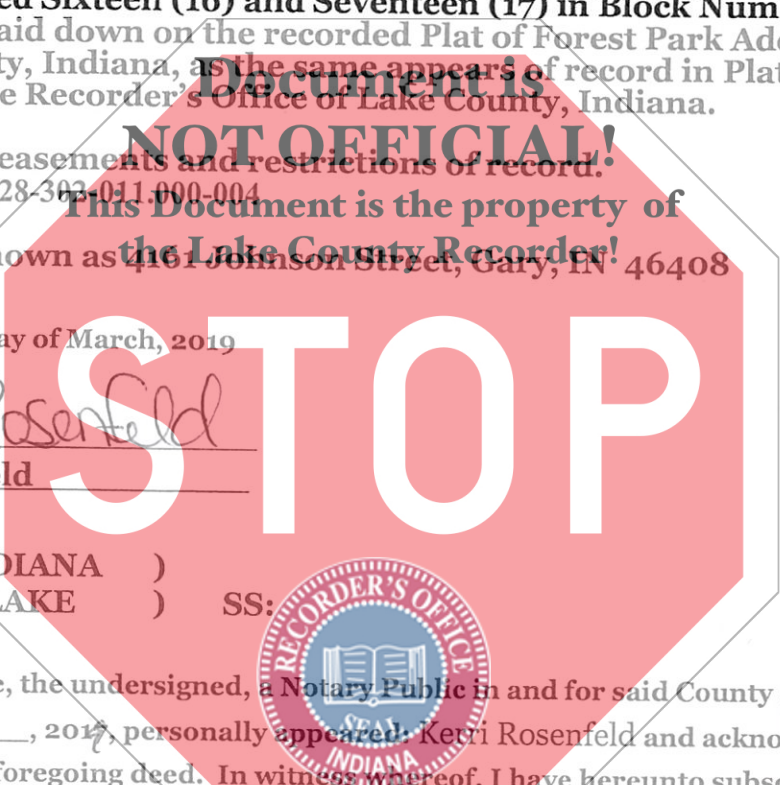
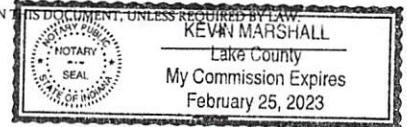

2019 018604

2019 MAR 28 PM 12:22
MICHAEL S. BROWN
RECORDER
STATE OF INDIANA
LAKE COUNTY
FILED FOR RECORD

NO SALES DISCLOSURE NEEDED

DULY ENTERED FOR TAXATION SUBJECT
FINAL ACCEPTANCE FOR TRANSFER

Approved Assessor's Office

MAR 28 2019

050709

By: [Signature]

JOHN E. PETALAS
LAKE COUNTY AUDITOR

\$ 2500

CC JTB



N
This I
th

S

