

STATE OF INDIANA
LAKE COUNTY
FILED FOR RECORD

2017 087463

2017 DEC 27 AM 9:58

MICHAEL B. BROWN
RECORDER

Mail tax bills to:

Parcel No. 45-02-36-429-002.000-023

612 Sibley St.
Hammond In.
46320

WARRANTY DEED

THIS INDENTURE WITNESSETH, That JESSICA SANCHEZ, ("Grantors")
of LAKE County in the State of Indiana

CONVEY (S) AND WARRANT (S) TO CESAR A. VASQUEZ, ("Grantee")
of LAKE County in the State of Indiana

in consideration of One Dollar and other valuable consideration, the receipt and
sufficiency of which are hereby acknowledged, the following described real estate in
LAKE County, in the State of Indiana:

THE EAST 37 1/2 FEET OF LOT 2 IN BLOCK 3 IN LOUISE HOHMAN'S ADDITION
TO THE CITY OF HAMMOND, AS PER PLAT THEREOF, RECORDED IN PLAT
BOOK 1, PAGE 56, IN THE OFFICE OF THE RECORDER OF LAKE COUNTY,
INDIANA.

Commonly known as: 612 SIBLEY ST, HAMMOND, IN, 46320
Grantee's address:

Subject to: Taxes for 2016 and subsequent years, building lines, covenants and
restrictions.

Dated this 22nd day of December, 2017

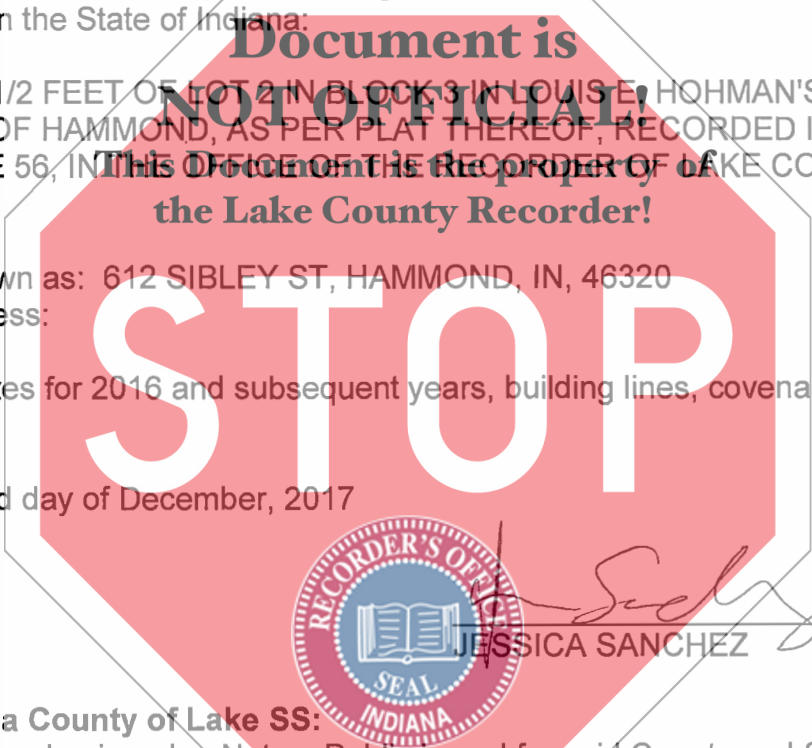

NORTHWEST INDIANA TITLE
162 WASHINGTON STREET
LOWELL, IN 46356
219-696-0100

State of Indiana County of Lake SS:

Before me, the undersigned, a Notary Public in and for said County and State, this 22nd
day of December, 2017, personally appeared: JESSICA SANCHEZ, and acknowledged
the execution of the foregoing deed. In witness whereof, I have hereunto subscribed
my name and affixed my official seal.

RICHARD A. ZUNICA
NOTARY PUBLIC
SEAL
Porter County, State of Indiana
My Commission Expires August 31, 2022

, Notary Public

My commission expires:
County of residence:

I affirm under the penalties for perjury that I have taken reasonable care to redact each social security
number in this document unless required by law. RICHARD A. ZUNICA

This instrument prepared by: Attorney Richard A. Zunica, 162 Washington St., Lowell, In 46356
File No. 17-22743 REV 4/

DULY ENTERED FOR TAXATION SUBJECT
FINAL ACCEPTANCE FOR TRANSFER

DEC 26 2017

JOHN E. PETALAS
LAKE COUNTY AUDITOR

029903

AMOUNT \$ 25.
CASH _____ CHARGE _____
CHECK # 4170
OVERAGE _____
COPY _____
NON - COM _____
CLERK FD