

Warranty Deed

2017 086675

THIS INDENTURE WITNESSETH, That
Betty LLC
of Lake County, in the State of Indiana Convey(s) and Warrant(s)
to
Keith F. Grill and Jennifer L. Grill,
husband and wife

STATE OF INDIANA
LAKE COUNTY
FILED FOR RECORD
2017 DEC 21 10:14
MICHAEL B. BROWN
RECORDER

of Lake County, in the State of Indiana for and in consideration of the sum of
Ten dollars (\$10.00) and other valuable consideration, the receipt whereof is hereby
acknowledged, the following described Real Estate in Lake County,
In the State of Indiana, to-wit:

Lot 210 in Ellendale Farm Unit 15, as per plat thereof recorded in Plat Book 109, page 66, in the
Office of the Recorder of Lake County, Indiana.

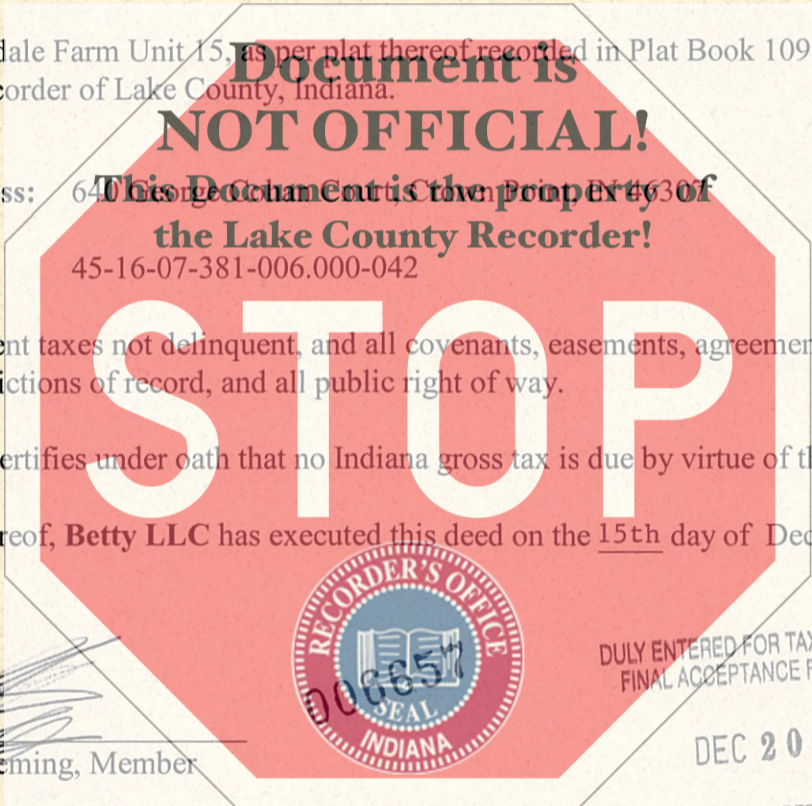

Property Address: 6400 Long Creek Court, Crown Point, IN 46307

Tax ID No.: 45-16-07-381-006.000-042

Subject to: current taxes not delinquent, and all covenants, easements, agreements and
restrictions of record, and all public right of way.

Grantor hereby certifies under oath that no Indiana gross tax is due by virtue of this deed.

In Witness, Whereof, Betty LLC has executed this deed on the 15th day of December, 2017.

Betty LLC

[Signature]
By Thomas J. Fleming, Member

DULY ENTERED FOR TAXATION SUBJECT
FINAL ACCEPTANCE FOR TRANSFER

DEC 20 2017

STATE OF INDIANA, Lake COUNTY, as **JOHN E. PETALAS**
LAKE COUNTY AUDITOR

Before me, a Notary Public in and for said County and State, personally appeared Thomas J.
Fleming, Member of Betty LLC who acknowledged the execution of the forgoing deed.

Witness my hand and official seal on the 15 day of December, 2017.



[Signature]
Notary Public Renee J. Wells
Resident of Lake County
My Commission Expires: 7-8-25

This instrument prepared by: Under the direction of Thomas J. Fleming.

I AFFIRM, UNDER THE PENALTIES FOR PERJURY, THAT I HAVE TAKEN REASONABLE CARE TO REDACT EACH
SOCIAL SECURITY NUMBER IN THIS DOCUMENT, UNLESS REQUIRED NBY LAW.
Thomas J. Fleming

Mail tax bill to: 11798 Clark Ct, Crown Point,
Return deed to: In 46307

FIDELITY NATIONAL ✓
TITLE COMPANY
FNO 1702493 LC

25-
FW
AN

(GRANTEE MAILING ADDRESS)