

STATE OF INDIANA
LAKE COUNTY
FILED FOR RECORD

2017 043893

2017 JUL 18 PM 2:05

MICHAEL B. BROWN
RECORDER

CERTIFICATE OF ASSUMED BUSINESS NAME

For persons (sole proprietorships, associations, or general partnerships)
Engaged in business under a name other than their own (DBA)

Document is NOT OFFICIAL!

STATE OF INDIANA, COUNTY of Lake
the Lake County Recorder!

NAME OF BUSINESS J & A Landscaping services

NATURE OF BUSINESS Landscaping

ADDRESS OF BUSINESS 3116 Cleveland st Hammond IN 46323

PRINTED NAMES AND RESIDENCES OF MEMBER OF BUSINESS:

Alexis Ayala at 3116 Cleveland st Hammond IN 46323

Jesus Barajas Macias at 2515 Tennessee Hammond IN 46323

at

at

FORM PREPARED BY: Alexis Ayala

Alexis Ayala Printed Name Capacity owner

Member's Signature

Printed Name

Capacity

Filed on July 18, 2017. Michael B. Brown, Recorder

25-
CS
an



OFFICE OF THE LAKE COUNTY RECORDER

LAKE COUNTY GOVERNMENT CENTER
2293 NORTH MAIN STREET
CROWN POINT, INDIANA 46307

MICHAEL B. BROWN
Recorder

PHONE (219) 755-3730
FAX (219) 755-3257

Verification of Assumed Business Name

Name of Business J & A Landscaping Services

Computer Check /Date 7-18-17

Card File Check /Date 7-18-17
This Document is the property of
the Lake County Recorder!

Name being used: No Yes

Similar Name being used: Yes No

Name of Business J & A Landscaping

Document # for Amendment

Reason for Change

Employee Signature J. Miller

Customer Signature Alexis Ayala

Customer Printed Name Alexis Ayala

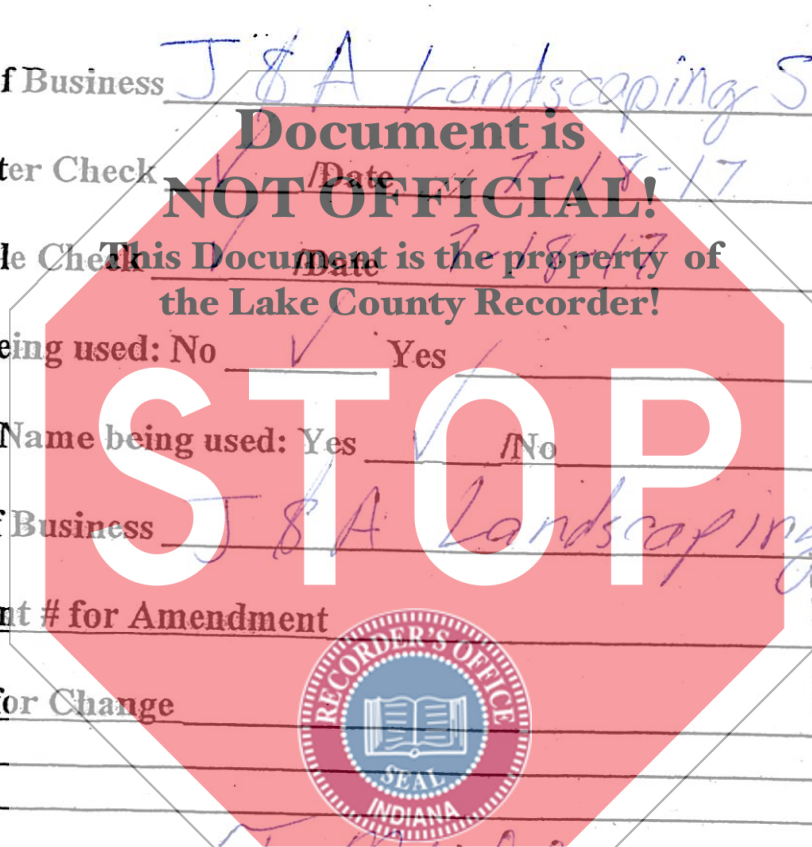

2017 043893

STATE OF INDIANA
LAKE COUNTY
FILED FOR RECORD
MICHAEL B. BROWN
RECORDER
2017 JUL 18 PM 2:05

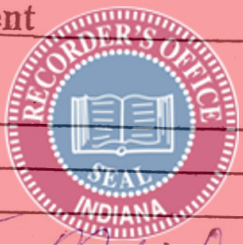

Customer performed their own search and results are entirely up to the individual. Our office is here to assist the customer.

Please note that our office does not certify the accuracy of this document and do not consent to the reliance by any party on this or any information provided by the Lake County Recorder. You may also contact the Secretary of State Office in Indianapolis for further clarification.