

2

STATE OF INDIANA
LAKE COUNTY
FILED FOR RECORD

2017 020561

2017 MAR 31 AM 10:11

MICHAEL B. BROWN
RECORDER

WARRANTY DEED

THIS INDENTURE WITNESSETH, That Larry Legler, as to an undivided 1/2 interest (Grantor) **CONVEY(S) AND WARRANT(S)** to Timothy Scoleri (Grantee) for the sum of Ten Dollars (\$10.00) and other valuable consideration, the receipt and sufficiency of which are hereby acknowledged, the following described real estate in Lake County, State of Indiana:

Lot 420 in Southtown Estates Ninth Addition to the Town of Highland, as per plat thereof, recorded in Plat Book 34, page 5, in the Office of the Recorder of Lake County, Indiana.

Property Address: 3443 43rd Street, Highland, IN 46322
Tax ID No.: 45-07-27-329-032-000-026

Subject to current taxes not delinquent, and all easements, agreements and restrictions of record and all public rights of way.

IN WITNESS WHEREOF, Grantor has executed this deed on the 23 day of March, 2017.

Larry Legler

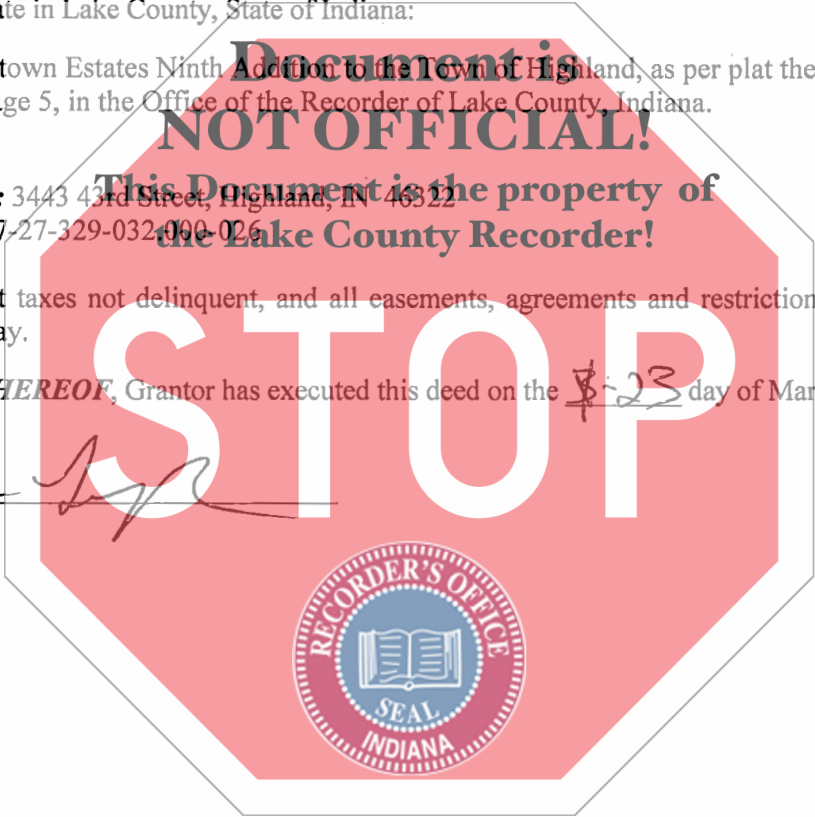

**FIDELITY NATIONAL
TITLE COMPANY**

92017-0289 (2) ✓

011342

DULY ENTERED FOR TAXATION SUBJECT
FINAL ACCEPTANCE FOR TRANSFER

MAR 29 2017

JOHN E. PETALAS
LAKE COUNTY AUDITOR

\$18
FN
CA

STATE OF INDIANA)

) SS.

COUNTY OF LAKE)

Document is

NOT OFFICIAL!

Before me, a Notary Public in and for said County and State, personally appeared Larry Legler who acknowledged the execution of the foregoing deed.

**This Document is the property of
the Lake County Recorder!**

Witness my hand and notarial seal on the 23rd day of March, 2017.



Notary Public Lisa M. Matson
Resident of Lake County
My Commission expires: 2/1/2024

Prepared by: Timothy R. Kuiper
Austgen Kuiper Jasaitis P.C., 130 North Main Street, Crown Point, IN 46307

Grantee's Address and Tax Billing Address:
3443 43rd St.
Highland, IN 46322



I affirm, under the penalties for perjury, that I have taken reasonable care to redact each Social Security number in this document, unless required by law Lisa M. Matson. File No. 920170289

Return to: 3443 43rd St.
Highland, IN 46322