

2

STATE OF INDIANA
LAKE COUNTY
FILED FOR RECORD

2017 020551

2017 MAR 31 AM 10:10

MICHAEL B. BROWN
RECORDER

WARRANTY DEED

THIS INDENTURE WITNESSETH, That Anthony M. Chavez II and Kelly D. Chavez, Husband and Wife (Grantor) **CONVEY(S) AND WARRANT(S)** to Jesse A. Tomich (Grantee) for the sum of Ten Dollars (\$10.00) and other valuable consideration, the receipt and sufficiency of which are hereby acknowledged, the following described real estate in Lake County, State of Indiana:

Lot 32 Wildwood on the Lake, in the City of Hobart as per Plat thereof, recorded in Plat Book 31, Page 44, in the Office of the Recorder of Lake County, Indiana.

Property Address: 335 Cherry Ln, Hobart, IN 46342-4941
Tax ID No.: 45-09-31-177-007-000-018

Subject to current taxes not delinquent, and all easements, agreements and restrictions of record and all public rights of way.

IN WITNESS WHEREOF, Grantor has executed this deed on the 22nd day of March 2017.

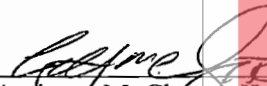
Anthony M. Chavez II

Kelly D. Chavez

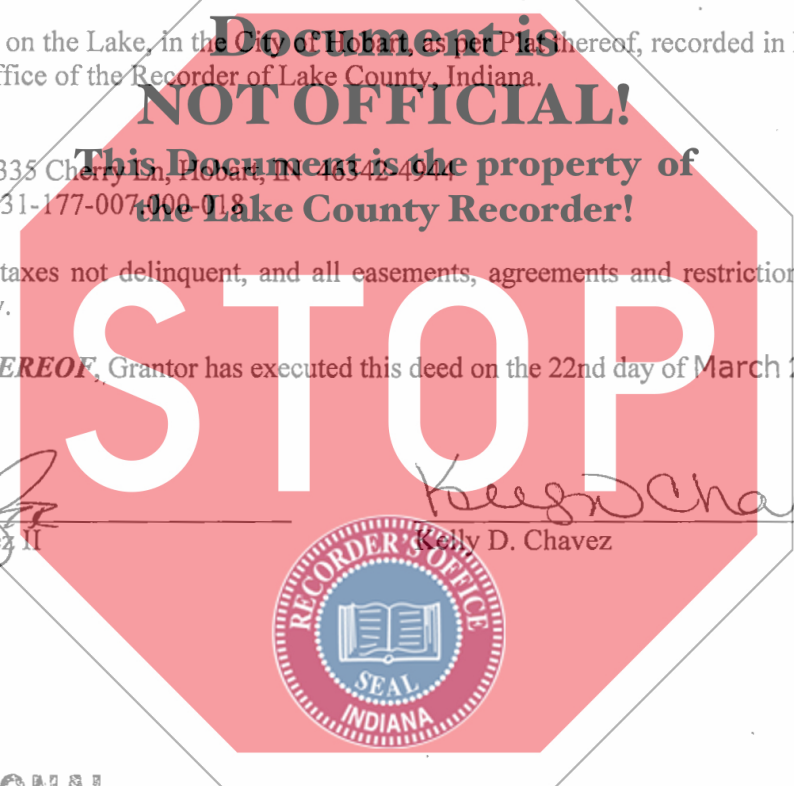

**FIDELITY NATIONAL
TITLE COMPANY**

92010-2671 ✓

DULY ENTERED FOR TAXATION SUBJECT
FINAL ACCEPTANCE FOR TRANSFER

MAR 29 2017

JOHN E. PETALAS
LAKE COUNTY AUDITOR

011336

A18
FN
C

STATE OF INDIANA)
) SS.
COUNTY OF Porter)

Before me, a Notary Public in and for said County and State, personally appeared Anthony M. Chavez II and Kelly D. Chavez who acknowledged the execution of the foregoing deed.

Witness my hand and notarial seal on the 22nd day of March, 2017.

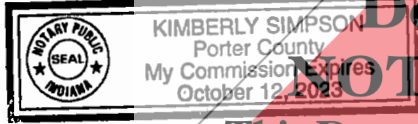

Kimberly Simpson
Notary Public Kimberly Simpson
Resident of Porter County
My Commission expires: 10/12/2023



Prepared by: Timothy Kuiper
Austgen Kuiper Jasaitis P.C., 130 North Main Street, Crown Point, IN 46307

Grantee's Address and Tax Billing Address:
335 Chesapeake
Evansville IN 46342

I affirm, under the penalties for perjury, that I have taken reasonable care to redact each Social Security number in this document, unless required by law
Kim Simpson. File No. 920162671

Return to: Fidelity Title