

QUITCLAIM DEED

THIS INDENTURE WITNESSETH, Janice Elaine Williams Baldwin

GRANTOR(S) of Robertson County, in the State of Tennessee

QUITCLAIMS(s) to George Frederick Baldwin and Janice Elaine Williams Baldwin as Co Trustees under the provisions of the FRED AND JANICE BALDWIN REVOCABLE TRUST AGREEMENT

GRANTEE(S) of Robertson County, in the State of Tennessee

In consideration of One Dollar (\$1.00) and other valuable consideration, the receipt and sufficiency of which are hereby acknowledged, the following described real estate in Lake County, in the State of Indiana: The West 60 feet of Lot 4, Block 1, Calumet Lawn Addition to Hammond, as shown in Plat Book 17, page 2, in Lake County, Indiana. Commonly Known As: 817 173rd Place, Hammond, Indiana 46324. Key number: 45-07-18-101-019.000-023

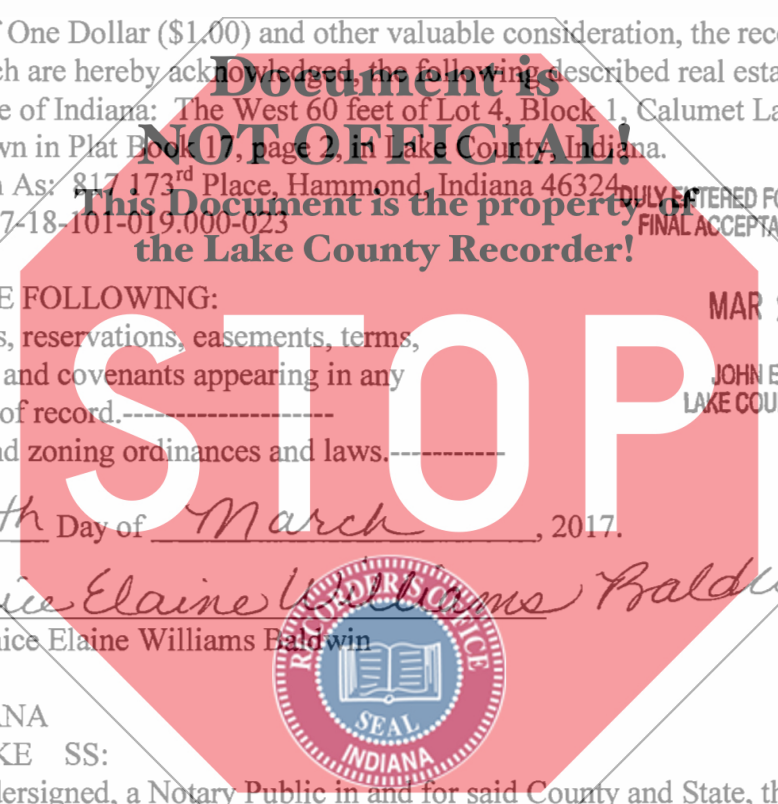

SUBJECT TO THE FOLLOWING:

1. Restrictions, reservations, easements, terms, conditions, and covenants appearing in any instrument of record.
2. Building and zoning ordinances and laws.

Dated this 24th Day of March, 2017.

Signature: Janice Elaine Williams Baldwin
Printed Name: Janice Elaine Williams Baldwin

STATE OF INDIANA
COUNTY OF LAKE SS:

Before me, the undersigned, a Notary Public in and for said County and State, this 24 Day of March, 2017, personally appeared: Janice Williams Baldwin, and acknowledged the execution of the foregoing deed. In witness whereof, I have hereunto subscribed my name and affixed my official seal.

My Commission Expires: 01/03/2020

Signature: Gerald Paul Kray

Resident of Lake County

Printed: Gerald Paul Kray

This instrument prepared by: Attorney Gerald P. Kray, 622 West Lake Street, Griffith, IN 46319
Attorney Identification No. 5446-45

I affirm under penalties for perjury, that I have taken reasonable care to redact each social security number in this document unless required by law.

Gerald P. Kray

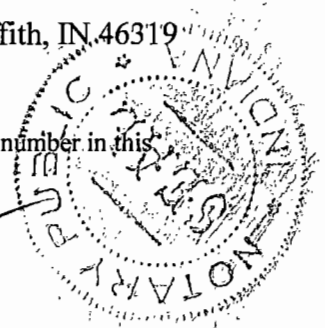

2017 089361

STATE OF INDIANA
LAKE COUNTY
FILED FOR RECORD

MAR 24 2017
JOHN E. PETALAS
LAKE COUNTY AUDITOR

030052

DISCLOSURE NEEDED

Approved Assessor's Office

#17
NONCON
CASH GP