

STATE OF INDIANA  
LAKE COUNTY  
FILED FOR RECORD

2017 007114

2017 FEB -1 AM 10:41

MICHAEL B. BROWN  
RECORDER

Mail tax bills to:

Parcel No. 45-10-01-427-015.000-034

445 EAST NORTH WATER ST  
UNIT 1304  
Chicago IL  
60611

### WARRANTY DEED

THIS INDENTURE WITNESSETH, That SUSAN M. GRELEWICZ, ("Grantors")

of LAKE County in the State of Indiana

CONVEY (S) AND WARRANT (S) TO B & E DEVELOPMENT LLC, ("Grantee")

of LAKE County in the State of Indiana

in consideration of One Dollar and other valuable consideration, the receipt and sufficiency of which are hereby acknowledged, the following described real estate in LAKE County, in the State of Indiana:

LOT 89, IN NORTHGATE SECOND ADDITION TO THE TOWN OF DYER, AS PER PLAT THEREOF, RECORDED IN PLAT BOOK 40 PAGE 28, IN THE OFFICE OF THE RECORDER OF LAKE COUNTY, INDIANA.

Commonly known as: 1015 JACKSON AVENUE, DYER, IN, 46311  
Grantee's address:

Subject to: Taxes for 2016 and subsequent years, building lines, covenants and restrictions.

Dated this 27<sup>th</sup> day of January, 2017.

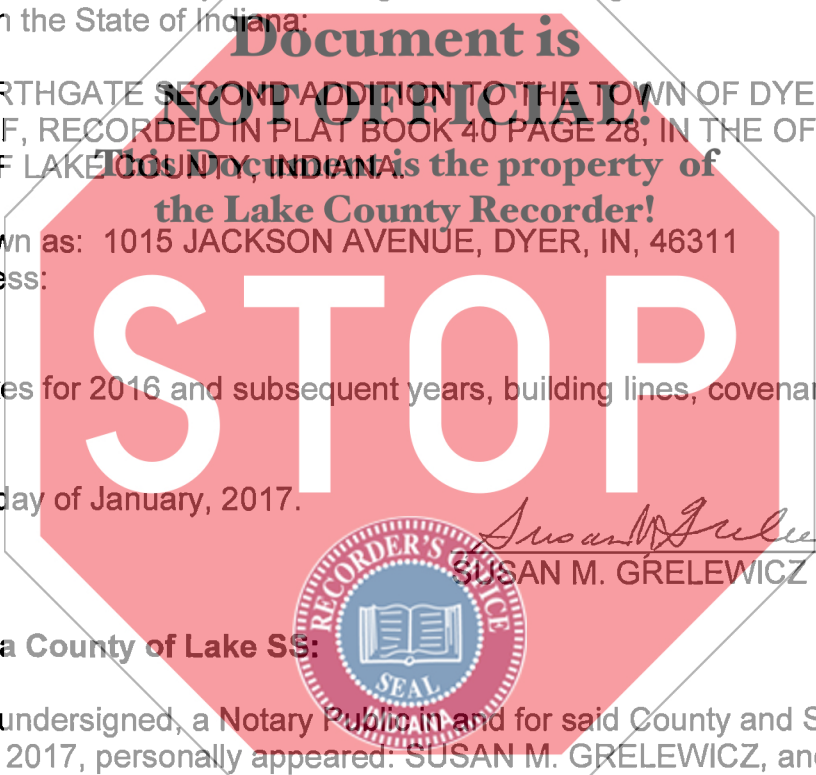

NORTHWEST INDIANA TITLE  
162 WASHINGTON STREET  
LOWELL, IN 46356  
22627 219-696-0100

State of Indiana County of Lake SS:

Before me, the undersigned, a Notary Public in and for said County and State, this 27<sup>th</sup> day of January, 2017, personally appeared: SUSAN M. GRELEWICZ, and acknowledged the execution of the foregoing deed. In witness whereof, I have hereunto subscribed my name and affixed my official seal.

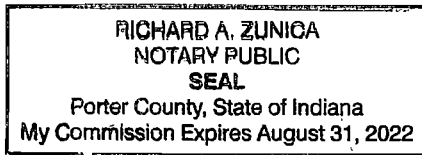

, Notary Public

My commission expires:  
County of residence:

I affirm under the penalties for perjury that I have taken reasonable care to redact each social security number in this document unless required by law.

RICHARD A. ZUNICA

This instrument prepared by: Attorney Richard A. Zunica, 162 Washington St., Lowell, In 46356  
File No. 17-22627/

020837

DULY ENTERED FOR TAXATION SUBJECT  
FINAL ACCEPTANCE FOR TRANSFER

FEB 01 2017

JOHN E. PETALAS  
LAKE COUNTY AUDITOR

AMOUNT \$ 16  
CASH \_\_\_\_\_ CHARGE \_\_\_\_\_  
CHECK # 3466  
OVERAGE \_\_\_\_\_  
COPY \_\_\_\_\_  
NON-COM \_\_\_\_\_  
CLERK CA