

2016 059627

2016 AUG 31 AM 10:57

MICHAEL D. BROWN  
RECORDER

Grantees' address & Mail tax bills to: \_\_\_\_\_

### WARRANTY DEED

THIS INDENTURE WITNESSETH, That **ROBERT LUEBCKE, AS TO AN UNDIVIDED 47.5 % INTEREST; GERALD LUEBCKE, AS TO AN UNDIVIDED 47.5 % INTEREST; GERALD LUEBCKE, AS TRUSTEE OF THE RAYMOND LUEBCKE TESTAMENTARY TRUST; AS TO AN UNDIVIDED 5 % INTEREST, ALL AS TENANTS IN COMMON.** ("Grantor")

of Lake County in the State of Indiana CARE ~~of~~

CONVEY (S) AND WARRANT (S) TO **Long Term Investments VI, LLC, an Indiana Limited Liability Company** ("Grantee")

of Lake County in the State of Indiana

in consideration of One Dollar and other valuable consideration, the receipt and sufficiency of which are hereby acknowledged, the following described real estate in LAKE County, in the State of Indiana:

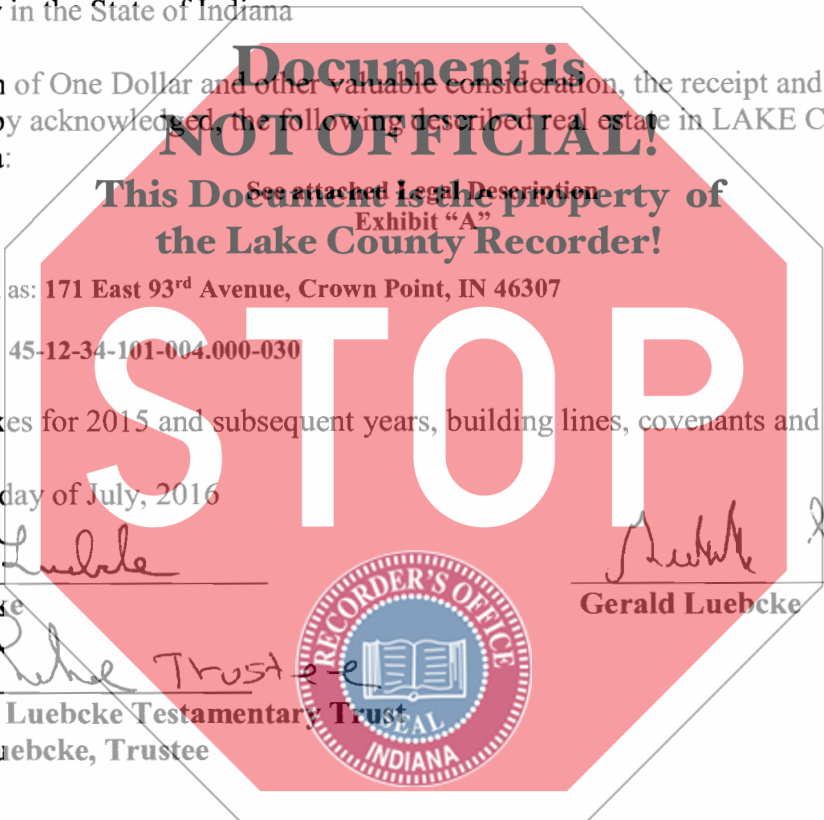

Commonly known as: **171 East 93<sup>rd</sup> Avenue, Crown Point, IN 46307**

Property Number: **45-12-34-101-004.000-030**

Subject to: Taxes for 2015 and subsequent years, building lines, covenants and restrictions.

Dated this 15<sup>th</sup> day of July, 2016

Robert Luebcke  
Robert Luebcke

Gerald Luebcke  
Gerald Luebcke

Gerald Luebcke Trustee  
The Raymond Luebcke Testamentary Trust  
By: Gerald Luebcke, Trustee

State of Indiana County of Lake SS:

Before me, the undersigned, a Notary Public in and for said County and State, this ~~20<sup>th</sup>~~<sup>15<sup>th</sup></sup> day of ~~July~~, 2016, personally appeared: **Timothy J. Fair and Judith K. Fair** and acknowledged the execution of the foregoing deed. In witness whereof, I have hereunto subscribed my name and affixed my official seal.

My commission expires: 10-29-16

Kimberly Kay Schultz, Notary Public

Resident of Jasper County

I affirm under the penalties for perjury that I have taken reasonable care to redact each social security number in this document unless required by law.  
16-5672M

Kim Schultz

This instrument prepared by \_\_\_\_\_ Kuiper Attorney at Law 130 N. Main Street, Crown Point, IN 46307

DULY ENTERED FOR TAXATION SUBJECT  
FINAL ACCEPTANCE FOR TRANSFER

014936

AUG 31 2016

JOHN E. PETALAS  
LAKE COUNTY AUDITOR

**Northwest Indiana  
Title Services, Inc.**  
101 E. 90th Drive Suite C  
Merrillville, IN 46410

18-  
JAT  
Dr

# EXHIBIT "A"

## LEGAL DESCRIPTION

THE WEST HALF OF THE NORTHWEST QUARTER OF SECTION 34, TOWNSHIP 35 NORTH, RANGE 8 WEST OF THE SECOND PRINCIPAL MERIDIAN, IN LAKE COUNTY, INDIANA, EXCEPT THE SOUTH 1,832.7 FEET, MEASURED ALONG THE WEST LINE THEREOF, AND ALSO EXCEPT THE NORTH 400 FEET OF THE WEST 653.4 FEET THEREOF,

EXCEPTING THEREFROM:

THAT PART OF THE WEST HALF OF THE NORTHWEST QUARTER OF SECTION 24, TOWNSHIP 35 NORTH, RANGE 8 WEST OF THE SECOND PRINCIPAL MERIDIAN, IN LAKE COUNTY, INDIANA, BOUNDED AND DESCRIBED AS FOLLOWS: COMMENCING AT THE NORTHWEST CORNER OF THE NORTHWEST QUARTER OF SAID SECTION 34; THENCE ON AN ASSUMED BEARING OF NORTH 90 DEGREES 00 MINUTES 00 SECONDS EAST, ALONG THE NORTH LINE OF SAID NORTHWEST QUARTER, 199.157 METERS (653.40 FEET) TO THE EAST LINE OF THE WEST 199.157 METERS (653.40 FEET) OF THE WEST HALF OF THE NORTHWEST QUARTER OF SAID SECTION 34 FOR THE POINT OF BEGINNING; THENCE SOUTH 00 DEGREES 24 MINUTES 38 SECONDS EAST ON THE LAST DESCRIBED LINE, 20.642 METERS (67.72 FEET); THENCE EASTERLY 16.900 METERS (55.44 FEET), ALONG AN ARC TO THE RIGHT, HAVING A RADIUS OF 5351.000 METERS (17555.74 FEET) AND SUBTENDED BY A LONG CHORD, HAVING A BEARING OF SOUTH 88 DEGREES 29 MINUTES 26 SECONDS EAST, AND A LENGTH OF 16.900 METERS (55.44 FEET); THENCE SOUTH 88 DEGREES 24 MINUTES 00 SECONDS EAST, ALONG A TANGENT 100.000 METERS (328.08 FEET); THENCE EASTERLY 89.264 METERS (292.86 FEET), ALONG AN ARC TO THE LEFT, HAVING A RADIUS OF 5389.000 METERS (17680.41 FEET) AND SUBTENDED BY A LONG CHORD HAVING A BEARING OF SOUTH 88 DEGREES 52 MINUTES 28 SECONDS EAST AND A LENGTH OF 89.263 METERS (292.86 FEET) TO THE EAST LINE OF THE WEST HALF OF THE NORTHWEST QUARTER OF SAID SECTION 34; THENCE NORTH 00 DEGREES 22 MINUTES 04 SECONDS WEST, ON SAID EAST LINE 25.632 METERS (84.10 FEET) TO THE NORTH LINE OF THE NORTHWEST QUARTER OF SAID SECTION 34; THENCE SOUTH 90 DEGREES 00 MINUTES 00 SECONDS WEST ON SAID NORTH LINE, 206.084 METERS (673.13 FEET) TO THE POINT OF BEGINNING;

ALSO EXCEPTING THEREFROM:

THAT PART OF THE WEST HALF OF THE NORTHWEST QUARTER OF SECTION 34, TOWNSHIP 35 NORTH, RANGE 8 WEST OF THE SECOND PRINCIPAL MERIDIAN, IN LAKE COUNTY, INDIANA, BOUNDED AND DESCRIBED AS FOLLOWS:

COMMENCING AT THE NORTHWEST CORNER OF THE NORTHWEST QUARTER OF SAID SECTION 34; THENCE ON AN ASSUMED BEARING OF NORTH 90 DEGREES 00 MINUTES 00 SECONDS EAST, ALONG THE NORTH LINE OF SAID NORTHWEST QUARTER, 199.157 METERS (653.40 FEET) TO THE EAST LINE OF THE WEST 199.157 METERS (653.40 FEET) OF THE WEST HALF OF THE NORTHWEST QUARTER OF SAID SECTION 34; THENCE SOUTH 00 DEGREES 24 MINUTES 38 SECONDS EAST ON SAID EAST LINE, 20.642 METERS (67.72 FEET) TO THE POINT OF BEGINNING; THENCE EASTERLY 1.899 METERS (6.23 FEET) ALONG AN ARC TO THE RIGHT, HAVING A RADIUS OF 5351.000 METERS (17555.74 FEET) AND SUBTENDED BY A LONG CHORD HAVING A BEARING OF SOUTH 88 DEGREES 34 MINUTES 15 SECONDS EAST AND A LENGTH OF 1.899 METERS (6.23 FEET) THENCE SOUTH 08 DEGREES 00 MINUTES 37 SECONDS EAST 88.059 METERS (288.91 FEET); THENCE SOUTH 00 DEGREES 58 MINUTES 17 SECONDS WEST 98.236 METERS (322.30 FEET); THENCE SOUTH 00 DEGREES 23 MINUTES 14 SECONDS WEST 39.720 METERS (130.31 FEET) TO THE NORTH LINE OF THE SOUTH 558.608 METERS (1832.70 FEET), AS MEASURED ALONG THE WEST LINE OF SAID NORTHWEST QUARTER; THENCE NORTH 89 DEGREES 51 MINUTES 38 SECONDS WEST, ALONG SAID NORTH LINE, A DISTANCE OF 45.720 METERS (150.00 FEET) THENCE NORTH 00 DEGREES 23 MINUTES 14 SECONDS EAST, A DISTANCE OF 40.150 METERS (131.73 FEET); THENCE NORTH 00 DEGREES 58 MINUTES 17 SECONDS EAST, A DISTANCE OF 83.663 METERS (274.48 FEET); TO THE SOUTH LINE OF THE NORTH 121.920 METERS (400.00 FEET); THENCE NORTH 90 DEGREES 00 MINUTES 00 SECONDS, ALONG SAID SOUTH LINE A DISTANCE OF 32.521 METERS (106.70 FEET) TO THE EAST LINE OF THE WEST 199.157 METERS (653.40 FEET); THENCE NORTH 00 DEGREES 24 MINUTES 38 SECONDS WEST, ALONG SAID

EAST LINE, A DISTANCE OF 101.279 METERS (332.28 FEET) TO THE POINT OF BEGINNING.

ALSO EXCEPTING THEREFROM:

PART OF THE WEST 1/2 OF THE NORTHWEST 1/4 OF SECTION 34, TOWNSHIP 35 NORTH, RANGE 8 WEST OF THE SECOND PRINCIPAL MERIDIAN, IN THE TOWN OF MERRILLVILLE, LAKE COUNTY, INDIANA, MORE PARTICULARLY DESCRIBED AS FOLLOWS:

COMMENCING AT THE NORTHWEST CORNER OF SAID SECTION 34; THENCE SOUTH 00 DEGREES 10 MINUTES 25 SECONDS EAST ALONG THE WEST LINE OF SAID SECTION 34, A DISTANCE OF 400.00 FEET TO THE POINT OF BEGINNING; THENCE SOUTH 89 DEGREES 45 MINUTES 41 SECONDS EAST PARALLEL WITH THE NORTH LINE OF SAID SECTION 34, A DISTANCE OF 546.69 FEET; THENCE SOUTH 01 DEGREES 12 MINUTES 36 SECONDS WEST A DISTANCE OF 274.48 FEET; THENCE SOUTH 00 DEGREES 47 MINUTES 33 SECONDS WEST, A DISTANCE OF 131.73 FEET TO THE SOUTH LINE OF A TRACT OF LAND DESCRIBED IN AN ORDER TO ROBERT LUEBCKE AND GERALD LUEBCKE, AS RECORDED IN CIRCUIT COURT DOC. NO. 2002 055650; THENCE NORTH 89 DEGREES 37 MINUTES 22 SECONDS WEST ALONG SAID SOUTH LINE A DISTANCE OF 538.24 FEET TO THE WEST LINE OF SAID SECTION 34; THENCE NORTH 00 DEGREES 10 MINUTES 25 SECONDS WEST ALONG SAID WEST LINE A DISTANCE OF 404.88 FEET TO THE POINT OF BEGINNING.