

STATE OF INDIANA
LAKE COUNTY
FILED FOR RECORD

2016 048925

2016 AUG -2 AM 10:43

MICHAEL B. BROWN
RECORDER

Mail tax bills to:
9598 CALUMET ST
DYER, IN, 46311

Parcel No. 45-10-36-279-022.000-032

WARRANTY DEED

THIS INDENTURE WITNESSETH, That TAMARA A. WARREN, ("Grantors")
of LAKE County in the State of Indiana

CONVEY (S) AND WARRANT (S) TO STEVEN M. MERGENTHALER and RAQUEL
MERGENTHALER, husband and wife, ("Grantee")

of LAKE County in the State of Indiana

in consideration of One Dollar and other valuable consideration, the receipt and
sufficiency of which are hereby acknowledged, the following described real estate in
LAKE County, in the State of Indiana:

LOT 116 IN THE ENCLAVE UNIT 1, AS PER PLAT THEREOF, RECORDED IN PLAT
BOOK 93 PAGE 32, IN THE OFFICE OF THE RECORDER OF LAKE COUNTY,
INDIANA.

Commonly known as: 9598 CALUMET ST, DYER, IN, 46311
Grantee's address: 9598 CALUMET ST, DYER, IN, 46311

Subject to: Taxes for 2015 and subsequent years, building lines, covenants and
restrictions.

Dated this 29th day of July, 2016

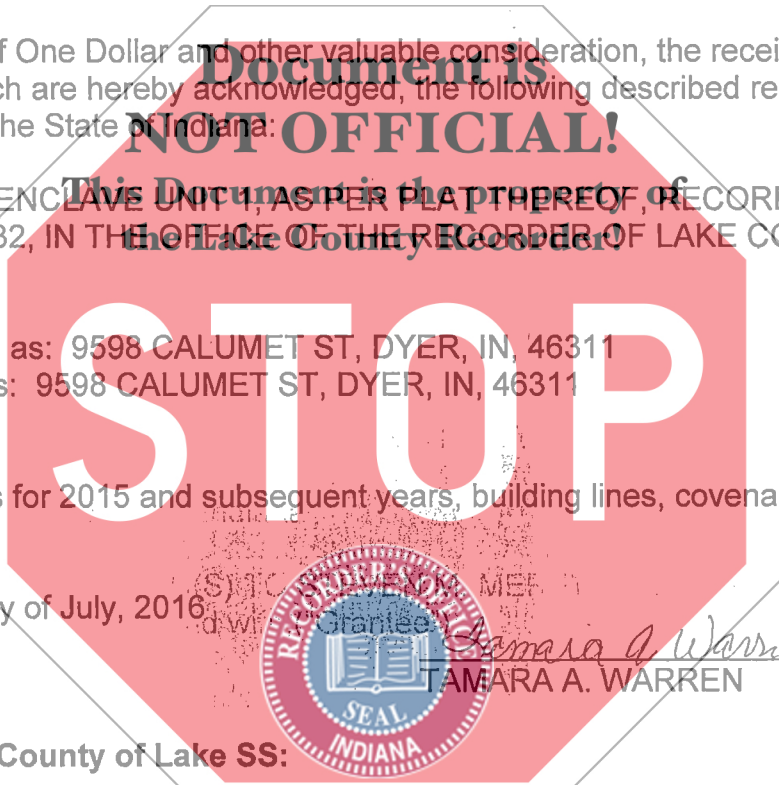

Tamara A. Warren
TAMARA A. WARREN

State of Indiana County of Lake SS:

Before me, the undersigned, a Notary Public in and for said County and State, this 29th
day of July, 2016 personally appeared: TAMARA A. WARREN, and acknowledged the
execution of the foregoing deed. In witness whereof, I have hereunto subscribed my
name and affixed my official seal.

KATREENA C. GUGGERTY
NOTARY PUBLIC
SEAL

Katreena C. Guggerty
Notary Public

LAKE COUNTY, STATE OF INDIANA
MY COMM. EXPIRES JANUARY 20, 2022

My commission expires COMMISSION NO. 650372
County of residence:

I affirm under the penalties for perjury that I have taken reasonable care to redact each social security
number in this document unless required by law

This instrument prepared by: Attorney Richard A. Zunica, 162 Washington St., Lowell, In 46356
File No. 16-22049CD/

DULY ENTERED FOR TAXATION SUBJECT
FINAL ACCEPTANCE FOR TRANSFER

24885

AUG 01 2016

JOHN E. PETALAS
LAKE COUNTY AUDITOR

AMOUNT \$ 16. -
CASH _____ CHARGE _____
CHECK # 3047
OVERAGE _____
COPY _____
NON-COM _____
CLERK *[Signature]*