

2016 048691

2016 AUG -1 PM 1:55

MICHAEL B. BROWN
RECORDER

Prepared By:
Gregory Jones
2127 w. 14th. Avenue
Gary, Indiana 46404

After Recording Return To:
Gregory Jones
2127 W. 14th. Avenue
Gary, Indiana 46404

**Document is
NOT OFFICIAL!**

SPACE ABOVE THIS LINE FOR RECORDER'S USE

QUITCLAIM DEED
This Document is the property of
the Lake County Recorder!

On July 31, 2016 THE GRANTOR(S),

- Gregory Jones, a married person,

for and in consideration of: One Dollar (\$1.00) and/or other good and valuable consideration conveys, releases and quitclaims to the GRANTEE(S):

- Percy Jones Sr., a single person, residing at 2509 E. 21st. Avenue, Gary, Lake County, Indiana 46407

the following described real estate, situated in Gary, in the County of Lake, State of Indiana:

Legal Description: MarshallTown Terrace L.5 BL1

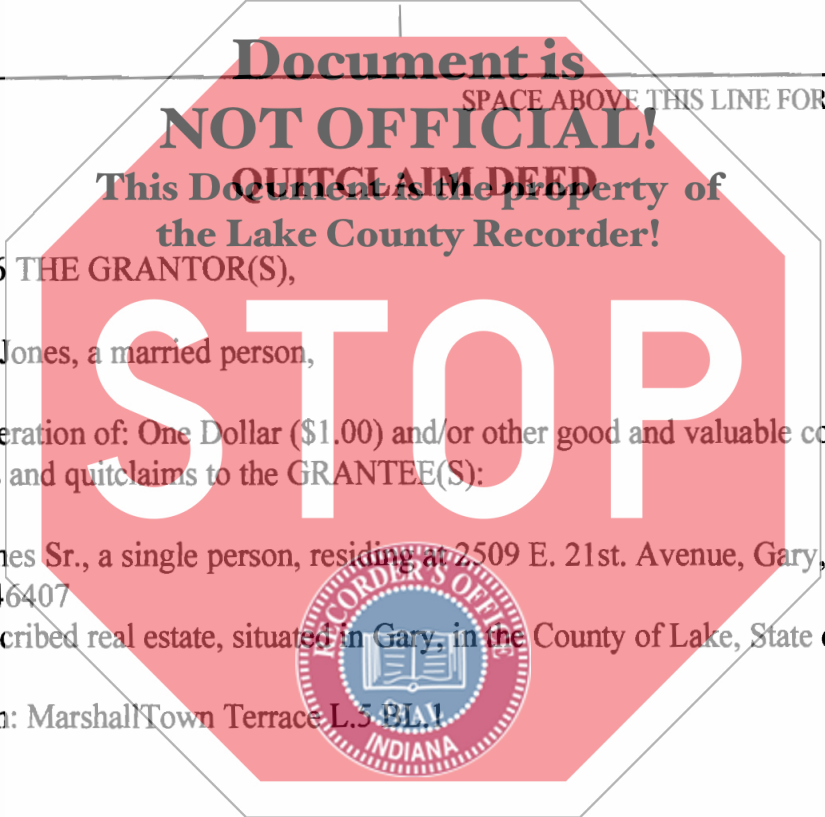

014282

DULY ENTERED FOR TAXATION SUBJECT
FINAL ACCEPTANCE FOR TRANSFER

NO SALES DISCLOSURE NEEDED

AUG 01 2016

Approved Assessor's Office

JOHN E. PETALAS
LAKE COUNTY AUDITOR

By: TT

20.
CASH
Dr

Grantor Signatures:

DATED: 7-31-16

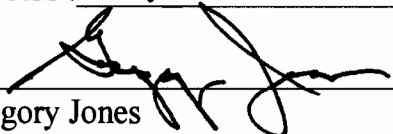

Gregory Jones
2127 w. 14th. Avenue
Gary, Indiana, 46404

STATE OF INDIANA, COUNTY OF LAKE, ss:

This instrument was acknowledged before me on this 31st day of July, 2016 by Gregory Jones.

I affirm, under the penalties for perjury, that I have taken reasonable care to redact each social security number in this document, unless required by law.

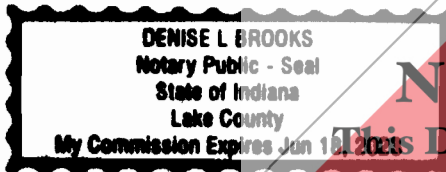

Denise L. Brooks
Notary Public
Document is NOT OFFICIAL!
Notary
This Document is the Property of
the Lake County Recorder!
My commission expires June 18th 2023

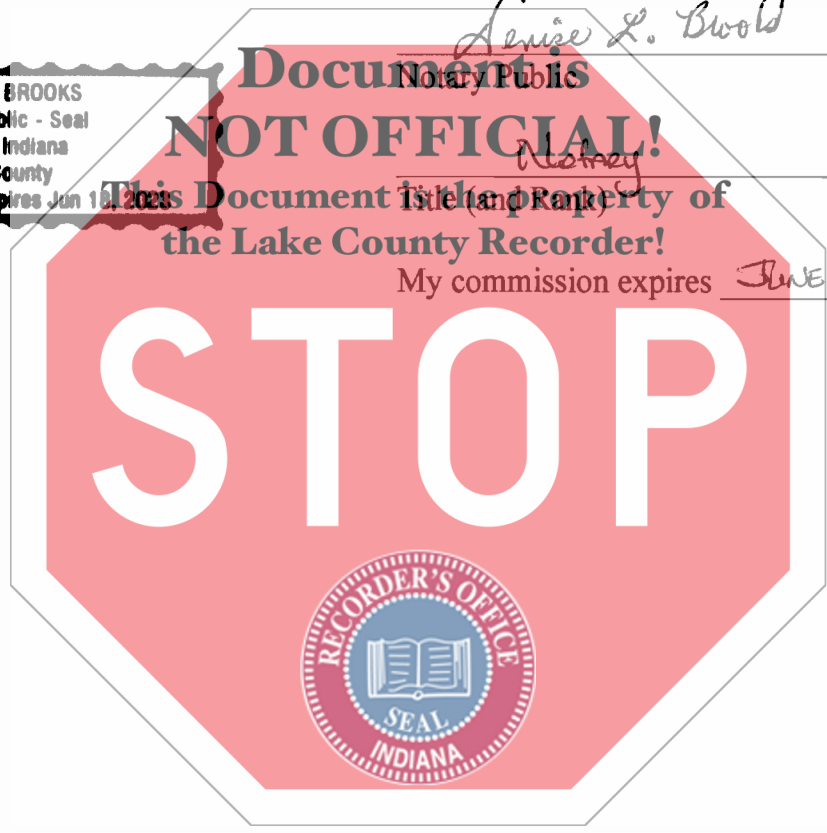

Grantor does hereby convey, release and quitclaim all of the Grantor's rights, title, and interest in and to the above described property and premises to the Grantee(s), and to the Grantee(s) heirs and assigns forever, so that neither Grantor(s) nor Grantor's heirs, legal representatives or assigns shall have, claim or demand any right or title to the property, premises, or appurtenances, or any part thereof.

Tax Parcel Number: 45-08-14-202-006.000-004

Mail Tax Statements To:
Priscilla Vorice
5147 Carolina St.
Gary, Indiana 46409

