

Grantees Address:
11621 W. Florissant Ave, Suite B
Florissant, MO 63033

mail Tax bills to:
2567 Burdard DR.
St. Louis, MO 63136

WARRANTY DEED

This Indenture Witnesseth that **Bethlehem Evangelical Lutheran Church, Inc., aka Bethlehem Lutheran Church, an administratively dissolved corporation, for the purposes of winding up its affairs pursuant to Indiana code**

of Lake County in the State of Indiana

Convey and warrant to **Covenant Community LLC**

of St. Louis County in the State of Missouri

in consideration of One Dollar (\$1.00) and other valuable consideration, the receipt and sufficiency of which are hereby acknowledged, the following described real estate in Lake County, in the State of Indiana:

See the land referred to and described in Exhibit "A" attached hereto and incorporated herein as if fully set out herein.

Dated this 25 day of March, 2016.

By: **Bethlehem Evangelical Lutheran Church, Inc.**

Lucy Mariani
Lucy Mariani, Trustee

Barbara J. Patterson
Barbara J. Patterson, Trustee

Robert N. Corley
Robert N. Corley, Trustee

STATE OF INDIANA)
) SS:
COUNTY OF LAKE)

Before me, the undersigned, a Notary Public in and for said County and State, this 25 day of March, 2016, personally appeared **Lucy Mariani, Barbara J. Patterson and Robert N. Corley**, and acknowledged the execution of the foregoing Warranty Deed.

In witness whereof, I have hereunto subscribed my name and affixed my official seal.

Renee J. Wells
, Notary Public

My Commission Expires: 7-8-17

County of Residence: Jasper

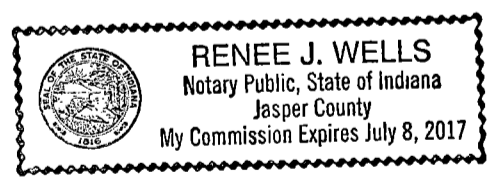

"I affirm under the penalties for perjury, that I have taken reasonable care to redact each social security number in this document, unless required by law."

Prepared by: Charles D. Brooks, Jr.
DUEY ENTERED FOR TAXATION SUBJECT
FINAL ACCEPTANCE FOR TRANSFER

**FIDELITY NATIONAL
TITLE COMPANY**
92015-2966

JUN 06 2016
JOHN E. PETALAS
LAKE COUNTY AUDITOR

23217

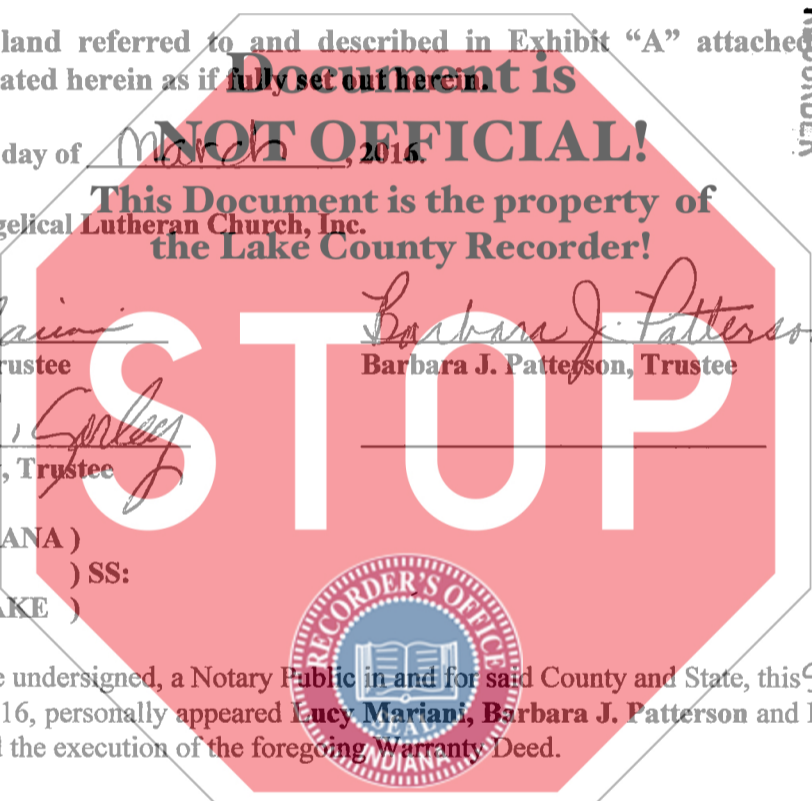

2016 JUN -9 AM 10:29
MICHAEL B. BROWN
RECORDER
STATE OF INDIANA
LAKE COUNTY
FILED FOR RECORD

CR
PW
Notary

EXHIBIT A

Parcel 1: Lots 1, 2, 3 and 4 in Block 49 in Gary Land Company's First Subdivision, in the City of Gary, as per plat thereof, recorded in Plat Book 6, page 15, in the Office of the Recorder of Lake County Indiana, excepting therefrom the South 7 feet of said Lot 4.

More commonly known as: 601 Fillmore Street, Gary, IN 46402 Property No. 45-08-04-336-001.000-004

✓ Parcel 2: The North ½ of Lot 7 in Block 49 in Gary Land Company's First Subdivision, in the City of Gary, as per plat thereof, recorded in Plat Book 6, page 15, in the Office of the Recorder of Lake County Indiana,

More commonly known as: 625 Fillmore Street, Gary, IN 46402 Property No. 45-08-04-336-004.000-004

✓ Parcel 3: Lot 8 and the South ½ of Lot 7 in Block 49 in Gary Land Company's First Subdivision, in the City of Gary, as per plat thereof, recorded in Plat Book 6, page 15, in the Office of the Recorder of Lake County Indiana,

More commonly known as: 629 Fillmore Street, Gary, IN 46402 Property No. 45-08-04-336-005.000-004

✓ Parcel 4: Lot 9 in Block 49 in Gary Land Company's First Subdivision, in the City of Gary, as per plat thereof, recorded in Plat Book 6, page 15, in the Office of the Recorder of Lake County Indiana,

More commonly known as: 635 Fillmore Street, Gary, IN 46402 Property No. 45-08-04-336-006.000-004

✓ Parcel 5: Lot 10 in Block 49 in Gary Land Company's First Subdivision, in the City of Gary, as per plat thereof, recorded in Plat Book 6, page 15, in the Office of the Recorder of Lake County Indiana,

More commonly known as: 637-39 Fillmore Street, Gary, IN 46402 Property No. 45-08-04-336-007.000-004

✓ Parcel 6: The North ½ of Lot 11 in Block 49 in Gary Land Company's First Subdivision, in the City of Gary, as per plat thereof, recorded in Plat Book 6, page 15, in the Office of the Recorder of Lake County Indiana,

More commonly known as: 641 Fillmore Street, Gary, IN 46402 Property No. 45-08-04-336-008.000-004