

STATE OF INDIANA
LAKE COUNTY
FILED FOR RECORD

2016 013049

2016 MAR -3 PM 2:40

MICHAEL B. BROWN
RECORDER

THE **LAMAR** COMPANIES

Termination of Memorandum of Lease
Lease #1095
Page 1 of 1

Return to: Lamar Advertising Co.
Attn: Real Estate Dept.
1770 W. 41st Avenue
Gary, IN 46408

Lessee: Lamar Advertising Company
1770 W. 41st Avenue
Gary, IN 46408

Lessor: Lake County Trust,
not individually but solely as Trustee
UTA #2313
2200 North Main Street
Crown Point, IN 46307

COMES NOW LAMAR ADVERTISING COMPANY by Jon Terpstra, Vice President and General Manager, terminates the Memorandum of Lease Agreement made on the 6th day of June, 2006 between Lake County Trust #2313 as Lessor and Lamar Advertising Company as Lessee, which was recorded on May 22, 2007 as Document #2007-041870 in the Office of the Recorder of Lake County, Indiana. The premises are situated in the County of Lake, State of Indiana more particularly described as follows:

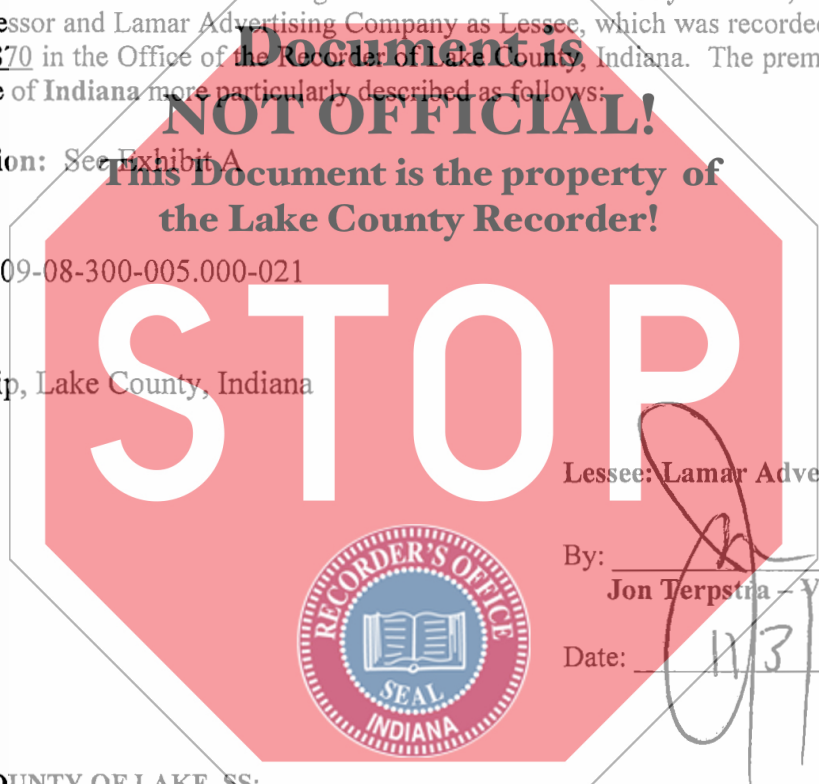

Legal Description: See Exhibit A

Key/Dup. #45-09-08-300-005.000-021

Hobart Township, Lake County, Indiana

Lessee: Lamar Advertising Company

By: Jon Terpstra VP/GM

Date: 11/3/15

STATE OF INDIANA, COUNTY OF LAKE, SS:

Before me the undersigned, a Notary Public for said county and state, personally appeared Jon Terpstra, and being first duly sworn upon their oaths, state that the facts set forth in the foregoing instrument are true. Signed and sealed this 3 day of November, 2015.

My Commission Expires:
County of Residence of Notary:



Shawn Michael Pettit
Notary Public (signature)

SHAWN MICHAEL PETTIT
Notary Public (please print)

→ This instrument prepared by: Lamar Advertising Company, 1770 W. 41st Avenue, Gary, Indiana 46408

AMOUNT \$ 14
CASH _____ CHARGE _____
CHECK# 2824
OVERAGE _____
COPY _____
NON-CONF _____
DEPUTY GP

“Exhibit A”

Lamar Lease #1095

Lake County Trust Company,
Not individually but solely as Trustee UTA #2313

Legal Description: The part of the South Half of Section 8 and part of the North Half of Section 17, Township 36 North, Range 7 West of the Second Principal Meridian, City of Lake Station, Hobart Township, Lake County, Indiana, lying South of the centerline of Burns Ditch and North of the North right of way line of the Borman Expressway (Interstate 80-94), more particularly described as follows: Commencing at the Northeast corner of Section 8, Township 36 North, Range 7 West as marked by a T-Rail; thence South along the said Section 8, South 1°42' East for a distance of 2,702.36 feet to the point of beginning; thence South 68°17' West on the centerline of Burns ditch which was dug in 1924 for a distance of 5,616.65 feet, more or less, to the West line of said Section 8: thence south on the West line of said Section 8 for a distance of 562.95 feet to the North line of said Section 17; thence East on the North line of said Section 17 for a distance of 729.25 feet, more or less, to the Northeast corner of a parcel of land conveyed by deed recorded March 24, 1971, as Document Number 93788; thence South on the East Line of document 93788, for a distance of 560 feet, more or less, to the North line of 300 foot wide Borman Expressway; thence North 65°20' East on the North line of said Borman Expressway for a distance of 650 feet, more or less, to the West line of a parcel of land conveyed by Warranty Deed recorded July 16, 1981, as Document Number 636628; thence North on said West line of East Half Northwest Quarter Section 17, 520 feet, more or less, to the South line of Section 8; thence East on said South line of Section 8 for a distance of 798.73 feet, more or less, to the North right of way line of said Borman Expressway; thence North 65°20' East on said North line of the Borman Expressway 565.0 feet, more or less, to the North-South centerline of said Section 8 and the West line of a parcel of land conveyed by Corporate Warranty Deed recorded September 26, 1983, as Document Number 727084; thence North on said North-South centerline for a distance of 515.0 feet, more or less, to the centerline of abandoned Little Calumet River and the Northwest side of Document 727084; thence North 66°20' East along said centerline of abandoned Little Calumet River, which is also the Northerly line of document 727084, for a distance of 420.0 feet, more or less; thence South 42°40' East on said centerline of abandoned Little Calumet River and the Northerly line of Document 727084, for a distance of 425.0 feet, more or less; thence North 32°20' East along the centerline of said abandoned Little Calumet River and the Northerly line of document 727084, for a distance of 180.0 feet; thence North 60°20' East along the centerline of said abandoned Little Calumet River and the Northerly line of Document 727084, for a distance of 120.0 feet; thence South 39°20' East along said centerline of abandoned Little Calumet River and the Northerly line of document 727084, 230 feet, more or less, to the North right of way line of 300 foot wide Borman Expressway; thence North 65°20' East on said North right of way line for a distance of 614.75 feet, more or less, to a concrete right of way marker; thence Northeasterly on a curved line of 1,600 foot radius, convexed to the Southeast, where chord has a bearing of North 45°50' East a length of 800 feet to a right of way marker; thence North 27°39'15" East for a distance of 96.93 feet to the centerline of the abandoned Little Calumet River; thence along the centerline of the abandoned Little Calumet River the following 11 distances: (1) Northwesterly on the centerline of the abandoned Little Calumet River in a straight line that makes an interior angle of 135°43'15" measured Southwest through West to Northwest with aforesaid 96.93 foot line for a distance of 145.00 feet; (2) thence Northwesterly on the centerline of the abandoned Little Calumet River on a straight line that makes an exterior angle of 164°28'26" measured South through East to Northwest with aforesaid 145 foot line for a distance of 132.00 feet; (3) thence Northwesterly in a straight line that makes an exterior angle of 194°52'48" measured Southeast through East to Northwest with aforesaid 132 foot line for a distance of 138.00 feet; (4) thence Northwesterly in a straight line that makes an exterior angle of 186°16'56" measured Southeast through East to Northwest with aforesaid 138 foot line for a distance of 70.00 feet; (5) thence Northwesterly in a straight line that makes an exterior angle of 179°18'46" measured Southeast through East to Northwest with aforesaid 70 foot line for a distance of 80.00 feet; (6) thence Northeasterly in a straight line that makes an exterior angle of 125°26'29" measured Southeast through East to Northeast with aforesaid 80 foot line for a distance of 75.00 feet; (7) thence Northeasterly in a straight line that makes an exterior angle of 166°28'27" measured Southwest through East to Northeast with aforesaid 75 foot line for a distance of 65.00 feet; (8) thence Northeast in a

straight line that makes an exterior angle of $151^{\circ}49'42''$ measured Southwest through South to Northeast with aforesaid 65 foot line for a distance of 55.00 feet; (9) thence Northeasterly in a straight line that makes an exterior angle of $169^{\circ}38'17''$ measured Southwest through South to Northeast with aforesaid 55 foot line for a distance of 122.00 feet; (10) thence Northeasterly in a straight line that makes an exterior angle of $181^{\circ}53'15''$ measured southwest through south to Northeast with aforesaid 122 foot line for a distance of 153.00 feet; (11) thence Northeasterly in a straight line that makes an exterior angle of $194^{\circ}29'47''$ measured Southwest through South to Northeast with aforesaid 153 foot line for a distance of 141.47 feet to a point in the Section line between said Sections 8 and 9 at a point 373.65 feet South of the point of beginning; thence North on said Section line between said Sections 8 and 9 for a distance of 373.65 feet to the point of beginning.

