

2

STATE OF INDIANA
LAKE COUNTY
FILED FOR RECORD

2015 073322

2015 OCT 30 AM 9:23

MICHAEL B. BROWN
RECORDER

STATE OF INDIANA)
)SS:
COUNTY OF LAKE)

AFFIDAVIT FOR TRANSFER OF REAL PROPERTY

1. That Tommie D. Joyner, a.k.a. Tommie Joyner, decedent, died intestate on February 3, 2005.

while domiciled in Lake County, Indiana

2. That forty-five (45) days have elapsed since the death of the decedent!

3. That no application or petition for the appointment of a personal representative is pending or has been granted in any jurisdiction, or is contemplated to be filed.

4. That the following named persons are the only heirs of the decedent:

- James W. Joyner, Adult Son, 2645 Van Buren Street, Gary, IN 46407; and
- Marie Harrington, Adult Daughter, 1858 Shady Grove Road, Goodman, MS 39079.

5. That among the decedent's probate assets is a parcel of real estate located in Lake County, Indiana, more particularly described as follows: DOUGLAS PARK ADD. S. 20 FT. L. 35 BL. 3, N. 20FT. L. 36 BL.3, commonly known as 2645 Van Buren Street, Gary, Indiana. Parcel No: 45-08-16-408-009.000-004.

6. That the value of the decedent's gross probate estate, less liens and encumbrances, does not exceed the sum of Twenty-five Thousand Dollars (\$25,000.00, as provided under IC 29-1-8-3, the costs of expenses of administration and reasonable funeral expenses.

7. That there are no creditors of the estate.



FILED

OCT 30 2015

22747

JOHN E. PETALAS
LAKE COUNTY AUDITOR

13 -
CS
RM

8. That there are no Indiana Inheritance or Federal Estate taxes due.
9. That the individuals entitled to the real estate as a result of the decedent's death are the are the decedent's heirs at law as provided under the laws of intestate succession as provided under IC- 29-2-1, namely: James W. Joyner, Adult Son and Marie Harrington, Adult Daughter.

10. That by reason of the above-stated matters, the affiant requests that the above-listed real estate of Tommie Joyner be transferred to them pursuant to the laws of intestate distribution. I.C. 29-1-2-1 et seq.

11. Each person's distributive share of the real estate described as: **DOUGLAS PARK ADD. S. 20 FT. L. 35 BL. 3, N. 20FT. L. 36 BL.3**, commonly known as 2645 Van Buren Street, Gary, Indiana has been calculated as follows: James W. Joyner 50% undivided interest and Marie Harrington 50% undivided interest.

I swear or affirm under the penalties for perjury that the foregoing statements are true.

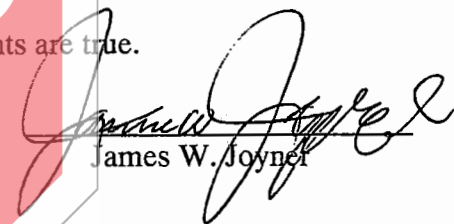

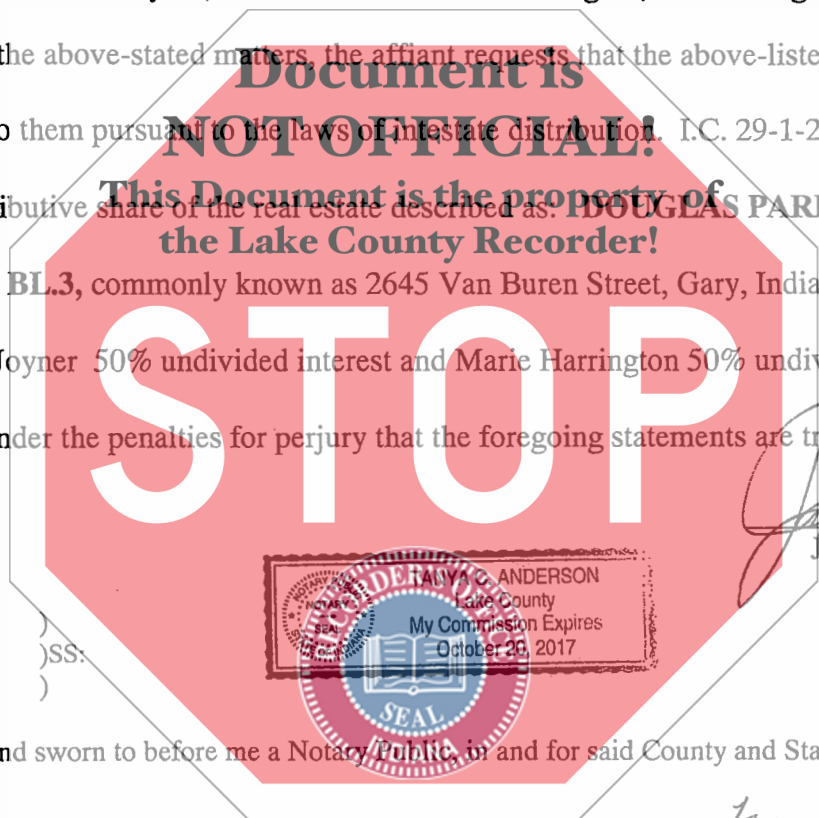
James W. Joyner



STATE OF INDIANA)
)SS:
COUNTY OF LAKE)

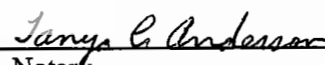

Subscribed and sworn to before me a Notary Public, in and for said County and State on this 27th day of October, 2015.

Notary

My Commission Expires: October 20, 2017
My County of Residence: Lake

I swear under the penalties for perjury that I have taken reasonable care to redact each social security number in this document unless required by law. Rebecca L. Wyatt.

Return document to: James W. Joyner, 2645 Van Buren Street, Gary, IN 46407.
Prepared by: Rebecca L. Wyatt, 644 S. Lake Street, Gary, Indiana 46403.

