

STATE OF INDIANA
LAKE COUNTY
FILED FOR RECORD

2015 072273

2015 OCT 26 AM 10:13

MICHAEL B. BROWN
RECORDER

2

WARRANTY DEED

THIS INDENTURE WITNESSETH, That Don H. Dillman (Grantor) **CONVEY(S) AND WARRANT(S)** to Sarah Marie Mercier (Grantee) for the sum of Ten Dollars (\$10.00) and other valuable consideration, the receipt and sufficiency of which are hereby acknowledged, the following described real estate in Lake County, State of Indiana:

Lot 10 in Park Manor 8th Addition to the Town of Schererville, as per plat thereof, recorded September 16, 1954 in Plat Book 30, Page 45 in the Office of the Recorder of Lake County, Indiana.

Property Address: 1721 Schafer Drive, Schererville, IN 46375
Tax ID No.: 45-11-15-134-010.000-036

Subject to current taxes not delinquent, and all easements, agreements and restrictions of record and all public rights of way.

IN WITNESS WHEREOF, Grantor has executed this deed on the 16th day of October, 2015.

Don H. Dillman

Don H. Dillman

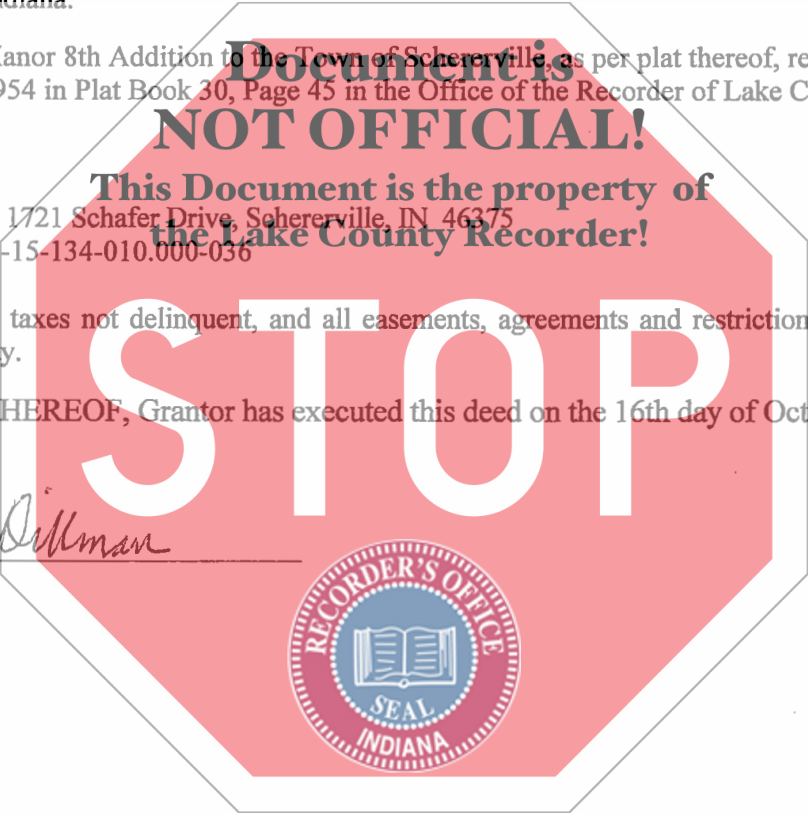

**FIDELITY NATIONAL
TITLE COMPANY**

92015-2562 ✓

DULY ENTERED FOR TAXATION SUBJECT
FINAL ACCEPTANCE FOR TRANSFER

OCT 23 2015

JOHN E. PETALAS
LAKE COUNTY AUDITOR

*18
DJ*

22585

STATE OF Indiana)
) SS.
COUNTY OF Lake)

Before me, a Notary Public in and for said County and State, personally appeared Don H. Dillman who acknowledged the execution of the foregoing deed.

Witness my hand and notarial seal on the 16th day of October, 2015.

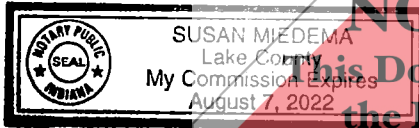

Document is NOT OFFICIAL!
Susan Miedema
Notary Public Susan Miedema
Resident of Lake County
My Commission expires: 8/7/2022
This Document is the property of the Lake County Recorder!

Prepared by: Timothy R. Kuiper, Attorney at Law
Austgen Kuiper Jasaitis P.C., 130 North Main Street, Crown Point, IN 46307

Grantee's Address and Tax Billing Address:
1721 Schafer Drive
Scherville, IN 46375

I affirm, under penalties for perjury, that I have taken reasonable care to redact each Social Security number in this document, unless required by law Susan Miedema. File No. 920152562

Return to: 1721 Schafer Drive, Scherville, IN 46375

