

Mail tax bills to:
1630 HARTLEY DRIVE
SCHERERVILLE, IN 46375

Parcel No. 45-11-15-202-006.000-036

WARRANTY DEED

THIS INDENTURE WITNESSETH, That EDWIN A. TYLEND A, JR. and MARY L. TYLEND A, husband and wife, ("Grantors")

of LAKE County in the State of Indiana

CONVEY (S) AND WARRANT (S) TO RICHARD WAYNE SHERMAN and PATRICIA SHERMAN, husband and wife ("Grantee")

of LAKE County in the State of Indiana

in consideration of One Dollar and other valuable consideration, the receipt and sufficiency of which are hereby acknowledged, the following described real estate in LAKE County, in the State of Indiana:

LOT 3, COUNTRY HILLS ESTATES, AS SHOWN IN PLAT BOOK 64, PAGE 6, IN LAKE COUNTY, INDIANA.

Commonly known as and Grantee's address: 1630 HARTLEY DRIVE, SCHERERVILLE, IN 46375

Subject to: Taxes for 2014 and subsequent years, building lines, covenants and restrictions.

Dated this 1st day of October, 2015.

Edwin A. Tylanda Jr.
EDWIN A. TYLEND A, JR.



Mary L. Tylanda
MARY L. TYLEND A

State of Indiana County of Lake SS:

Before me, the undersigned, a Notary Public in and for said County and State of Indiana, on the 1st day of October, 2015, personally appeared: EDWIN A. TYLEND A, JR. and MARY L. TYLEND A, and acknowledged the execution of the foregoing deed. In witness whereof, I have hereunto subscribed my name and affixed my official seal.



My commission expires:
County of residence:

I affirm under the penalties for perjury that I have taken reasonable care to redact each social security number in this document unless required by law.

This instrument prepared by: Attorney Richard A. Zunica, 162 Washington St., Lowell, In 46356
File No. 15-21688/sd/cash

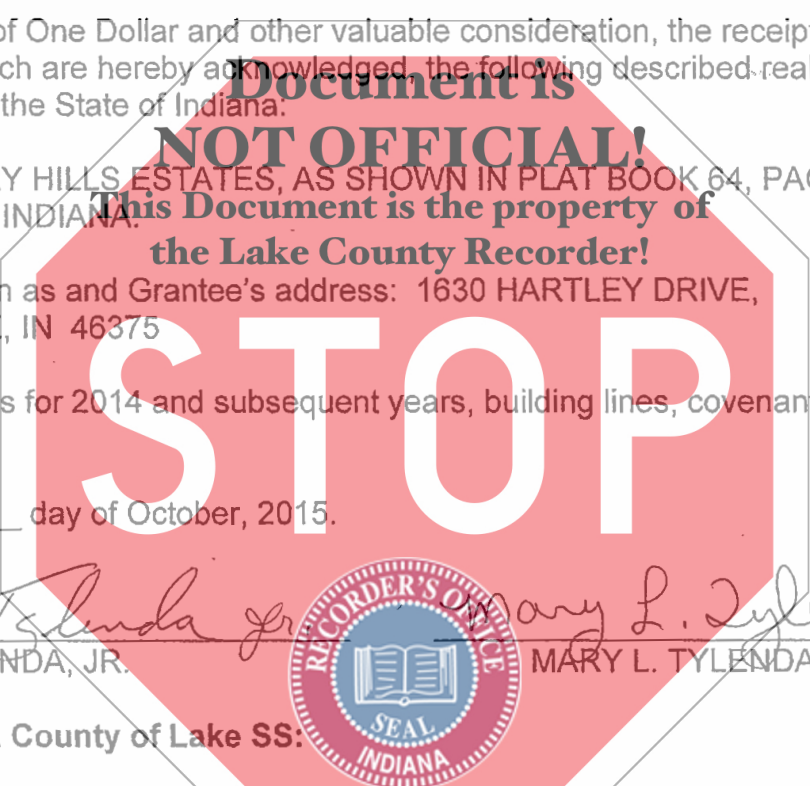

2015 07 10 46

2015 OCT 20 AM 9:50
MICHAEL B. BROWN
RECORDER

STATE OF INDIANA
LAKE COUNTY
FILED FOR RECORD
22324

Lori A. Moseley
Lori A. Moseley, Notary Public
TAXATION SUBJECT
FINAL ACCEPTANCE FOR TRANSFER

OCT 14 2015 \$ 17

JOHN E. PETALAS
LAKE COUNTY AUDITOR

ck# 2380
now can p
A