

2015 059487

2015 SEP -2 AM 9:07

MICHAEL B. BROWN  
RECORDER

WARRANTY DEED

15060663 1 of 2

THIS INDENTURE WITNESSETH that WILLIAM J. VIRGIN and JESSICA A. KARLIN, of Lake County, in the State of Indiana, CONVEY AND WARRANT to, MICHELLE R. RAMIREZ, of Lake County, in the State of Indiana, for and in consideration of Ten (\$10.00) Dollars and other good and valuable consideration, the receipt whereof is hereby acknowledged, the following Real Estate in Lake County in the State of Indiana, to-wit:

Commonly known as: 206 Woodland Drive, Lowell, IN 46356  
Parcel#: 45-19-25-102-009.000-008

LOT 15 IN BLOCK 1 IN FOREST HILL ADDITION TO LOWELL, AS PER PLAT THEREOF RECORDED IN PLAT BOOK 27, PAGE 33, IN THE OFFICE OF THE RECORDER OF LAKE COUNTY INDIANA.

- Subject to: 1) Taxes, Easements, Covenants and restrictions of record;
- 2) All legal highways and rights-of-way;
- 3) Ditches and drains, and rights therein;
- 4) Zoning Ordinances.
- 5) Subject to building lines, easements, covenants and restrictions of record, if any;
- 6) Possible Municipal and/or Sewer Assessments levied by the City/Town of Lowell;
- 7) Subject to the rights of way for drainage files, ditches, feeders, swails and laterals, if any.

Dated this 24 day of July, 2015.

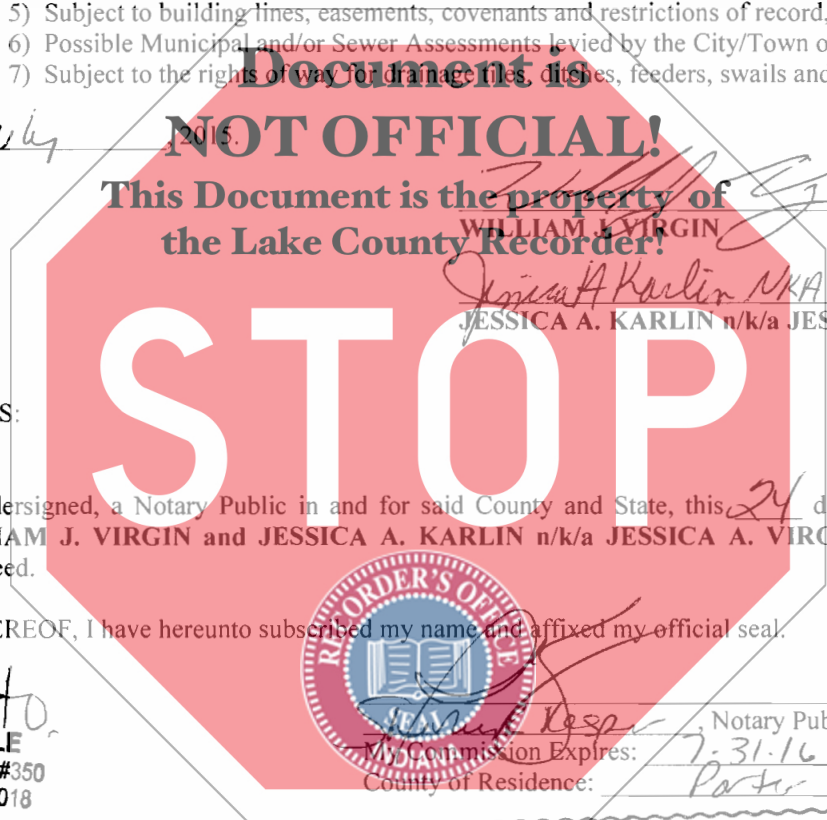

STATE OF IN )  
COUNTY OF  Jasper  ) SS:

Before me, the undersigned, a Notary Public in and for said County and State, this 24 day of July, 2015, personally appeared WILLIAM J. VIRGIN and JESSICA A. KARLIN n/k/a JESSICA A. VIRGIN, and acknowledged the execution of the foregoing deed.

IN WITNESS WHEREOF, I have hereunto subscribed my name and affixed my official seal.

Mail to  
PRISM TITLE  
1011 E. Touhy Ave. #350  
Des Plaines, IL 60018

This Instrument Prepared By:  
Nathan D. Vis, Attorney  
Blachly Tabor Bozik & Hartman  
56 S. Washington Street, Suite 401  
Valparaiso, IN 46383  
PH: 219/464-1041

SHIRLEY R. KASPER  
Notary Public, State of Indiana  
Porter County  
My Commission Expires 07/31/2016

MAIL TO: 206 WOODLAND DRIVE, LOWELL, IN 46356  
Grantee's Mailing Address to which the tax statement should be mailed under I.C. 6-1.1-22-8.1

Grantee's Street Address or Rural Route Address if different than Mailing Address

I affirm, under the penalties for perjury, that I have taken reasonable care to redact each social security number in this document, unless required by law. No legal opinion has been rendered during the preparation of this Deed.

Judy Kaczmarek

DULY ENTERED FOR TAXATION SUBJECT  
FINAL ACCEPTANCE FOR TRANSFER

AUG 28 2015

JOHN E. PETALAS  
LAKE COUNTY AUDITOR

014864

ck. 16. 01162 DW