

2

STATE OF INDIANA
LAKE COUNTY
FILED FOR RECORD

2015 032542

2015 MAY 28 AM 9:20

MICHAEL B. BROWN
RECORDER

Mail Tax Bills to:

Parcel No. 45-09-17-276-001,000-021

3232 Central ave.
Lake Station In.
46405

QUITCLAIM DEED

THIS INDENTURE WITNESSETH, that NASER MUSLEH, GRANTOR(S)
of Lake County in the State of Indiana

QUITCLAIM(S) to GRANTEE(S) 3232 CENTRAL AVENUE, LLC

of Lake County in the State of Indiana

in consideration of One Dollar (\$1.00) and other valuable consideration, the receipt and sufficiency of which are hereby acknowledged, the following described real estate in Lake County, in the State of Indiana:

see attached legal description

Commonly known as: 3400 CENTRAL AVE, LAKE STATION, IN 46405
Grantee's address: 3232 Central Avenue, Lake Station In. 46405

NORTHWEST INDIANA TITLE
162 WASHINGTON STREET
LOWELL, IN 46356
219-696-0100
21390

Dated this 21st day of May, 2015.

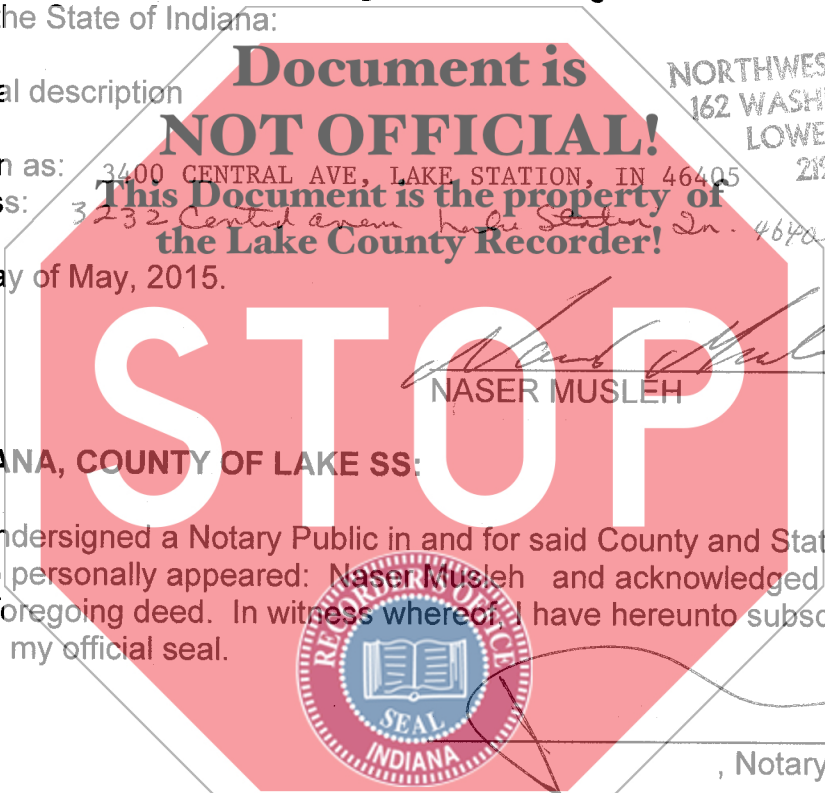

Naser Musleh

NASER MUSLEH

STATE OF INDIANA, COUNTY OF LAKE SS:

Before me, the undersigned a Notary Public in and for said County and State, this 21st day of May, 2015 personally appeared: Naser Musleh and acknowledged the execution of the foregoing deed. In witness whereof, I have hereunto subscribed my name and affixed my official seal.



Richard A. Zunica

, Notary Public

I affirm under the penalties for perjury that I have taken reasonable care to redact each social security number in this document unless required by law.

This Instrument prepared by: Attorney Richard A. Zunica, 162 Washington, Lowell, In 46356

NO CONSIDERATION
File No. 15-21390/sd

RICHARD A. ZUNICA
NOTARY PUBLIC
SEAL
Porter County, State of Indiana
My Commission Expires August 31, 2022

NO SALES DISCLOSURE NEEDED

DULY ENTERED FOR TAXATION SUBJECT
FINAL ACCEPTANCE FOR TRANSFER

Approved Assessor's Office

MAY 25 2015

By: _____

JOHN E. PETALAS
LAKE COUNTY AUDITOR

AMOUNT \$ 18.00
CASH _____ CHARGE _____
CHECK # ~~200~~ 2103
OVERAGE _____
COPY _____
NON-COM _____
CLERK M.E

20600

That part of the Northeast Quarter of Section 17, Township 36 North, Range 7 West of the Second Principal Meridian, in the City of East Gary, in the County of Lake, in the State of Indiana, described as a strip of land 20 feet in width lying Northerly of and contiguous with a line drawn 220 feet North of and parallel with the North line of Central Avenue, Easterly of the East line of Pike Street and Westerly of a line drawn at right angles to the North line of Central Avenue at a point 200 feet Southwesterly measured along said North line of Central Avenue from the East line of said Section 17, Township 36 North, Range 7.

