

STATE OF INDIANA  
LAKE COUNTY  
FILED FOR RECORD

2015 027724

2015 MAY -8 AM 10:11

MICHAEL B. BROWN  
RECORDER

2

**WARRANTY DEED**

**THIS INDENTURE WITNESSETH**, That Charles R. Johnsten (Grantor) **CONVEY(S) AND WARRANT(S)** to Catherine J. Greenberg and Donald Greenberg, wife and husband, (Grantee) for the sum of Ten Dollars (\$10.00) and other valuable consideration, the receipt and sufficiency of which are hereby acknowledged, the following described real estate in Lake County, State of Indiana:

Lot 12 in Courtney Estates, in the City of Crown Point, as per plat thereof, recorded in Plat Book 68 page 24, in the Office of the Recorder of Lake County, Indiana.

**Property Address:** 788 Courtney Dr., Crown Point, IN 46307-4364

**Tax ID No.:** 45-16-17-232-012.000-042

**Subject to current taxes not delinquent**, and all easements, agreements and restrictions of record and all public rights of way.

IN WITNESS WHEREOF, Grantor has executed this deed on the 30th day of April, 2015.

  
Charles R. Johnsten

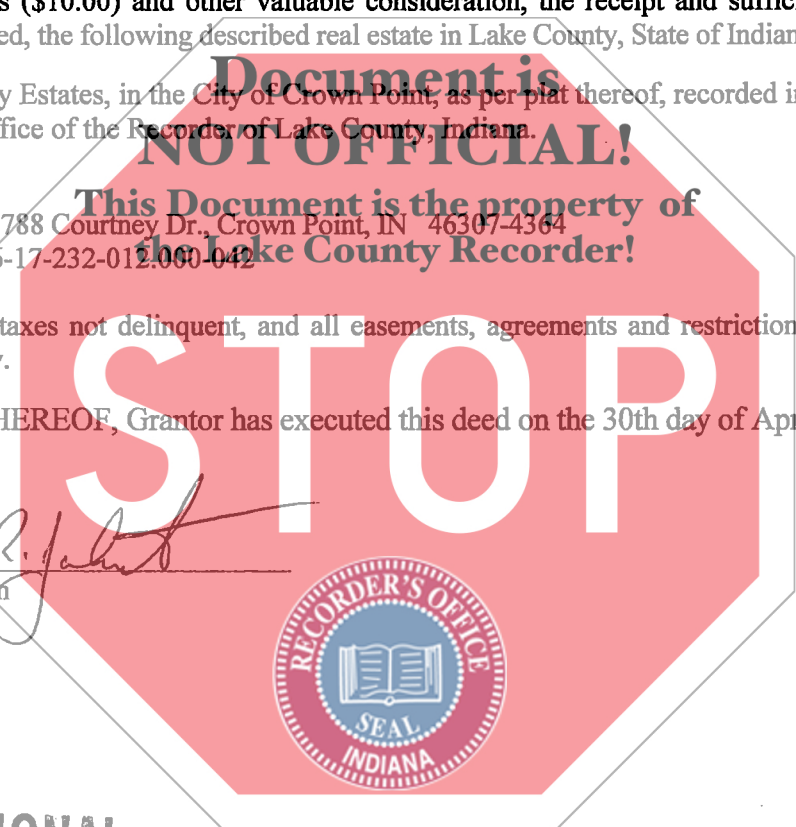

**FIDELITY NATIONAL  
TITLE COMPANY**

FB1500266

DULY ENTERED FOR TAXATION SUBJECT  
FINAL ACCEPTANCE FOR TRANSFER

011935

MAY 04 2015

JOHN E. PETALAS  
LAKE COUNTY AUDITOR

18  
2015  
2

STATE OF Indiana

)  
) SS.  
)

COUNTY OF Lake

Before me, a Notary Public in and for said County and State, personally appeared Charles R. Johnsten who acknowledged the execution of the foregoing deed.

Witness my hand and notarial seal on the 30th day of April, 2015.

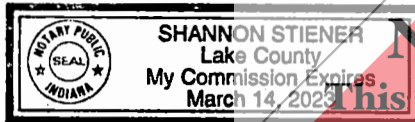

Document is

**NOT OFFICIAL!**

Notary Public: Shannon Stiener  
Resident of Lake County  
My Commission expires: 3/14/2023

This Document is the property of  
the Lake County Recorder!

Prepared by: Timothy R. Kuiper, Attorney at Law

Grantee's Address and Tax Billing Address:  
788 Courtney Dr., Crown Point, IN 46307-4364

I affirm, under penalties for perjury, that I have taken reasonable care to redact each Social Security number in this document, unless required by law Shannon Stiener. File No. FB1500266

