

3

STATE OF INDIANA
LAKE COUNTY
FILED FOR RECORD

2015 APR 21 AM 9:05

2015 023646

MICHAEL B. BROWN
RECORDER

**NOTICE OF
FIRST RIGHT OF
REFUSAL**

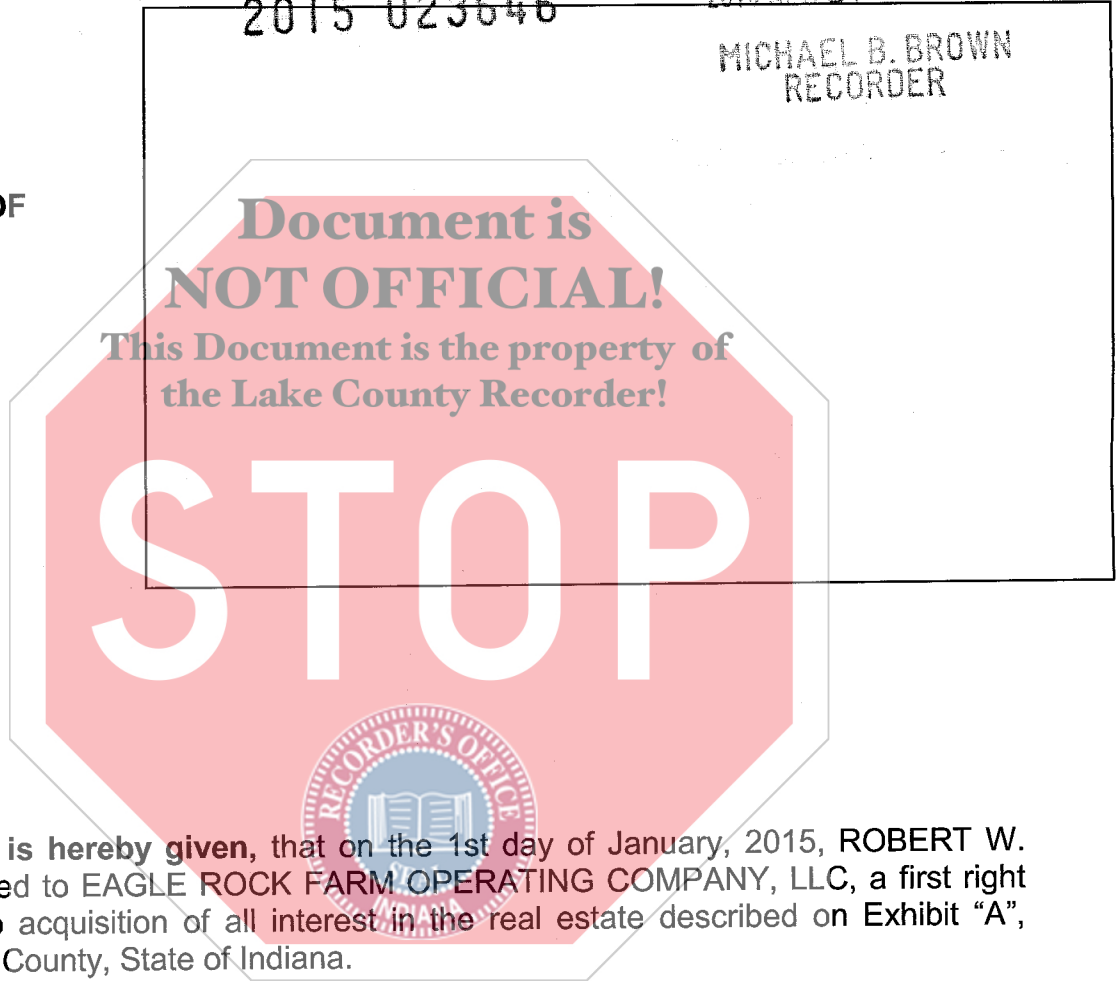

NOTICE is hereby given, that on the 1st day of January, 2015, ROBERT W. HAYDEN granted to EAGLE ROCK FARM OPERATING COMPANY, LLC, a first right of refusal as to acquisition of all interest in the real estate described on Exhibit "A", located in Lake County, State of Indiana.

Dated this 1st day of January, 2015.

BY:

Robert W. Hayden

Robert W. Hayden

15

CK#
23932

✓

30v

E

STATE OF ILLINOIS)
) SS:
COUNTY OF EDGAR)

I, the undersigned, a Notary Public, in and for said County, in the State aforesaid, **DO HEREBY CERTIFY THAT ROBERT W. HAYDEN**, personally known to me to be the same person whose name is subscribed to the foregoing instrument, appeared before me this day in person and acknowledged the above and foregoing instrument as his free and voluntary acts and deeds, for the uses and purposes therein set forth.

Given under my hand and Notarial Seal this 1st day of January, 2015.

Document is NOT OFFICIAL.

This Document is the property of the Lake County Recorder!

STOP

RECORDER'S OFFICE
SEAL
INDIANA

"OFFICIAL SEAL"
KRISTA J. KRABEL
Notary Public, State of Illinois
My Commission Exp. 3-21-16

Notary Public

This instrument was prepared by: DAVID M. FRISSE, ATTORNEY
Return this document to: FRISSE & BREWSTER LAW OFFICES
P.O. Box 430
Paris, IL 61944
(217) 465-1234

EXHIBIT A

Part of the East Thirty (30) acres of the Northeast Quarter of Section 25, Township 33 North, Range 8 West of the Second Principal Meridian, in Eagle Creek Township, Lake County, Indiana, being more particularly described as follows:

Beginning at a point on the east line of said Section 25 which is 784.6 feet South of the Northeast corner of said Section 25, being the Northeast corner of a tract conveyed to Jerry C. and Susan J. Hayden in Instrument Number 2004-029699 in the Office of the Recorder of Lake County, Indiana; thence continuing South 00°00'00" East, along the East line of the Northeast corner of said Section 25, also being the East line of said "Hayden" tract, a distance of 182.53; thence South 89°00'00" West, a distance of 108.60 feet; thence North 40°15'02" West, a distance of 111.02 feet; thence North 02°03'17" West, a distance of 97.86 feet, to a point on the North line of said "Hayden" tract; thence North 90°00'00" East, along the north line of said "Hayden" tract, being perpendicular to the aforesaid East line of said Section 25, a distance of 183.84 feet, to the Point of Beginning; Containing 0.690 Acres, more or less, all in Eagle Creek Township, Lake County, Indiana.

