

3
3

Reference: 2014 082643
45-11-24-228-001.000-036
45-11-24-277-001.000-036

STATE OF INDIANA
LAKE COUNTY
FILED FOR RECORD

2014 DEC 29 PM 12:00

MICHAEL B. BROWN
RECORDER

4791966100m

**PARTIAL RELEASE OF
CONSTRUCTION MORTGAGE, ASSIGNMENT OF RENTS AND LEASES,
SECURITY AGREEMENT AND FIXTURE FINANCING STATEMENT
AND
ASSIGNMENT OF RENTS AND LEASES**

Reference is made to those certain:

(i) Construction Mortgage, Assignment of Rents and Leases, Security Agreement and Fixture Financing Statement dated as of July 16, 2007, and recorded in the Office of the Recorder of Lake County, Indiana, on July 24, 2007, as Instrument Number 2007-060213; and

(ii) Assignment of Rents and Leases dated July 16, 2007 and recorded in the Office of the Recorder of Lake County, Indiana, on July 24, 2007, as Instrument Number 2007-060214

(collectively, the "Encumbrances"), whereby a mortgage interest and other interests in certain real property situated in Lake County, Indiana, as described therein, were granted by **GCC Merrillville Venture, LLC ("GCC") to MB Financial Bank, as successor in interest to New Century Bank** (collectively, "MB Bank").

In consideration of the payment of One Dollar and other good and valuable consideration by GCC, to MB Bank, the receipt and sufficiency of which are hereby acknowledged, MB Bank hereby releases from the lien of the Encumbrances the parcel of real property described hereinbelow:

All that part of the Northeast ¼ of Section 24, Township 35 North, Range 9 West of the 2nd P.M., lying east of the east right-of-way line of the Chicago and Erie railroad, located in Lake County, Indiana, containing 17.35 acres, more or less,

together with all the appurtenances and privileges thereunto belonging or appertaining.

THIS IS A PARTIAL RELEASE ONLY AND NO PROPERTY ENCUMBERED BY THE FOREGOING DOCUMENT, OTHER THAN THAT PORTION OF THE REAL PROPERTY ENCUMBERED BY THE MORTGAGE DESCRIBED ON EXHIBIT A ATTACHED HERETO, IS BEING RELEASED, SAID DOCUMENTS REMAINING IN FULL FORCE AND EFFECT WITH REGARD TO ALL OTHER PORTIONS OF THE REAL PROPERTY ENCUMBERED BY THE MORTGAGE.

1 Ret
\$ 18.00
non-com
M-E
C-T

CHICAGO TITLE INSURANCE COMPANY

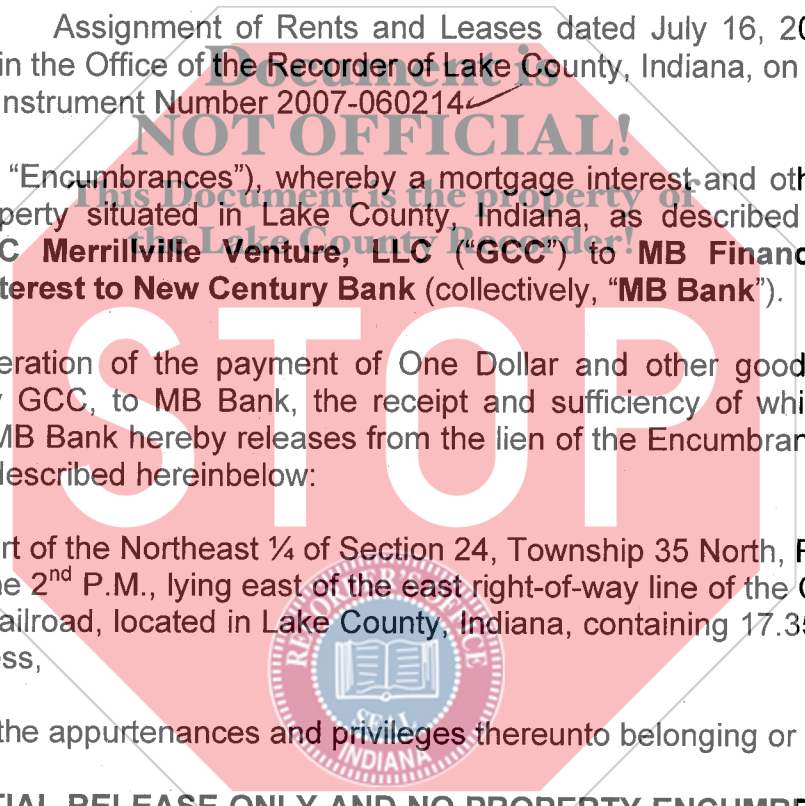

IN WITNESS WHEREOF, MB Bank has caused this Partial Release of Construction Mortgage, Assignment of Rents and Leases, Security Agreement and Fixture Financing Statement and Assignment of Rents and Leases as of the date below written.

Dated December 16, 2014

MB FINANCIAL BANK, as successor in interest to New Century Bank

By: [Signature]
Print Name: Linda Weber
Title: SVP

STATE OF Illinois)
COUNTY OF Cook)

SS:

Before me, the undersigned, a Notary Public in and for said County and State on December 16, 2014, personally appeared Linda Weber, personally known to me to be the same person whose name is subscribed to the foregoing Release of Construction Mortgage, Assignment of Rents and Leases, Security Agreement and Fixture Financing Statement and Assignment of Rents and Leases as _____ of MB Financial Bank, and being first duly sworn by me upon oath, acknowledged that such person has read and understands the foregoing and that such person has affixed such person's name to and delivered the foregoing as such person's own free and voluntary act and as the free and voluntary act of said entity for the uses and purposes therein set forth.

IN WITNESS WHEREOF, I have hereunto subscribed my name and affixed my official seal.

My Commission Expires: 3/23/2015 County of Residence: Cook
[Signature] Notary Public

I affirm, under the penalties of perjury, that I have taken reasonable care to redact each Social Security number in this document, unless required by law. Lee I. Lane

Prepared by and upon recording return to: Lee I. Lane
Genetos Retson & Yoon LLP
1000 E. 80th Place, Suite 555 North
Merrillville, Indiana 46410

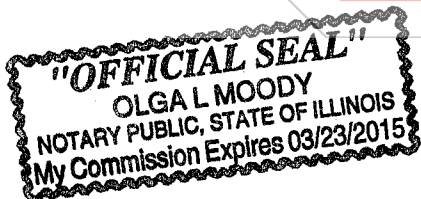

Exhibit "A"

Real Property Released

All that part of the Northeast $\frac{1}{4}$ of Section 24, Township 35 North, Range 9 West of the 2nd P.M., lying east of the east right-of-way line of the Chicago and Erie railroad, located in Lake County, Indiana, containing 17.35 acres, more or less

