

STATE OF INDIANA
LAKE COUNTY
FILED FOR RECORD

2014 080041

2014 DEC 16 PM 1:41

MICHAEL D. BROWN

Tax Parcel No. ~~RECORDED~~ 82-016.000-023

Mail tax bills to:
Claudia E. Hernandez
248-250 Fernwood Ave.
Hammond, IN 46324
(Grantee Address)

QUIT-CLAIM DEED

This indenture witnesseth that Epitacio Hernandez Tovar of Lake County in the State of Indiana

Releases and quit claims to Claudia E. Hernandez of Lake County in the State of Indiana for and in consideration of Ten Dollars (\$10.00) and other good and valuable consideration, the receipt whereof is hereby acknowledged, the following Real Estate in Lake County in the State of Indiana, to wit:

Lot 9, in Resubdivision of Lots 1 and 4 of Oak Park Addition to Hammond, as per plat thereof, recorded in Plat Book 17 Page 18, in the Office of the Recorder of Lake County, Indiana.

Commonly known as: 248-250 Fernwood Avenue, Hammond, IN 46324

State of Indiana, Lake County, SS: Dated this 12th Day of December, 2014.

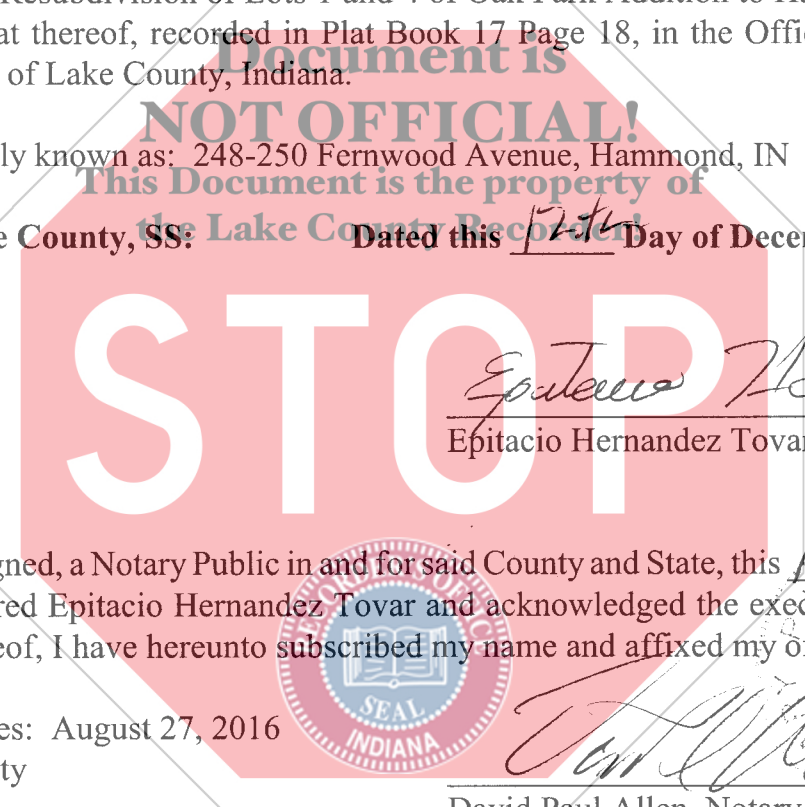

Epitacio Hernandez
Epitacio Hernandez Tovar

Before me, the undersigned, a Notary Public in and for said County and State, this 12th day of December, 2014 personally appeared Epitacio Hernandez Tovar and acknowledged the execution of the foregoing deed. In witness whereof, I have hereunto subscribed my name and affixed my official seal.

My Commission Expires: August 27, 2016
Resident of Lake County

David Paul Allen
David Paul Allen, Notary Public

I affirm under the penalties for perjury, that I have taken reasonable care to redact each Social Security number in this document, unless required by law.

David Paul Allen

This instrument prepared by David Paul Allen, Attorney at Law, 5930 Hohman Ave., Suite 204, Hammond, IN 46320 (219) 931-7275

Return to: David Paul Allen, Attorney at Law, 5930 Hohman Ave., Suite 204, Hammond, IN 46320

FILED FOR RECORD
FINAL ACCEPTANCE FOR TRANSFER

DEC 16 2014

PEGGY HOLINGA KATONA
LAKE COUNTY AUDITOR

28794

\$16
CS

NO SALES DISCLOSURE NEEDED

Approved Assessor's Office

By: *ma*

CA