

2

STATE OF INDIANA
LAKE COUNTY
FILED FOR RECORD

2014 051212

2014 AUG 26 AM 11:08

MICHAEL B. BROWN
RECORDER

WARRANTY DEED

THIS INDENTURE WITNESSETH, That Andrzej Zeglin (Grantor) **CONVEY(S) AND WARRANT(S)** to Krzysztof Bialas (Grantee) for the sum of Ten Dollars (\$10.00) and other valuable consideration, the receipt and sufficiency of which are hereby acknowledged, the following described real estate in Lake County, State of Indiana:

SEE ATTACHED EXHIBIT "A"

Property Address: 4101 Howard Street, Hobart, IN 46342
Tax ID No.: 45-08-26-330-002.000-018

Subject to current taxes not delinquent, and all easements, agreements and restrictions of record and all public rights of way.

IN WITNESS WHEREOF, Grantor has executed this deed on the 7th day of August, 2014.

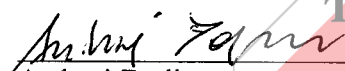

Andrzej Zeglin

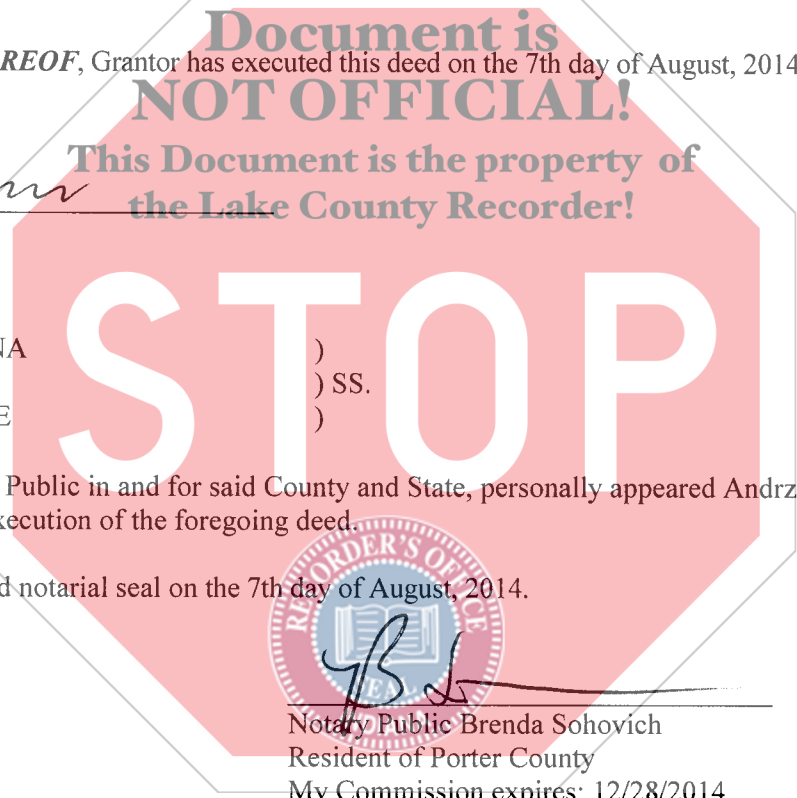

STATE OF INDIANA)
) SS.
COUNTY OF LAKE)

Before me, a Notary Public in and for said County and State, personally appeared Andrzej Zeglin who acknowledged the execution of the foregoing deed.

Witness my hand and notarial seal on the 7th day of August, 2014.

Notary Public Brenda Sohovich
Resident of Porter County
My Commission expires: 12/28/2014

Prepared by: Dena Phillips Farling for the benefit of Chicago Title Company, LLC

Grantee's Address and Tax Billing Address:

8200g mason
BURBANK IL 60458

I affirm, under penalties for perjury, that I have taken reasonable care to redact each Social Security number in this document, unless required by law

Leslene Kurdalak. File No. 1403286

\$18
CT
E

DULY ENTERED FOR TAXATION SUBJECT
FINAL ACCEPTANCE FOR TRANSFER

AUG 22 2014

PEGGY HOLINGA KATONA
LAKE COUNTY AUDITOR

6

03741

Exhibit "A"

File No. 1403286

THE FOLLOWING DESCRIBED REAL ESTATE IN LAKE COUNTY, INDIANA:

THE NORTH 1/2 OF THE EAST 1/2 OF THE EAST 1/2 OF THE NORTHEAST 1/4 OF THE SOUTHWEST 1/4 OF SECTION 26, TOWNSHIP 36 NORTH, RANGE 8 WEST OF THE 2ND PRINCIPAL MERIDIAN, EXCEPT THE NORTH 30 FEET OF THEREOF, AND ALSO EXCEPT THAT PART LYING WITHIN THE FOLLOWING DESCRIBED PARCEL, TO-WIT: PART OF THE EAST HALF OF THE NORTHEAST QUARTER OF THE SOUTHWEST QUARTER OF SECTION 26, TOWNSHIP 36 NORTH, RANGE 8 WEST OF THE 2ND PRINCIPAL MERIDIAN, DESCRIBED AS FOLLOWS: COMMENCING AT A POINT ON THE EAST LINE OF SAID TRACT WHICH IS 630 FEET SOUTH OF THE NORTHEAST CORNER THEREOF AND RUNNING THENCE SOUTH ALONG THE EAST LINE OF SAID TRACT 690 FEET; THENCE WEST 298 FEET, THENCE NORTH 690 FEET THENCE EAST 298 FEET TO THE PLACE OF BEGINNING.

NOT OFFICIAL!

**This Document is the property of
the Lake County Recorder!**

Return to: _____

STOP

