

SWORN STATEMENT OF INTENTION TO HOLD LIEN (NOTICE OF MECHANIC'S LIEN)

To: PHILIP BARBERCHECK
528 E. JOLIET ST, CROWN POINT, IN 46307
Owner's Name and Address

State of Indiana, County of LAKE ss

The undersigned, being first duly sworn, makes this sworn statement of intention to hold a lien upon the property described below and says that:

1. The undersigned AIR TECH COMFORT SYSTEMS, INC
9021 W. 141st Ave, CEDAR LAKE, IN 46303

intends to hold a lien on land legally described as follows:

RAILROAD ADD. BL. 16 W. 1/2 OF LOTS 1 &

2014 026397

and commonly known as:

302 E. PORTER CROWN POINT
Street City

as well as on all building, other structures and improvements located thereon or connected therewith for work and labor done and/or materials and machinery furnished by the undersigned in the erection, construction, altering, repairing, and removing of said buildings, structures, and improvements.

2. The amount claimed under this statement is ONE THOUSAND EIGHT HUNDRED DOLLARS (\$1800.00)

3. The work and labor were done, and the materials and machinery were furnished by the undersigned within the last sixty (60) days.

STATE OF INDIANA
LAKE COUNTY
FILED FOR RECORD
2014 MAY 9 PM 1:00
MICHAEL PEROM
RECORDER

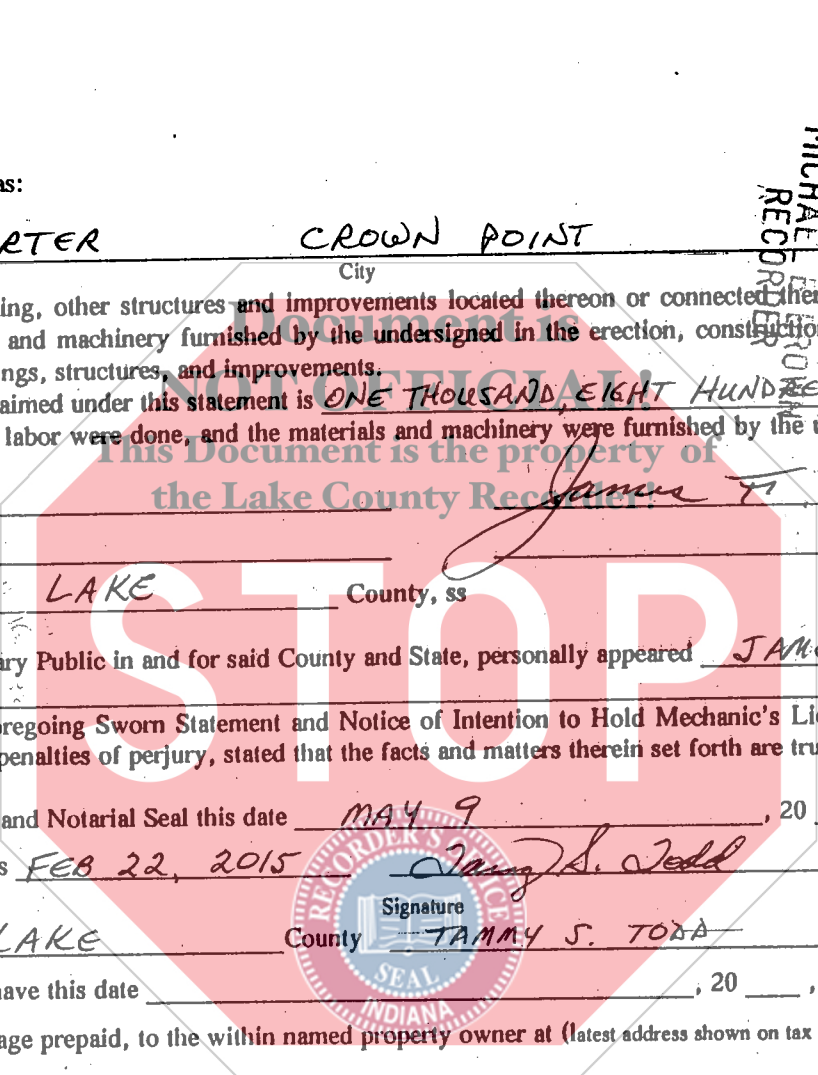

State of Indiana, LAKE County, ss

Before me, a Notary Public in and for said County and State, personally appeared JAMES F. TODD who acknowledged the execution of the foregoing Sworn Statement and Notice of Intention to Hold Mechanic's Lien, and who, having been duly sworn, under the penalties of perjury, stated that the facts and matters therein set forth are true and correct.

Witness my hand and Notarial Seal this date MAY 9, 20 14.

My commission expires FEB 22, 2015 Tammy S. Todd Notary Public

Resident of LAKE County TAMMY S. TODD (Printed)

I hereby certify that I have this date _____, 20____, mailed a duplicate of this notice, first class, postage prepaid, to the within named property owner at (latest address shown on tax records) _____

Recorder of _____ County

This instrument prepared by: TAMMY S. TODD Resident of LAKE County

IC 1400 num. 10522 RM