

2

STATE OF INDIANA  
LAKE COUNTY  
FILED FOR RECORD

2014 014993

2014 MAR 13 PM 2: 04

MICHAEL B. BROWN  
RECORDER

NOTICE OF LIEN

COPY

To: Jeremy Charles and Gina N. Charles  
810 James Court  
Crown Point, IN 46307

The Board of Directors of the Ellendale Farm Property Owners' Association, Inc. files a notice of the existence of a lien pursuant to the Declaration of Covenants, Conditions, Easements, and Restrictions of Ellendale Farm Subdivision, recorded in the Office of the Lake County Recorder on March 31, 1997, as Document No. 97018695, as amended from time to time. The charge is levied upon the following real estate:

Lot 101 in Ellendale Farm Unit Five, In the City of Crown Point, as per plat thereof, recorded in Plat Book 89 page 76, In the Office of the Recorder of Lake County, Indiana

More commonly known as 810 James Court, Crown Point, IN 46307

Parcel No. 45-16-07-477-010.000-042

The amount of the lien as of March 7, 2014, is \$882.00, plus expenses and attorney fees.

March 10, 2014.

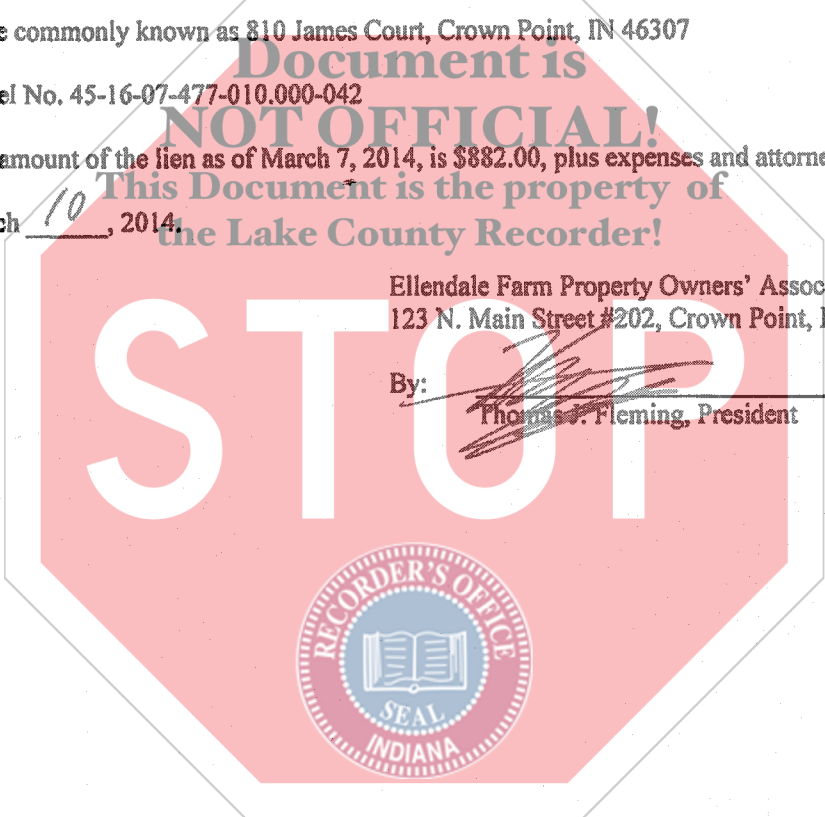

Ellendale Farm Property Owners' Association, Inc.  
123 N. Main Street #202, Crown Point, IN 46307

By:   
Thomas J. Fleming, President

#13  
CK#  
8287  
G  
E

STATE OF INDIANA )  
                          ) SS:  
COUNTY OF LAKE )

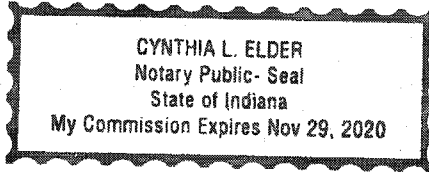

Before me, the undersigned, a Notary in and for said County and State, this <sup>th</sup> 10 day of March, 2014, personally appeared Thomas J. Fleming, and acknowledged the execution of the foregoing document. In witness whereof, I have hereunto subscribed my name and affixed my official seal.

Cynthia L. Elder  
Cynthia L. Elder, Notary Public

County of Residence: Lake

My Commission Expires: Nov. 29, 2020

This instrument prepared by and please return to after recording: Shannon L. Noder, Burke Costanza & Carberry, LLP, 9191 Broadway, Merrillville, Indiana 46410

