

2.5

STATE OF INDIANA
LAKE COUNTY
FILED FOR RECORD

2014 011914

2014 FEB 28 PM 2:40

MICHAEL B. BROWN
RECORDER

QUITCLAIM DEED

THIS QUITCLAIM DEED, Executed this 11th day of Dec ,

2013 (year),

by first party, Grantor,

Susana Ruehman

whose post office address is

5188 Royal Ave. Portage In 46368

to second party, Grantee,

Open door church of god refuge in Christ INC.

whose post office address is

2134 w.5th Ave. Gary In 46404

WITNESSETH, That the said first party, for good consideration and for the sum of one dollar Dollars (\$1.00) paid by the said second party, the receipt whereof

is hereby acknowledged, does hereby remise, release and quitclaim unto the said second party forever, all the right, title, interest and claim which the said first party has in and to the following described parcel of land, and improvements and appurtenances thereto in the County of

Lake , State of Indiana to wit:

Lot 13 in Robert Barlett's East Gary Small Farms , in the city of Lake Station as per Plat thereof recorded better known as 1300 E. 24th Ave. Lake Station In. 46405

Parcel number 45-09-253-001-021

18-000.

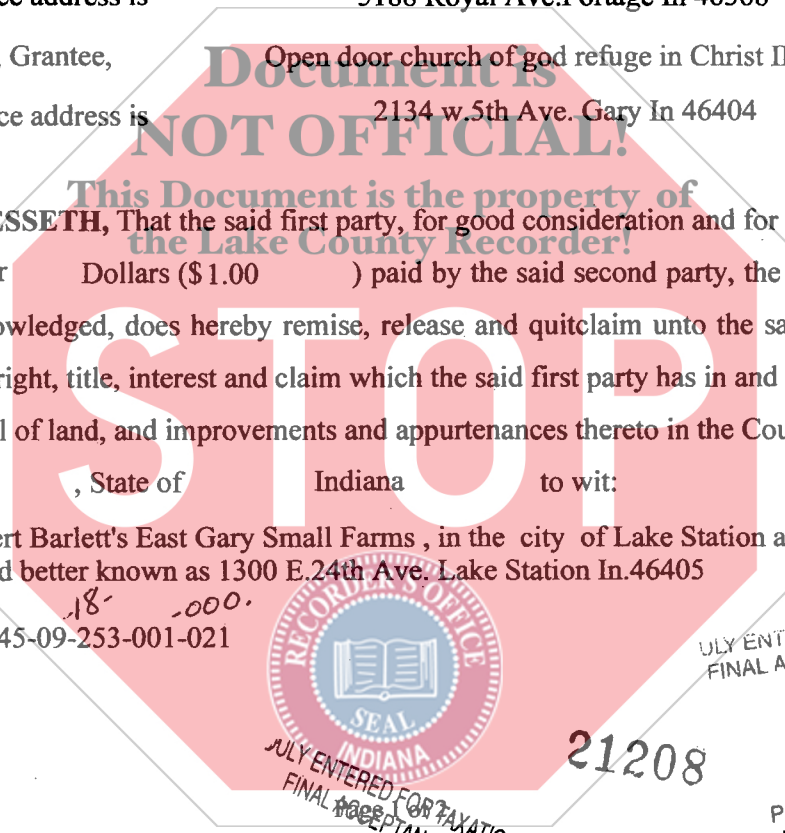

FILED FOR TAXATION SUBJECT
FINAL ACCEPTANCE FOR TRANSFER

FEB 28 2014

PEGGY HOLINGA KATONA
LAKE COUNTY AUDITOR
Initials of First Party

21208

FILED FOR TAXATION SUBJECT
FINAL ACCEPTANCE FOR TRANSFER

FEB 28 2014

PEGGY HOLINGA KATONA
LAKE COUNTY AUDITOR

[Signatures on following page.]

\$18.00
M. E. ASH

IN WITNESS WHEREOF, The said first party has signed and sealed these presents the day and year first above written. Signed, sealed and delivered in presence of:

Randy W. Craig
Signature of Witness

Susana Ruchman
Signature of First Party, Grantor

Randy W. Craig
Print name of Witness

SUSANA RUEHMAN
Print name of First Party

Signature of Witness

Signature of First Party, Grantor

Print name of Witness

Print name of First Party

STATE OF
COUNTY OF
On Feb 22

IN
Porter }

before me,
appeared Susana Ruchman

personally known to me (or proved to me on the basis of satisfactory evidence) to be the person(s) whose name(s) is/are subscribed to the within instrument and acknowledged to me that he/she/they executed the same in his/her/their authorized capacity(ies), and that by his/her/their signature(s) on the instrument the person(s), or the entity upon behalf of which the person(s) acted, executed the instrument.

NOTICE
STOP
This Document is the property of
the Lake County Recorder!

WITNESS my hand and official seal.

[Signature]
Signature of Notary

Affiant Known Produced ID
Type of ID Driver's license

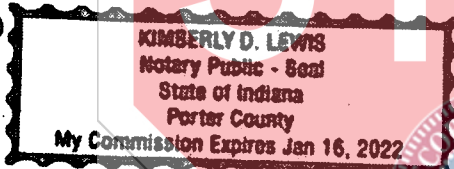
(Seal) 



Signature of Preparer

Print Name of Preparer

Address of Preparer

SAR
Initials of First Party