

3

WARRANTY DEED
Indiana Statutory
LLC to CORPORATION

THE GRANTOR, **THREE CREEKS MEADOW, LLC**, a Limited Liability Company created and existing under and by virtue of the laws of the State of Indiana and duly authorized to transact business in the State of Indiana, of the Village of Steger, County of Will, State of Illinois, for and in consideration of TEN and NO/100 DOLLARS (\$10.00) in hand paid, and pursuant to authority given by the Members of said Company, CONVEYS and WARRANTS to: **LOWELL FIRST ASSEMBLY OF GOD, INC.**, of 1601 Northview Drive, Lowell, IN 46356, created and existing under and by virtue of the laws of the State of Indiana and duly authorized to transact business in the State of Indiana, the following described Real Estate situated in the County of Lake, in the State of Indiana, to-wit:

CRICOM 13584

SEE LEGAL DESCRIPTION ATTACHED HERETO AND MADE A PART HEREOF AND IDENTIFIED AS EXHIBIT "A"

THIS INSTRUMENT IS SUBJECT TO: general taxes not due and payable at the time of closing; building lines and building laws and ordinances, use or occupancy restrictions, conditions and covenants of record; zoning laws and ordinances which conform to the present usage of the premises; public and utility easements which serve the premises; public roads and highways, if any; party wall rights and agreements, if any.

TAX I.D. #: 45-19-25-451-001.000-008 and 45-19-36-201-001.000-008

~~PIN NO: /45/15/03-400-027,000-015/~~

PROPERTY ADDRESS: 23.75 Acres, Belshaw Road, Lowell, IN 46356

DATED this twenty ninth (29th) day of October, 2013.

IN WITNESS WHEREOF, said Grantor has caused its company seal to be hereto affixed, and has caused its name to be signed to these presents by its Managers, this twenty ninth (29th) day of October, 2013.

THREE CREEKS MEADOW, LLC

BY: *Charles G. Lotton*
CHARLES G. LOTTON, Manager

BY: *Jonathan C. Lotton*
JONATHAN C. LOTTON, Manager

STATE OF ILLINOIS, COUNTY OF COOK SS. I, the undersigned, a Notary Public in and for said County, in the State aforesaid, DO HEREBY CERTIFY that CHARLES G. LOTTON and JONATHAN C. LOTTON, personally known to me to be the Managers of said limited liability company, and personally known to me to be the same persons whose names are subscribed to the foregoing instrument, appeared before me this day in person, and acknowledged that as such Managers they signed, sealed and delivered the said instrument, pursuant to authority given by the Members of said company, as their free and voluntary act and deed of said company, for the uses and purposes therein set forth.

Given my hand and official seal, this twenty ninth (29th) day of October, 2013.

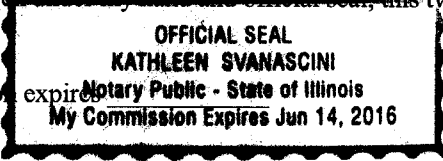

Commission expires

Kathleen Svanascini
NOTARY PUBLIC
DULY ENTERED FOR TAXATION SUBJECT
FINAL ACCEPTANCE FOR TRANSFER

FEB 21 2014

21014

PEGGY HOLINGA KATONA
LAKE COUNTY AUDITOR

1305896

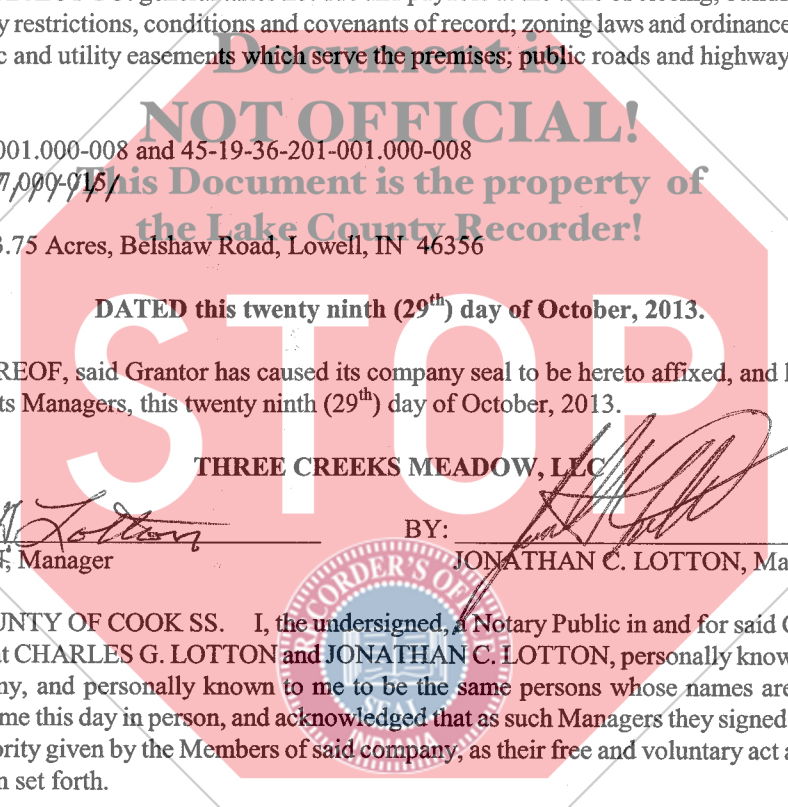

CHICAGO TITLE INSURANCE COMPANY

STATE OF INDIANA
LAKE COUNTY
FILED FOR RECORD

2014 011110

2014 FEB 25 AM 10:40

MICHAEL B. BROWN
RECORDER

\$20

CT

CA

THIS INSTRUMENT WAS PREPARED BY: ANTHONY G. CATULLO, 18141 Dixie Highway, Suite 108, Homewood, IL 60430
SEND TAX BILLS TO: LOWELL FIRST ASSEMBLY OF GOD, INC., 1601 Northview Drive, Lowell, IN 46356
MAIL TO: LOWELL FIRST ASSEMBLY OF GOD, INC., 1601 Northview Drive, Lowell, IN 46356

I, undersigned, affirm under the penalties from perjury, that I have taken reasonable care to redact each Social Security number in this document, unless required by law.



ANTHONY G. CATULLO



EXHIBIT A

Parcel 1:

Part of the Southwest Quarter of the Southeast Quarter of Section 25, and part of the Northwest Quarter of the Northeast Quarter of Section 36, both in Township 33 North, Range 9 West of the Second Principal Meridian, in Lake County, Indiana, more particularly described as follows: Commencing at a point which is 40 rods North and 33 rods West of the Southeast corner of the Southwest Quarter of the Southeast Quarter of Section 25, being the Northwest corner of the 10 acres deeded to Vandecar; thence running North 40 rods to the North line of said Southwest Quarter of the Southeast Quarter; thence West about 35-1/2 rods, or far enough to include 23.75 acres within the boundaries herein described; thence South to the center of the public highway known as the State Road; thence Northeasterly along the center of said road to the Southwest corner of said Vandecar Lot; thence North to the place of beginning, in Lake County, Indiana.

Parcel 2:

Lots 1 and 2, in Eastdale Estates, Unit No. 1, being a subdivision of part of Outlot "C", Eastdale, in the Town of Lowell, as shown in Plat Book 36, page 64, in Lake County, Indiana.

