

2014 009228

2014 FEB 18 AM 11:32

MICHAEL B. BROWN
RECORDER

LF298-04
R298-04

QUITCLAIM DEED

THIS QUITCLAIM DEED, executed this 18th day of February, 2014,
 by first party, Grantor, Rena E. Schueberg
 whose post office address is 6647 Arkansas (Rear Apartment), Hammond, IN 46323
 to second party, Grantee, Steven W. Schueberg
 whose post office address is 3335 Orchard Drive Hammond, IN 46323

FILED FOR TAXATION SUBJECT TO FINAL ACCEPTANCE FOR TRANSFER

FEB 18 2014

PEGGY HOLINGA KATONA
LAKE COUNTY AUDITOR

WITNESSETH, That the said first party, for good consideration and for the sum of Ten Dollars (\$ 10.00)
 paid by the said second party, the receipt whereof is hereby acknowledged, does hereby remise, release
 and quitclaim unto the said second party forever, all the right, title, interest and claim which the said first
 party has in and to the following described parcel of land, and improvements and appurtenances thereto in
 the County of Lake, State of Indiana to wit:

Parcel No: 45-07-15-101-024.000-023

PART OF THE NORTHWEST 1/4 OF THE NORTHWEST 1/4 OF SECTION 15,
 TOWNSHIP 36 NORTH, RANGE 9 west of the 2ND PRINCIPAL MERIDIAN
 IN LAKE COUNTY, INDIANA, DESCRIBED AS FOLLOWS: beginning at a
 POINT IN THE CENTER LINE OF BLACK OAK ROAD 1151.6 FEET,
 MEASURED SOUTHEASTERLY ALONG THE CENTER LINE OF SAID BLACK OAK
 ROAD, FROM THE WEST LINE OF SAID SECTION 15; THENCE NORTHERLY
 ON A LINE PARALLEL TO THE EAST LINE OF SAID NORTHWEST 1/4 OF
 THE NORTHWEST 1/4 OF SECTION 15, 275.90 FEET; THENCE EASTERLY
 ON A LINE PARALLEL TO THE NORTH LINE OF SAID SECTION 15; 70ft.
 THENCE SOUTHERLY ON A LINE PARALLEL TO SAID 275.90 FOOT LINE
 314.5 FEET TO THE CENTER LINE OF SAID BLACK OAK ROAD;
 THENCE NORTHWESTERLY 80.8 FEET, ALONG THE CENTER LIEN OF SAID
 BLACK OAK ROAD, TO THE PLACE OF BEGINNING, EXCEPT THEREFROM THE
 SOUTHERLY 30 FEET BY PERPENDICULAR MEASUREMENT FROM THE CENTER
 LINE OF ORCHARD DRIVE (formerly Black Oak Road),

PROPERTY ADDRESS: 3335 ORCHARD DRIVE, HAMMOND, IN 46323 010774

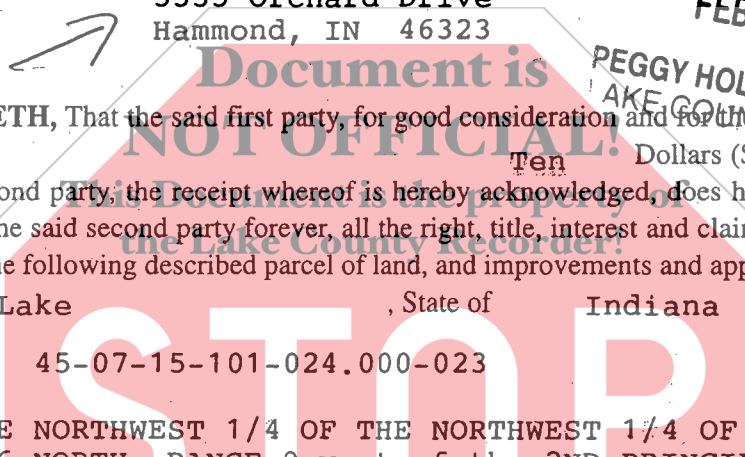

18
CASH

IN WITNESS WHEREOF, The said first party has signed and sealed these presents the day and year first above written. Signed, sealed and delivered in presence of:

John C. Burris
Signature of Witness

JOHN C. BURRIS
Print name of Witness

Signature of Witness

Print name of Witness

Renae E. Schueberg
Signature of First Party

RENAE E. SCHUEBERG
Print name of First Party

Signature of First Party

Print name of First Party

State of Indiana
County of LAKE
On 2-18-11

before me, Renae Schueberg
appeared

personally known to me (or proved to me on the basis of satisfactory evidence) to be the person(s) whose name(s) is/are subscribed to the within instrument and acknowledged to me that he/she/they executed the same in his/her/their authorized capacity(ies), and that by his/her/their signature(s) on the instrument the person(s), or the entity upon behalf of which the person(s) acted, executed the instrument.
WITNESS my hand and official seal.

Tamara S. Simpson
Signature of Notary

Document is NOT OFFICIAL
This Document is the property of the Lake County Recorder!

Affiant _____ Known _____ Produced ID _____
Type of ID DLN
8939-08-137A (Seal)

State of Indiana
County of LAKE
On 2-18-11

before me,

appeared RENAE E. Schueberg
personally known to me (or proved to me on the basis of satisfactory evidence) to be the person(s) whose name(s) is/are subscribed to the within instrument and acknowledged to me that he/she/they executed the same in his/her/their authorized capacity(ies), and that by his/her/their signature(s) on the instrument the person(s), or the entity upon behalf of which the person(s) acted, executed the instrument.
WITNESS my hand and official seal.

Tamara S. Simpson
Signature of Notary



Affiant _____ Known _____ Produced ID _____
Type of ID _____ (Seal)

Tamara S. Simpson
Signature of Preparer

TAMARA SUE SIMPSON
Print Name of Preparer

437 N. BROAD STREET
Address of Preparer GRIFFITH, IN 46319