

2

STATE OF INDIANA
LAKE COUNTY
FILED FOR RECORD

2014 007003

2014 FEB -5 PM 12:47

MICHAEL B. BROWN
RECORDER

MAIL TAX STATEMENTS TO:

Ruben Soto & Sharae Soto
1243 Inverness Ct
Scherverville, IN 46375

SHERIFF'S DEED

THIS INDENTURE WITNESSETH, that John Buncich as Sheriff of Lake County, State of Indiana, conveys to Ruben Soto & Sharae Soto, in consideration of the sum of \$121,000.00, the receipt of which is hereby acknowledged, on sale made by virtue of a decree judgment, issued from Lake Superior Court, Civil Division 7, in the State of Indiana, pursuant to the laws of said State on June 24, 2013, in Cause No. 45D11-1208-MF-00344, wherein Wells Fargo Bank, N.A. was Plaintiff, and Jason E. Surdzial a/k/a Jason Surdzial, Sheryl B. Surdzial a/k/a Sheryl Surdzial, and Crown Ridge Property Owners Association, Inc. were Defendants, in consideration of said sum aforesaid, the following described real estate in Lake County, Indiana, to-wit:

That part of Tract 29 lying Westerly of a line drawn from a point 60.93 feet Westerly (as measured along the northerly line of said Tract 29) of the Northeast corner, to a point on the Southerly line of said Tract 29, said point being 85.95 feet Southwesterly (as measured along the Southerly line thereof, said line being an arc of a circle convex Southeasterly having a radius of 68.25 feet) of the Eastmost point of curve on said Tract 29 and lying Easterly of a line drawn from a point 86.76 feet Westerly (as measured along the Northerly line of said Tract 29) of the northeast corner, to a point on the Southerly line of said Tract 29, said point being 111.91 feet Southwesterly (as measured along the Southerly line thereof, said line being an arc of a circle convex Southeasterly having a radius of 68.25 feet) of the Eastmost point of curve in Crown Ridge Estates Unit Five, a Planned Unit Development in Crown Point, as per plat thereof, recorded in Plat Book 95, page 61, in the Office of the Recorder of Lake County, Indiana.

More commonly known as 9591 Luebcke Ln, Crown Point, IN 46307-6267

Parcel# 45-12-33-254-019.000-129

To have and to hold the premises aforesaid with the privileges and appurtenances to said purchaser, their grantees and assigns, forever, in full and ample manner with all rights, title and interest held or claimed by the aforesaid Defendants.

Subject to assessed but unpaid taxes, not yet delinquent. Subject to all liens, encumbrances and easement of record not otherwise extinguished in the proceedings known as Cause # 45D11-1208-MF-00344 in the Lake Superior Court, Civil Division 7 of the County of Lake, Indiana.

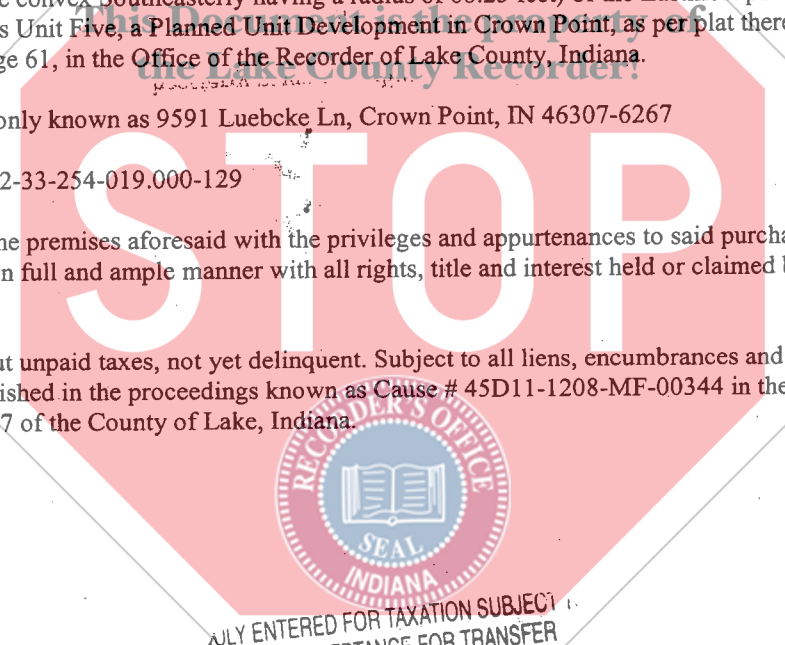

FULLY ENTERED FOR TAXATION SUBJECT
TO FINAL ACCEPTANCE FOR TRANSFER

FEB 05 2014

010595

PEGGY HOLINGA KATONA
LAKE COUNTY AUDITOR

18^{ce}
CS
RN

IN WITNESS WHEREOF, I, THE UNDERSIGNED, Sheriff aforesaid have hereunto set my hand and seal, this 1st day of November, 2013.

STATE OF INDIANA)
)SS:
COUNTY OF LAKE)

SHERIFF OF LAKE COUNTY INDIANA



JOHN BUNCICH

On the 1st day of November, 2013, personally appeared John Buncich in the capacity of Sheriff of said County, and acknowledged the execution of the foregoing deed.

IN WITNESS WHEREOF, I have hereunto set my hand and official seal.

County of Residence Lake

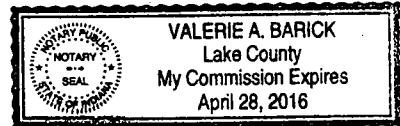
My Commission Expires 4/28/2016



Valerie A. Barick
NOTARY PUBLIC

Valerie A. Barick
Printed Name

**This Document is the property of
the Lake County Recorder!**

Grantee's Address:
Ruben Soto & Sharae Soto
1243 Inverness Ct
Schererville, IN 46375

THIS INSTRUMENT PREPARED BY ROSE K. KLEINDL, ATTORNEY AT LAW

I affirm, under the penalties for perjury, that I have taken reasonable care to redact each Social Security number in this document, unless required by law.

BY: 

Feiwell & Hannoy, P.C.
251 N. Illinois Street, Suite 1700
Indianapolis, IN 46204-1944
073012F01

