

2

2014 005212

STATE OF INDIANA
LAKE COUNTY
FILED FOR RECORD

2014 JAN 29 AM 9:29

MICHAEL D. BROWN
RECORDER

INDIANA

FHA Loan No.: 1518885078703

CORPORATE SPECIAL WARRANTY DEED

THIS INDENTURE WITNESSETH, that Bank of America, N.A. ("Grantor"), a National Association organized and existing under the laws of the United States, CONVEYS AND WARRANTS to The Secretary of Housing and Urban Development of Washington, D.C., whose address is c/o Golden Feather Realty Services, Inc., 180 North LaSalle Street, Suite 1900, Chicago, Illinois 60601; and its successors in such office, as such, as its assigns, for the sum of Ten Dollars (\$10.00) and other good and valuable consideration, the receipt of which is hereby acknowledged, the following described real estate in Lake County, Indiana:

Land situated in the County of Lake, State of Indiana, is described as follows:

Lot 9 in Block 3 in Homestead Gardens Master Addition in the Town of Highland, as per plat thereof, recorded in Plat book 31, page 79 in the Office of the Recorder of Lake County, Indiana.

More commonly known as: 3109 Maple Drive, Highland, IN 46322
Parcel #45-07-21-228-017.000-026

Grantor warrants as to its own acts only, and not further or otherwise. Grantor thus warrants the title to said property against the lawful claims of any and all persons claiming or to claim the same or any part thereof by, through or under Grantor.

The undersigned persons executing this deed on behalf of Grantor represent and certify that they are duly elected officers of Grantor and have been full empowered, by proper resolution of the Board of Directors of Grantor, to execute and deliver this deed; that Grantor has full corporate capacity to convey the real estate described herein; and that all necessary corporate action for the making of such conveyance has been taken and done.

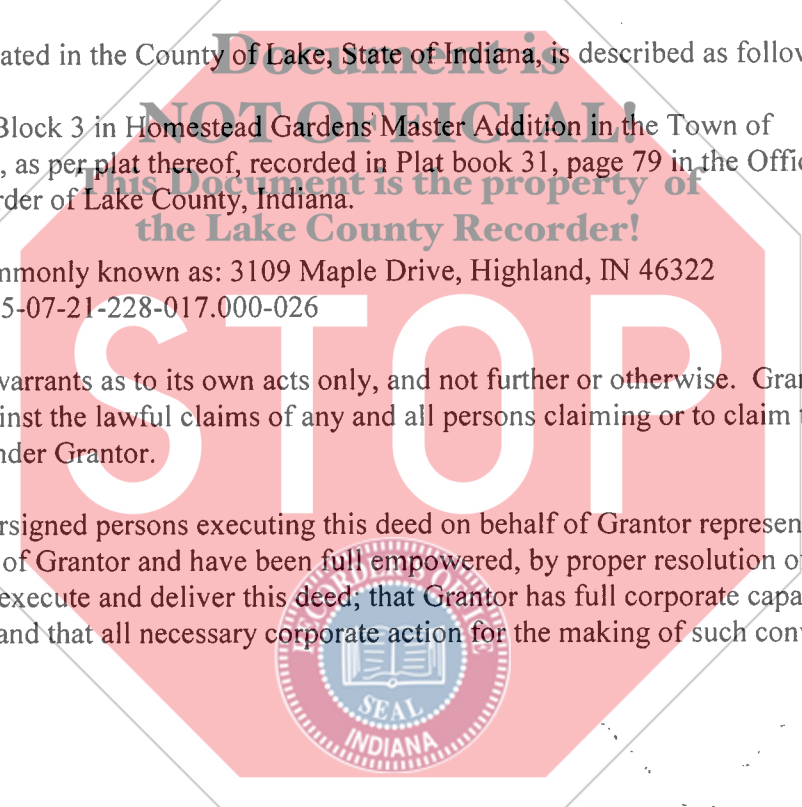

DULY ENTERED FOR TAXATION SUBJECT TO
FINAL ACCEPTANCE FOR TRANSFER

JAN 24 2014

PEGGY HOLINGA KATONA
LAKE COUNTY AUDITOR

010369

12-13856
3109 Maple Drive, Highland, IN 46322
Corporate special Warranty Deed

AMOUNT \$ 18⁰⁰
CASH _____ CHARGE _____
CHECK # 146674
OVERAGE _____
COPY _____
NON-COM _____
CLERK SP

4

