

2014 004931

2014 JAN 24 PM 1:55

MICHAEL B. BROWN
RECORDER

**SWORN STATEMENT OF INTENTION TO HOLD LIEN
(NOTICE OF MECHANIC'S LIEN)**

To: TM & V, LLC
900 Woodlands Pkwy
Vernon Hills, IL 60061

State of Indiana, county of Lake ss:

The undersigned being first duly sworn, makes this sworn statement of intention to hold a lien upon the property described below and says that:

1. The undersigned Graham's Trucking & Excavating, Inc.
P.O. Box 70
Crown Point, IN 46308

intends to hold a lien on land legally described as follows:

For legal description, see Addendum 1.

Parcel #: 45-16-20-351-012.000-041

And commonly known as:

13232 Marshall St Crown Point IN
Street City State

As well as on all building, other structures and improvements located thereon or connected therewith for work and labor done and/or materials and machinery furnished by the undersigned in the erection, construction, altering, repairing, and removing of said buildings, structures and Improvements.

2. The amount claimed under this statement is Forty-eight thousand four hundred ninety dollars & no cents
\$ 48,490.00

3. The work and labor were done, and materials and machinery were furnished by the undersigned within the last sixty (60) days.

Sarah E. Wiese Sarah E. Wiese
Signature Name Printed

State of Indiana, Lake County ss:
Before me a Notary Public in and for said county and State, personally appeared Sarah E. Wiese
Agent and who acknowledged the execution of the foregoing intention to Hold Mechanics Lien.

Witnesseth my hand and seal this 23rd day of January, 20 14.

My commission expires 6/19/2014 Patricia G. Shure Notary Public

Resident of Lake County Patricia G. Shure Name printed

Recorder of Lake County

This instrument was prepared by Sarah E. Wiese, Resident of Lake County

I affirm under penalties of perjury, that I have taken reasonable care to redact each social security in this document, unless required by law.

(Signature) Sarah E. Wiese (Name Printed) Sarah E. Wiese

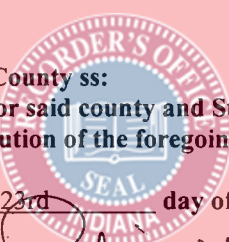
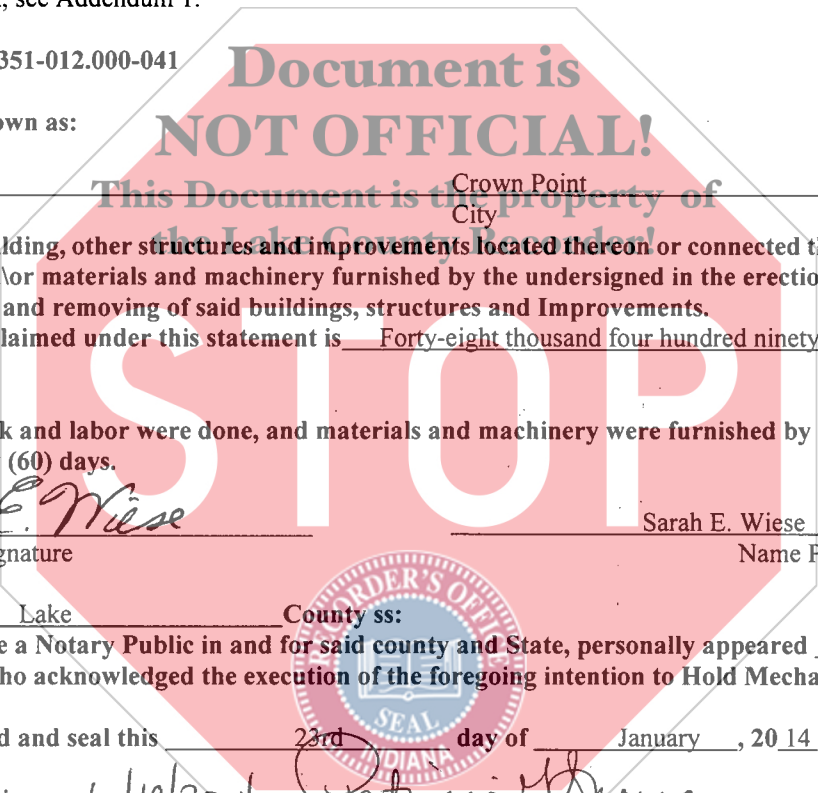

Patricia G. Shure
Notary Public Seal State of Indiana
Lake County
My Commission Expires 06/19/2014

150
CK... 9636
DIN
2. 002 CASH

ADDENDUM 1

Part of the Southwest Quarter of Section 20, Township 34 North, Range 8 West of the Second Principal Meridian, in Lake County, Indiana, more particularly described as follows: Commencing at the Southeast corner of said Section 20; thence along the South line of the Southeast Quarter of said Section, North 89 degrees 44 minutes 59 seconds West, 2646.35 feet, to the Southeast corner of the Southwest Quarter of said Section 20; thence along the South line of said Southwest Quarter, North 89 degrees 51 minutes 53 seconds West, 555.41 feet, to the point of beginning; thence continuing along said South line, North 89 degrees 51 minutes 53 seconds West, 908.67 feet; thence North 00 degrees 06 minutes 22 seconds West, 161.56 feet to a point on a non-tangent curve; thence 28.67 feet Westerly along a curve concave to the North having a radius of 225.00 feet and a chord bearing South 86 degrees 14 minutes 36 seconds West, 28.65 feet to a point of tangency; thence South 89 degrees 53 minutes 38 seconds West, 75.15 feet to a point of curvature; thence 69.65 feet Westerly along a curve concave to the Northeast, having a radius of 200.00 feet and a chord bearing North 80 degrees 07 minutes 47 seconds West, 69.30 feet to a point of tangency; thence North 70 degrees 09 minutes 13 seconds West, 57.19 feet to the centerline of Marshall Street; thence along said centerline North 19 degrees 50 minutes 47 seconds East, 101.12 feet to a point of curvature; thence continuing along said centerline, 119.82 feet Northerly along a curve concave to the West having a radius of 1500.00 feet, a chord bearing North 17 degrees 33 minutes 29 seconds East, 119.79 feet to a point on a non-tangent line; thence South 21 degrees 41 minutes 51 seconds East, 32.86 feet; thence South 49 degrees 50 minutes 11 seconds East 46.70 feet; thence North 89 degrees 52 minutes 03 seconds East, 96.26 feet; thence North 47 degrees 00 minutes 57 seconds East, 680.34 feet; thence North 37 degrees 50 minutes 24 seconds East, 78.33 feet; thence North 20 degrees 52 minutes 18 seconds East, 417.39 feet; thence North 29 degrees 25 minutes 51 seconds East, 95.73 feet; thence North 73 degrees 19 minutes 04 seconds East, 4.46 feet; thence North 20 degrees 41 minutes 40 seconds East, 29.07 feet; thence North 27 degrees 49 minutes 03 seconds East, 74.48 feet; thence North 66 degrees 12 minutes 25 seconds East, 100.44 feet; thence North 32 degrees 17 minutes 12 seconds East, 84.00 feet; thence South 68 degrees 25 minutes 38 seconds East, 48.02 feet; thence South 04 degrees 46 minutes 56 seconds East, 15.46 feet; thence North 87 degrees 25 minutes 34 seconds East, 33.86 feet; thence South 68 degrees 25 minutes 38 seconds East, 59.33 feet; thence South 10 degrees 38 minutes 18 seconds West, 47.65 feet; thence South 06 degrees 24 minutes 05 seconds West, 184.88 feet; thence South 10 degrees 38 minutes 18 seconds West, 89.37 feet; thence South 27 degrees 31 minutes 05 seconds West, 79.54 feet; thence South 11 degrees 08 minutes 35 seconds West, 430.77 feet; thence South 00 degrees 10 minutes 23 seconds East, 304.80 feet; thence South 04 degrees 28 minutes 32 seconds East, 79.64 feet; thence South 09 degrees 08 minutes 18 seconds East, 95.63 feet; thence South 00 degrees 21 minutes 37 seconds East, 203.30 feet to the point of beginning.

