

2

Mail Tax Bills to:  
Bernard P. Chapin  
1500 E. 33<sup>rd</sup> Ave.  
Hobart, IN 46342

STATE OF INDIANA  
LAKE COUNTY  
FILED FOR RECORD

2013 091644

2013 DEC 16 AM 11:30

MICHAEL B. BROWN  
RECORDER

STATE OF INDIANA )  
 ) SS:  
COUNTY OF LAKE )

IN THE LAKE SUPERIOR COURT  
PROBATE DIVISION  
SITTING AT EAST CHICAGO, INDIANA

IN THE MATTER OF THE ESTATE )  
OF: )  
 )  
GLORIA DEIULIUS, )  
Deceased. )

CAUSE NO: 45D02-1305-ES-00043

Filed in Open Court

NOV 26 2013

**PERSONAL REPRESENTATIVE'S DEED**

13M104701

*[Signature]*  
SUPERIOR COURT OF LAKE COUNTY  
CIVIL DIVISION COURT ROOM 3

Denise M. Diaz, as Personal Representative of the estate of Gloria DeJulius a/k/a Gloria J. DeJulius,

deceased, which estate is under the supervision of the Superior Court of Lake County, under cause number 45D02-1305-ES-00043, in the office of the Clerk of the Superior Court of Lake County, Indiana, pursuant to an Order of the Superior Court of Lake County, Indiana, dated the 26<sup>th</sup> day of November, 2013, hereby conveys to Bernard P. Chapin, for the sum of One Dollar (\$1.00), the receipt of which is hereby acknowledged, the following described real estate in Lake County, State of Indiana, to-wit:

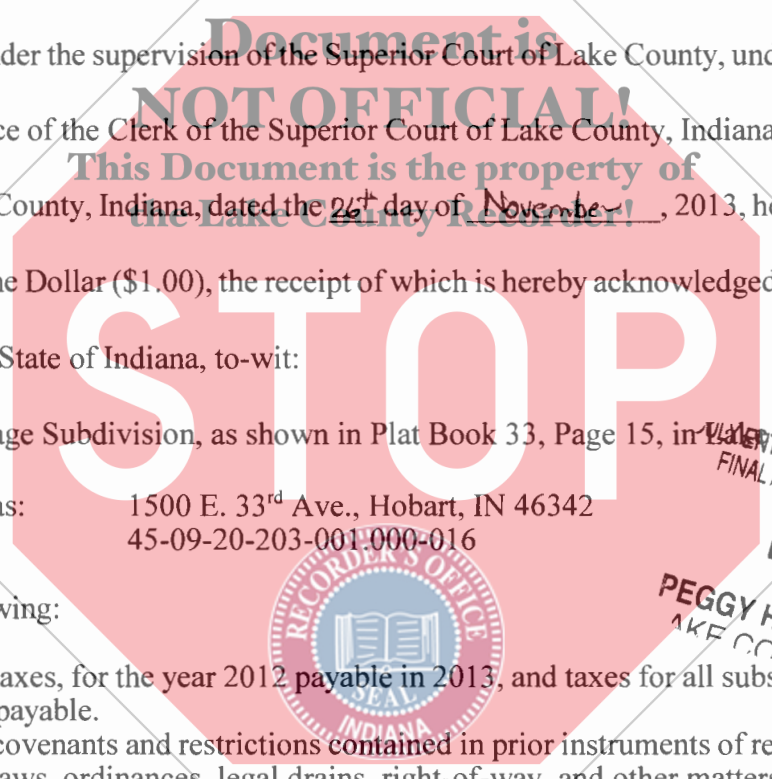

Lot 25, Viking Village Subdivision, as shown in Plat Book 33, Page 15, in Lake County, Indiana.

Commonly known as: 1500 E. 33<sup>rd</sup> Ave., Hobart, IN 46342  
Parcel Number: 45-09-20-203-001.000-016

ENTERED FOR TAXATION SUBJECT  
FINAL ACCEPTANCE FOR TRANSFER

DEC 12 2013

PEGGY HOLINGA KATONA  
LAKE COUNTY CLERK

Subject to the following:

1. Real Estate taxes, for the year 2012 payable in 2013, and taxes for all subsequent years yet due and payable.
2. Easements, covenants and restrictions contained in prior instruments of record; all building and zoning laws, ordinances, legal drains, right-of-way, and other matters which would be disclosed by an accurate survey of the premises.
3. Liens and encumbrances, if any, created by the acts of the herein grantees.

006970

\$19  
noncont  
#0800045 E  
EE

