

STATE OF INDIANA
LAKE COUNTY
FILED FOR RECORD

2013 052828

2013 JUL 19 AM 8:40

MICHAEL B. BROWN
RECORDER

SATISFACTION OF MORTGAGE

This Certifies, that a certain Mortgage executed by JOHN E. HIELEMA AND TRUDI E. HIELEMA, HUSBAND AND WIFE. This Security Instrument is given to LAKE MORTGAGE COMPANY, INC. on the 26TH day of NOVEMBER 2002 calling for \$96,300.00 recorded in Mortgage Record No. Page No. Document #2002 112311 LAKE COUNTY, State of INDIANA has been fully paid and satisfied, and the same is hereby released.

WITNESS our hand(s) and seal on this 11TH day of JULY 2013.

ATTEST:

Susan M. Bristow

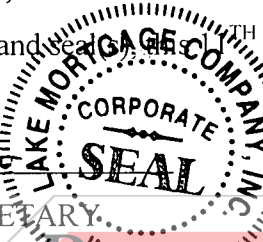

Lake Mortgage Company, Inc.

BY:

Peter S. Briggs II

SUSAN M. BRISTOW, SECRETARY

PETER S. BRIGGS II, ASST. VICE PRES.

State of Indiana, LAKE County, ss: Before me, the undersigned, a Notary Public in and for said County, this 11TH day of JULY 2013. Personally appeared Susan M. Bristow and Peter S. Briggs II respectively Secretary and Assistant Vice President acknowledged the execution of the annexed satisfaction of mortgage.

Witness my hand and official seal. *Donna S. Rust* Donna S. Rust Notary Public.

My Commission expires 11/18/16 County Residence Lake. This instrument was prepared by: Jackie Creighton, Lake Mortgage Co. 4000 West Lincoln Hwy. Merrillville, IN 46410 "I affirm, under penalties for perjury, that I have taken reasonable care to redact each social security number in this document, unless required by law". Jackie Creighton

LEGAL DESCRIPTION

LOT 14 THE NORTH 43.05 FEET BY PARALLEL LINES OF PINE RIDGE ESTATES, AN ADDITION TO THE TOWN OF LOWELL, AS SHOWN IN PLAT BOOK 81 PAGE 47 IN LAKE COUNTY, INDIANA. COMMONLY KNOWN AS 334 CLINTON, LOWELL, INDIANA 46356.

PTN#45-19-24-330-009.000-008 506024/23947

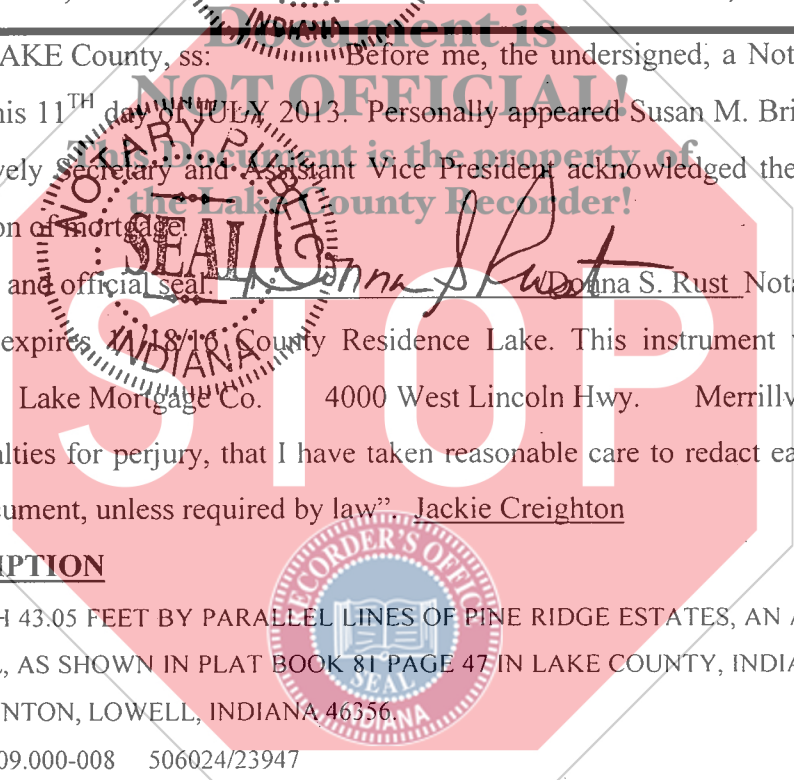

12-
5043
AM
E