

2013 051096

2013 JUL 15 PM 4:00

MICHAEL B. BROWN
RECORDER

SURVIVORSHIP AFFIDAVIT

STATE OF INDIANA)
COUNTY OF LAKE)

On this 15th day of July, 2013, before me personally appeared Anne Sikma to me personally known, who being duly sworn on oath did say that:

1. Affiants resides at the address given below affiants' signature.
2. Affiants is the surviving adult spouse of Henry Sikma.
3. Said premises were formerly owned by, and titled in the names of, Henry Sikma and Anne Sikma, Husband and Wife.
4. Henry Sikma died on March 14, 2008, leaving no will.
5. The premises are commonly known as: 10606 Calumet Ave., Dyer, Indiana 46311.

Property Number: 45-14-01-400-022.000-015
 Legal description of the property:
 N. 40 Acres of E. 100 Acres of SE. S. 1 T. 34 R. 10;
 Subject to easement and right of ways;
 Approximately 40 Acres

6. To the best of affiant's knowledge there is no Federal estate tax liability by reason of the death of said decedent. All inheritance taxes due the State of Indiana have been determined and paid.
7. Affiant and decedent were husband and wife..
9. Please mail all future tax bills/notices to the below address.

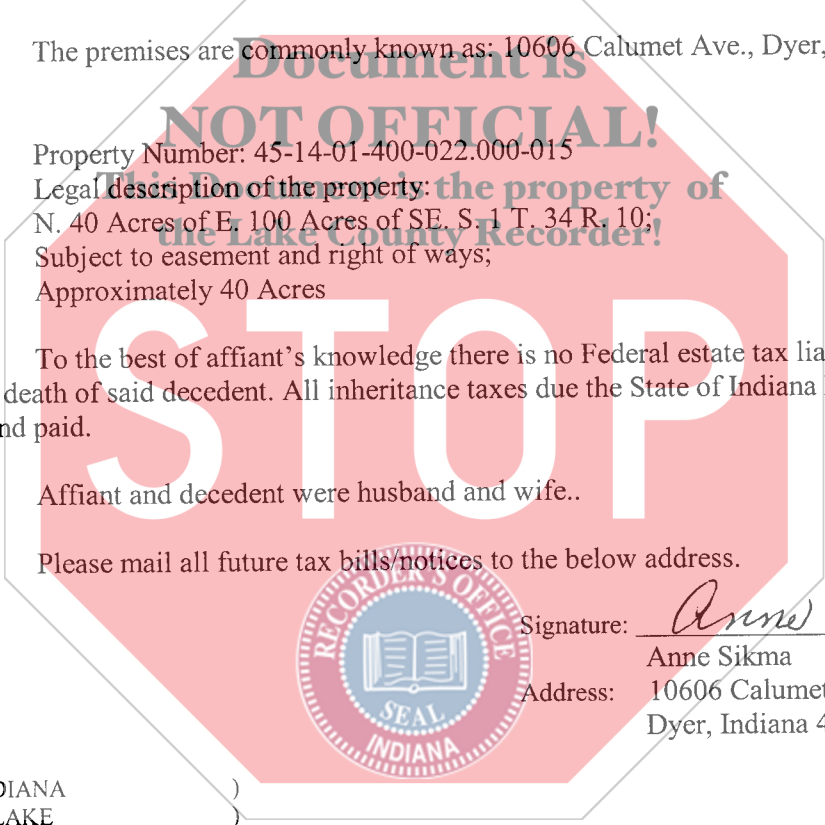

Signature: Anne Sikma
 Anne Sikma
 Address: 10606 Calumet Ave.
 Dyer, Indiana 46311

STATE OF INDIANA)
COUNTY OF LAKE)

Before me, a Notary Public in and for said County and State, personally Anne Sikma who acknowledged execution of the Survivorship Affidavit and who, being duly sworn, stated the representations contained therein to be true.

WITNESS my hand and Notarial Seal this 15th day of July, 2013.

My Commission Expires: December 25, 2014
Resident of Lake County

Rosemary L. Gabrys
 Rosemary L. Gabrys, Notary Public

I affirm under the penalties of perjury, that I have taken reasonable care and steps to redact cash, social security number in the document, including attachments, unless required by law



Kimberly A. Mouradites
 Kimberly A. Mouradites

Instrument Prepared By: Kenneth A. Manning, 200 Monticello Drive, Dyer, Indiana 46311; phone: (219) 865-8376

\$11--
CK#6440
KC