

22

STATE OF INDIANA
LAKE COUNTY
FILED FOR RECORD

STATE OF INDIANA)
)
COUNTY OF LAKE)

2013 018432

2013 MAR 13 AM 8:47

MICHAEL B. BROWN
RECORDER

AFFIDAVIT OF HEIRSHIP



Gregory S. Russell, being first duly sworn upon his oath, now alleges and states as follows:



1. That the affiant is an adult person and resides at 7525 Clay Street, Merrillville, IN 46410.

2. That the affiant is the son and only child of Billy Gene Russell who died December 17, 2008.

3. That Billy Gene Russell and his wife, Peggy Jean Russell, acquired a certain parcel of real estate located in the Town of Merrillville, County of Lake, State of Indiana, which real estate has a common address of 7525 Clay Street, Merrillville, Indiana and is legally described as:

The South 120 feet of the North 130 feet of the West 200 feet of the North Half (N1/2) of the Southwest Quarter (SW1/4) of the Southwest Quarter (SW 1/4), of Section Eighteen (18), Township Thirty-five (35) North, Range Seven (7) West of the Second Principal Meridian, containing .551 of an acre, more or less.

4. That Billy Gene Russell and Peggy Jean Russell were married when they acquired the real estate herein described and lived together as husband and wife until September 16, 2004, on which date Peggy Jean Russell passed away. Here local death certificate bears number 2276-04, Lake County, Indiana.

5. That as a result of the death of Peggy Jean Russell on September 16, 2004, Billy Gene Russell became the sole owner of the real estate herein described.

6. That on December 17, 2008, Billy Gene Russell a/k/a Billy G. Russell passed away. His death certificate bears local no. 4264-08, Lake County, Indiana. As a consequence of his death, the real estate at 7525 Clay Street, Merrillville, Indiana became the sole property of Gregory S. Russell, only child of Billy Gene Russell and Peggy Jean Russell.

7. That no administration of the estate of Billy Gene Russell is contemplated by anyone to the knowledge and belief of the affiant. The estate of Billy Gene Russell was subject to any Federal Estate Tax or any Indiana Inheritance Tax. That to the best of the affiant's knowledge, there are no outstanding debts or claims of the decedent, except the balance due on a mortgage on decedent's real estate.

8. That Billy Gene Russell died intestate leaving only one child, Gregory S. Russell, as his sole and only heir at law.

001416

14
MK
AD
CS

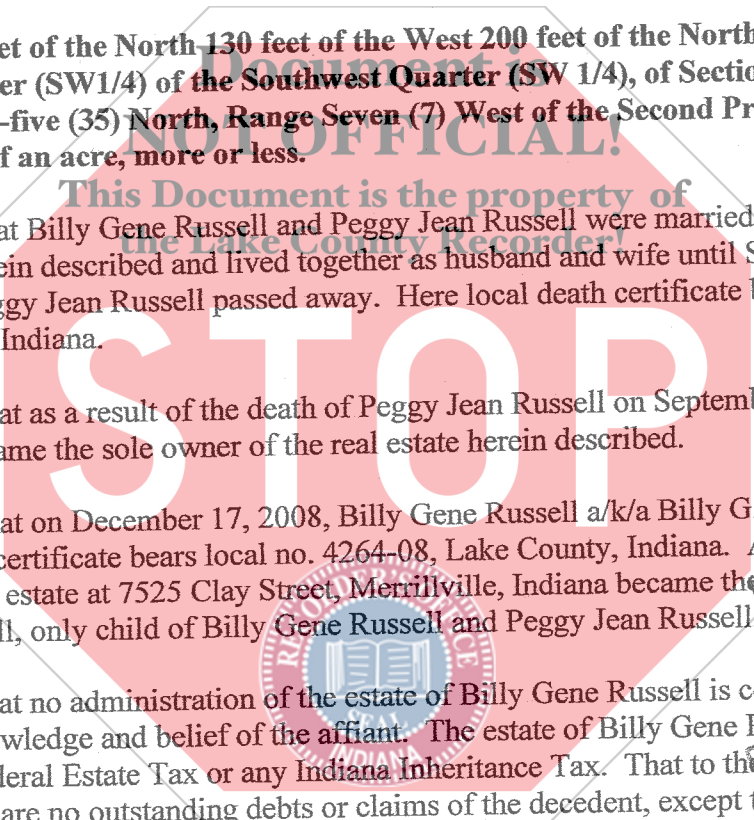

FILED
MAR 13 2013
PEGGY HOLINA KATONA
LAKE COUNTY AUDITOR

9. That this affiant is made for the purpose of demonstrating the fee simple interest of Gregory S. Russell in the above described real estate and to cause the Auditor of Lake County to properly reflect the current status of the title to said parcel.

10. Affiant requests that all future tax statement be sent to :

**GREGORY S. RUSSELL
7525 S. CLAY STREET
MERRILLVILLE, IN 46410**

Further affiant sayeth not.



GREGORY S. RUSSELL

STATE OF INDIANA COUNTY OF LAKE SS:

Before me, the undersigned, a Notary Public in and for said County and State, this 5th day of October, 2010 personally appeared: **GREGORY S. RUSSELL** and acknowledged the execution of the foregoing deed. In witness thereof, I have hereunto subscribed my name and affixed my official seal.

My commission expires: 7-01-17

Signature



Resident of Lake County

NOT OFFICIAL!
This Document is the property of
the Lake County Recorder!

Printed: **Ervin C. Carstensen**, Notary Public

I affirm, under the penalties for perjury, that I have taken reasonable care to redact each Social Security number in this document, unless required by law.



ERVIN C. CARSTENSEN, Attorney at Law

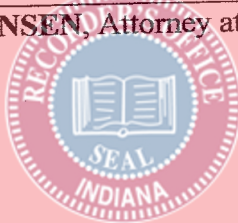

This instrument prepared by: Ervin C. Carstensen, I. D. #3141-45
503 Main Street, Hobart, IN 46342