

2012 087207

2012 DEC 11 PM 2:41

RECORDER
MAN

**SWORN STATEMENT OF INTENTION TO HOLD LIEN
(NOTICE OF MECHANIC'S LIEN)**

To: Providence Homes at Regency,
900 Woodlands Pkwy
Vernon Hills, IL 60061

State of Indiana, county of Lake ss:

The undersigned being first duly sworn, makes this sworn statement of intention to hold a lien upon the property described below and says that:

1. The undersigned Graham's Trucking & Excavating, Inc 
P O Box 70
Crown Point, IN 46308

intends to hold a lien on land legally described as follows:

Lot 26 in the Regency - Unit No 2 - Phase One, according to the plat thereof recorded August 22, 2008 in plat book 103, page 19 as Doc. No. 2008-059896 in Lake County, Indiana.

And commonly known as:

13089 Hayes St Crown Point IN
Street City State

As well as on all building, other structures and improvements located thereon or connected therewith for work and labor done and/or materials and machinery furnished by the undersigned in the erection, construction, altering, repairing, and removing of said buildings, structures and Improvements.

2. The amount claimed under this statement is Four hundred seventy dollars & no cents
\$ 470.00

3. The work and labor were done, and materials and machinery were furnished by the undersigned within the last sixty (60) days.

Sarah E. Wiese Sarah E. Wiese
Signature Name Printed

State of Indiana, Lake County ss:
Before me a Notary Public in and for said county and State, personally appeared Sarah E. Wiese
Agent and who acknowledged the execution of the foregoing intention to Hold Mechanics Lien.

Witnesseth my hand and seal this 10th day of December, 2012

My commission expires 6/19/2014 Patricia G. Shure Notary Public

Resident of Lake County Patricia G. Shure Name printed

Recorder of Lake County

This instrument was prepared by Sarah E. Wiese, Resident of Lake County

I affirm under penalties of perjury, that I have taken reasonable care to redact each social security in this document, unless required by law.

(Signature) Sarah E. Wiese (Name Printed) Sarah E. Wiese

AMOUNT \$ 13
CASH X CHARGE _____
CHECK # _____
OVERAGE _____
COPY _____
NON-COM _____
CLERK LP

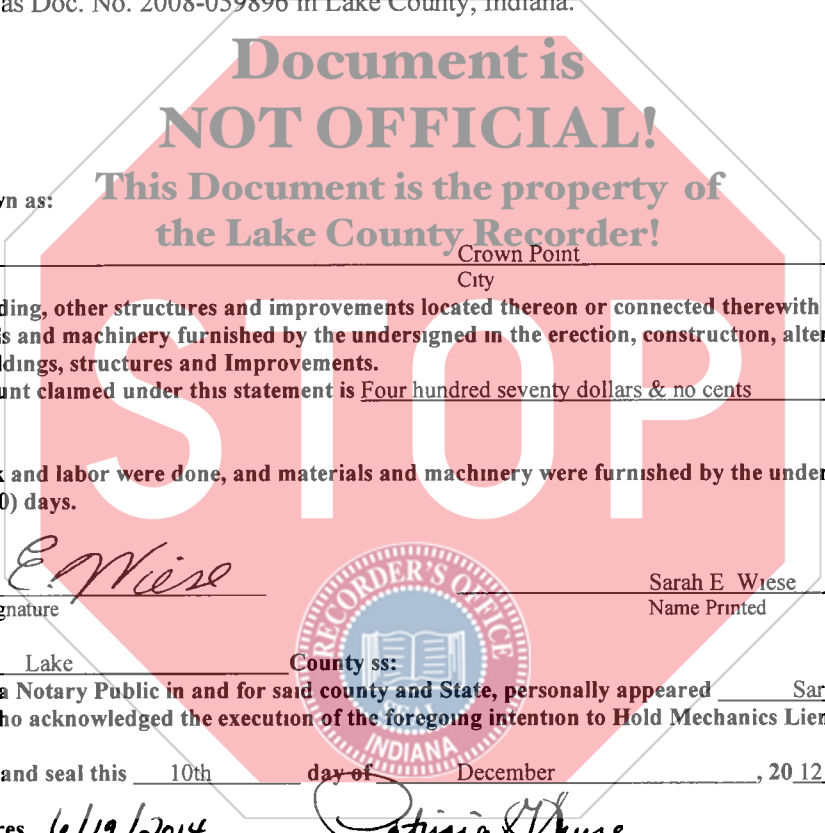

Patricia G. Shure
Notary Public State of Indiana
Lake County
My Commission Expires 06/19/2014