

2

STATE OF INDIANA  
LAKE COUNTY  
FILED FOR RECORD

2012 085819

2012 DEC -6 AM 8:40

# INDIANA

COUNTY OF LAKE  
POOL NO.  
LOAN NO. 1640005511

PREPARED BY SECURITY CONNECTIONS, INC.  
WHEN RECORDED MAIL TO:  
SECURITY CONNECTIONS INC.  
240 TECHNOLOGY DRIVE  
IDAHO FALLS, ID 83401  
PH: (208) 528-9895  
ATTN: TERRILL NIELSON

## ASSIGNMENT OF MORTGAGE

ALL MEN BY THESE PRESENTS:  
That METLIFE HOME LOANS, A DIVISION OF METLIFE BANK, N.A.,

located at 1555 W. WALNUT HILL LANE #200, IRVING, TX 75038,  
party of the first part, for value received has granted, bargained, sold,  
assigned, transferred and set over unto CHAMPION MORTGAGE COMPANY

located at 350 HIGHLAND DRIVE LEWISVILLE, TX 75067 party of the second  
part, its successors and assigns, a certain indenture of mortgage dated  
DECEMBER 19, 2008 made by NANCY L. BARAN  
to THE MORTGAGE NETWORK, INC.

as Beneficiary  
securing the payment of one promissory note therein described for the sum  
of ONE HUNDRED SEVENTY-SEVEN THOUSAND and NO/100----- dollars (\$177,000.00)  
and all its right, title and interest in and to the premises situated in  
county of LAKE, State of Indiana, and described in  
said mortgage as follows, to wit:  
**AS DESCRIBED ON SAID MORTGAGE REFERRED TO HEREIN.**

Assignment-Interv.-Recorded

which said mortgage is recorded in the office of the recorder of  
LAKE County, in the State of Indiana in  
Book/Drawer \_\_\_\_\_ at Page/Card \_\_\_\_\_, Document#  
or Instrument # 2009 000527 and Microfilm# \_\_\_\_\_



Loan No.

J=m18070112ai.s.44430 P=S.002.00699.74

Page 1 of 2

AMOUNT \$ 14<sup>00</sup>  
CASH \_\_\_\_\_ CHARGE \_\_\_\_\_  
CHECK # 358083  
OVERAGE \_\_\_\_\_  
COPY \_\_\_\_\_  
NON-COM \_\_\_\_\_  
CLERK AM E

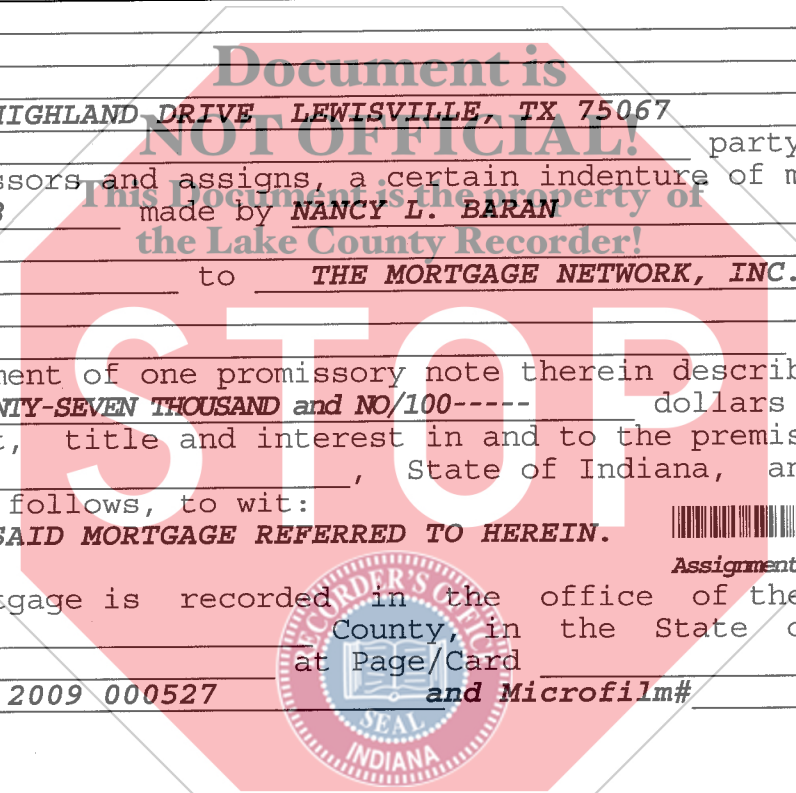

Loan No. 1640005511

TO HAVE AND TO HOLD the same unto the said party of the second part, its successors and assigns, forever, subject only to the provisions in the said indenture of mortgage contained.

IN WITNESS WHEREOF, the party of the first part has caused this instrument to be executed in its name by Janice Robertson and attested by \_\_\_\_\_. This \_\_\_\_\_ day of NOV 13 2012.

ATTEST:

**METLIFE HOME LOANS, A DIVISION OF METLIFE BANK, N.A.**

BY Janice Robertson  
**Janice Robertson**  
**LIMITED VICE PRESIDENT**  
STATE OF **TEXAS**

COUNTY OF **DALLAS**  
On NOV 13 2012  
personally appeared Janice Robertson

**Document is NOT OFFICIAL!**  
**This Document is the property of the Lake County Recorder!** **Brenda Jenkins**

and personally appeared Janice Robertson and to me on the basis of satisfactory evidence) to be the person(s) who executed the within instrument as **LIMITED VICE PRESIDENT** and on behalf of the corporation therein named and acknowledged to me that the corporation executed it.

Brenda Jenkins  
**Brenda Jenkins**  
Notary Public

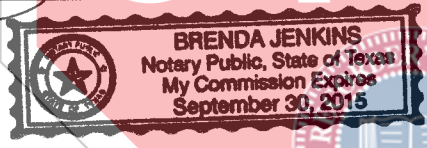

PREPARED BY: Janice Robertson  
**Janice Robertson**  
**240 TECHNOLOGY DRIVE**  
**IDAHO FALLS, ID 83401**

I affirm, under the penalties for perjury, that I have taken reasonable care to redact each social security number in this document, unless required by law.

P=S.002.00699.74

J=m18070112ai.s.44430

Page 2 of 2