

Notice of Federal Tax Lien

Area:
SMALL BUSINESS/SELF EMPLOYED AREA #4
Lien Unit Phone: (800) 913-6050

Serial Number
891259412

For Optional Use by Recording Office

As provided by section 6321, 6322, and 6323 of the Internal Revenue Code, we are giving a notice that taxes (including interest and penalties) have been assessed against the following-named taxpayer. We have made a demand for payment of this liability, but it remains unpaid. Therefore, there is a lien in favor of the United States on all property and rights to property belonging to this taxpayer for the amount of these taxes, and additional penalties, interest, and costs that may accrue.

Name of Taxpayer COWCHOW TRANSPORT INC, a Corporation

Residence 17108 PARRISH AVE
LOWELL, IN 46356-9661

2012 061327

2012 SEP

MORTGAGE RECORDED

STATE RECORDS DIVISION
FILED

IMPORTANT RELEASE INFORMATION: For each assessment listed below, unless notice of the lien is refiled by the date given in column (e), this notice shall, on the day following such date, operate as a certificate of release as defined in IRC 6325(a).

Kind of Tax (a)	Tax Period Ending (b)	Identifying Number (c)	Date of Assessment (d)	Last Day for Refiling (e)	Unpaid Balance of Assessment (f)
941	06/30/2011	26-1606661	03/05/2012	04/04/2022	8228.82
941	09/30/2011	26-1606661	03/05/2012	04/04/2022	10554.03
941	12/31/2011	26-1606661	03/12/2012	04/11/2022	
941	12/31/2011	26-1606661	05/14/2012	06/13/2022	10596.22
941	03/31/2012	26-1606661	07/02/2012	08/01/2022	13596.56
Place of Filing COUNTY RECORDER LAKE COUNTY CROWN POINT, IN 46307					Total \$ 42975.63

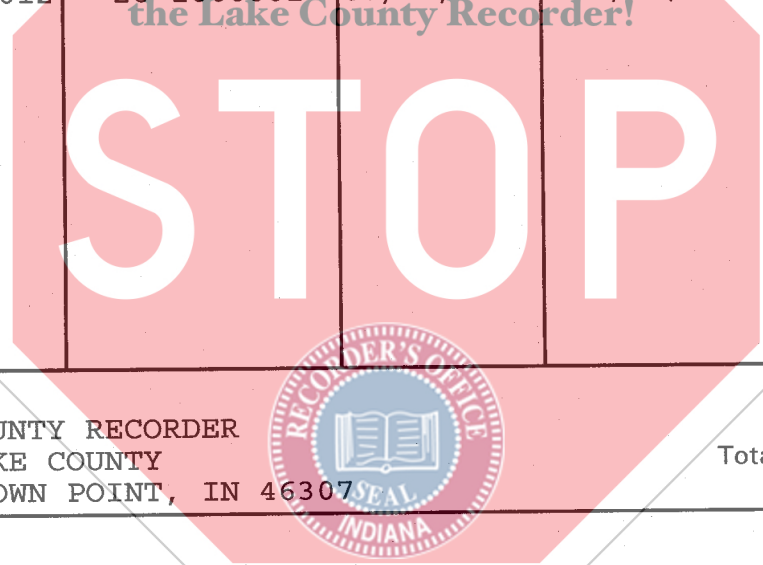

This notice was prepared and signed at CHICAGO, IL, on this, 12th day of Aug, 2012.

Signature *[Signature]*
for THOMAS R GUNTHER

Title
REVENUE OFFICER 24-09-1810
(219) 736-4312

(NOTE: Certificate of officer authorized by law to take acknowledgment is not essential to the validity of Notice of Federal Tax lien Rev. Rul. 71-466, 1971 - 2 C.B. 409)

Part 1 - Kept By Recording Office

Form 668(Y)(c) (Rev. 2-2004)
CAT. NO 60025X