

2012 057397

2012 AUG 24 AM 9:01



**APPLICATION FOR WITHDRAWAL OF  
CLASSIFIED FOREST & WILDLANDS**

State Form 45541 (R4/07-06)

Department of Natural Resources  
Division of Forestry  
402 West Washington Street, Room W296  
Indianapolis, Indiana 46204

**VOLUNTARY WITHDRAWAL OF CLASSIFIED FOREST & WILDLANDS CF 6061**

I, Patrick & Mary Laws, do hereby make application for withdrawal from classification, subject to the provisions of an Act approved March 10, 1921, as amended, entitled "An Act to encourage timber production and to protect watersheds by classifying certain lands as forest lands, and prescribing a method of assessing (appraising) lands thus classified for purposes of taxation," the following described land, located in Lake County, of which I am the owner, to wit

See Attached Legal Description

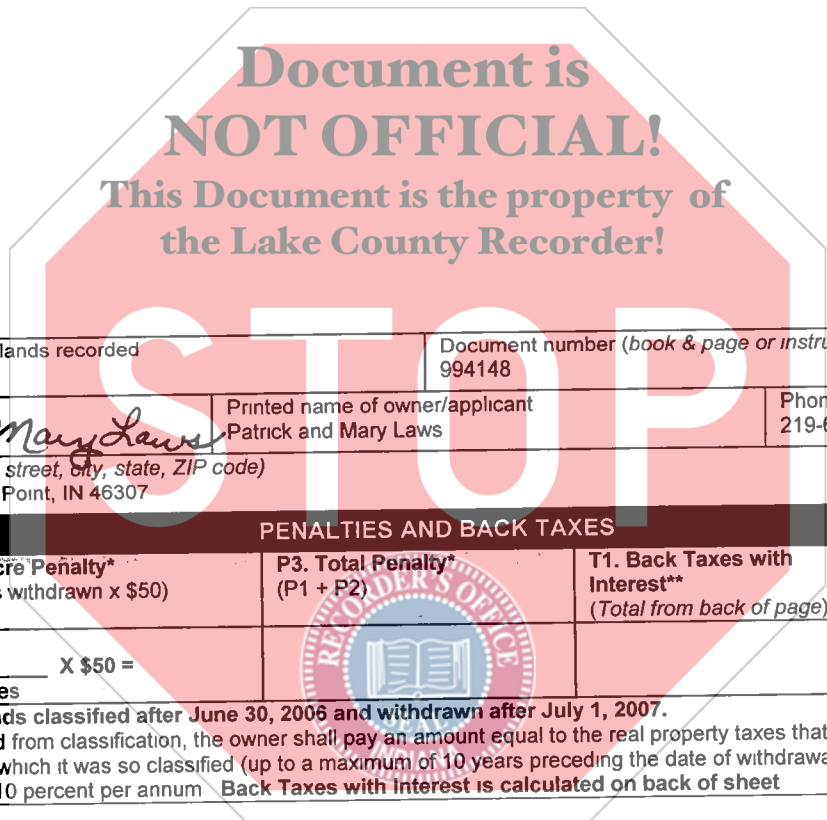

Date Classified Forest & Widlands recorded 8/25/1988	Document number (book & page or instrument number) 994148
Signature of owner/applicant <u>Patrick Laws Mary Laws</u>	Printed name of owner/applicant Patrick and Mary Laws
Mailing address (number and street, city, state, ZIP code) 1324 W 163 <sup>rd</sup> Avenue Crown Point, IN 46307	Phone number 219-696-9665

**PENALTIES AND BACK TAXES**

P1 Flat Penalty*	P2 Acre Penalty* (Acres withdrawn x \$50)	P3 Total Penalty* (P1 + P2)	T1 Back Taxes with Interest** (Total from back of page)	Total Penalties and Back Taxes Due (P3 + T1)
\$100	_____ X \$50 = Acres			

\*Penalties apply only to lands classified after June 30, 2006 and withdrawn after July 1, 2007.  
\*\*Upon the withdrawal of land from classification, the owner shall pay an amount equal to the real property taxes that would have been assessed on the land during the period in which it was so classified (up to a maximum of 10 years preceding the date of withdrawal) plus interest on such real property taxes at the rate of 10 percent per annum. Back Taxes with Interest is calculated on back of sheet

**FILED**

AUG 24 2012

PEGGY HOLINGA KATONA  
LAKE COUNTY AUDITOR

15.00  
CS  
40

050157

6/26/12 / 16

15-20-09 301-005.000-007 / 02-03-48-44

REPORT OF BACK TAX								
(1) Year	(2) Assessed (True Tax) Value Per Acre Minus \$1	(3) Tax Rate Per \$100	(4) PTIRC - Property Tax Replacement Credit	(5) Tax Rate	(6) Taxes Due Per Acre	(7) 10% Annual Interest Factor	(8) Amount Due Per Acre For The Year	
Example 2005	\$209 - 1 = \$208	2.0534	0.209695	$\frac{208 \times 2.0534}{100} = 4.27$	$4.27 - (4.27 \times 0.209695) = 3.37$	1.1	$3.37 \times 1.1 = 3.71$	
1) 2011	1500 - 1 = 1499	1.8570	—	27.84	27.84	1.1	30.62	
2) 2010	1290 - 1 = 1289	2.0549	—	26.48	26.48	1.2	31.78	
3) 2009	1250 - 1 = 1249	2.0554	—	25.68	25.68	1.3	33.58	
4) 2008	1200 - 1 = 1199	2.0536	—	24.62	24.62	1.4	34.48	
5) 2007	1140 - 1 = 1139	2.60290	18.87150	29.64	24.18	1.5	36.28	
6) 2006	980 - 1 = 879	2.7165	.194675	23.87	19.22	1.6	30.76	
7) 2005	880 - 1 = 879	3.0431	.213542	26.74	21.02	1.7	35.74	
8) 2004	1050 - 1 = 1049	2.7631	.221947	28.98	22.54	1.8	40.58	
9) 2003	1050 - 1 = 1049	2.8195	.204581	29.28	23.52	1.9	44.70	
10) 2002	105 - 1 = 104	2.7191	.202148	28.52	22.74	2.0	45.48	
							<b>Total Per Acre</b>	<b>363.80</b>
Signature of County Assessor					Date signed	Number of Acres		
<i>[Signature]</i>					7/2/12	18.4		
Signature of County Auditor					Date signed	Total Taxes with Interest Due		
<i>[Signature]</i>					7/5/12	\$ 6623.94		
Signature of State Forester or Deputy								
<i>[Signature]</i>								
Date Auditor notified (month, day, year)			Date Auditor acknowledged receipt (month, day, year)					
8/1/12			8/6/12					
I affirm, under penalties for perjury, that I have taken reasonable care to redact each social security number in the document, unless required by law.								
Signature: <i>[Signature]</i>					Date: 8/9/12			

**FILED**

JUN 27 2012

PEGGY HOLINGA KATONA  
LAKE COUNTY AUDITOR

02-09-48-24

Patrick & Mary Laws  
1324 W 163rd Ave  
CWP



**APPLICATION FOR CLASSIFICATION/301N**  
State Form 34161R **994148**

Return to: DEPARTMENT OF NATURAL RESOURCES  
DIVISION OF FISH & WILDLIFE  
CLASSIFIED WILDLIFE HABITAT PROGRAM  
NORTH WILDLIFE MANAGEMENT REGIONAL OFFICE  
RR #4, PERU, INDIANA 46970

Date  
7-29-88

**APPLICATION FOR THE CLASSIFICATION OF LAND AS WILDLIFE HABITAT**

I, Patrick & Mary Laws

do hereby make application to have classified as Wildlife

Habitat Land, subject to the provisions of an Act approved March 23, 1979, entitled "An Act to amend IC 6-1.1 by adding a new chapter concerning property taxation of wildlife habitats", the following described land, of which I am owner, to-wit:

**LEGAL DESCRIPTION**

Part of the East Half of the Northwest Quarter of the Southwest Quarter of Section 9, Township 33 North, Range 8 West, Lake County, Indiana, described as follows: Beginning at the Northeast corner of the Northwest Quarter of the Southwest Quarter of said Section; thence South along the East line of said Northwest Quarter, a distance of 1301 feet, more or less, to the North right-of-way line of 163rd Avenue (40 feet wide); thence West along said right-of-way line a distance of 170 feet; thence North 220 feet; thence West 280 feet; thence South 220 feet to said North right-of-way line; thence West 214 feet, more or less, along said right-of-way line to the West line of said East Half; thence North 1299 feet, more or less, to the Northwest corner of said East Half; thence East 664 feet more or less to the point of beginning, containing 18.4 acres, more or less.

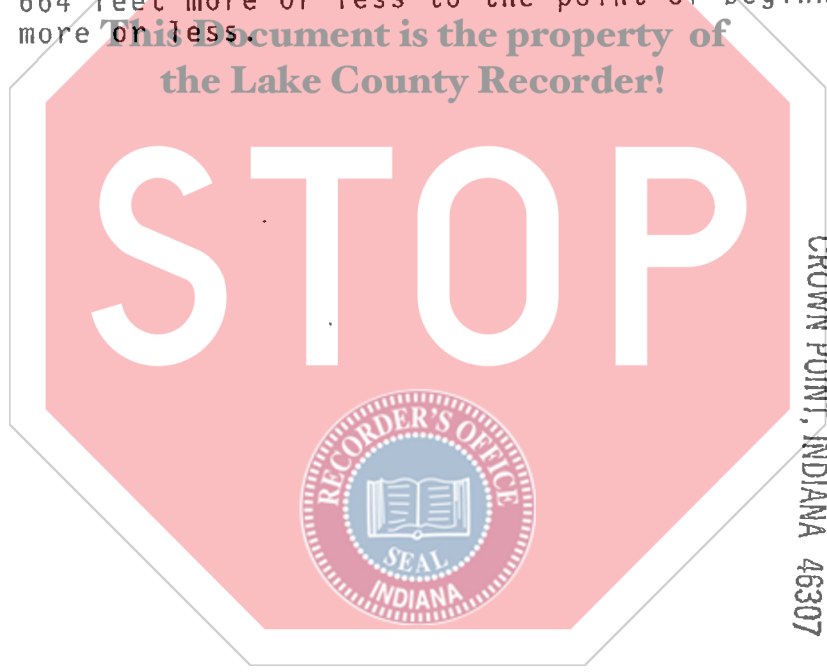

This document is the property of  
the Lake County Recorder!

STATE OF INDIANA/S.S. NO.  
LAKE COUNTY  
FILED FOR RECORD  
Aug 25 12 27 PM '88  
LILLIAN A. BLASTICK  
RECORDER, LAKE COUNTY  
CROWN POINT, INDIANA 46307

Street Address of Owner <u>1324 W. 163rd Ave.</u>		City, State, Zip <u>Crown Point, In. 46307</u>	Phone No. <u>696-9665</u>
County In which owner resides <u>Lake</u>	County location of land to be classified <u>Lake</u>	Owner/Applicant's Signature <u>Mary Laws</u>	

H.O.C.