

23

This instrument was prepared by and, after recording, return to:

Allen C. Balk
Meltzer, Purtil & Stelle LLC
300 South Wacker Drive, Suite 3500
Chicago, Illinois 60606

Permanent Real Estate Tax Index No.:
See **Exhibit A** attached hereto

Address:
See **Exhibit A** attached hereto

2012 056657

STATE OF INDIANA
LAKE COUNTY
FILED FOR RECORD

2012 AUG 22 AM 9:50

MICHELLE R. FAJMAN
RECORDER

This space reserved for Recorder's use only

OTICUM 120191

ASSIGNMENT OF RENTS AND LEASES

LAKESHORE DUNES APARTMENTS, GARY, INDIANA

15, 2012 by **LAKESHORE DUNES LIMITED PARTNERSHIP**, an Illinois limited partnership (as context may require, separately and collectively "Assignor"), to **FIRST MIDWEST BANK**, its successors and assigns ("Assignee").

WITNESSETH:

Assignor, for good and valuable consideration, the receipt and sufficiency of which are hereby acknowledged, hereby grants, transfers, sets over and assigns to Assignee, all of the right, title and interest of Assignor (i) in and to all of the rents, issues and profits of and from the Property described in **Exhibit A** attached hereto and made a part hereof (the "Property"); (ii) in and to all leases and subleases (the "Leases") now or hereafter existing on all or any part of the Property (which term includes, if **Exhibit B** is attached to this instrument, the particular lease or leases of the Property (the "Existing Leases") described in said **Exhibit B**); (iii) in and to all rights and claims for damage against tenants arising out of defaults under the Leases, including rights to compensation with respect to rejected Leases pursuant to Section 365(a) of the United States Bankruptcy Code (11 U.S.C. § 101 *et seq.*) or any replacement Section thereof; and (iv) all of Assignor's interest in any tenant improvements and fixtures located on the Property.

THIS ASSIGNMENT OF RENTS AND LEASES IS GIVEN TO SECURE:

(a) Payment by Assignor when due of (i) the indebtedness evidenced by that certain Promissory Note of even date herewith (the "Note") made by Assignor, in the principal sum of Twelve Million Four Hundred Fifty Thousand and No/100 Dollars (\$12,450,000.00) delivered to Assignee simultaneously with the execution and delivery of this Assignment, and any and all renewals, extensions or refinancings thereof; (ii) any other obligations, liabilities or indebtedness which may be due and owing from Assignor to Assignee, or by any co-maker or guarantor of the Note, whether such obligations, liabilities or indebtedness are now existing or hereafter created, direct or indirect, absolute or contingent, joint or several due or to become due, howsoever

#76
CT
CVA

CHICAGO TITLE

created, evidenced or arising and howsoever acquired by Assignee, and any and all renewals, extensions or refinancings thereof; and (iii) all costs and expenses paid or incurred by Assignee in enforcing its rights hereunder, including without limitation, court costs and attorneys' fees.

(b) Observance and performance by Assignor of the covenants, terms, conditions and agreements contained in the Note, this Assignment, the Mortgage and Security Agreement (the "Mortgage") of even date herewith made by Assignor to Assignee and creating a first mortgage lien on the Property, the Loan Agreement ("Loan Agreement") of even date herewith by and among Assignor, Assignee and the Guarantors (as defined therein), and any other document or instrument evidencing or securing the Note or delivered to induce Assignee to disburse the proceeds thereof. The Mortgage, Loan Agreement, this Assignment and all such other documents and instruments evidencing or securing the Note and delivered to induce Assignee to disburse the proceeds thereof are hereinafter collectively referred to as the "Loan Documents".

AND ASSIGNOR HEREBY COVENANTS, AGREES, REPRESENTS AND WARRANTS AS FOLLOWS:

1. **Representations and Warranties of Assignor.** Assignor represents and warrants to Assignee that:

(a) This Assignment, as executed by Assignor, constitutes the legal and binding obligation of Assignor enforceable in accordance with its terms and provisions;

(b) Assignor is the lessor under the Existing Leases and is or will be the lessor under all Leases, in each case either directly or as successor in interest to the named lessor thereunder;

(c) Assignor has not heretofore made any other assignment, which has not been released, of its entire or any part of its interest in and to any or all of the Leases, or any or all of the rents, issues, income or profits assigned hereunder or entered into any agreement to subordinate any of the Leases, or Assignor's right to receive any of the rents, issues, income or profits assigned hereunder;

(d) Assignor has not heretofore executed any instrument or performed any act which may or might prevent Assignee from operating under any of the terms and provisions hereof or which would limit Assignee in such operation; and

(e) To Assignor's knowledge, no tenant is in material default under any Lease, except to the extent as disclosed to Assignee in the Rent Roll.

2. **Covenants of Assignor.** Assignor covenants and agrees that so long as this Assignment shall be in effect:

(a) Assignor shall not enter into any lease for all or any portion of the Property without the prior written consent of Assignee except for the lease of residential apartments to individual tenants in the ordinary course of Assignor's business;

(b) Assignor shall, in the ordinary course of Assignor's business, observe and perform all of the material covenants, terms, conditions and agreements contained in the Leases to be observed or performed by the lessor thereunder, and Assignor shall not do or suffer to be done anything to impair the security thereof, or without the express written consent of Assignee, (i) release the liability of any tenant under any Lease, or (ii) permit or suffer any tenant thereunder to withhold the payment of rent or to make monetary advances and off-set the same against future rentals, or (iii) permit or suffer any tenant thereunder to claim a total or partial eviction, (iv) permit any tenant thereunder to terminate or cancel any Lease (as hereinafter defined), or (v) enter into any oral leases with respect to all or any portion of the Property;

(c) Assignor shall not collect any of the rents, issues, income or profits assigned hereunder outside the ordinary course of Assignor's business, except for security or similar deposits;

(d) Assignor shall not make any other assignment of its entire or any part of its interest in or to any or all Leases, or any or all rents, issues, income or profits assigned hereunder without the prior written consent of Assignee;

(e) Assignor shall not make any other assignment of its entire or any part of its interest in or to any or all Leases, or any or all rents, issues, income or profits assigned hereunder without the prior written consent of Assignee;

(f) Assignor shall not accept a surrender of any Lease other than any Lease in which the tenant thereunder is in default, or convey or transfer, or suffer or permit a conveyance or transfer, of the premises demised under any Lease or of any interest in any Lease so as to effect, directly or indirectly, proximately or remotely, a merger of the estates and rights of, or a termination or diminution of the obligations of, any tenant thereunder other than any Lease in which the tenant thereunder is in default;

(g) Assignor shall not, subject to reasonable and prudent property management standards, alter, modify or change the terms of any guaranty of any Lease, or cancel or terminate any such guaranty or do or suffer to be done anything which would terminate any such guaranty as a matter of law, without the prior written consent of Assignee;

(h) Assignor shall not, subject to reasonable and prudent property management standards, waive or excuse the obligation to pay rent under any Lease;

(i) Assignor shall enforce the Leases and all rights and remedies of the lessor thereunder in case of default thereunder by any tenant, subject to reasonable and prudent property management standards;

(j) Assignor shall, at its sole cost and expense, appear in and defend any and all actions and proceedings arising under, relating to or in any manner connected with any Lease or the obligations, duties or liabilities of the lessor or any tenant or guarantor thereunder, and shall pay all reasonable costs and expenses of Assignee, including court costs and reasonable attorneys' fees, in any such action or proceeding in which Assignee may appear;

(k) Assignor shall give prompt notice to Assignee of any material default on the part of the lessor with respect to any Lease received from any tenant thereunder;

(l) Assignor shall enforce the observance and performance of each covenant, term, condition and agreement contained in each Lease to be observed and performed by the tenant(s) thereunder, subject to reasonable and prudent property management standards;

(m) Assignor shall furnish to Assignee, at least every six (6) months or more frequently if requested by Assignee within ten (10) days after Assignee's written request, a written statement containing the names of all tenants and subtenants of the Property, unit number, amount of monthly rental, security deposit, term of Lease and whether or not such Lease is in default; and

(n) In the event that any tenant under any Lease is or becomes the subject of any proceeding under title 11 of the United States Code, as amended from time to time, or any other federal, state, or local statute which provides for the possible termination or rejection of the Leases assigned hereby, Assignor covenants and agrees that if any such Leases is so terminated or rejected, the settlement for damages shall be made without the prior written consent of Assignee, and any check in payment of damages will be applied in accordance with the provisions of Paragraph 6 below.

3. **Rights Prior to Default.** So long as Assignor is not in default hereunder, Assignee shall not demand from tenants under the Leases or any other person liable thereunder, any of the rents, issues, income and profits assigned hereunder, and Assignor shall have the right to collect at the time, but not more than thirty (30) days in advance of the date, provided for the payment thereof, all rents, issues, income and profits assigned hereunder, and to retain, use and enjoy the same. Assignee shall have the right to notify the tenants under the Leases of the existence of this Assignment at any time.

4. **Events of Default.** The occurrence of any one or more of the following shall constitute an "Event of Default" for purposes of this Assignment:

(a) Failure by Assignor to pay or cause to be paid (i) ten (10) days after any installment of principal or interest payable pursuant to the Note, or (ii) within ten (10) days written notice from Assignee any other amount payable pursuant to the Note, the Mortgage, the other Loan Documents or this Assignment.

(b) Failure by Assignor to promptly perform or cause to be performed any other obligation or observe any other condition, covenant, term, agreement or provision required to be performed or observed by Assignor under this Assignment, the Note, the Mortgage or any other Loan Document within thirty (30) days after written notice; provided, however, that if such condition, covenant, term, agreement or provision is such that it cannot with the exercise of reasonable diligence be performed within said thirty (30) days and Assignor diligently undertakes said performance within said thirty (30) day period, and thereafter diligently pursues such performance, the time to so perform shall be extended for an additional period, not to exceed sixty (60) days total, to effect such performance, unless the continued operation or safety of the Property, or the priority, validity or enforceability of the lien created by the Mortgage, the

Loan Agreement or any other Loan Document or the value of the Property is materially impaired, threatened or jeopardized.

(c) There shall exist or be continuing an "Event of Default" under the Note, the Loan Agreement, the Mortgage or any of the other Loan Documents.

(d) The existence of any material inaccuracy or untruth in any representation, covenant or warranty contained in this Assignment or any Loan Document, or of any statement or certification as to facts delivered to Assignee by Assignor, any co-maker or guarantor of the Note, or any applicant for the loan evidenced by the Note.

(e) At any time, Assignor or any guarantor or co-maker of the Note files a voluntary petition in bankruptcy, or is adjudicated a bankrupt or insolvent, or institutes (by petition, application, answer, consent or otherwise) any bankruptcy, insolvency, reorganization, arrangement, composition, readjustment, dissolution, liquidation or similar proceedings under any present or future Federal, state or other statute or law, or admits in writing his or its inability to pay his or its debts as they mature, or makes an assignment for the benefit of his or its creditors, or seeks or consents to the appointment of any receiver, Assignor or similar officer for all or any substantial part of his or its property.

(f) The commencement of any involuntary petition in bankruptcy against the Assignor or any guarantor or co-maker of the Note, or the institution against the Assignor, Assignor or any guarantor or co-maker of the Note, of any reorganization, arrangement, composition, readjustment, dissolution, liquidation or similar proceedings under any present or future Federal, state or other statute or law, or the appointment of a receiver, Assignor or other officer for all or any substantial part of the property of Assignor or any guarantor or co-maker of the Note, which shall remain undismissed or undischarged for a period of sixty (60) days.

(g) Any sale, transfer, lease, assignment, conveyance, pledge, lien or encumbrance made in violation of the provisions of the Loan Documents.

(h) The making of any levy, judicial seizure or attachment on the Leases or any portion thereof, which shall remain undismissed or undischarged for a period of sixty (60) days.

(i) Assignor fails to cause to be resolved to Assignee's satisfaction any claim which could affect the validity or priority of this Agreement or the lien of the Mortgage or the Loan Documents.

(j) The death or legal incompetence of either individual Guarantor of the Note, unless within the sixty (60) day period immediately following such death or declaration of legal incompetency (i) Assignor provides Assignee with a substitute guarantor whose creditworthiness and real estate experience and skills are comparable to those of the original guarantor and who is otherwise acceptable to Assignee in Assignee's sole discretion, and (ii) such substitute guarantor executes a guaranty in favor of Assignee in form and substance substantially similar to the existing guaranty and otherwise satisfactory to Assignee.

5. **Rights and Remedies Upon Default.** At any time upon or following the occurrence of any one or more Events of Default hereunder, Assignee may, at its option, exercise any one or more of the following rights and remedies without any obligation to do so, without in any way waiving such Event or Events of Default, without further notice or demand on Assignor (except as provided in the Loan Documents), without regard to the adequacy of the security for the obligations secured hereby, without releasing Assignor or any guarantor or co-maker of the Note from any obligation hereunder, and with or without bringing any action or proceeding to foreclose the Mortgage or any other lien granted by the Loan Documents:

(a) Declare the unpaid balance of the principal sum of the Note, together with all accrued and unpaid interest thereon, immediately due and payable;

(b) Enter upon and take possession of the Property, either in person or by agent or by a receiver appointed by a court, and have, hold, manage, lease and operate the same on such terms and for such period of time as Assignee may deem necessary or proper, with full power to make from time to time all reasonable alterations, renovations, repairs or replacements thereto or thereof as may seem proper to Assignee, to make, enforce, modify and accept the surrender of Leases, to obtain and evict tenants, to fix or modify rents, and to do any other act which Assignee deems necessary or proper;

(c) Either with or without taking possession of the Property, demand, sue for, settle, compromise, collect, and give acquittances for all rents, issues, income and profits of and from the Property and pursue all remedies for enforcement of the Leases and all the lessor's rights therein and thereunder, provided that, for such purpose, this Assignment shall constitute an authorization and direction to the tenants under the Leases to pay all rents and other amounts payable under the Leases to Assignee, without proof of default hereunder, upon receipt from Assignee of written notice to thereafter pay all such rents and other amounts to Assignee and to comply with any notice or demand by Assignee for observance or performance of any of the covenants, terms, conditions and agreements contained in the Leases to be observed or performed by the tenants thereunder, and provided, further, that Assignor will facilitate in all reasonable ways Assignee's collection of such rents, issues, income and profits, and upon request will execute written notices to the tenants under the Leases to thereafter pay all such rents and other amounts to Assignee; and

(d) Make any payment or do any act required herein of Assignor in such manner and to such extent as Assignee may reasonably deem necessary, and any amount so paid by Assignee shall become immediately due and payable by Assignor with interest thereon until paid at an annual rate (the "Default Rate") equal to five percent (5%) plus the applicable Loan Rate (as defined in the Note) then in effect under the Note and shall be secured by this Assignment.

6. **Application of Proceeds.** All sums collected and received by Assignee out of the rents, issues, income and profits of the Property following the occurrence of any one or more events of default under the provisions of Paragraph 4 of this Assignment shall be applied as follows:

(a) First, to reimbursement of Assignee for all expenses (including court costs and reasonable attorneys' fees) of taking and retaining possession of the Property; managing the Property and collecting the rents, issues, income and profits thereof, including without limitation, salaries, fees and wages of a managing agent and such other employees as Assignee may reasonably deem necessary and proper; operating and maintaining the Property, including without limitation, taxes, charges, claims, assessments, water rents, sewer rents, other liens, and premiums for any insurance provided in the Mortgage; the cost of all alterations, renovations, repairs or replacements of or to the Property which Assignee may deem necessary and proper, with interest thereon at the Default Rate;

(b) Second, to reimbursement of Assignee for and of all sums expended by Assignee pursuant to Paragraph 5 above to make any payment or do any act required herein of Assignor, together with interest thereon as provided herein;

(c) Third, to reimbursement of Assignee for and of all other sums with respect to which Assignee is indemnified pursuant to Paragraph 7 below, together with interest thereon as provided herein;

(d) Fourth, to reimbursement of Assignee for and of all other sums expended or disbursed by Assignee pursuant to the terms and provisions of or constituting additional indebtedness under any of the Loan Documents, with interest thereon as provided therein;

(e) Fifth, to the payment of all accrued and unpaid interest on the principal sums of the Note;

(f) Sixth, to payment of the unpaid balance of the principal sums of the Note; and

(g) Seventh, any balance remaining to Assignor, its successors and assigns.

7. **Limitation of Assignee's Liability.** Assignee shall not be liable for any loss sustained by Assignor resulting from Assignee's failure to let the Property following the occurrence of any one or more Events of Default under the provisions hereof or from any other act or omission of Assignee in managing, operating or maintaining the Property following the occurrence of any one or more Events of Default under the provisions hereof. Assignee shall not be obligated to observe, perform or discharge, nor does Assignee hereby undertake to observe, perform or discharge any covenant, term, condition or agreement contained in any Lease to be observed or performed by the lessor thereunder, or any obligation, duty or liability of Assignor under or by reason of this Assignment, and Assignor shall and does hereby agree to indemnify Assignee for, and to hold Assignee harmless of and from, any and all liability, loss or damage which Assignee may or might incur under any Lease or under or by reason of this Assignment and of and from any and all claims and demands whatsoever which may be asserted against Assignee by reason of any alleged obligation or undertaking on its part to observe or perform any of the covenants, terms, conditions and agreements contained in any Lease, except for such claims and demands arising or resulting from the negligent or willful actions of Assignee or its successors or assigns. Should Assignee incur any such liability, loss or damage under any Lease or under or by reason of this Assignment, or in the defense of any such claim or demand, the

amount thereof, including costs, expenses and attorneys' fees, shall become immediately due and payable by Assignor with interest hereon at the Default Rate and shall be secured by this Assignment. This Assignment shall not operate to place responsibility for the care, control, management or repair of the Property or for the carrying out of any of the covenants, terms, conditions and agreements contained in any Lease upon Assignee, nor shall it operate to make Assignee responsible or liable for any waste committed upon the Property by any tenant, occupant or other party, or for any dangerous or defective condition of the Property, or for any negligence in the management, upkeep, repair or control of the Property resulting in loss or injury or death to any tenant, occupant, licensee, employee or stranger. Nothing herein or in the Mortgage contained, and no exercise by Assignee of any of the rights herein or in the Mortgage conferred shall constitute or be construed as constituting Assignee a "mortgagee in possession" of the Property, in the absence of the taking of actual possession of the Property by Assignee pursuant to the provisions hereof. Assignee has not received nor been transferred any security deposited by any tenant with the lessor under the terms of any Lease and Assignee assumes no responsibility or liability for any security so deposited.

8. **Non-Waiver.** Nothing contained in this Assignment and no act done or omitted to be done by Assignee pursuant to the rights and powers granted to it hereunder shall be deemed to be a waiver by Assignee of its rights and remedies under the Note, the guaranty thereof or any of the Loan Documents; this Assignment is made and accepted without prejudice to any of the rights and remedies of Assignee under the terms and provisions of such instruments; and Assignee may exercise any of its rights and remedies under the terms and provisions of such instruments either prior to, simultaneously with, or subsequent to any action taken by it hereunder. Assignee may take or release any other security for the performance of the obligations secured hereby, may release any party primarily or secondarily liable therefor, and may apply any other security held by it for the satisfaction of the obligations secured hereby without prejudice to any of its rights and powers hereunder.

9. **Further Assurances.** Assignor shall execute or cause to be executed such additional instruments (including, but not limited to, general or specific assignments of such Leases as Assignee may designate) and shall do or cause to be done such further acts, as Assignee may reasonably request, in order to permit Assignee to perfect, protect, preserve and maintain the assignment made to Assignee by this Assignment.

10. **Security Deposits.** Assignor hereby acknowledges that Assignee has not received nor been transferred any security deposited by any tenant with lessor under the terms of the Existing Leases and that Assignee assumes no responsibility or liability for any security so deposited.

11. **Written Modifications.** This Assignment shall not be amended, modified or supplemented without the written agreement of Assignor and Assignee at the time of such amendment, modification or supplement.

12. **Duration.** This Assignment shall become null and void at such time as Assignor shall have paid the principal sum of the Note, together with all interest thereon, and shall have fully paid and performed all of the other obligations secured hereby and by the Loan Documents.

13. **Governing Law.** This Assignment shall be governed by and construed in accordance with the substantive laws of the State of Illinois (unless Indiana law requires that Indiana law be applied).

14. **Notices.** All notices and demands which are required or permitted to be given or served hereunder shall be deemed sufficiently served when delivered or mailed in the manner and to the persons described in the Mortgage.

15. **CONSENT TO JURISDICTION.** ASSIGNOR AND ASSIGNEE IRREVOCABLY AGREE THAT, SUBJECT TO ASSIGNEE'S SOLE AND ABSOLUTE ELECTION, ALL ACTIONS OR PROCEEDINGS IN ANY WAY ARISING OUT OF OR RELATED TO THIS ASSIGNMENT OR THE MORTGAGE WILL BE LITIGATED IN COURTS HAVING SITUS IN LAKE COUNTY, INDIANA. ASSIGNOR HEREBY CONSENTS AND SUBMITS TO THE JURISDICTION OF ANY COURT LOCATED WITHIN LAKE COUNTY, INDIANA, WAIVES PERSONAL SERVICE OF PROCESS UPON THE BORROWER, AND AGREES THAT ALL SUCH SERVICE OF PROCESS MAY BE MADE BY REGISTERED MAIL DIRECTED TO THE BORROWER AT THE ADDRESS STATED ON THE MORTGAGE AND SERVICE SO MADE WILL BE DEEMED COMPLETED UPON ACTUAL RECEIPT.

16. **WAIVER OF TRIAL BY JURY.** ASSIGNOR AND ASSIGNEE (BY ACCEPTANCE HEREOF), HAVING BEEN REPRESENTED BY COUNSEL, EACH KNOWINGLY AND VOLUNTARILY WAIVES ANY RIGHT TO A TRIAL BY JURY IN ANY ACTION OR PROCEEDING TO ENFORCE OR DEFEND ANY RIGHTS (a) UNDER THIS ASSIGNMENT OR ANY RELATED AGREEMENT OR UNDER ANY AMENDMENT, INSTRUMENT, DOCUMENT OR AGREEMENT DELIVERED OR WHICH MAY IN THE FUTURE BE DELIVERED IN CONNECTION WITH THIS ASSIGNMENT OR (b) ARISING FROM ANY BANKING RELATIONSHIP EXISTING IN CONNECTION WITH THIS ASSIGNMENT, AND AGREES THAT ANY SUCH ACTION OR PROCEEDING WILL BE TRIED BEFORE A COURT AND NOT BEFORE A JURY. ASSIGNOR AGREES THAT IT WILL NOT ASSERT ANY CLAIM AGAINST ASSIGNEE OR ANY OTHER PERSON INDEMNIFIED UNDER THIS ASSIGNMENT ON ANY THEORY OF LIABILITY FOR SPECIAL, INDIRECT, CONSEQUENTIAL, INCIDENTAL OR PUNITIVE DAMAGES.

[Signatures on following page]



IN WITNESS WHEREOF, Assignor has executed and delivered this Assignment as of the day and year first above written.

ASSIGNOR:

LAKESHORE DUNES LIMITED PARTNERSHIP, an Illinois limited partnership

By: Lakeshore Dunes General LLC, an Illinois limited liability company, its General Partner

By: Kinzie Assets, LLC, an Illinois limited liability company, its sole member and manager

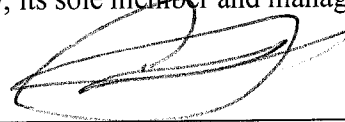
By: 
Charles F. Clarke, III, a member

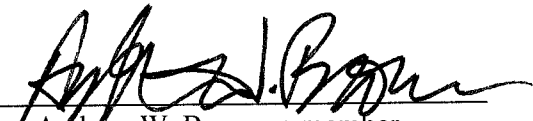
By: 
Andrew W. Brown, a member

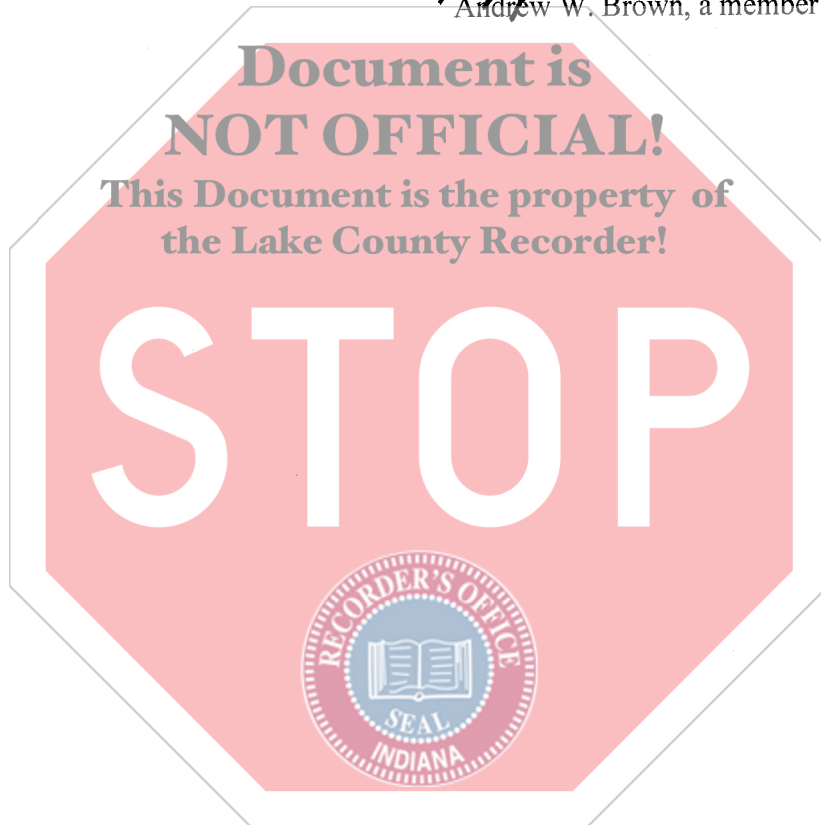

STATE OF IL)
COUNTY OF LAKE) SS.

I, the undersigned, a Notary Public in and for said County, in the State aforesaid, do hereby certify that Charles F. Clarke, III, a Member of Kinzie Assets, LLC, an Illinois limited liability company, which is the Sole Member and Manager of Lakeshore Dunes General LLC, an Illinois limited liability company, which is the General Partner of LAKESHORE DUNES LIMITED PARTNERSHIP, an Illinois limited partnership (the "Company"), personally known to me to be the same person whose name is subscribed to the foregoing instrument as such Member, appeared before me this day in person and acknowledged that he signed and delivered the said instrument as his own free and voluntary act, as the free and voluntary act of Company, for the uses and purposes therein set forth.

GIVEN under my hand and notarial seal, this 15th day of August, 2012.

(SEAL)

My Commission Expires: _____

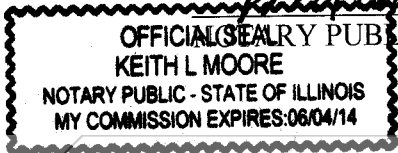

STATE OF IL)

COUNTY OF LAKE)

Document is NOT OFFICIAL!
This document is the property of the Lake County Recorder!

I, the undersigned, a Notary Public in and for said County, in the State aforesaid, do hereby certify that Andrew W. Brown, a Member of Kinzie Assets, LLC, an Illinois limited liability company, which is the Sole Member and Manager of Lakeshore Dunes General LLC, an Illinois limited liability company, which is the General Partner of LAKESHORE DUNES LIMITED PARTNERSHIP, an Illinois limited partnership (the "Company"), personally known to me to be the same person whose name is subscribed to the foregoing instrument as such Member, appeared before me this day in person and acknowledged that he signed and delivered the said instrument as his own free and voluntary act, as the free and voluntary act of Company, for the uses and purposes therein set forth.

GIVEN under my hand and notarial seal, this 15th day of August, 2012.

(SEAL)

My Commission Expires: _____



NOTARY PAGE
ASSIGNMENT OF RENTS AND LEASES

EXHIBIT A

LEGAL DESCRIPTION

PROPERTY EAST OF LAKE STREET:

PARCEL F1: LOTS 17 TO 24, BOTH INCLUSIVE, AND THE VACATED SOUTH 20 FEET OF HICKORY AVENUE, NOW FOREST AVENUE, LYING NORTH OF AND ADJACENT TO SAID LOT 17, AND THE VACATED NORTH 20 FEET OF HEMLOCK AVENUE LYING SOUTH OF AND ADJACENT TO SAID LOT 24, AND THE WEST HALF OF THE VACATED 20 FOOT ALLEY WHICH ADJOINS LOTS 17 TO 24, BOTH INCLUSIVE, ON THE EAST, ALL IN BLOCK "A", IN THE JOHNSON-KENNEDY ESTATES SECOND SUBDIVISION, IN THE CITY OF GARY, AS PER PLAT THEREOF, AS RECORDED IN PLAT BOOK 17, PAGE 15, IN THE RECORDER'S OFFICE OF LAKE COUNTY, INDIANA.

TAX IDENTIFICATION NUMBER: 45-05-31-405-001.000-004

PARCEL F6: LOTS 18 TO 26, BOTH INCLUSIVE, BLOCK "C", JOHNSON-KENNEDY ESTATES SECOND SUBDIVISION, IN THE CITY OF GARY, AS PER PLAT THEREOF, AS RECORDED IN PLAT BOOK 17, PAGE 15, IN THE RECORDER'S OFFICE OF LAKE COUNTY, INDIANA.

TAX IDENTIFICATION NUMBER: 45-05-31-407-002.000-004

PROPERTY WEST OF LAKE STREET:

PART OF THE NORTHWEST QUARTER OF THE SOUTHEAST QUARTER OF SECTION 31, TOWNSHIP 37 NORTH, RANGE 7 WEST OF THE SECOND PRINCIPAL MERIDIAN, DESCRIBED AS FOLLOWS: COMMENCING AT A MONUMENT AT THE INTERSECTION OF THE CENTER LINE OF CYPRESS AVENUE AND THE WEST LINE OF SAID SOUTHEAST QUARTER OF SECTION 31; THENCE NORTH ALONG SAID WEST LINE OF SAID SOUTHEAST QUARTER A DISTANCE OF 30 FEET TO THE NORTH RIGHT-OF-WAY LINE OF CYPRESS AVENUE AND THE POINT OF BEGINNING; THENCE NORTH 00 DEGREES 21 MINUTES 38 SECONDS WEST 1,447.88 FEET ALONG SAID WEST LINE (SAID WEST LINE ALTERNATELY DESCRIBED AS THE CENTER LINE OF THE SECTION AND THE WEST LINE OF GOVERNMENT LOT 5), TO THE GRAND CALUMET RIVER LAGOON; THENCE EASTERLY ALONG THE WATER'S EDGE OF SAID LAGOON FOR THE NEXT THREE COURSES, NORTH 79 DEGREES 07 MINUTES 51 SECONDS EAST 297.50 FEET, NORTH 77 DEGREES 29 MINUTES 56 SECONDS EAST 152.57 FEET, NORTH 78 DEGREES 43 MINUTES 43 SECONDS EAST 151.99 FEET TO THE WEST LINE OF LAKE STREET; THENCE SOUTH 01 DEGREES 48 MINUTES 30 SECONDS EAST 398.78 FEET TO THE NORTH RIGHT-OF-WAY LINE OF FOREST COURT; THENCE NORTH 89 DEGREES 59 MINUTES 22 SECONDS WEST ALONG THE NORTH RIGHT-OF-WAY LINE 300.02 FEET; THENCE NORTHWESTERLY 189.77 FEET ALONG AN ARC HAVING A RADIUS OF 40 FEET, A CHORD OF 55.66 FEET AND A CHORD BEARING OF SOUTH 44 DEGREES 06 MINUTES 04 SECONDS WEST TO A POINT WHICH IS 373.02 FEET WESTERLY FROM THE CENTER LINE OF SAID LAKE STREET; THENCE SOUTH 01 DEGREE 48 MINUTES 30 SECONDS EAST 10.03 FEET TO THE SOUTH RIGHT-OF-WAY LINE OF FOREST COURT; THENCE SOUTH 89 DEGREES 59 MINUTES 22 SECONDS EAST ALONG THE SAID RIGHT-OF-WAY LINE 340.02 FEET TO THE WEST RIGHT-OF-WAY LINE OF SAID LAKE STREET; THENCE SOUTH 01 DEGREE 48 MINUTES 30 SECONDS EAST 380.54 FEET ALONG SAID

EXHIBIT A

WEST RIGHT-OF-WAY AND CROSSING HEMLOCK AVENUE ALONG ITS INTERSECTION WITH SAID LINE, TO THE SOUTHEAST CORNER OF LOT 16, BLOCK 3; JOHNSON-KENNEDY ESTATES FOURTH SUBDIVISION, AS PER PLAT THEREOF, RECORDED IN PLAT BOOK 22, PAGE 2, IN THE OFFICE OF THE RECORDER OF LAKE COUNTY, INDIANA; THENCE NORTH 89 DEGREES 59 MINUTES 22 SECONDS WEST ALONG THE SOUTH LINE OF SAID LOT 16, 133.55 FEET TO THE SOUTHWEST CORNER THEREOF; THENCE SOUTH 01 DEGREE 48 MINUTES 30 SECONDS EAST 440.17 FEET AND CROSSING KENNEDY TERRACE; THENCE SOUTH 89 DEGREES 59 MINUTES 22 SECONDS EAST 133.55 FEET TO THE WEST RIGHT-OF-WAY LINE OF SAID LAKE STREET; THENCE SOUTH 01 DEGREE 48 MINUTES 30 SECONDS EAST ALONG SAID RIGHT-OF-WAY LINE 298.12 FEET TO THE NORTH RIGHT-OF-WAY LINE OF SAID CYPRESS AVENUE; THENCE NORTH 89 DEGREES 59 MINUTES 22 SECONDS WEST ALONG SAID NORTH RIGHT-OF-WAY LINE 630.66 FEET TO THE POINT OF BEGINNING, ALL IN LAKE COUNTY, INDIANA.

TAX IDENTIFICATION NUMBERS: 45-05-31-401-001.000-004
45-05-31-402-003.000-004
45-05-31-401-002.000-004
45-05-31-402-002.000-004
45-05-31-401-003.000-004
45-05-31-403-003.000-004
45-05-31-403-001.000-004
45-05-31-402-001.000-004
45-05-31-404-005.000-004
~~45-05-31-404-002.000-004~~
~~45-05-31-404-001.000-004~~
45-05-31-403-004.000-004
45-05-31-404-004.000-004
45-05-31-403-002.000-004
45-05-31-404-003.000-004
~~45-05-31-404-010.000-004~~
45-05-31-403-006.000-004
45-05-31-403-007.000-004
45-05-31-403-008.000-004

PROPERTY ADDRESS: 440 N. LAKE STREET, GARY, IN



EXHIBIT B

LEASES

(See Rent Roll Attached)



EXHIBIT B

EXHIBIT B

LEASES

(See Rent Roll Attached)



EXHIBIT B

Rent Roll
Lakeshore Dunes LP (lsd)
As of: 07/23/2012

| UNIT | UNIT TYPE | UNIT SF | RESIDENT | RESIDENT NAME | MARKET RENT | ACTUAL RENT | DEPOSIT | OTHER DEPOSIT | MOVE IN | MOVE OUT |
|------|-----------|---------|----------|--------------------------|-------------|-------------|----------|---------------|------------|------------|
| A001 | lsd:2-1 | 760 | tolinat | Natoya Tolar | 670.00 | 670.00 | 99.00 | 0.00 | 04/20/2010 | 05/31/2013 |
| A002 | lsd:1-1 | 470 | patlor | Loretta Patton | 531.00 | 531.00 | 450.00 | 0.00 | 10/22/2007 | 11/30/2012 |
| A003 | lsd:1-1 | 470 | harfra | Frances Harris | 550.00 | 550.00 | 300.00 | 0.00 | 07/31/2010 | 08/31/2011 |
| A004 | lsd:2-1 | 760 | t0000922 | Tiffany Granberry | 600.00 | 600.00 | 1,200.00 | 0.00 | 05/24/2012 | 06/30/2013 |
| A005 | lsd:2-1 | 760 | t0000728 | Shareese Boyd | 600.00 | 600.00 | 399.00 | 0.00 | 04/26/2012 | 05/31/2013 |
| A006 | lsd:1-1 | 470 | edgrob | Edgewater Systems | 575.00 | 0.00 | 671.00 | 0.00 | 12/29/2011 | 12/31/2012 |
| A007 | lsd:1-1 | 470 | t0000393 | Irma Thomas | 530.00 | 530.00 | 399.00 | 0.00 | 02/29/2012 | 03/31/2013 |
| A008 | lsd:2-1 | 760 | VACANT | VACANT | 605.00 | 0.00 | 0.00 | 0.00 | | |
| A009 | lsd:2-1 | 760 | VACANT | VACANT | 640.00 | 0.00 | 0.00 | 0.00 | | |
| A010 | lsd:1-1 | 470 | VACANT | VACANT | 530.00 | 0.00 | 0.00 | 0.00 | | |
| A011 | lsd:1-1 | 470 | VACANT | VACANT | 520.00 | 0.00 | 0.00 | 0.00 | | |
| A012 | lsd:2-1 | 760 | VACANT | VACANT | 640.00 | 0.00 | 0.00 | 0.00 | | |
| A013 | lsd:2-1 | 760 | willar | Larry Williams | 671.00 | 671.00 | 575.00 | 25.00 | 08/01/2004 | 07/31/2011 |
| A014 | lsd:1-1 | 470 | t0000720 | Shaneise Kincaid | 540.00 | 540.00 | 399.00 | 0.00 | 04/30/2012 | 05/31/2013 |
| A015 | lsd:1-1 | 470 | t0000399 | Akinda Shepard | 530.00 | 530.00 | 399.00 | 0.00 | 02/29/2012 | 03/31/2013 |
| A016 | lsd:2-1 | 760 | t0000571 | Kashica Bennett | 625.00 | 625.00 | 399.00 | 0.00 | 04/05/2012 | 04/30/2013 |
| A101 | lsd:2-1 | 760 | t0000755 | South Shore Baseball LLC | 675.00 | 675.00 | 0.00 | 0.00 | 04/30/2012 | 09/30/2012 |
| A102 | lsd:3-1 | 950 | hayroo | Roosevelt Haywood III | 797.00 | 797.00 | 674.00 | 25.00 | 10/01/2004 | 10/31/2012 |
| A103 | lsd:1-2 | 610 | ryacas | Cassandra Ryan | 585.00 | 585.00 | 99.00 | 0.00 | 05/31/2011 | 06/30/2013 |
| A104 | lsd:2-1 | 760 | lawstyl | Sylvia Lawson-Cleveland | 680.00 | 680.00 | 350.00 | 0.00 | 02/28/2007 | 04/30/2013 |
| A105 | lsd:2-1 | 760 | VACANT | VACANT | 660.00 | 0.00 | 0.00 | 0.00 | | |
| A106 | lsd:3-1 | 950 | campac | A. C Campbell | 885.00 | 885.00 | 400.00 | 0.00 | 05/28/2009 | 06/30/2013 |
| A107 | lsd:1-2 | 610 | holpat | Patti Holloway | 570.00 | 570.00 | 99.00 | 0.00 | 08/31/2006 | 10/31/2012 |
| A108 | lsd:2-1 | 760 | cooken | Kenyatta Cooper | 640.00 | 640.00 | 300.00 | 0.00 | 07/31/2010 | 08/31/2012 |
| A109 | lsd:2-1 | 760 | VACANT | VACANT | 650.00 | 0.00 | 0.00 | 0.00 | | |
| A110 | lsd:3-1 | 950 | VACANT | VACANT | 825.00 | 0.00 | 0.00 | 0.00 | | |
| A111 | lsd:1-2 | 610 | VACANT | VACANT | 540.00 | 0.00 | 0.00 | 0.00 | | |
| A112 | lsd:2-1 | 760 | VACANT | VACANT | 605.00 | 0.00 | 0.00 | 0.00 | | |
| A113 | lsd:2-1 | 760 | t0000365 | Leslee Scott | 625.00 | 625.00 | 1,300.00 | 0.00 | 02/29/2012 | 03/31/2013 |
| A114 | lsd:3-1 | 950 | balant | Antonette Balbosa | 850.00 | 850.00 | 100.00 | 0.00 | 09/30/2011 | 10/31/2012 |
| A115 | lsd:1-2 | 610 | balric | Richard Balkom | 575.00 | 575.00 | 99.00 | 0.00 | 07/31/2010 | 08/31/2011 |
| A116 | lsd:2-1 | 760 | t0000623 | Jill Gerloff | 600.00 | 600.00 | 399.00 | 0.00 | 03/31/2012 | 04/30/2013 |
| A201 | lsd:2-1 | 760 | fulfra | Frank Fuller | 675.00 | 675.00 | 99.00 | 0.00 | 05/13/2011 | 05/31/2012 |
| A202 | lsd:3-1 | 950 | guyapr | April Guydon | 875.00 | 386.00 | 300.00 | 0.00 | 01/06/2012 | 12/31/2012 |
| A203 | lsd:1-2 | 610 | russrob | Robert Russell | 535.00 | 535.00 | 99.00 | 0.00 | 12/31/2008 | 01/31/2013 |
| A204 | lsd:2-1 | 760 | juljam | Jamar Julkes | 625.00 | 625.00 | 99.00 | 0.00 | 05/01/2011 | 04/30/2013 |
| A205 | lsd:2-1 | 760 | mcecha | Charita McElroy | 660.00 | 660.00 | 399.00 | 0.00 | 06/30/2011 | 07/31/2012 |
| A206 | lsd:3-1 | 950 | revdor | Dorothy Reveler | 806.00 | 806.00 | 692.00 | 25.00 | 09/01/2004 | 08/31/2013 |
| A207 | lsd:1-2 | 610 | edwflfe | Edgewater Systems | 575.00 | 0.00 | 671.00 | 0.00 | 12/30/2011 | 12/31/2012 |

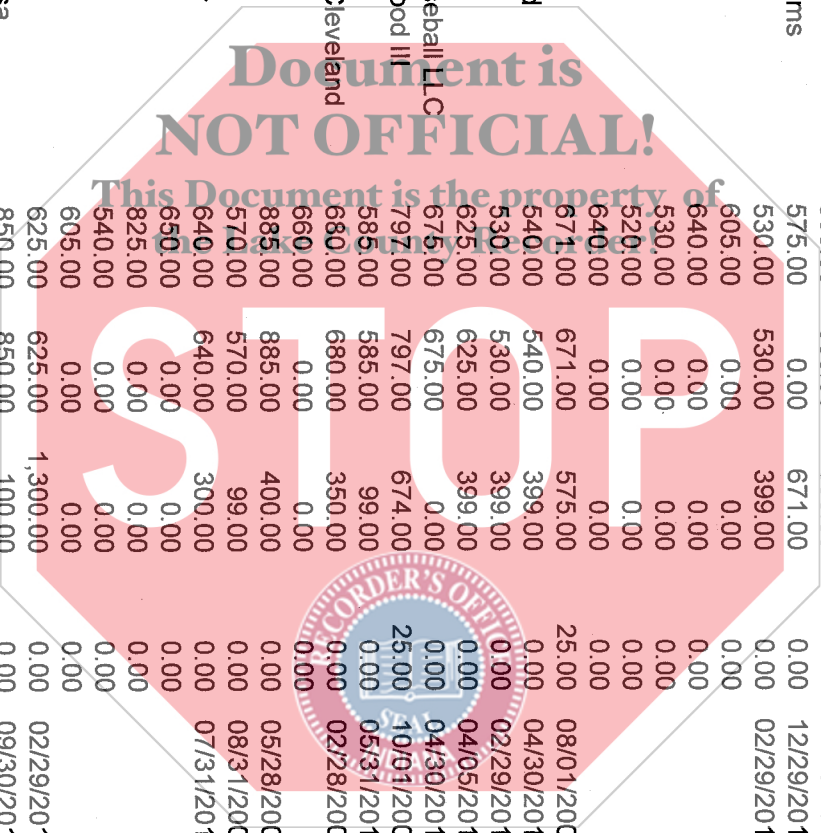

Rent Roll
Lakeshore Dunes LP (Isd)
As of: 07/23/2012

| UNIT | UNIT TYPE | UNIT SF | RESIDENT | RESIDENT NAME | MARKET RENT | ACTUAL RENT | DEPOSIT | OTHER DEPOSIT | MOVE IN | MOVE OUT |
|------|-----------|---------|----------|-------------------------|-------------|-------------|----------|---------------|------------|------------|
| A208 | Isd:2-1 | 760 | t0001008 | Gregory West | 625.00 | 625.00 | 399.00 | 0.00 | 05/31/2012 | 06/30/2013 |
| A209 | Isd:2-1 | 760 | VACANT | VACANT | 670.00 | 0.00 | 0.00 | 0.00 | | |
| A210 | Isd:3-1 | 950 | VACANT | VACANT | 852.00 | 0.00 | 0.00 | 0.00 | | |
| A211 | Isd:1-2 | 610 | VACANT | VACANT | 560.00 | 0.00 | 0.00 | 0.00 | | |
| A212 | Isd:2-1 | 760 | VACANT | VACANT | 625.00 | 0.00 | 0.00 | 0.00 | | |
| A213 | Isd:2-1 | 760 | t0000975 | Jimmie Davis | 600.00 | 600.00 | 399.00 | 0.00 | 05/31/2012 | 06/30/2013 |
| A214 | Isd:3-1 | 950 | aleken | Kenyarda Wingard-Alexan | 895.00 | 0.00 | 99.00 | 0.00 | 05/13/2011 | 04/30/2013 |
| A215 | Isd:1-2 | 610 | t0000617 | Levinia Lewis | 550.00 | 550.00 | 399.00 | 0.00 | 03/31/2012 | 04/30/2013 |
| A216 | Isd:2-1 | 760 | palhat | Natasha Palmer | 640.00 | 640.00 | 99.00 | 0.00 | 11/29/2011 | 05/31/2013 |
| B001 | Isd:2-2 | 845 | VACANT | VACANT | 630.00 | 0.00 | 0.00 | 0.00 | | |
| B002 | Isd:2-2 | 845 | VACANT | VACANT | 630.00 | 0.00 | 0.00 | 0.00 | | |
| B003 | Isd:2-2 | 845 | VACANT | VACANT | 630.00 | 0.00 | 0.00 | 0.00 | | |
| B004 | Isd:2-2 | 845 | VACANT | VACANT | 630.00 | 0.00 | 0.00 | 0.00 | | |
| B005 | Isd:3-1 | 950 | VACANT | VACANT | 675.00 | 0.00 | 0.00 | 0.00 | | |
| B006 | Isd:1-4 | 710 | VACANT | VACANT | 565.00 | 0.00 | 0.00 | 0.00 | | |
| B008 | Isd:2-2 | 845 | VACANT | VACANT | 630.00 | 0.00 | 0.00 | 0.00 | | |
| B010 | Isd:2-2 | 845 | t0001025 | Sandford Proctor | 600.00 | 600.00 | 1,200.00 | 0.00 | 06/07/2012 | 06/30/2013 |
| B011 | Isd:1-3 | 550 | trokei | Keith Troutman | 530.00 | 530.00 | 300.00 | 0.00 | 02/28/2011 | 03/31/2013 |
| B012 | Isd:2-2 | 845 | t0001003 | Arni Dust | 600.00 | 600.00 | 399.00 | 0.00 | 05/31/2012 | 06/30/2013 |
| B013 | Isd:2-2 | 845 | VACANT | VACANT | 630.00 | 0.00 | 0.00 | 0.00 | | |
| B014 | Isd:2-2 | 845 | VACANT | VACANT | 630.00 | 0.00 | 0.00 | 0.00 | | |
| B101 | Isd:2-2 | 845 | t0000958 | Nakeisha Torbert | 600.00 | 600.00 | 399.00 | 0.00 | 05/30/2012 | 06/30/2013 |
| B102 | Isd:2-2 | 845 | t0000951 | Tina Harris | 640.00 | 640.00 | 399.00 | 0.00 | 05/29/2012 | 06/30/2013 |
| B103 | Isd:2-3 | 855 | VACANT | VACANT | 672.00 | 0.00 | 0.00 | 0.00 | | |
| B104 | Isd:2-3 | 855 | shacan | Candida Sharp | 660.00 | 181.00 | 300.00 | 0.00 | 11/01/2010 | 10/31/2012 |
| B105 | Isd:3-1 | 950 | boyjon | Jonnel Boyd | 718.00 | 718.00 | 99.00 | 0.00 | 04/30/2006 | 05/31/2013 |
| B106 | Isd:1-4 | 710 | shadav | David Shackelford | 584.00 | 584.00 | 508.00 | 25.00 | 06/29/2002 | 06/30/2013 |
| B107 | Isd:1-3 | 550 | millian | Lana Miller | 552.00 | 552.00 | 480.00 | 0.00 | 10/31/2007 | 11/30/2011 |
| B108 | Isd:2-2 | 845 | brashy | Shylonda Bravo | 675.00 | 563.00 | 625.00 | 25.00 | 09/01/2004 | 08/31/2010 |
| B109 | Isd:2-2 | 845 | t0000979 | Fannie Pippin | 600.00 | 600.00 | 399.00 | 0.00 | 05/31/2012 | 06/30/2013 |
| B110 | Isd:2-2 | 845 | t0000937 | Lacresha Clark | 640.00 | 640.00 | 399.00 | 0.00 | 05/30/2012 | 06/30/2013 |
| B111 | Isd:2-2 | 845 | t0001172 | Delanie Benson | 635.00 | 640.00 | 399.00 | 0.00 | 06/30/2012 | 07/31/2013 |
| B112 | Isd:2-2 | 845 | mulmar | Mary Mulligan | 675.00 | 675.00 | 561.00 | 25.00 | 09/01/2004 | 08/31/2012 |
| B113 | Isd:2-2 | 845 | t0001010 | Khalliah Farrakhan | 640.00 | 640.00 | 1,181.00 | 0.00 | 05/31/2012 | 06/30/2013 |
| B114 | Isd:2-2 | 845 | t0000929 | Vernice Muhammad | 640.00 | 640.00 | 1,088.00 | 0.00 | 06/06/2012 | 06/30/2013 |
| B201 | Isd:2-2 | 845 | walcar | Carolyn Walker | 600.00 | 600.00 | 399.00 | 0.00 | 11/30/2011 | 12/31/2012 |
| B202 | Isd:2-2 | 845 | t0001012 | Edna Anderson | 640.00 | 640.00 | 399.00 | 0.00 | 05/31/2012 | 06/30/2013 |
| B203 | Isd:2-3 | 855 | t0000425 | Beverly Ratcliff | 635.00 | 600.00 | 399.00 | 0.00 | 05/21/2012 | 05/31/2013 |
| B204 | Isd:2-3 | 855 | t0000993 | Keshuna Billingsley | 640.00 | 640.00 | 800.00 | 0.00 | 05/31/2012 | 06/30/2013 |

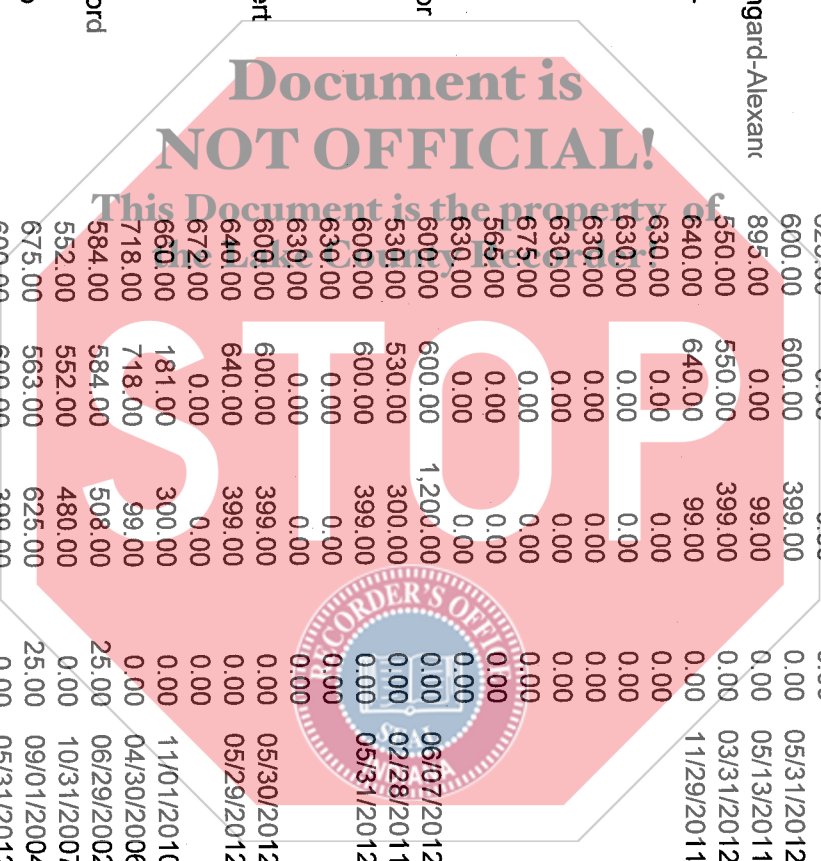

Rent Roll
Lakeshore Dunes LP (lsd)
As of: 07/23/2012

| UNIT | UNIT TYPE | UNIT SF | RESIDENT | RESIDENT NAME | MARKET RENT | ACTUAL RENT | DEPOSIT | OTHER DEPOSIT | MOVE IN | MOVE OUT |
|------|-----------|---------|----------|-------------------------|-------------|-------------|----------|---------------|------------|------------|
| B205 | lsd:3-1 | 950 | ky/wil | Wiley Kyles | 665.00 | 665.00 | 536.00 | 25.00 | 08/01/2004 | 07/31/2013 |
| B206 | lsd:2-2 | 845 | morjam | Jamie Morrow | 673.00 | 20.00 | 650.00 | 0.00 | 02/11/2010 | 01/31/2013 |
| B207 | lsd:1-3 | 550 | edgbra | Edgewater Systems | 575.00 | 0.00 | 671.00 | 0.00 | 12/15/2011 | 12/31/2012 |
| B208 | lsd:2-2 | 845 | byrded | Dedric Byrd | 660.00 | 660.00 | 325.00 | 0.00 | 01/25/2010 | 02/28/2013 |
| B209 | lsd:2-2 | 845 | marlav | Laverne Martin | 675.00 | 685.00 | 645.00 | 0.00 | 05/31/2009 | 06/30/2013 |
| B210 | lsd:2-2 | 845 | VACANT | VACANT | 630.00 | 0.00 | 0.00 | 0.00 | | |
| B211 | lsd:2-2 | 845 | t0000042 | Lovonda Banks | 600.00 | 600.00 | 399.00 | 0.00 | 01/06/2012 | 01/31/2013 |
| B212 | lsd:2-2 | 845 | loclak | Lakresha Lockhart | 640.00 | 640.00 | 350.00 | 0.00 | 10/01/2010 | 09/30/2012 |
| B213 | lsd:2-2 | 845 | brojam | James Brown Jr | 670.00 | 670.00 | 99.00 | 0.00 | 06/28/2008 | 07/31/2013 |
| B214 | lsd:2-2 | 845 | bivton | Tonisha Mitchell Bivens | 600.00 | 600.00 | 399.00 | 0.00 | 09/01/2011 | 08/31/2012 |
| B301 | lsd:2-2 | 845 | tralal | Latanza Traywick | 707.00 | 0.00 | 544.00 | 25.00 | 07/01/2006 | 06/30/2013 |
| B302 | lsd:2-2 | 845 | t0000699 | Ronald Thrash | 640.00 | 640.00 | 399.00 | 0.00 | 04/30/2012 | 05/31/2013 |
| B303 | lsd:2-3 | 855 | stekan | Kandy Stephens | 660.00 | 660.00 | 99.00 | 0.00 | 07/31/2010 | 08/31/2011 |
| B304 | lsd:2-3 | 855 | harray | Raymond Harris | 675.00 | 675.00 | 575.00 | 25.00 | 01/24/2005 | 08/31/2012 |
| B305 | lsd:3-1 | 950 | t0001145 | Julia Horn | 650.00 | 650.00 | 975.00 | 0.00 | 06/30/2012 | 07/31/2013 |
| B306 | lsd:2-2 | 845 | VACANT | VACANT | 630.00 | 0.00 | 0.00 | 0.00 | | |
| B307 | lsd:1-3 | 550 | t0000809 | Jackelyn Araque | 540.00 | 540.00 | 399.00 | 0.00 | 05/11/2012 | 06/30/2013 |
| B308 | lsd:2-2 | 845 | t0001131 | Juginia Brooks | 600.00 | 640.00 | 399.00 | 0.00 | 06/30/2012 | 07/31/2013 |
| B309 | lsd:2-2 | 845 | VACANT | VACANT | 600.00 | 0.00 | 0.00 | 0.00 | | |
| B310 | lsd:2-2 | 845 | t0001199 | Michael Toigo | 630.00 | 600.00 | 399.00 | 0.00 | 06/30/2012 | 07/31/2013 |
| B311 | lsd:2-2 | 845 | t0001189 | Jamie Frost | 630.00 | 640.00 | 640.00 | 0.00 | 06/30/2012 | 07/31/2013 |
| B312 | lsd:2-2 | 845 | crarus | Rushelle Crane | 680.00 | 680.00 | 100.00 | 0.00 | 07/31/2010 | 03/31/2012 |
| B313 | lsd:2-2 | 845 | t0001057 | Shenaye Edmonds | 600.00 | 600.00 | 399.00 | 0.00 | 06/05/2012 | 06/30/2013 |
| B314 | lsd:2-2 | 845 | llokev | Kevin Lloyd | 600.00 | 600.00 | 600.00 | 0.00 | 12/31/2011 | 01/31/2013 |
| B401 | lsd:2-2 | 845 | t0000232 | Aleeza Cotton | 600.00 | 600.00 | 1,200.00 | 0.00 | 01/31/2012 | 02/28/2013 |
| B402 | lsd:2-2 | 845 | crichr | Dorothy Cribbs | 685.00 | 685.00 | 630.00 | 0.00 | 04/30/2008 | 05/31/2013 |
| B403 | lsd:2-3 | 855 | harand | Andrea Harris | 685.00 | 685.00 | 564.00 | 25.00 | 04/01/2005 | 03/31/2013 |
| B404 | lsd:2-3 | 855 | t0000026 | Shawn Ross | 600.00 | 600.00 | 699.00 | 0.00 | 04/01/2012 | 03/31/2013 |
| B405 | lsd:3-1 | 950 | VACANT | VACANT | 650.00 | 0.00 | 0.00 | 0.00 | | |
| B406 | lsd:2-2 | 845 | beaani | Anita Beavers | 680.00 | 680.00 | 300.00 | 0.00 | 02/25/2010 | 03/31/2013 |
| B407 | lsd:1-3 | 550 | slagwe | Gwendolyn Slaughter | 560.00 | 560.00 | 1,120.00 | 0.00 | 11/17/2011 | 12/31/2012 |
| B408 | lsd:2-2 | 845 | t0000078 | Latricia Mason | 1,100.00 | 1,100.00 | 1,100.00 | 0.00 | 01/10/2012 | 01/31/2013 |
| B409 | lsd:2-2 | 845 | thotom | Tommy Thompson | 689.00 | 689.00 | 578.00 | 25.00 | 05/01/2005 | 04/30/2013 |
| B411 | lsd:2-2 | 845 | jobjas | Jason Johnson | 670.00 | 670.00 | 99.00 | 0.00 | 01/01/2010 | 12/31/2012 |
| B412 | lsd:2-2 | 845 | ruslat | Latoya Russell | 1,025.00 | 1,025.00 | 0.00 | 0.00 | 08/31/2011 | 08/31/2012 |
| B413 | lsd:2-2 | 845 | hawwil | Willie Hawthorne | 670.00 | 670.00 | 602.00 | 25.00 | 11/01/2004 | 10/31/2012 |
| C001 | lsd:2-2 | 845 | VACANT | VACANT | 630.00 | 0.00 | 0.00 | 0.00 | | |
| C002 | lsd:2-2 | 845 | t0001125 | Amanda Ross | 650.00 | 600.00 | 399.00 | 0.00 | 06/30/2012 | 07/31/2013 |
| C003 | lsd:2-3 | 855 | t0000606 | Aylich Artiez | 600.00 | 600.00 | 399.00 | 0.00 | 03/31/2012 | 04/30/2013 |

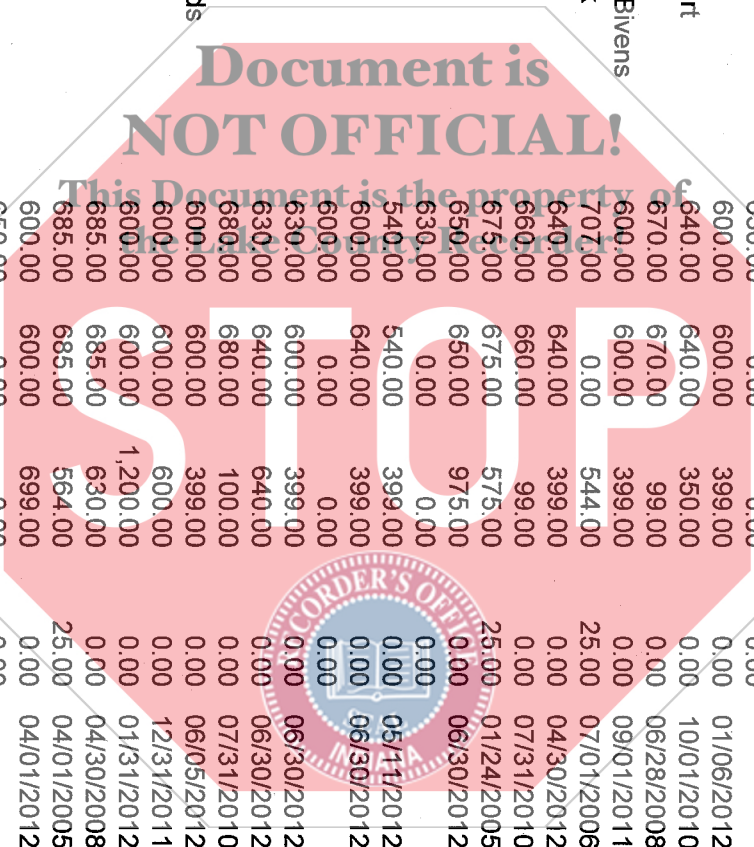

Rent Roll
Lakeshore Dunes LP (Isd)
As of: 07/23/2012

| UNIT | UNIT TYPE | UNIT SF | RESIDENT | RESIDENT NAME | MARKET RENT | ACTUAL RENT | DEPOSIT | OTHER DEPOSIT | MOVE IN | MOVE OUT |
|------|-----------|---------|----------|--------------------------|-------------|-------------|----------|---------------|------------|------------|
| C004 | Isd:2-3 | 855 | hiddeb-e | Debra Hightower | 640.00 | 640.00 | 99.00 | 0.00 | 05/31/2011 | 06/30/2013 |
| C005 | Isd:3-1 | 950 | t0000855 | Alicia Smith | 600.00 | 600.00 | 900.00 | 0.00 | 05/14/2012 | 05/31/2013 |
| C006 | Isd:1-4 | 710 | t0000125 | Antionette Pole | 550.00 | 550.00 | 399.00 | 0.00 | 01/20/2012 | 01/31/2013 |
| C008 | Isd:2-3 | 855 | VACANT | VACANT | 635.00 | 0.00 | 0.00 | 0.00 | | |
| C010 | Isd:2-3 | 855 | t0001146 | Jasmine Steed | 600.00 | 600.00 | 1,200.00 | 0.00 | 06/30/2012 | 07/31/2013 |
| C011 | Isd:1-1 | 470 | lovdeo | Deonte Love | 535.00 | 535.00 | 99.00 | 0.00 | 06/30/2011 | 07/31/2012 |
| C012 | Isd:2-3 | 855 | VACANT | VACANT | 635.00 | 0.00 | 0.00 | 0.00 | | |
| C013 | Isd:2-2 | 845 | t0000928 | Barbara Fry | 600.00 | 600.00 | 399.00 | 0.00 | 05/25/2012 | 06/30/2013 |
| C014 | Isd:2-2 | 845 | rucjos | Joshua Rucker | 625.00 | 625.00 | 575.00 | 0.00 | 01/31/2012 | 01/31/2013 |
| C101 | Isd:2-2 | 845 | t0000559 | Theresa Thomas | 600.00 | 600.00 | 600.00 | 0.00 | 03/31/2012 | 04/30/2013 |
| C102 | Isd:2-2 | 845 | t0000074 | Nashanta Taylor-Weems | 600.00 | 600.00 | 399.00 | 0.00 | 01/11/2012 | 01/31/2013 |
| C103 | Isd:2-3 | 855 | hownor | Norma Howard | 650.00 | 650.00 | 650.00 | 0.00 | 10/30/2011 | 11/30/2012 |
| C104 | Isd:2-3 | 855 | t0000174 | Jaylen Wilson | 660.00 | 600.00 | 399.00 | 0.00 | 06/30/2012 | 06/30/2013 |
| C105 | Isd:3-1 | 950 | abrobb | Robbin Abrams | 660.00 | 660.00 | 99.00 | 0.00 | 08/31/2011 | 09/30/2012 |
| C106 | Isd:1-4 | 710 | t0000051 | Arthur Johnson | 520.00 | 520.00 | 520.00 | 0.00 | 01/06/2012 | 01/31/2013 |
| C107 | Isd:1-3 | 550 | t0000721 | Amber Sherrod | 540.00 | 540.00 | 399.00 | 0.00 | 04/30/2012 | 05/31/2013 |
| C108 | Isd:2-3 | 855 | t0000166 | Tiffani Murphy | 600.00 | 600.00 | 1,200.00 | 0.00 | 01/31/2012 | 02/28/2013 |
| C109 | Isd:2-3 | 855 | t0000194 | Aaron Patterson | 600.00 | 600.00 | 399.00 | 0.00 | 01/31/2012 | 02/28/2013 |
| C110 | Isd:2-3 | 855 | t0000826 | Cari Oladiji | 610.00 | 610.00 | 399.00 | 0.00 | 05/10/2012 | 05/31/2013 |
| C111 | Isd:2-3 | 855 | ezeter | Terry Ezell | 661.00 | 661.00 | 561.00 | 25.00 | 06/01/2005 | 05/31/2013 |
| C112 | Isd:2-3 | 855 | VACANT | VACANT | 661.00 | 0.00 | 0.00 | 0.00 | | |
| C113 | Isd:2-2 | 845 | t0001137 | Erika Sherrod | 661.00 | 640.00 | 399.00 | 0.00 | 06/20/2012 | 07/31/2013 |
| C114 | Isd:2-2 | 760 | ganjan | Jani Gant | 675.00 | 675.00 | 575.00 | 0.00 | 10/01/2010 | 09/30/2011 |
| C201 | Isd:2-2 | 845 | t0000752 | South Shore Baseball LLC | 675.00 | 675.00 | 0.00 | 0.00 | 04/30/2012 | 09/30/2012 |
| C202 | Isd:2-2 | 845 | murrou | Ouida Murry | 645.00 | 645.00 | 99.00 | 0.00 | 12/31/2008 | 01/31/2013 |
| C203 | Isd:2-3 | 855 | t0000127 | Mickiela Willey | 600.00 | 600.00 | 399.00 | 0.00 | 01/31/2012 | 02/28/2013 |
| C204 | Isd:2-3 | 855 | trinc | Nicole Trice | 640.00 | 640.00 | 399.00 | 0.00 | 08/31/2011 | 09/30/2012 |
| C205 | Isd:3-1 | 950 | freiel | Leland Free | 670.00 | 670.00 | 350.00 | 0.00 | 02/28/2010 | 02/28/2013 |
| C206 | Isd:2-3 | 855 | wyetyr | Tyrone Wyr | 650.00 | 650.00 | 99.00 | 0.00 | 07/15/2011 | 08/31/2012 |
| C207 | Isd:1-3 | 550 | brakev | Kevin Brame | 560.00 | 560.00 | 99.00 | 0.00 | 10/14/2011 | 10/31/2012 |
| C208 | Isd:2-3 | 855 | t0000963 | Jajuan Coleman | 640.00 | 640.00 | 399.00 | 0.00 | 05/31/2012 | 06/30/2013 |
| C209 | Isd:2-3 | 855 | t0000036 | Erica Johnson | 600.00 | 600.00 | 99.00 | 0.00 | 01/06/2012 | 01/31/2013 |
| C210 | Isd:2-3 | 855 | delias | Jason Delk | 640.00 | 640.00 | 300.00 | 0.00 | 02/19/2011 | 03/31/2013 |
| C211 | Isd:2-3 | 855 | olode | Adenike Oloyede | 600.00 | 600.00 | 399.00 | 0.00 | 12/31/2011 | 01/31/2013 |
| C212 | Isd:2-3 | 855 | t0001157 | Terrance Change | 677.00 | 640.00 | 399.00 | 0.00 | 06/30/2012 | 07/31/2013 |
| C213 | Isd:2-2 | 845 | t0000197 | Michael Anthony | 600.00 | 600.00 | 399.00 | 0.00 | 01/31/2012 | 02/28/2013 |
| C214 | Isd:2-2 | 845 | hargles | Leslie Hargrove | 665.00 | 665.00 | 399.00 | 0.00 | 08/31/2011 | 09/30/2012 |
| C301 | Isd:2-2 | 845 | rowdia | Diana Rowe | 665.00 | 665.00 | 350.00 | 0.00 | 09/30/2009 | 10/31/2012 |
| C302 | Isd:2-2 | 845 | nasdav | David Nash | 660.00 | 660.00 | 99.00 | 0.00 | 02/28/2010 | 03/31/2013 |

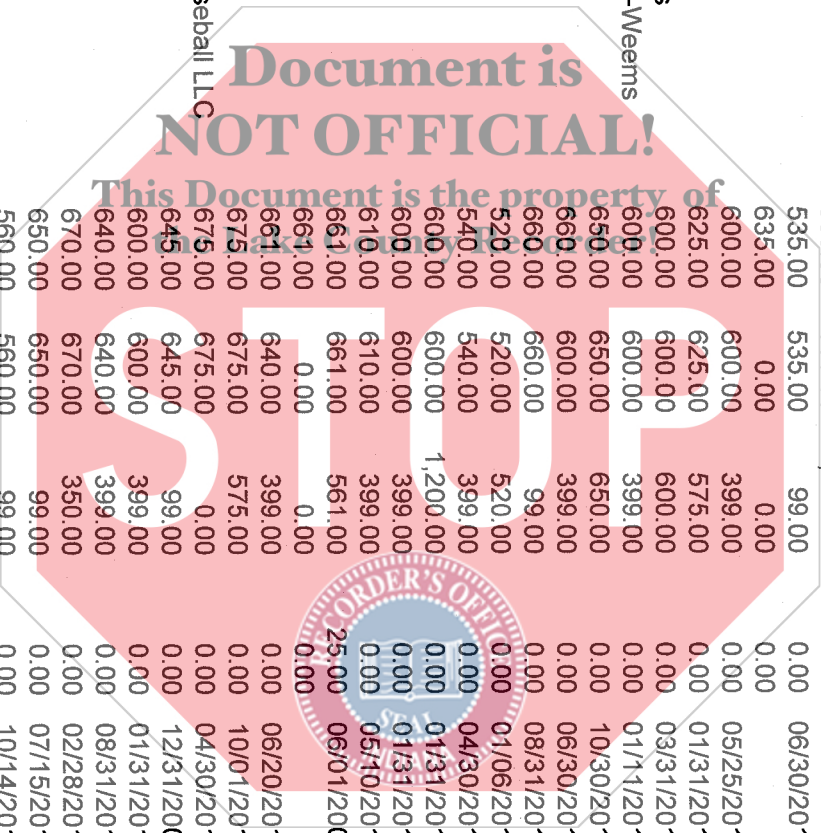

Rent Roll
Lakeshore Dunes LP (lsd)
As of: 07/23/2012

| UNIT | UNIT TYPE | UNIT SF | RESIDENT | RESIDENT NAME | MARKET RENT | ACTUAL RENT | DEPOSIT | OTHER DEPOSIT | MOVE IN | MOVE OUT |
|------|-----------|---------|----------|--------------------------|-------------|-------------|----------|---------------|------------|------------|
| C303 | lsd:2-3 | 855 | andchri | Christopher Anderson | 640.00 | 640.00 | 1,280.00 | 0.00 | 09/30/2011 | 10/31/2012 |
| C304 | lsd:2-3 | 855 | ricclim | Cliffmit Richmond | 661.00 | 661.00 | 1,160.00 | 25.00 | 03/31/2005 | 04/30/2013 |
| C305 | lsd:3-1 | 950 | srniwil | William Smith | 600.00 | 600.00 | 610.00 | 0.00 | 02/27/2012 | 08/31/2012 |
| C306 | lsd:2-3 | 855 | giberi | Erin Gibson | 660.00 | 660.00 | 325.00 | 0.00 | 01/31/2010 | 03/31/2013 |
| C307 | lsd:1-3 | 550 | henbri | Britani Henry | 530.00 | 530.00 | 399.00 | 0.00 | 09/15/2011 | 10/31/2012 |
| C308 | lsd:2-3 | 855 | porcar | Carol Porter | 675.00 | 675.00 | 580.00 | 25.00 | 02/11/2005 | 03/31/2013 |
| C309 | lsd:2-3 | 855 | t0001006 | Kelly Mcghee | 640.00 | 640.00 | 960.00 | 0.00 | 05/31/2012 | 06/30/2013 |
| C310 | lsd:2-3 | 855 | falsab | Sabrina Falkner | 650.00 | 650.00 | 99.00 | 0.00 | 05/01/2012 | 04/30/2013 |
| C311 | lsd:2-3 | 855 | willmar | Marolyn Williams | 671.00 | 671.00 | 581.00 | 25.00 | 06/01/2005 | 05/31/2013 |
| C312 | lsd:2-3 | 855 | t0001124 | Verdi Davis | 635.00 | 640.00 | 399.00 | 0.00 | 06/30/2012 | 07/31/2013 |
| C313 | lsd:2-2 | 845 | vrzacc | Zachery Vraska | 660.00 | 660.00 | 650.00 | 0.00 | 04/30/2012 | 05/31/2012 |
| C314 | lsd:2-2 | 845 | cargre | Gregory Carr | 676.00 | 676.00 | 591.00 | 25.00 | 06/01/2005 | 05/31/2013 |
| C401 | lsd:2-2 | 845 | gradon | Donna Grady | 675.00 | 675.00 | 350.00 | 0.00 | 07/31/2009 | 08/31/2012 |
| C402 | lsd:2-2 | 845 | t0000778 | Sophia Cross | 650.00 | 640.00 | 399.00 | 0.00 | 06/30/2012 | 07/31/2013 |
| C403 | lsd:2-3 | 855 | hudter | Darryl Hudson | 660.00 | 660.00 | 1,170.00 | 25.00 | 03/04/2005 | 03/31/2013 |
| C404 | lsd:2-3 | 855 | t0000881 | John Resunenko | 625.00 | 625.00 | 399.00 | 0.00 | 05/15/2012 | 05/31/2013 |
| C405 | lsd:3-1 | 950 | mcdann | Ann Nita McDonald | 622.00 | 622.00 | 582.00 | 25.00 | 06/01/1992 | 05/31/2013 |
| C406 | lsd:2-3 | 855 | bedjes | Jessica Bedford | 625.00 | 625.00 | 600.00 | 0.00 | 04/05/2012 | 04/30/2013 |
| C407 | lsd:1-3 | 550 | sabdon | Donald Saberniak, Jr. | 510.00 | 510.00 | 99.00 | 0.00 | 12/31/2011 | 01/31/2013 |
| C408 | lsd:2-3 | 855 | hayind | India Hayes | 648.00 | 648.00 | 325.00 | 0.00 | 12/01/2009 | 10/31/2012 |
| C409 | lsd:2-3 | 855 | t0000456 | Schleta Brown | 600.00 | 600.00 | 399.00 | 0.00 | 02/29/2012 | 03/31/2013 |
| C410 | lsd:2-3 | 855 | ezeeri | Eric Ezell | 670.00 | 670.00 | 99.00 | 0.00 | 07/31/2008 | 08/31/2012 |
| C411 | lsd:2-3 | 855 | t0000751 | South Shore Baseball LLC | 675.00 | 675.00 | 0.00 | 0.00 | 04/30/2012 | 09/30/2012 |
| C412 | lsd:2-3 | 855 | hinsha | Shadae Hines | 650.00 | 650.00 | 300.00 | 0.00 | 07/31/2010 | 08/31/2012 |
| C413 | lsd:2-2 | 845 | barsam | Samuel Barker | 675.00 | 675.00 | 99.00 | 0.00 | 07/11/2008 | 08/31/2012 |
| C414 | lsd:2-2 | 845 | wilste | Stephanie Nicol Wiley | 650.00 | 650.00 | 399.00 | 0.00 | 08/31/2011 | 09/30/2012 |
| D001 | lsd:2-1 | 760 | VACANT | VACANT | 673.00 | 0.00 | 0.00 | 0.00 | | |
| D002 | lsd:1-1 | 470 | kirjoe | Joe Kirk | 510.00 | 510.00 | 99.00 | 0.00 | 01/06/2009 | 02/28/2013 |
| D003 | lsd:2-1 | 760 | t0000652 | Donyale Daniels | 610.00 | 610.00 | 399.00 | 0.00 | 04/09/2012 | 05/31/2013 |
| D004 | lsd:1-1 | 470 | genlel | Lela Gentry | 500.00 | 500.00 | 399.00 | 0.00 | 12/31/2011 | 01/31/2013 |
| D005 | lsd:1-1 | 470 | edgcar | Edgewater Systems | 575.00 | 0.00 | 671.00 | 0.00 | 12/13/2011 | 12/31/2012 |
| D006 | lsd:2-1 | 760 | chaver | Vera Chavers | 660.00 | 660.00 | 500.00 | 0.00 | 06/30/2010 | 07/31/2013 |
| D007 | lsd:1-3 | 550 | marsal | Sally Marr | 561.00 | 561.00 | 99.00 | 0.00 | 09/30/2006 | 11/30/2012 |
| D008 | lsd:2-1 | 760 | liknon | Nona Fuller-Like | 660.00 | 0.00 | 300.00 | 0.00 | 07/30/2011 | 07/30/2012 |
| D101 | lsd:2-1 | 760 | durden | Denise Durham | 665.00 | 665.00 | 575.00 | 25.00 | 06/01/2005 | 08/31/2012 |
| D102 | lsd:2-1 | 760 | phimab | Mable Phillips | 670.00 | 670.00 | 587.00 | 25.00 | 03/01/2005 | 02/28/2013 |
| D103 | lsd:2-1 | 760 | t0000526 | Erica Shannon | 610.00 | 610.00 | 399.00 | 0.00 | 03/31/2012 | 04/30/2013 |
| D104 | lsd:3-1 | 950 | johden | Denise Johnson | 880.00 | 880.00 | 300.00 | 0.00 | 06/17/2010 | 07/31/2012 |
| D105 | lsd:1-2 | 610 | tolant | Antonio Tolbert | 550.00 | 550.00 | 99.00 | 0.00 | 08/31/2011 | 09/30/2012 |

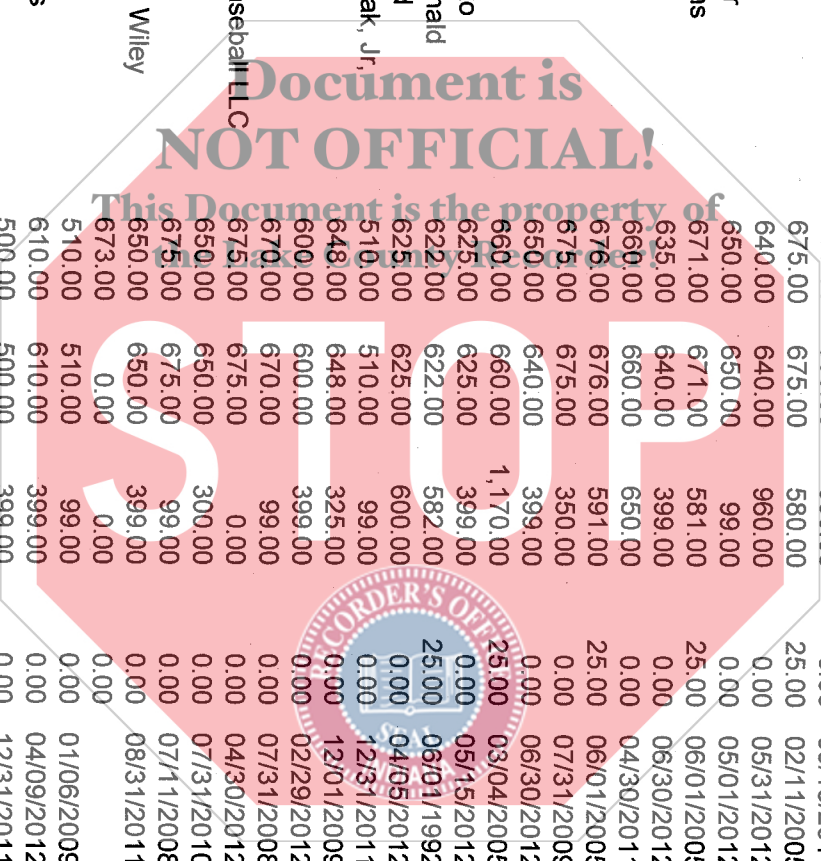

Rent Roll
Lakeshore Dunes LP (lsd)
As of: 07/23/2012

| UNIT | UNIT TYPE | UNIT SF | RESIDENT | RESIDENT NAME | MARKET RENT | ACTUAL RENT | DEPOSIT | OTHER DEPOSIT | MOVE IN | MOVE OUT |
|------|-----------|---------|----------|-------------------|-------------|-------------|----------|---------------|------------|------------|
| D106 | lsd:2-1 | 588 | evadon | Donald Evans, Sr. | 665.00 | 665.00 | 100.00 | 0.00 | 07/31/2010 | 08/31/2012 |
| D107 | lsd:2-1 | 760 | rahsan | Sandra Rahim | 666.00 | 666.00 | 587.00 | 25.00 | 03/01/2005 | 02/28/2013 |
| D108 | lsd:2-1 | 760 | grialb | Albenie Griffin | 665.00 | 665.00 | 99.00 | 0.00 | 06/29/2008 | 07/31/2012 |
| D201 | lsd:2-1 | 760 | davcia | Clarissa Davis | 620.00 | 248.00 | 121.00 | 0.00 | 03/01/2005 | 03/31/2013 |
| D202 | lsd:2-1 | 760 | johmark | Markizh Johnson | 645.00 | 645.00 | 100.00 | 0.00 | 10/31/2010 | 11/30/2012 |
| D203 | lsd:2-1 | 760 | t0000689 | Patrick Holtgrave | 625.00 | 685.00 | 399.00 | 0.00 | 07/12/2012 | 10/31/2012 |
| D204 | lsd:3-1 | 950 | trityr | Tyree Trice | 800.00 | 800.00 | 750.00 | 0.00 | 03/01/2012 | 03/31/2013 |
| D205 | lsd:1-2 | 610 | allmarv | Mary Allen | 575.00 | 575.00 | 99.00 | 0.00 | 08/31/2011 | 09/30/2012 |
| D206 | lsd:2-1 | 760 | cussam | Samuel Custard | 670.00 | 670.00 | 559.00 | 25.00 | 04/01/2005 | 03/31/2013 |
| D207 | lsd:2-1 | 760 | stilor | Lori Stingley | 676.00 | 676.00 | 99.00 | 0.00 | 06/30/2007 | 07/31/2013 |
| D208 | lsd:2-1 | 760 | nelkif | Tiffany Nelson | 625.00 | 625.00 | 100.00 | 0.00 | 03/01/2012 | 02/28/2013 |
| E001 | lsd:2-5 | 740 | t0000403 | Robert Edmond | 575.00 | 575.00 | 399.00 | 0.00 | 02/29/2012 | 03/31/2013 |
| E002 | lsd:2-5 | 740 | VACANT | VACANT | 625.00 | 0.00 | 0.00 | 0.00 | | |
| E003 | lsd:2-5 | 740 | VACANT | VACANT | 555.00 | 0.00 | 0.00 | 0.00 | | |
| E004 | lsd:2-4 | 700 | sotcar | Carol Solo | 645.00 | 645.00 | 287.50 | 0.00 | 11/05/2008 | 12/31/2012 |
| E005 | lsd:2-4 | 700 | VACANT | VACANT | 555.00 | 0.00 | 0.00 | 0.00 | | |
| E006 | lsd:2-4 | 700 | vivekeo | Keon Viverette | 575.00 | 575.00 | 595.00 | 0.00 | 04/07/2010 | 02/28/2012 |
| E007 | lsd:1-5 | 625 | t0000663 | Edgewater Systems | 575.00 | 0.00 | 671.00 | 0.00 | 04/05/2012 | 04/30/2013 |
| E009 | lsd:1-5 | 625 | VACANT | VACANT | 510.00 | 0.00 | 0.00 | 0.00 | | |
| E011 | lsd:2-4 | 700 | VACANT | VACANT | 555.00 | 0.00 | 0.00 | 0.00 | | |
| E013 | lsd:2-4 | 700 | VACANT | VACANT | 575.00 | 0.00 | 0.00 | 0.00 | | |
| E014 | lsd:2-4 | 700 | t0001264 | Carlos Otero | 575.00 | 595.00 | 399.00 | 0.00 | 06/30/2012 | 07/31/2013 |
| E015 | lsd:2-5 | 740 | VACANT | VACANT | 585.00 | 0.00 | 0.00 | 0.00 | | |
| E016 | lsd:2-5 | 740 | VACANT | VACANT | 575.00 | 0.00 | 0.00 | 0.00 | | |
| E101 | lsd:2-5 | 740 | t0000614 | Adejoke Adeleke | 590.00 | 590.00 | 1,180.00 | 0.00 | 03/31/2012 | 04/30/2013 |
| E102 | lsd:2-5 | 740 | philak | Lakesha Phifer | 595.00 | 595.00 | 399.00 | 0.00 | 11/30/2011 | 12/31/2012 |
| E103 | lsd:2-4 | 700 | t0000985 | Tatiana Jones | 595.00 | 595.00 | 892.50 | 0.00 | 05/31/2012 | 06/30/2013 |
| E104 | lsd:2-4 | 700 | matani | Anita Matthews | 645.00 | 645.00 | 350.00 | 0.00 | 07/31/2009 | 08/31/2012 |
| E105 | lsd:2-4 | 700 | t0000616 | Daason House | 575.00 | 575.00 | 399.00 | 0.00 | 03/31/2012 | 04/30/2013 |
| E106 | lsd:2-4 | 700 | t0001214 | Tamieko Havard | 635.00 | 595.00 | 1,190.00 | 0.00 | 06/30/2012 | 07/31/2013 |
| E107 | lsd:1-5 | 625 | t0000152 | Betty Black | 0.00 | 0.00 | 650.00 | 0.00 | 04/13/2012 | 04/30/2013 |
| E108 | lsd:1-2 | 610 | mortre | Trecia Morris | 570.00 | 570.00 | 300.00 | 0.00 | 08/31/2010 | 09/30/2011 |
| E109 | lsd:1-5 | 625 | claama | Amanda Claxton | 530.00 | 530.00 | 250.00 | 0.00 | 09/30/2011 | 09/30/2012 |
| E110 | lsd:1-7 | 555 | bucwil | William Buckson | 574.00 | 574.00 | 99.00 | 0.00 | 01/31/2007 | 03/31/2013 |
| E111 | lsd:2-4 | 700 | t0000448 | Florestee Buss | 575.00 | 575.00 | 399.00 | 0.00 | 02/29/2012 | 03/31/2013 |
| E112 | lsd:2-4 | 700 | clakat | Kathleen Clark | 660.00 | 291.00 | 640.00 | 0.00 | 10/01/2010 | 09/30/2012 |
| E113 | lsd:2-4 | 700 | weslam | Lameka West | 660.00 | 660.00 | 99.00 | 0.00 | 04/30/2010 | 05/31/2013 |
| E114 | lsd:2-4 | 700 | VACANT | VACANT | 555.00 | 0.00 | 0.00 | 0.00 | | |
| E115 | lsd:2-5 | 740 | padedw | Edward Padgett | 610.00 | 610.00 | 100.00 | 0.00 | 12/31/2010 | 01/31/2013 |

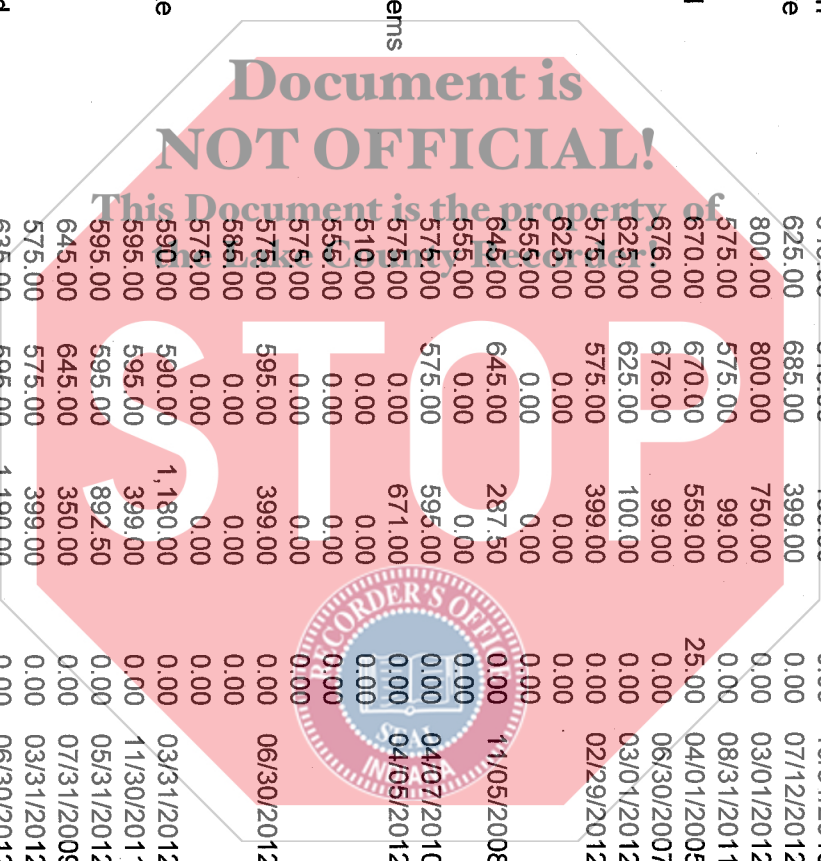

Rent Roll
Lakeshore Dunes LP (lsd)
As of: 07/23/2012

| UNIT | UNIT TYPE | UNIT SF | RESIDENT | RESIDENT NAME | MARKET RENT | ACTUAL RENT | DEPOSIT | OTHER DEPOSIT | MOVE IN | MOVE OUT |
|------|-----------|---------|----------|-----------------------|-------------|-------------|----------|---------------|------------|------------|
| E116 | lsd:2-5 | 740 | 10000643 | Christopher Lightner | 590.00 | 590.00 | 399.00 | 0.00 | 04/30/2012 | 05/31/2013 |
| E201 | lsd:2-5 | 740 | colval | Valeria Colston | 640.00 | 114.00 | 604.00 | 0.00 | 10/01/2011 | 09/30/2012 |
| E202 | lsd:2-5 | 740 | bakant | Antoine Baker | 635.00 | 635.00 | 99.00 | 0.00 | 06/30/2011 | 07/31/2012 |
| E203 | lsd:2-4 | 700 | glomit | Latonya Griffin | 595.00 | 595.00 | 300.00 | 0.00 | 12/09/2011 | 12/31/2012 |
| E204 | lsd:2-4 | 700 | VACANT | VACANT | 595.00 | 0.00 | 0.00 | 0.00 | | |
| E205 | lsd:2-4 | 700 | jonlyn | Lynda Jones | 666.00 | 666.00 | 99.00 | 0.00 | 01/31/2007 | 03/31/2013 |
| E206 | lsd:2-4 | 700 | 10000430 | Harold Camp Sr | 575.00 | 575.00 | 399.00 | 0.00 | 02/29/2012 | 03/31/2013 |
| E207 | lsd:2-4 | 700 | protaw | Tawana Brown | 652.00 | 652.00 | 504.00 | 25.00 | 08/22/2002 | 03/31/2013 |
| E208 | lsd:1-2 | 610 | 10000383 | Andre Foster | 550.00 | 550.00 | 399.00 | 0.00 | 02/29/2012 | 03/31/2013 |
| E209 | lsd:2-4 | 700 | 10000416 | Natasha Beecher | 575.00 | 575.00 | 99.00 | 0.00 | 02/29/2012 | 03/31/2013 |
| E210 | lsd:2-4 | 700 | 10000416 | Natasha Beecher | 555.00 | 575.00 | 99.00 | 0.00 | 02/29/2012 | 03/31/2013 |
| E211 | lsd:2-4 | 700 | babemy-e | Myrna Baber | 630.00 | 630.00 | 250.00 | 0.00 | 11/01/2010 | 10/31/2012 |
| E212 | lsd:2-4 | 700 | 10000464 | Felicia Bright | 575.00 | 575.00 | 1,150.00 | 0.00 | 02/29/2012 | 03/31/2013 |
| E213 | lsd:2-4 | 700 | 10001099 | Lashaun Smith-McGowan | 595.00 | 595.00 | 399.00 | 0.00 | 06/16/2012 | 06/30/2013 |
| E214 | lsd:2-4 | 855 | wilband | Andrew Wilburn | 630.00 | 630.00 | 100.00 | 0.00 | 10/31/2010 | 11/30/2012 |
| E215 | lsd:2-5 | 740 | heiant | Antoinette Height | 630.00 | 630.00 | 99.00 | 0.00 | 09/01/2011 | 08/31/2012 |
| E216 | lsd:2-5 | 740 | wilbra | Brandon Williams | 620.00 | 620.00 | 100.00 | 0.00 | 12/31/2010 | 07/31/2012 |
| E301 | lsd:2-5 | 740 | cooros | Rosie Cook | 662.00 | 662.00 | 569.00 | 0.00 | 04/01/2011 | 03/31/2013 |
| E302 | lsd:2-5 | 740 | VACANT | VACANT | 657.00 | 0.00 | 0.00 | 0.00 | | |
| E303 | lsd:2-4 | 700 | boygre | Gregory Boyd | 622.00 | 622.00 | 523.00 | 0.00 | 05/15/2006 | 04/30/2013 |
| E304 | lsd:2-4 | 700 | 10000217 | Shante Blair | 575.00 | 575.00 | 399.00 | 0.00 | 01/31/2012 | 02/28/2013 |
| E305 | lsd:2-4 | 700 | 10000886 | Jillian Ritacco | 595.00 | 595.00 | 399.00 | 0.00 | 05/16/2012 | 05/31/2013 |
| E306 | lsd:2-4 | 700 | 10000625 | Korey Miller | 595.00 | 595.00 | 399.00 | 0.00 | 03/31/2012 | 04/30/2013 |
| E307 | lsd:1-6 | 700 | 10000757 | Timothy Jones | 595.00 | 595.00 | 399.00 | 0.00 | 04/30/2012 | 05/31/2013 |
| E308 | lsd:1-2 | 610 | whidav | David White | 570.00 | 570.00 | 99.00 | 0.00 | 07/14/2009 | 08/31/2013 |
| E309 | lsd:2-4 | 700 | willsus | Susie Williams | 640.00 | 640.00 | 99.00 | 0.00 | 12/31/2009 | 01/31/2013 |
| E310 | lsd:1-7 | 555 | VACANT | VACANT | 565.00 | 0.00 | 0.00 | 0.00 | | |
| E311 | lsd:2-4 | 700 | 10001140 | Dushawn Armstrong | 635.00 | 595.00 | 1,190.00 | 0.00 | 06/30/2012 | 07/31/2013 |
| E312 | lsd:2-4 | 855 | smicon | Constance Smith | 595.00 | 595.00 | 399.00 | 0.00 | 09/30/2011 | 10/31/2012 |
| E313 | lsd:2-4 | 700 | 10000402 | Troy Sanders | 575.00 | 575.00 | 399.00 | 0.00 | 02/29/2012 | 03/31/2013 |
| E314 | lsd:2-4 | 700 | 10000445 | Ashley Jackson | 575.00 | 575.00 | 399.00 | 0.00 | 02/29/2012 | 03/31/2013 |
| E315 | lsd:2-5 | 740 | VACANT | VACANT | 640.00 | 0.00 | 0.00 | 0.00 | | |
| E316 | lsd:2-5 | 740 | 10000432 | Narccara Perry | 575.00 | 575.00 | 399.00 | 0.00 | 02/29/2012 | 03/31/2013 |
| F001 | lsd:1-1 | 470 | temjul | Juie Templeton | 530.00 | 530.00 | 399.00 | 0.00 | 08/31/2011 | 09/30/2012 |
| F002 | lsd:2-1 | 760 | wilhow | Howard Williams | 640.00 | 640.00 | 399.00 | 0.00 | 09/30/2011 | 10/31/2012 |
| F003 | lsd:1-2 | 610 | 10000687 | Oliver Dixon | 540.00 | 540.00 | 1,080.00 | 0.00 | 04/27/2012 | 05/31/2013 |
| F004 | lsd:eff1 | 390 | mooiac | Jacquelyn Moore | 475.00 | 475.00 | 100.00 | 0.00 | 04/30/2010 | 05/31/2013 |
| F005 | lsd:eff1 | 390 | tayiam | Jamillah Taylor | 475.00 | 475.00 | 415.00 | 25.00 | 06/29/2004 | 07/31/2013 |
| F006 | lsd:1-2 | 610 | tyarl | Arlene Tyler | 572.00 | 572.00 | 485.00 | 0.00 | 05/31/2007 | 06/30/2013 |

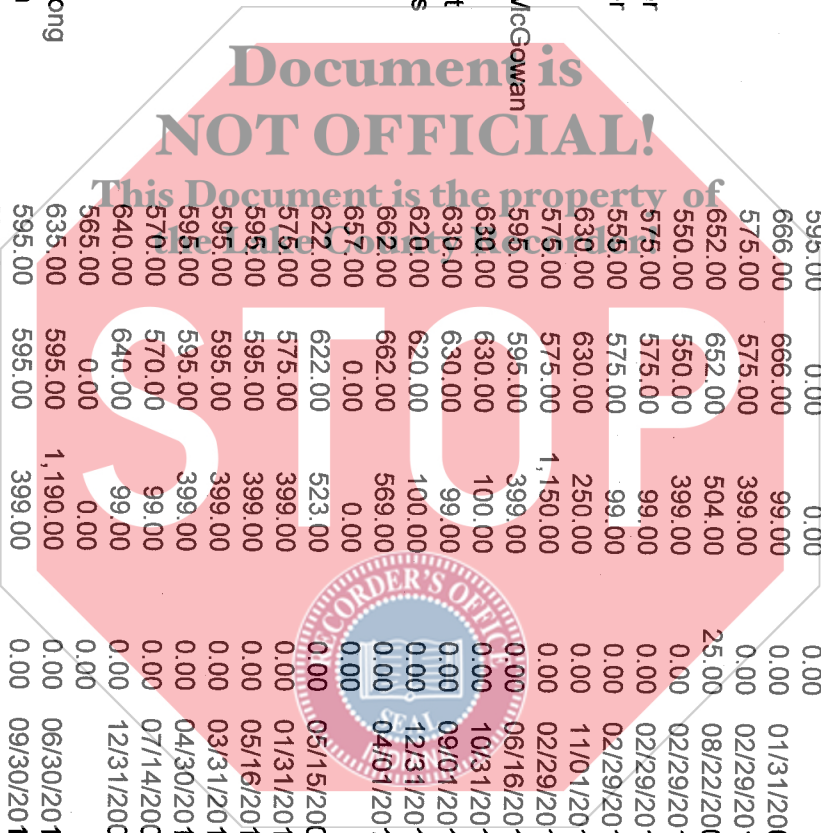

Rent Roll
Lakeshore Dunes LP (lsd)
As of: 07/23/2012

| UNIT | UNIT TYPE | UNIT SF | RESIDENT | RESIDENT NAME | MARKET RENT | ACTUAL RENT | DEPOSIT | OTHER DEPOSIT | MOVE IN | MOVE OUT |
|------|-----------|---------|----------|-------------------|-------------|-------------|----------|---------------|------------|------------|
| F007 | lsd:2-5 | 740 | shaley | Levonne Sharp | 688.00 | 563.00 | 124.00 | 15.00 | 06/01/2005 | 05/31/2013 |
| F008 | lsd:1-1 | 470 | brodia | Dianne Brooks | 535.00 | 535.00 | 300.00 | 0.00 | 01/01/2011 | 12/31/2012 |
| F009 | lsd:1-1 | 470 | henjoh | John Henn | 560.00 | 560.00 | 99.00 | 0.00 | 06/30/2011 | 07/31/2012 |
| F010 | lsd:2-5 | 740 | VACANT | VACANT | 610.00 | 0.00 | 0.00 | 0.00 | | |
| F011 | lsd:eff1 | 390 | floron | Ronald Flowers | 455.00 | 455.00 | 99.00 | 0.00 | 12/03/2010 | 01/31/2013 |
| F012 | lsd:eff1 | 390 | t0000649 | Sidney Smith | 460.00 | 460.00 | 460.00 | 0.00 | 03/31/2012 | 04/30/2013 |
| F013 | lsd:2-5 | 740 | gorrob | Robert Gordon | 640.00 | 640.00 | 99.00 | 0.00 | 10/15/2011 | 10/31/2012 |
| F101 | lsd:2-1 | 760 | t0000987 | Julian Jackson | 625.00 | 625.00 | 399.00 | 0.00 | 05/31/2012 | 06/30/2013 |
| F102 | lsd:2-1 | 760 | willju | Julius Williams | 630.00 | 630.00 | 250.00 | 0.00 | 10/15/2011 | 10/31/2012 |
| F103 | lsd:1-2 | 610 | jacpeg | Peggy Jackson | 560.00 | 560.00 | 483.00 | 25.00 | 05/01/2005 | 04/30/2013 |
| F104 | lsd:1-2 | 610 | blanan | Nancy Blair | 572.00 | 572.00 | 500.00 | 0.00 | 08/31/2005 | 08/31/2013 |
| F105 | lsd:1-2 | 610 | jonwil | Willie Jones | 560.00 | 560.00 | 483.00 | 25.00 | 05/01/2005 | 04/30/2013 |
| F106 | lsd:1-2 | 610 | pulroo | Roosevelt Pulliam | 585.00 | 585.00 | 491.00 | 25.00 | 06/01/2005 | 05/31/2013 |
| F107 | lsd:2-1 | 760 | buccar | Carol Buchanan | 640.00 | 640.00 | 399.00 | 0.00 | 09/30/2011 | 10/31/2012 |
| F108 | lsd:3-1 | 950 | hansan | Sandra Handspur | 780.00 | 780.00 | 707.00 | 25.00 | 06/01/2005 | 08/31/2012 |
| F109 | lsd:1-1 | 470 | dalles | Leslie Dallaher | 540.00 | 540.00 | 399.00 | 0.00 | 12/31/2011 | 01/31/2013 |
| F110 | lsd:2-1 | 760 | haysyl | Sylvester Haywood | 679.00 | 679.00 | 508.00 | 0.00 | 10/01/2006 | 09/30/2012 |
| F111 | lsd:1-2 | 610 | t0000560 | Baron Moss | 560.00 | 560.00 | 399.00 | 0.00 | 03/31/2012 | 04/30/2013 |
| F112 | lsd:1-2 | 610 | carron | Ronda Carter | 552.00 | 552.00 | 494.00 | 25.00 | 06/26/2002 | 07/31/2012 |
| F113 | lsd:2-5 | 740 | pielat | Latasha Pierce | 679.00 | 679.00 | 605.00 | 0.00 | 08/31/2005 | 09/30/2011 |
| F201 | lsd:2-5 | 740 | wilsho | Sholanda Williams | 678.00 | 678.00 | 99.00 | 0.00 | 10/31/2005 | 06/30/2013 |
| F202 | lsd:2-1 | 588 | irojef | Jeffrey Irons | 636.00 | 636.00 | 525.00 | 25.00 | 01/01/2005 | 12/31/2012 |
| F203 | lsd:1-2 | 610 | t0001197 | Kimberliah Woods | 575.00 | 560.00 | 840.00 | 0.00 | 06/30/2012 | 07/31/2013 |
| F204 | lsd:1-2 | 610 | gibliam | Jameshia Gibbs | 0.00 | 0.00 | 550.00 | 0.00 | 09/15/2011 | 09/30/2012 |
| F205 | lsd:1-2 | 610 | arste | Sterling Arthur | 560.00 | 560.00 | 250.00 | 0.00 | 02/10/2012 | 02/28/2013 |
| F206 | lsd:1-2 | 610 | cotmar | Martese Cotton | 555.00 | 555.00 | 99.00 | 0.00 | 12/31/2010 | 01/31/2013 |
| F207 | lsd:2-1 | 760 | moojoh | Johnnie Moolye | 673.00 | 673.00 | 573.00 | 0.00 | 05/01/2005 | 04/30/2013 |
| F208 | lsd:3-1 | 950 | magthe | Theodore Magwood | 865.00 | 865.00 | 850.00 | 0.00 | 10/23/2010 | 10/31/2012 |
| F209 | lsd:1-2 | 610 | hawkco | Coleman Hawkins | 550.00 | 550.00 | 99.00 | 0.00 | 04/01/2011 | 03/31/2013 |
| F210 | lsd:2-1 | 760 | t0000012 | Matthew Host | 625.00 | 625.00 | 399.00 | 0.00 | 12/31/2011 | 01/31/2013 |
| F211 | lsd:1-2 | 610 | mlfre | Freddie Miles | 550.00 | 550.00 | 99.00 | 0.00 | 11/30/2011 | 12/31/2012 |
| F212 | lsd:1-2 | 610 | haymaq | Maquilla Hayes | 550.00 | 550.00 | 300.00 | 0.00 | 12/31/2011 | 01/31/2013 |
| F213 | lsd:2-5 | 740 | sumpat | Patrick Sumby | 660.00 | 660.00 | 100.00 | 0.00 | 11/16/2010 | 12/31/2012 |
| G001 | lsd:2-5 | 740 | VACANT | VACANT | 585.00 | 0.00 | 0.00 | 0.00 | | |
| G002 | lsd:eff1 | 390 | nicdam | Damond Nichols | 435.00 | 435.00 | 99.00 | 0.00 | 09/30/2011 | 10/31/2012 |
| G003 | lsd:eff1 | 390 | broapr | April Brooks | 465.00 | 465.00 | 99.00 | 0.00 | 02/28/2009 | 03/31/2013 |
| G004 | lsd:2-1 | 760 | t0000624 | Tyron Shepard | 600.00 | 600.00 | 1,200.00 | 0.00 | 03/31/2012 | 04/30/2013 |
| G005 | lsd:1-1 | 470 | t0000374 | Leonard Davis | 550.00 | 550.00 | 399.00 | 0.00 | 02/29/2012 | 03/31/2013 |
| G006 | lsd:1-1 | 470 | houear | Earl House | 560.00 | 560.00 | 250.00 | 0.00 | 01/31/2007 | 03/31/2013 |

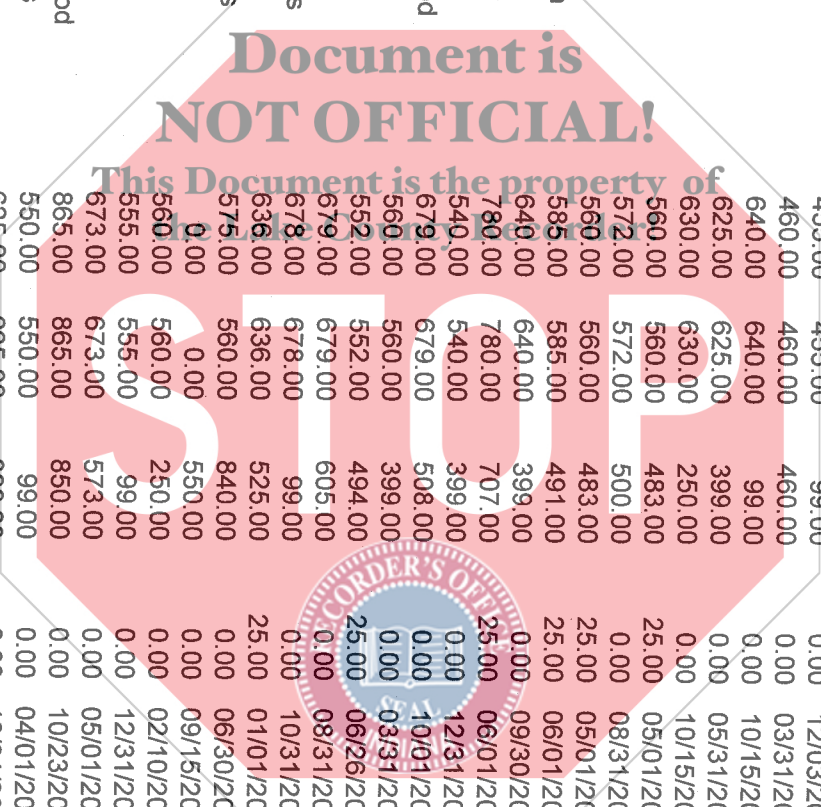

Rent Roll
Lakeshore Dunes LP (lsd)
As of: 07/23/2012

| UNIT | UNIT TYPE | UNIT SF | RESIDENT | RESIDENT NAME | MARKET RENT | ACTUAL RENT | DEPOSIT | OTHER DEPOSIT | MOVE IN | MOVE OUT |
|------|-----------|---------|----------|--------------------------|-------------|-------------|----------|---------------|------------|------------|
| G007 | lsd:2-1 | 760 | t0000613 | Kimberly Sykes | 600.00 | 600.00 | 399.00 | 0.00 | 03/31/2012 | 04/30/2013 |
| G008 | lsd:1-2 | 610 | t0000196 | Danielle Henry | 550.00 | 550.00 | 399.00 | 0.00 | 01/31/2012 | 02/28/2013 |
| G009 | lsd:eff1 | 390 | traray | Roy Taylor | 477.00 | 477.00 | 250.00 | 0.00 | 04/30/2007 | 04/30/2013 |
| G010 | lsd:eff1 | 390 | VACANT | VACANT | 425.00 | 0.00 | 0.00 | 0.00 | | |
| G011 | lsd:1-2 | 610 | VACANT | VACANT | 485.00 | 0.00 | 0.00 | 0.00 | | |
| G012 | lsd:2-5 | 740 | VACANT | VACANT | 585.00 | 0.00 | 0.00 | 0.00 | | |
| G013 | lsd:1-1 | 470 | VACANT | VACANT | 577.00 | 0.00 | 0.00 | 0.00 | | |
| G101 | lsd:2-5 | 740 | frajan | Janet Frazier | 625.00 | 625.00 | 399.00 | 0.00 | 12/31/2011 | 01/31/2013 |
| G102 | lsd:1-2 | 610 | armeld | Eldon Armstrong | 578.00 | 313.00 | 1,020.00 | 25.00 | 08/01/2004 | 07/31/2013 |
| G103 | lsd:1-2 | 610 | whiste | Stephanie White | 570.00 | 570.00 | 300.00 | 0.00 | 10/31/2010 | 11/30/2012 |
| G104 | lsd:2-1 | 760 | bismit | Mitchell Bishop | 672.00 | 672.00 | 610.00 | 0.00 | 02/01/2012 | 02/28/2013 |
| G105 | lsd:1-2 | 610 | t0000668 | Edgewater Systems | 575.00 | 0.00 | 671.00 | 0.00 | 04/13/2012 | 04/30/2013 |
| G106 | lsd:3-1 | 950 | eshtan | Tanya Eshelman | 850.00 | 850.00 | 399.00 | 100.00 | 08/31/2011 | 09/30/2012 |
| G107 | lsd:2-5 | 740 | petdel | Delores Peters | 675.00 | 675.00 | 566.00 | 25.00 | 08/01/2004 | 07/31/2012 |
| G108 | lsd:1-2 | 610 | thoalp | Alphonso Thomas | 573.00 | 573.00 | 518.00 | 25.00 | 07/01/2004 | 06/30/2013 |
| G109 | lsd:1-2 | 610 | carrden | Denzel Carroll | 575.00 | 575.00 | 99.00 | 0.00 | 04/30/2011 | 05/31/2013 |
| G110 | lsd:1-2 | 610 | t0000651 | Phyllis Mosley | 550.00 | 550.00 | 399.00 | 0.00 | 04/09/2012 | 05/31/2013 |
| G111 | lsd:1-2 | 610 | VACANT | VACANT | 560.00 | 0.00 | 0.00 | 0.00 | | |
| G112 | lsd:2-1 | 760 | alejам | James Alexander | 675.00 | 675.00 | 99.00 | 0.00 | 06/30/2008 | 07/31/2013 |
| G113 | lsd:2-5 | 740 | lohjud | Ludine Johnson | 670.00 | 228.00 | 99.00 | 0.00 | 04/21/2012 | 03/31/2013 |
| G201 | lsd:2-5 | 740 | lewfel | Felice Lewis | 671.00 | 671.00 | 610.00 | 0.00 | 11/30/2007 | 12/31/2011 |
| G202 | lsd:1-2 | 610 | colmic | Michelle Coley | 575.00 | 575.00 | 350.00 | 0.00 | 09/01/2010 | 08/31/2012 |
| G203 | lsd:1-2 | 610 | garbea | Beatriz Garcia | 550.00 | 550.00 | 99.00 | 0.00 | 10/31/2011 | 11/30/2012 |
| G204 | lsd:2-1 | 760 | t0000615 | Irene Harris | 625.00 | 625.00 | 399.00 | 0.00 | 03/31/2012 | 04/30/2013 |
| G205 | lsd:1-2 | 610 | t0000707 | Latrece Brooks | 565.00 | 565.00 | 399.00 | 0.00 | 04/30/2012 | 05/31/2013 |
| G206 | lsd:3-1 | 950 | t0000747 | Ahmad Evans | 825.00 | 825.00 | 399.00 | 0.00 | 04/30/2012 | 05/31/2013 |
| G207 | lsd:2-5 | 740 | wellad | Ladonna Wells | 640.00 | 640.00 | 99.00 | 0.00 | 10/31/2011 | 11/30/2012 |
| G208 | lsd:1-2 | 610 | fostden | Dennis Foster | 580.00 | 580.00 | 99.00 | 0.00 | 05/31/2011 | 06/30/2013 |
| G209 | lsd:1-2 | 610 | t0000607 | Bryant Fowler | 550.00 | 550.00 | 399.00 | 0.00 | 03/31/2012 | 04/30/2013 |
| G210 | lsd:1-2 | 610 | t0000454 | Jamar Thomas | 550.00 | 550.00 | 1,100.00 | 0.00 | 02/29/2012 | 03/31/2013 |
| G211 | lsd:1-2 | 610 | turnak | Makita Turner | 0.00 | 0.00 | 1,100.00 | 0.00 | 09/30/2011 | 09/30/2012 |
| G212 | lsd:2-1 | 760 | wilsim | Simmie Williams | 630.00 | 630.00 | 564.00 | 0.00 | 04/01/2010 | 03/31/2013 |
| G213 | lsd:2-5 | 740 | t0000749 | South Shore Baseball LLC | 675.00 | 675.00 | 0.00 | 0.00 | 04/30/2012 | 09/30/2012 |
| H001 | lsd:1-9 | 620 | VACANT | VACANT | 460.00 | 0.00 | 0.00 | 0.00 | | |
| H002 | lsd:1-9 | 588 | VACANT | VACANT | 460.00 | 0.00 | 0.00 | 0.00 | | |
| H003 | lsd:2-8 | 835 | chaida | Ida Chatman | 695.00 | 695.00 | 500.00 | 0.00 | 08/31/2010 | 09/30/2012 |
| H004 | lsd:2-8 | 835 | willcas | Cassie Williams | 635.00 | 635.00 | 399.00 | 0.00 | 12/15/2011 | 01/31/2013 |
| H005 | lsd:2-8 | 835 | maxdav | Dave H. Maxwell | 665.00 | 665.00 | 399.00 | 0.00 | 08/31/2011 | 09/30/2012 |
| H006 | lsd:2-8 | 835 | t0000455 | Angelic Dunn | 640.00 | 640.00 | 1,005.00 | 0.00 | 02/29/2012 | 03/31/2013 |

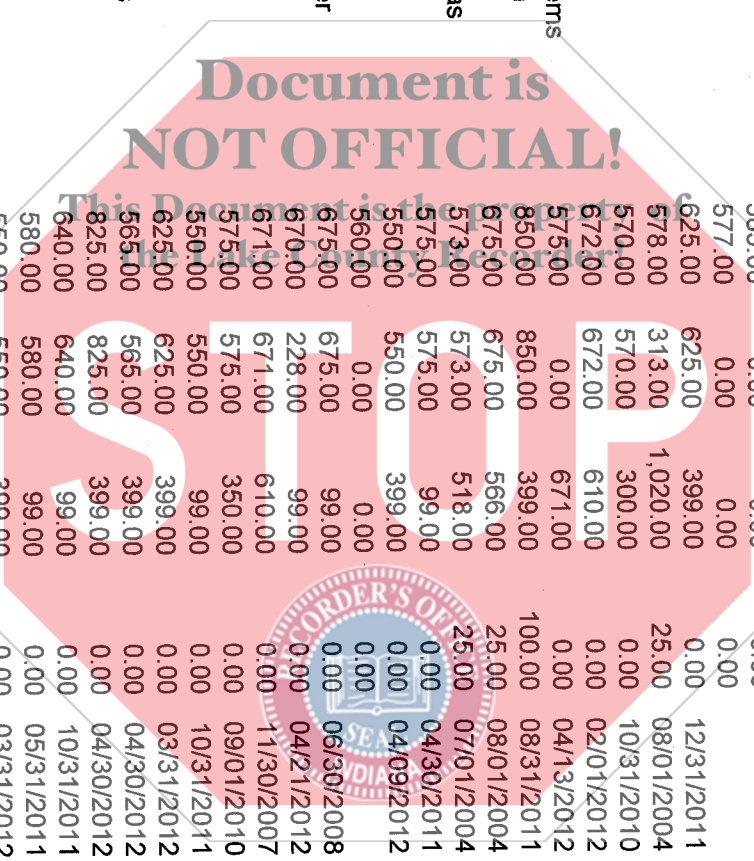

Rent Roll
Lakeshore Dunes LP (lsd)
As of: 07/23/2012

| UNIT | UNIT TYPE | UNIT SF | RESIDENT | RESIDENT NAME | MARKET RENT | ACTUAL RENT | DEPOSIT | OTHER DEPOSIT | MOVE IN | MOVE OUT |
|------|-----------|---------|----------|---------------------|-------------|-------------|----------|---------------|------------|------------|
| H007 | lsd:1-9 | 588 | jonerw | Erwin Jones | 565.00 | 565.00 | 523.00 | 25.00 | 03/01/2005 | 02/28/2013 |
| H008 | lsd:1-9 | 588 | patchr | Christopher Patrick | 545.00 | 545.00 | 399.00 | 0.00 | 12/09/2011 | 01/31/2013 |
| H009 | lsd:1-9 | 588 | jonreu | Reuben Jones | 580.00 | 580.00 | 399.00 | 0.00 | 07/31/2011 | 08/31/2012 |
| H010 | lsd:1-9 | 588 | tucjus | Justin Tucker | 565.00 | 565.00 | 99.00 | 0.00 | 01/21/2011 | 04/30/2013 |
| H011 | lsd:2-6 | 750 | t0000114 | Marlon Davis | 640.00 | 640.00 | 1,200.00 | 0.00 | 06/01/2012 | 02/28/2013 |
| H012 | lsd:2-6 | 750 | kizglo | Gloria Kizer | 695.00 | 23.00 | 300.00 | 0.00 | 03/05/2011 | 02/28/2013 |
| H101 | lsd:1-9 | 588 | raglag | Lagina Ragland | 550.00 | 550.00 | 99.00 | 0.00 | 06/30/2008 | 07/31/2012 |
| H102 | lsd:1-9 | 588 | gorcha | Pamela Williams | 565.00 | 565.00 | 99.00 | 0.00 | 08/01/2011 | 05/31/2013 |
| H103 | lsd:2-8 | 835 | packat | Kathryn Pace | 668.00 | 668.00 | 800.00 | 0.00 | 10/01/2007 | 09/30/2012 |
| H104 | lsd:2-8 | 835 | t0000195 | Shardai Pearson | 645.00 | 645.00 | 99.00 | 0.00 | 01/31/2012 | 01/31/2013 |
| H105 | lsd:2-8 | 835 | tatsie | Steven Tate | 690.00 | 690.00 | 100.00 | 0.00 | 06/30/2010 | 07/31/2012 |
| H106 | lsd:2-8 | 835 | lamann | Annie Lampkin | 685.00 | 685.00 | 665.00 | 25.00 | 06/01/2005 | 05/31/2013 |
| H107 | lsd:1-9 | 588 | moodar | Daryl Moore | 571.00 | 239.00 | 526.00 | 25.00 | 12/01/2004 | 12/31/2012 |
| H108 | lsd:1-9 | 588 | joylha | Jhalysa Joyner | 580.00 | 580.00 | 399.00 | 0.00 | 06/30/2011 | 07/31/2013 |
| H109 | lsd:1-9 | 588 | johala | Alan Johnson | 580.00 | 580.00 | 100.00 | 0.00 | 11/30/2010 | 12/31/2012 |
| H110 | lsd:1-9 | 588 | kinsan | Sandra King | 576.00 | 576.00 | 537.00 | 125.00 | 05/01/2005 | 04/30/2013 |
| H111 | lsd:2-6 | 750 | peasan | Sandra Pearson | 700.00 | 153.00 | 642.00 | 25.00 | 06/01/2005 | 05/31/2013 |
| H112 | lsd:2-6 | 750 | t0000110 | Linda Washington | 635.00 | 635.00 | 665.00 | 0.00 | 01/31/2012 | 02/28/2013 |
| H201 | lsd:1-9 | 588 | henand | Andrew Hensel | 565.00 | 565.00 | 399.00 | 0.00 | 08/31/2011 | 09/30/2012 |
| H202 | lsd:1-9 | 588 | VACANT | VACANT | 585.00 | 0.00 | 0.00 | 0.00 | | |
| H203 | lsd:2-8 | 835 | enndon | Donita Ennis | 680.00 | 680.00 | 100.00 | 0.00 | 11/30/2010 | 12/31/2012 |
| H204 | lsd:2-8 | 835 | nuttaw | Dawna Nutt | 635.00 | 635.00 | 399.00 | 0.00 | 10/31/2011 | 11/30/2012 |
| H205 | lsd:2-8 | 835 | harare | Arevitta Harris | 680.00 | 680.00 | 99.00 | 0.00 | 05/31/2011 | 06/30/2012 |
| H206 | lsd:2-8 | 835 | glibisa | Isaac Gibson | 685.00 | 685.00 | 647.00 | 25.00 | 05/01/2005 | 04/30/2013 |
| H207 | lsd:1-9 | 588 | wittia | Tia Williams | 580.00 | 580.00 | 99.00 | 200.00 | 07/31/2011 | 08/31/2012 |
| H208 | lsd:1-9 | 588 | patcav | Cavatina Patrick | 0.00 | 0.00 | 350.00 | 0.00 | 02/06/2007 | 03/31/2013 |
| H209 | lsd:1-9 | 588 | t0000920 | Bobby Tabor | 565.00 | 565.00 | 892.50 | 0.00 | 05/31/2012 | 06/30/2013 |
| H210 | lsd:1-9 | 588 | washma | Maryland Wash | 545.00 | 545.00 | 399.00 | 0.00 | 09/30/2011 | 10/31/2012 |
| H211 | lsd:2-6 | 750 | ellbri | Brian Ellis | 685.00 | 685.00 | 99.00 | 0.00 | 04/01/2009 | 03/31/2013 |
| H212 | lsd:2-6 | 750 | t0000437 | Lamar Strickland | 665.00 | 665.00 | 1,390.00 | 0.00 | 02/29/2012 | 03/31/2013 |
| I001 | lsd:2-6 | 750 | t0000869 | Carribarie Rattiff | 680.00 | 650.00 | 691.67 | 0.00 | 06/30/2012 | 06/30/2013 |
| I002 | lsd:2-6 | 740 | reesab | Sabrina Reed | 665.00 | 665.00 | 100.00 | 0.00 | 08/31/2010 | 09/30/2012 |
| I003 | lsd:1-9 | 588 | valjet | Jeton Valentin | 575.00 | 575.00 | 530.00 | 0.00 | 09/30/2007 | 10/31/2012 |
| I004 | lsd:1-9 | 588 | fieter | Terrence Fields | 557.00 | 557.00 | 966.00 | 25.00 | 11/01/2004 | 10/31/2012 |
| I005 | lsd:1-9 | 588 | powant | Anthony Powell | 545.00 | 545.00 | 399.00 | 0.00 | 11/30/2011 | 12/31/2012 |
| I006 | lsd:1-9 | 588 | houmat | Mateena Hough | 565.00 | 565.00 | 300.00 | 0.00 | 05/17/2010 | 06/30/2013 |
| I007 | lsd:2-8 | 835 | VACANT | VACANT | 620.00 | 0.00 | 0.00 | 0.00 | | |
| I008 | lsd:2-8 | 835 | VACANT | VACANT | 620.00 | 0.00 | 0.00 | 0.00 | | |
| I009 | lsd:2-8 | 835 | t0000487 | Jennifer Jennings | 640.00 | 640.00 | 399.00 | 0.00 | 03/14/2012 | 04/30/2013 |

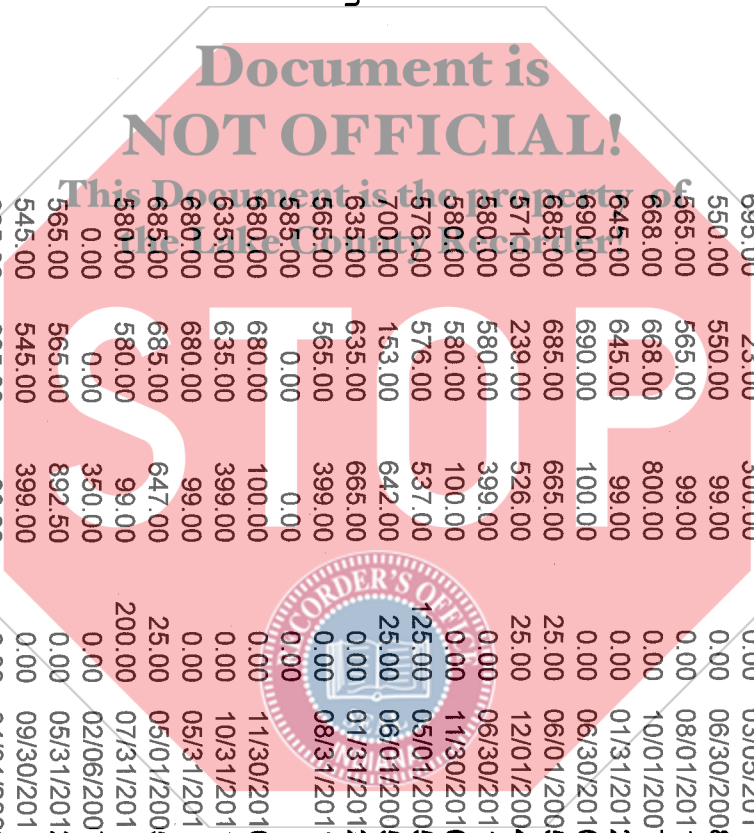

Rent Roll
Lakeshore Dunes LP (lsd)
As of: 07/23/2012

| UNIT | UNIT TYPE | UNIT SF | RESIDENT | RESIDENT NAME | MARKET RENT | ACTUAL RENT | DEPOSIT | OTHER DEPOSIT | MOVE IN | MOVE OUT |
|------|-----------|---------|----------|----------------------|-------------|-------------|----------|---------------|------------|------------|
| I010 | lsd:2-8 | 835 | campam | Pamela Campbell | 690.00 | 0.00 | 630.00 | 0.00 | 07/24/2007 | 07/31/2013 |
| I011 | lsd:1-9 | 588 | andar | Larry Anderson | 554.00 | 554.00 | 530.00 | 25.00 | 06/01/2005 | 05/31/2013 |
| I012 | lsd:1-9 | 588 | t0000756 | Shavon Thomas | 565.00 | 565.00 | 399.00 | 0.00 | 04/30/2012 | 05/31/2013 |
| I013 | lsd:eff3 | 404 | pertal | Talonya Perdue | 445.00 | 445.00 | 399.00 | 0.00 | 10/31/2011 | 11/30/2012 |
| I014 | lsd:eff3 | 404 | t0000578 | Angel Velazquez | 465.00 | 465.00 | 399.00 | 0.00 | 03/30/2012 | 04/30/2013 |
| I015 | lsd:2-6 | 750 | VACANT | VACANT | 595.00 | 0.00 | 0.00 | 0.00 | | |
| I016 | lsd:2-6 | 750 | VACANT | VACANT | 595.00 | 0.00 | 0.00 | 0.00 | | |
| I101 | lsd:2-6 | 750 | anddju | Djuana Anderson | 655.00 | 655.00 | 300.00 | 0.00 | 03/23/2009 | 04/30/2013 |
| I102 | lsd:2-6 | 750 | pearob | Robert Pearson | 673.00 | 673.00 | 665.00 | 0.00 | 01/31/2008 | 03/31/2013 |
| I103 | lsd:1-9 | 588 | robeli | Elizabeth Robertson | 590.00 | 590.00 | 100.00 | 0.00 | 06/30/2010 | 07/31/2013 |
| I104 | lsd:1-9 | 588 | cocann | Anne Coco | 585.00 | 0.00 | 585.00 | 0.00 | 09/01/2011 | 08/31/2012 |
| I105 | lsd:1-9 | 588 | tubbel | Belvia Tucker | 0.00 | 0.00 | 560.00 | 0.00 | 09/18/2007 | 08/31/2012 |
| I106 | lsd:1-9 | 588 | VACANT | VACANT | 580.00 | 0.00 | 0.00 | 0.00 | | |
| I107 | lsd:2-8 | 835 | adasha | Shawn Adams Sr. | 660.00 | 660.00 | 99.00 | 0.00 | 11/29/2008 | 12/31/2012 |
| I108 | lsd:2-8 | 835 | gordrob | Robert Gordon, Jr. | 675.00 | 675.00 | 300.00 | 0.00 | 01/31/2011 | 03/31/2013 |
| I109 | lsd:2-8 | 835 | t0000669 | Chanel Johnson | 655.00 | 655.00 | 1,027.50 | 0.00 | 04/30/2012 | 05/31/2013 |
| I110 | lsd:2-8 | 835 | mooper | Percy Moore | 690.00 | 690.00 | 1,042.50 | 0.00 | 07/31/2010 | 07/31/2013 |
| I111 | lsd:1-9 | 588 | shujoh | John Shuey | 615.00 | 615.00 | 99.00 | 0.00 | 10/31/2011 | 11/30/2012 |
| I112 | lsd:1-9 | 588 | hilkry | Krystal Hill | 545.00 | 545.00 | 399.00 | 0.00 | 09/23/2011 | 10/31/2012 |
| I113 | lsd:eff3 | 404 | gorjas | Jason Gore | 490.00 | 490.00 | 99.00 | 0.00 | 02/28/2011 | 03/31/2013 |
| I114 | lsd:eff3 | 404 | batden | Denita Batemane | 435.00 | 435.00 | 930.00 | 0.00 | 11/30/2011 | 12/31/2012 |
| I115 | lsd:2-6 | 750 | halshi | Shirley Hall | 640.00 | 665.00 | 99.00 | 0.00 | 07/01/2012 | 07/31/2013 |
| I116 | lsd:2-6 | 750 | mcdbrl | Bridget McDaniels | 655.00 | 655.00 | 625.00 | 25.00 | 07/01/2004 | 06/30/2013 |
| I201 | lsd:2-6 | 750 | t0000431 | Linda Bryant | 640.00 | 640.00 | 399.00 | 0.00 | 02/29/2012 | 03/31/2013 |
| I202 | lsd:2-6 | 750 | waldam | Dameon Walker | 681.00 | 681.00 | 667.00 | 25.00 | 10/21/2003 | 11/30/2012 |
| I203 | lsd:1-9 | 588 | mortea | Tealicia Morris | 540.00 | 540.00 | 640.00 | 0.00 | 10/21/2011 | 10/31/2012 |
| I204 | lsd:1-9 | 588 | smishe | Tatinyana Smith | 565.00 | 565.00 | 595.00 | 0.00 | 11/30/2009 | 12/31/2012 |
| I205 | lsd:1-9 | 588 | t0000786 | Ernest Thirston | 565.00 | 565.00 | 399.00 | 0.00 | 05/09/2012 | 05/31/2013 |
| I206 | lsd:1-9 | 588 | cofyr | Tyrone Coffey | 570.00 | 570.00 | 250.00 | 0.00 | 04/30/2006 | 06/30/2013 |
| I207 | lsd:2-8 | 835 | t0000758 | Benita Mcbride | 665.00 | 665.00 | 695.00 | 0.00 | 05/31/2012 | 06/30/2013 |
| I208 | lsd:2-8 | 835 | utegeo | Georgia Ulendahl | 665.00 | 665.00 | 100.00 | 0.00 | 05/01/2011 | 05/31/2013 |
| I209 | lsd:2-8 | 835 | t0000567 | Destiny Hudson | 640.00 | 640.00 | 399.00 | 0.00 | 03/31/2012 | 04/30/2013 |
| I210 | lsd:2-8 | 835 | t0000620 | Jameshea Stevenson | 640.00 | 640.00 | 1,000.00 | 0.00 | 03/31/2012 | 04/30/2013 |
| I211 | lsd:1-9 | 588 | t0001198 | Tom Moore | 545.00 | 595.00 | 399.00 | 0.00 | 06/30/2012 | 12/31/2012 |
| I212 | lsd:1-9 | 588 | wornrn | Ernest Worix | 570.00 | 570.00 | 300.00 | 0.00 | 07/01/2011 | 06/30/2013 |
| I213 | lsd:eff3 | 404 | khaman | Maniphon Khanthavong | 490.00 | 490.00 | 100.00 | 0.00 | 08/31/2010 | 09/30/2012 |
| I214 | lsd:eff3 | 404 | broded | Dedrick Brookins | 445.00 | 445.00 | 399.00 | 0.00 | 10/31/2011 | 12/30/2012 |
| I215 | lsd:2-6 | 750 | larkei | Keisha Laraviere | 640.00 | 640.00 | 99.00 | 0.00 | 11/10/2011 | 12/31/2012 |
| I216 | lsd:2-6 | 750 | scodea | Deandre Scott | 680.00 | 680.00 | 99.00 | 0.00 | 07/31/2011 | 08/31/2012 |

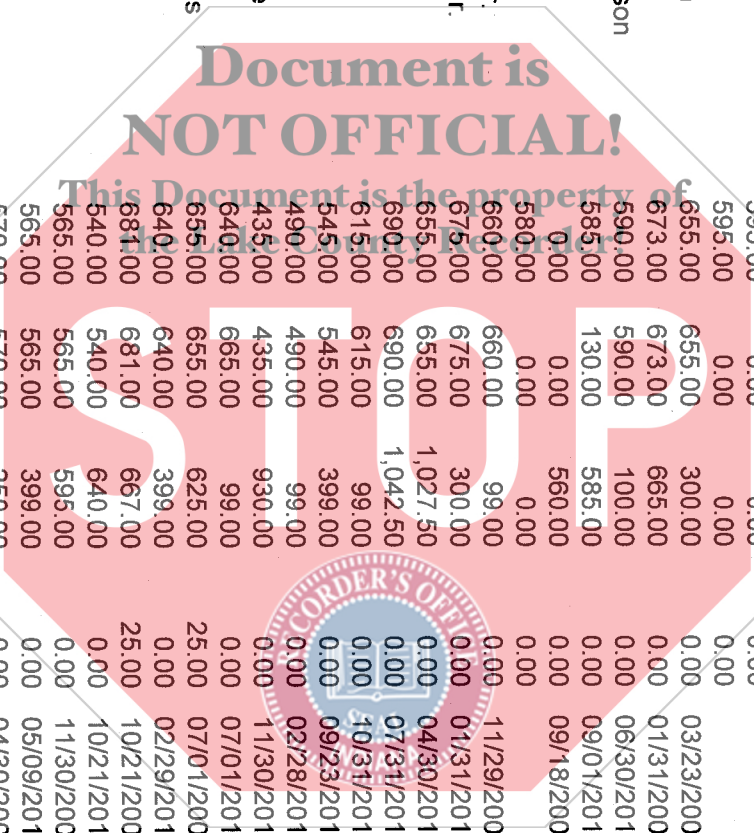

Rent Roll
Lakeshore Dunes LP (lsd)
As of: 07/23/2012

| UNIT | UNIT TYPE | UNIT SF | RESIDENT | RESIDENT NAME | MARKET RENT | ACTUAL RENT | DEPOSIT | OTHER DEPOSIT | MOVE IN | MOVE OUT |
|------|-----------|---------|----------|----------------------|-------------|-------------|----------|---------------|------------|------------|
| J001 | lsd:2-6 | 750 | VACANT | VACANT | 595.00 | 0.00 | 0.00 | 0.00 | | |
| J002 | lsd:2-6 | 750 | VACANT | VACANT | 640.00 | 0.00 | 0.00 | 0.00 | | |
| J003 | lsd:1-9 | 588 | 10001196 | Mark Stevenson | 545.00 | 565.00 | 250.21 | 0.00 | 06/30/2012 | 07/31/2013 |
| J004 | lsd:1-9 | 588 | broter | Terra Brown | 565.00 | 565.00 | 399.00 | 0.00 | 08/31/2011 | 09/30/2012 |
| J005 | lsd:1-9 | 588 | adance | Noel Adams | 585.00 | 585.00 | 530.00 | 0.00 | 07/31/2007 | 08/31/2013 |
| J006 | lsd:1-9 | 588 | hurmar | Marcus Hurt | 555.00 | 555.00 | 300.00 | 0.00 | 10/31/2009 | 11/30/2012 |
| J007 | lsd:2-8 | 835 | willat | Latrese Wilson | 0.00 | 0.00 | 695.00 | 0.00 | 04/30/2010 | 04/30/2013 |
| J008 | lsd:2-8 | 835 | marmar | Manuel Marquez | 665.00 | 665.00 | 99.00 | 0.00 | 04/30/2011 | 05/31/2013 |
| J009 | lsd:2-8 | 835 | spephy | Phylicia Spears | 680.00 | 680.00 | 99.00 | 0.00 | 05/10/2011 | 06/30/2012 |
| J010 | lsd:2-8 | 835 | 10000228 | Sheila Alexander | 640.00 | 640.00 | 1,340.00 | 0.00 | 01/31/2012 | 02/28/2013 |
| J011 | lsd:1-9 | 588 | 10000188 | Krissie Erdelles | 545.00 | 545.00 | 399.00 | 0.00 | 01/31/2012 | 02/28/2013 |
| J012 | lsd:1-9 | 588 | welcia | Clardy Wells, Jr. | 545.00 | 545.00 | 399.00 | 0.00 | 10/31/2011 | 11/30/2012 |
| J013 | lsd:eff3 | 404 | wildwi | Dwight Williams, Jr. | 434.00 | 434.00 | 99.00 | 0.00 | 08/11/2008 | 09/30/2012 |
| J014 | lsd:eff3 | 404 | 10000741 | Georgianna Simpson | 455.00 | 455.00 | 399.00 | 0.00 | 04/30/2012 | 05/31/2013 |
| J015 | lsd:2-6 | 750 | VACANT | VACANT | 615.00 | 0.00 | 0.00 | 0.00 | | |
| J016 | lsd:2-6 | 750 | VACANT | VACANT | 690.00 | 0.00 | 0.00 | 0.00 | | |
| J017 | lsd:2-6 | 750 | VACANT | VACANT | 640.00 | 0.00 | 0.00 | 0.00 | | |
| J101 | lsd:2-6 | 750 | VACANT | VACANT | 640.00 | 0.00 | 0.00 | 0.00 | | |
| J102 | lsd:2-6 | 750 | VACANT | VACANT | 640.00 | 0.00 | 0.00 | 0.00 | | |
| J103 | lsd:1-9 | 588 | 10001250 | Paula Yonker/Broyles | 545.00 | 545.00 | 19.17 | 0.00 | 06/30/2012 | 06/30/2013 |
| J104 | lsd:1-9 | 588 | mcgdor | Dorothy McGill | 565.00 | 565.00 | 300.00 | 0.00 | 08/31/2010 | 09/30/2012 |
| J105 | lsd:1-9 | 588 | VACANT | VACANT | 543.00 | 0.00 | 0.00 | 0.00 | | |
| J106 | lsd:1-9 | 588 | rismar | Marvin Rist | 580.00 | 580.00 | 250.00 | 0.00 | 07/31/2006 | 12/31/2012 |
| J107 | lsd:2-8 | 835 | keladr | Adrienne Dear-Kelly | 672.00 | 672.00 | 1,312.00 | 25.00 | 03/01/2005 | 02/28/2013 |
| J108 | lsd:2-8 | 835 | shecar | Carl Sheegog | 640.00 | 640.00 | 1,340.00 | 0.00 | 10/31/2011 | 11/30/2012 |
| J109 | lsd:2-8 | 835 | ewron | Ronald Ewing | 640.00 | 640.00 | 399.00 | 0.00 | 12/31/2011 | 01/31/2013 |
| J110 | lsd:2-8 | 835 | stotra | Tranita Stovall | 673.00 | 344.00 | 625.00 | 0.00 | 02/12/2008 | 02/28/2013 |
| J111 | lsd:1-9 | 588 | 10000594 | Conchita Patty | 545.00 | 545.00 | 399.00 | 0.00 | 03/31/2012 | 04/30/2013 |
| J112 | lsd:1-9 | 588 | marcla | Clarence Martin | 585.00 | 118.00 | 535.00 | 0.00 | 12/01/2004 | 11/30/2012 |
| J113 | lsd:eff3 | 404 | 10001213 | Monique Vega | 455.00 | 465.00 | 742.50 | -369.00 | 06/30/2012 | 07/31/2013 |
| J114 | lsd:eff3 | 404 | spejac | Jacquelyn Spencer | 485.00 | 485.00 | 399.00 | 0.00 | 07/31/2011 | 08/31/2013 |
| J115 | lsd:2-6 | 750 | mcfra | Frank McClain | 690.00 | 690.00 | 665.00 | 0.00 | 03/31/2008 | 04/30/2013 |
| J116 | lsd:2-6 | 750 | milosc | Oscar Miller | 675.00 | 675.00 | 399.00 | 0.00 | 10/14/2011 | 10/31/2012 |
| J201 | lsd:2-6 | 750 | 10000680 | Kevin Tucker | 655.00 | 655.00 | 399.00 | 0.00 | 04/18/2012 | 04/30/2013 |
| J202 | lsd:2-6 | 750 | 10000846 | Beverly Davis | 665.00 | 665.00 | 399.00 | 0.00 | 05/30/2012 | 06/30/2013 |
| J203 | lsd:1-9 | 588 | 10000642 | Brittany Chapman | 565.00 | 565.00 | 399.00 | 0.00 | 04/30/2012 | 05/31/2013 |
| J204 | lsd:1-9 | 588 | hlval | Valencia Hill | 545.00 | 545.00 | 575.00 | 0.00 | 12/31/2011 | 01/31/2013 |
| J205 | lsd:1-9 | 588 | avesam | Sam Avery | 564.00 | 105.00 | 120.00 | 25.00 | 03/01/2005 | 03/31/2013 |
| J206 | lsd:1-9 | 588 | 10000076 | Edward Starzyk | 545.00 | 545.00 | 99.00 | 0.00 | 01/06/2012 | 01/31/2013 |
| J207 | lsd:2-8 | 835 | VACANT | VACANT | 640.00 | 0.00 | 0.00 | 0.00 | | |

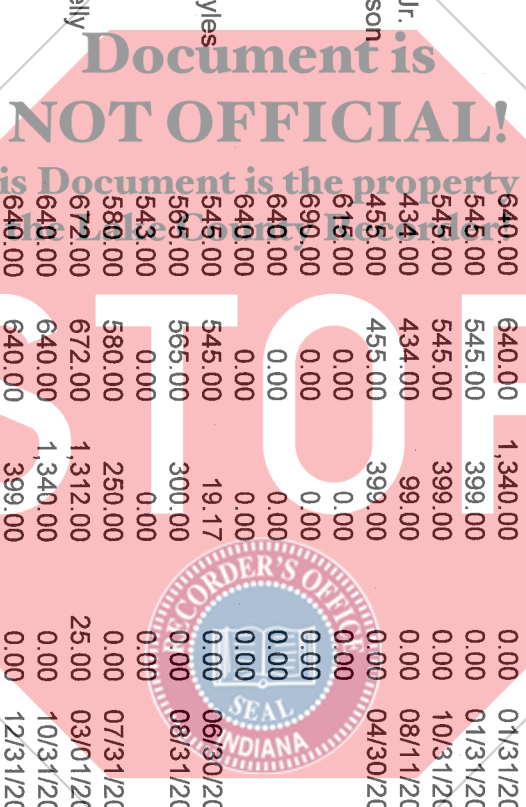

Rent Roll
Lakeshore Dunes LP (lsd)
As of: 07/23/2012

| UNIT | UNIT TYPE | UNIT SF | RESIDENT | RESIDENT NAME | MARKET RENT | ACTUAL RENT | DEPOSIT | OTHER DEPOSIT | MOVE IN | MOVE OUT |
|------|-----------|---------|----------|---------------------|-------------|-------------|----------|---------------|------------|------------|
| J208 | lsd:2-8 | 835 | irbnad | Nadine Irby | 688.00 | 688.00 | 675.00 | 25.00 | 10/14/2004 | 09/30/2011 |
| J209 | lsd:2-8 | 835 | hicind | India Hicks | 680.00 | 26.00 | 300.00 | 0.00 | 05/01/2010 | 04/30/2011 |
| J210 | lsd:2-8 | 835 | leslar | LaRon Leslie | 665.00 | 665.00 | 99.00 | 0.00 | 12/31/2009 | 12/31/2010 |
| J211 | lsd:1-9 | 588 | owemae | Maegan Owens | 545.00 | 545.00 | 399.00 | 0.00 | 10/10/2011 | 11/30/2012 |
| J212 | lsd:1-9 | 588 | marthom | Thomas Martin | 590.00 | 590.00 | 560.00 | 0.00 | 08/31/2007 | 09/30/2011 |
| J213 | lsd:eff3 | 404 | hopwal | Walter Hopkins | 473.00 | 473.00 | 408.00 | 25.00 | 06/07/2006 | 04/30/2013 |
| J214 | lsd:eff3 | 404 | ralmeg | Megan Ralls | 465.00 | 465.00 | 99.00 | 0.00 | 12/31/2009 | 01/31/2013 |
| J215 | lsd:2-6 | 750 | somrod | Rodney Sommerville | 690.00 | 690.00 | 631.00 | 25.00 | 08/01/2004 | 07/31/2013 |
| J216 | lsd:2-6 | 750 | t0000609 | Tanisha Bowen | 640.00 | 640.00 | 399.00 | 0.00 | 03/31/2012 | 04/30/2013 |
| K001 | lsd:2-6 | 750 | VACANT | VACANT | 680.00 | 0.00 | 0.00 | 0.00 | | |
| K002 | lsd:2-6 | 750 | jacant | Anthony Jackson | 660.00 | 660.00 | 660.00 | 0.00 | 08/31/2009 | 09/30/2012 |
| K003 | lsd:eff3 | 462 | porant | Anthony Portis | 445.00 | 445.00 | 475.00 | 0.00 | 10/31/2011 | 11/30/2012 |
| K004 | lsd:eff3 | 404 | t0000770 | Billy Batson | 455.00 | 455.00 | 399.00 | 0.00 | 04/30/2012 | 05/31/2013 |
| K005 | lsd:1-9 | 588 | VACANT | VACANT | 460.00 | 0.00 | 0.00 | 0.00 | | |
| K006 | lsd:1-9 | 588 | locpam | Pamela Lockhart | 545.00 | 545.00 | 399.00 | 0.00 | 09/30/2011 | 09/30/2012 |
| K007 | lsd:2-8 | 835 | VACANT | VACANT | 600.00 | 0.00 | 0.00 | 0.00 | | |
| K008 | lsd:2-8 | 835 | VACANT | VACANT | 620.00 | 0.00 | 0.00 | 0.00 | | |
| K009 | lsd:2-8 | 835 | t0000446 | Latasha Harvey | 640.00 | 640.00 | 1,009.00 | 0.00 | 02/29/2012 | 03/31/2013 |
| K010 | lsd:2-8 | 835 | zogcla | Clarice Zogyie | 640.00 | 640.00 | 399.00 | 0.00 | 11/11/2011 | 12/31/2012 |
| K011 | lsd:1-9 | 588 | t0000014 | Marion Burnett | 545.00 | 545.00 | 399.00 | 0.00 | 12/31/2011 | 01/31/2013 |
| K012 | lsd:1-9 | 588 | wiekel | Kelly Wienckowski | 565.00 | 565.00 | 100.00 | 0.00 | 01/31/2011 | 02/28/2013 |
| K013 | lsd:1-9 | 588 | VACANT | VACANT | 545.00 | 0.00 | 0.00 | 0.00 | | |
| K014 | lsd:1-9 | 588 | kinedw | Edward Kincade | 545.00 | 545.00 | 399.00 | 0.00 | 11/30/2011 | 12/31/2012 |
| K015 | lsd:2-6 | 750 | VACANT | VACANT | 595.00 | 0.00 | 0.00 | 0.00 | | |
| K016 | lsd:2-6 | 750 | VACANT | VACANT | 595.00 | 0.00 | 0.00 | 0.00 | | |
| K101 | lsd:2-6 | 750 | t0000986 | Leslie Bell | 665.00 | 665.00 | 1,033.00 | 0.00 | 05/31/2012 | 06/30/2013 |
| K102 | lsd:2-6 | 750 | VACANT | VACANT | 655.00 | 0.00 | 0.00 | 0.00 | | |
| K103 | lsd:eff3 | 404 | bowjam | Jameel Bowen | 435.00 | 435.00 | 465.00 | 0.00 | 12/31/2011 | 01/31/2013 |
| K104 | lsd:eff3 | 404 | t0000802 | Bradley Worthington | 505.00 | 505.00 | 399.00 | 0.00 | 05/08/2012 | 11/30/2012 |
| K105 | lsd:1-9 | 588 | blotra | Tracy Blount | 565.00 | 565.00 | 100.00 | 0.00 | 12/31/2010 | 01/31/2013 |
| K106 | lsd:1-9 | 588 | starob | Robert Staley, Jr. | 565.00 | 565.00 | 100.00 | 0.00 | 08/01/2011 | 02/28/2012 |
| K107 | lsd:2-8 | 835 | ricdar | Darrin Ricketts | 690.00 | 690.00 | 606.00 | 0.00 | 10/01/2009 | 09/30/2012 |
| K108 | lsd:2-8 | 835 | t0000983 | Regina Robinson | 665.00 | 665.00 | 399.00 | 0.00 | 06/05/2012 | 06/30/2013 |
| K109 | lsd:2-8 | 835 | walern | Ernest Walton | 680.00 | 219.00 | 552.00 | 0.00 | 12/01/2009 | 11/30/2011 |
| K110 | lsd:2-8 | 835 | harvan | Vanessa Hardaway | 685.00 | 685.00 | 100.00 | 0.00 | 07/10/2010 | 08/31/2013 |
| K111 | lsd:1-9 | 588 | t0000237 | Regina Stafford | 545.00 | 545.00 | 575.00 | 0.00 | 01/31/2012 | 02/28/2013 |
| K112 | lsd:1-9 | 620 | wadsyl | Sylvia Wade | 565.00 | 565.00 | 399.00 | 0.00 | 08/31/2011 | 09/30/2012 |
| K113 | lsd:1-9 | 588 | t0000011 | Stephanie Greenwood | 535.00 | 535.00 | 399.00 | 0.00 | 12/31/2011 | 01/31/2013 |
| K114 | lsd:1-9 | 588 | t0000999 | Samantha Walton | 565.00 | 565.00 | 99.00 | 0.00 | 05/31/2012 | 06/30/2013 |

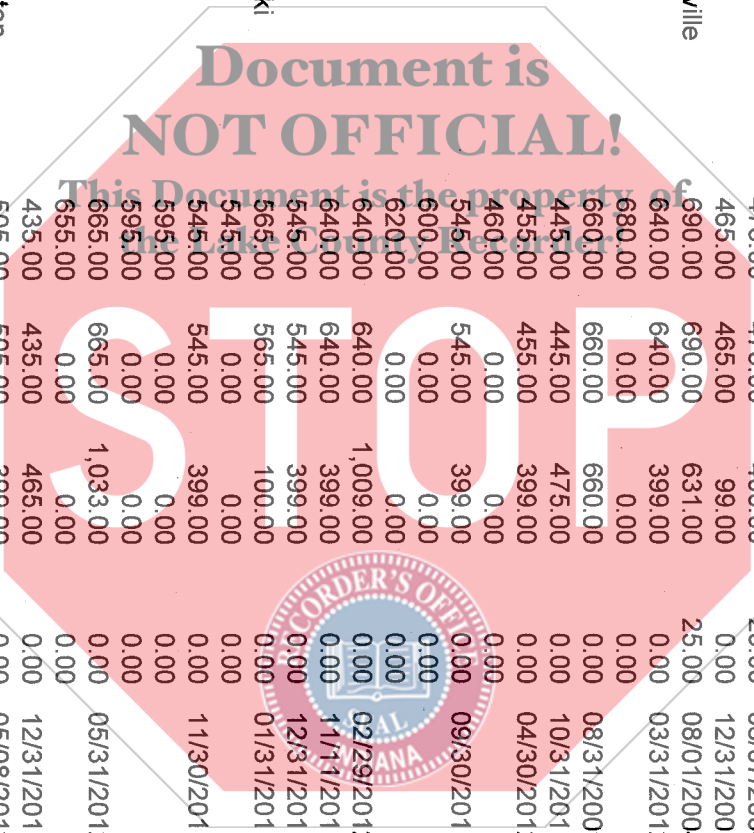

Rent Roll
Lakeshore Dunes LP (lsd)
As of: 07/23/2012

| UNIT | UNIT TYPE | UNIT SF | RESIDENT | RESIDENT NAME | MARKET RENT | ACTUAL RENT | DEPOSIT | OTHER DEPOSIT | MOVE IN | MOVE OUT |
|------|-----------|---------|----------|---------------------|-------------|-------------|----------|---------------|------------|------------|
| K115 | lsd:2-6 | 750 | t0000605 | Khrystyna McClinton | 655.00 | 655.00 | 399.00 | 0.00 | 03/31/2012 | 04/30/2013 |
| K116 | lsd:2-6 | 750 | t0000356 | Louis Aguilera | 640.00 | 640.00 | 399.00 | 0.00 | 02/21/2012 | 03/31/2013 |
| K201 | lsd:2-6 | 750 | t0000030 | Renee Brasier | 640.00 | 640.00 | 399.00 | 0.00 | 01/31/2012 | 02/28/2013 |
| K202 | lsd:2-6 | 750 | simdor | Jessica Whitlow | 680.00 | 680.00 | 99.00 | 0.00 | 01/16/2012 | 08/31/2012 |
| K203 | lsd:eff3 | 404 | t0000004 | Pearl Quiroz | 435.00 | 435.00 | 399.00 | 0.00 | 12/31/2011 | 01/31/2013 |
| K204 | lsd:eff3 | 404 | t0001122 | T Keyton Abrams | 465.00 | 465.00 | 399.00 | 0.00 | 06/22/2012 | 07/31/2013 |
| K205 | lsd:1-9 | 588 | franma | Mario Franklin | 485.00 | 485.00 | 399.00 | 0.00 | 10/15/2011 | 10/31/2012 |
| K206 | lsd:1-9 | 588 | deecha | Chad Deere | 545.00 | 545.00 | 399.00 | 0.00 | 11/18/2011 | 12/31/2012 |
| K207 | lsd:2-8 | 835 | wlskei | Keith Wilson | 677.00 | 677.00 | 350.00 | 0.00 | 07/31/2006 | 09/30/2013 |
| K208 | lsd:2-8 | 835 | t0000681 | Antonette Ford | 655.00 | 655.00 | 399.00 | 0.00 | 04/30/2012 | 05/31/2013 |
| K209 | lsd:2-8 | 835 | t0000015 | Charlyse Williams | 640.00 | 640.00 | 1,005.00 | 0.00 | 12/31/2011 | 01/31/2013 |
| K210 | lsd:2-8 | 835 | t0000176 | Bernice King | 640.00 | 640.00 | 1,005.00 | 0.00 | 01/31/2012 | 02/28/2013 |
| K211 | lsd:1-9 | 588 | t0001169 | Virginia Smith | 545.00 | 565.00 | 399.00 | 0.00 | 06/30/2012 | 07/31/2013 |
| K212 | lsd:1-9 | 588 | t0000664 | Tasia Simmons | 520.00 | 520.00 | 399.00 | 0.00 | 04/05/2012 | 04/30/2013 |
| K213 | lsd:1-9 | 588 | harrjo | Johnny Harris | 565.00 | 565.00 | 99.00 | 0.00 | 12/31/2009 | 01/31/2013 |
| K214 | lsd:1-9 | 588 | lactra | Tracey Lacefield | 580.00 | 580.00 | 300.00 | 0.00 | 03/31/2010 | 04/30/2013 |
| K215 | lsd:2-6 | 750 | wilche | Cheryl Wilson | 690.00 | 690.00 | 631.00 | 25.00 | 08/01/2004 | 07/31/2013 |
| K216 | lsd:2-6 | 750 | t0000101 | Arthur Lawson | 640.00 | 640.00 | 399.00 | 0.00 | 02/29/2012 | 03/31/2013 |
| L001 | lsd:2-6 | 750 | VACANT | VACANT | 595.00 | 0.00 | 0.00 | 0.00 | | |
| L002 | lsd:2-6 | 750 | VACANT | VACANT | 595.00 | 0.00 | 0.00 | 0.00 | | |
| L003 | lsd:1-9 | 588 | edwgat | Edgewater Systems | 545.00 | 0.00 | 671.00 | 0.00 | 11/22/2011 | 11/30/2012 |
| L004 | lsd:1-9 | 620 | VACANT | VACANT | 545.00 | 0.00 | 0.00 | 0.00 | | |
| L005 | lsd:1-9 | 588 | t0000236 | Diane Agnew | 545.00 | 545.00 | 399.00 | 0.00 | 01/31/2012 | 02/28/2013 |
| L006 | lsd:1-9 | 588 | owedej | Dejuan Owens | 565.00 | 565.00 | 399.00 | 0.00 | 08/31/2011 | 09/30/2012 |
| L007 | lsd:2-8 | 835 | howjus | Justina Howard | 665.00 | 665.00 | 399.00 | 0.00 | 08/31/2011 | 09/30/2012 |
| L008 | lsd:2-8 | 835 | t0001229 | Edgewater Systems | 620.00 | 635.00 | 0.00 | 0.00 | 06/30/2012 | 06/30/2013 |
| L009 | lsd:2-8 | 835 | nalkas | Kasey Nalls | 675.00 | 675.00 | 695.00 | 0.00 | 09/30/2010 | 10/31/2012 |
| L010 | lsd:2-8 | 835 | t0000792 | Rashedah Jackson | 660.00 | 660.00 | 690.00 | 0.00 | 04/30/2012 | 05/31/2013 |
| L011 | lsd:1-9 | 588 | t0000961 | Ebony Brodnax | 0.00 | 0.00 | 650.00 | 0.00 | 05/31/2012 | 05/31/2013 |
| L012 | lsd:1-9 | 588 | t0000754 | Autumn Shelton | 565.00 | 565.00 | 399.00 | 0.00 | 04/30/2012 | 05/31/2013 |
| L013 | lsd:eff3 | 404 | spelav | Laverne Spears | 445.00 | 445.00 | 99.00 | 0.00 | 08/31/2009 | 09/30/2012 |
| L014 | lsd:eff3 | 404 | lesvin | Vincent Lesniewski | 440.00 | 440.00 | 399.00 | 0.00 | 09/30/2011 | 10/31/2012 |
| L015 | lsd:2-6 | 750 | t0000965 | Joshua Ray | 660.00 | 660.00 | 399.00 | 0.00 | 05/31/2012 | 06/30/2013 |
| L016 | lsd:2-6 | 750 | VACANT | VACANT | 595.00 | 0.00 | 0.00 | 0.00 | | |
| L101 | lsd:2-6 | 750 | leeri | Erica Leonard | 675.00 | 192.00 | 99.00 | 0.00 | 03/31/2007 | 03/31/2013 |
| L102 | lsd:2-6 | 750 | t0001001 | Trishawn Jones | 655.00 | 655.00 | 399.00 | 0.00 | 05/31/2012 | 06/30/2013 |
| L103 | lsd:1-9 | 588 | rembra | Brandon Remmer | 565.00 | 565.00 | 99.00 | 0.00 | 07/31/2011 | 08/31/2012 |
| L104 | lsd:1-9 | 588 | yucar | Carlton Yulie | 572.00 | 572.00 | 1,116.00 | 25.00 | 11/01/2004 | 10/31/2012 |
| L105 | lsd:1-9 | 588 | edgjon | Edgewater Systems | 545.00 | 0.00 | 671.00 | 0.00 | 10/31/2011 | 10/31/2012 |

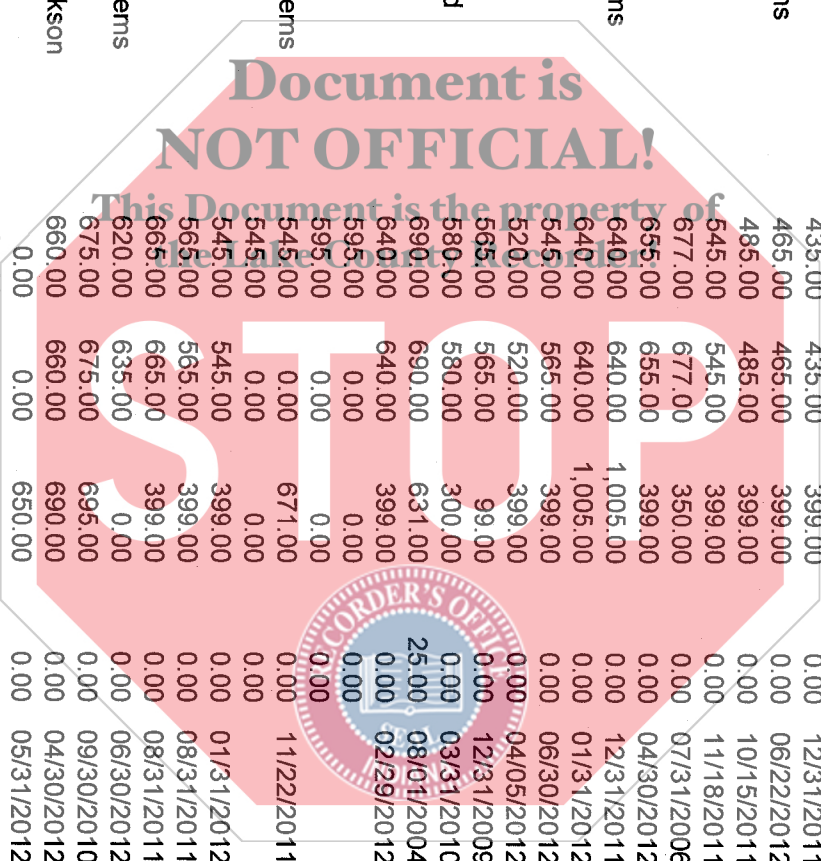

Rent Roll
Lakeshore Dunes LP (lsd)
As of: 07/23/2012

| UNIT | UNIT TYPE | UNIT SF | RESIDENT | RESIDENT NAME | MARKET RENT | ACTUAL RENT | DEPOSIT | OTHER DEPOSIT | MOVE IN | MOVE OUT |
|------|-----------|---------|----------|---------------------|-------------|-------------|----------|---------------|------------|------------|
| L106 | lsd:1-9 | 588 | maytac | Tacarra May | 565.00 | 565.00 | 100.00 | 0.00 | 09/01/2011 | 08/31/2012 |
| L107 | lsd:2-8 | 835 | smiand | Andre Smith | 680.00 | 680.00 | 99.00 | 0.00 | 09/30/2008 | 10/31/2012 |
| L108 | lsd:2-8 | 835 | t0000242 | Richard Graham | 635.00 | 635.00 | 399.00 | 0.00 | 01/31/2012 | 02/28/2013 |
| L109 | lsd:2-8 | 835 | VACANT | VACANT | 620.00 | 0.00 | 0.00 | 0.00 | | |
| L110 | lsd:2-8 | 835 | t0000796 | Lacey Simpkins, Jr. | 660.00 | 660.00 | 399.00 | 0.00 | 04/30/2012 | 05/31/2013 |
| L111 | lsd:1-9 | 588 | morver | Vera Morgan | 588.00 | 588.00 | 523.00 | 25.00 | 04/01/2005 | 03/31/2013 |
| L112 | lsd:1-9 | 588 | t0000610 | Edgewater Systems | 545.00 | 0.00 | 671.00 | 0.00 | 03/31/2012 | 03/31/2013 |
| L113 | lsd:eff3 | 404 | jimalb | Alberto Jiminez | 480.00 | 480.00 | 99.00 | 0.00 | 04/30/2006 | 05/31/2012 |
| L114 | lsd:2-6 | 750 | wescha | Karyn Wesley | 465.00 | 465.00 | 99.00 | 0.00 | 08/31/2011 | 09/30/2012 |
| L115 | lsd:2-6 | 750 | VACANT | VACANT | 665.00 | 0.00 | 0.00 | 0.00 | | |
| L116 | lsd:2-6 | 750 | t0000996 | Yionda Lewis | 660.00 | 660.00 | 399.00 | 0.00 | 05/31/2012 | 06/30/2013 |
| L201 | lsd:2-6 | 750 | colalb | Albani Coleman | 690.00 | 1.00 | 99.00 | 0.00 | 03/31/2011 | 04/30/2013 |
| L202 | lsd:2-6 | 750 | t0000854 | Lisa Winters | 595.00 | 660.00 | 399.00 | 0.00 | 07/20/2012 | 08/31/2013 |
| L203 | lsd:1-9 | 588 | edwjac | Edgewater Systems | 545.00 | 0.00 | 671.00 | 0.00 | 11/22/2011 | 11/30/2012 |
| L204 | lsd:1-9 | 588 | cowlee | Lee Cowart, Jr. | 585.00 | 585.00 | 530.00 | 0.00 | 09/15/2008 | 08/31/2013 |
| L205 | lsd:1-9 | 588 | larjoe | Joe Lara | 580.00 | 580.00 | 560.00 | 25.00 | 01/01/2005 | 12/31/2012 |
| L206 | lsd:1-9 | 588 | edgsea | Edgewater Systems | 545.00 | 0.00 | 671.00 | 0.00 | 11/21/2011 | 11/30/2012 |
| L207 | lsd:2-8 | 835 | mcenty | Tyri McNair | 668.00 | 668.00 | 660.00 | 25.00 | 07/09/2003 | 06/30/2010 |
| L208 | lsd:2-6 | 750 | t0000233 | Anthony Redmond | 635.00 | 635.00 | 399.00 | 0.00 | 01/31/2012 | 02/28/2013 |
| L209 | lsd:2-8 | 835 | t0000020 | Stephanie Morris | 635.00 | 635.00 | 399.00 | 0.00 | 12/31/2011 | 01/31/2013 |
| L210 | lsd:2-8 | 835 | elinh | Nina Ellebe | 665.00 | 665.00 | 99.00 | 0.00 | 03/06/2007 | 04/30/2011 |
| L211 | lsd:1-9 | 588 | edwcal | Edgewater Systems | 545.00 | 0.00 | 671.00 | 0.00 | 12/07/2011 | 12/31/2012 |
| L212 | lsd:1-9 | 588 | wilnes | Mesideth Williams | 565.00 | 565.00 | 399.00 | 0.00 | 08/31/2011 | 09/30/2012 |
| L213 | lsd:eff3 | 404 | wildan | Danny Willhite | 480.00 | 480.00 | 100.00 | 0.00 | 11/30/2010 | 12/31/2012 |
| L214 | lsd:eff3 | 404 | t0000504 | Adam Koskela | 455.00 | 455.00 | 399.00 | 0.00 | 03/19/2012 | 04/30/2013 |
| L215 | lsd:2-6 | 750 | wridav | David Wright | 685.00 | 685.00 | 99.00 | 100.00 | 03/31/2011 | 04/30/2013 |
| L216 | lsd:2-6 | 750 | dotlin | Linda Dotson | 643.00 | 643.00 | 250.00 | 0.00 | 10/31/2005 | 12/31/2010 |
| M001 | lsd:2-6 | 750 | VACANT | VACANT | 595.00 | 0.00 | 0.00 | 0.00 | | |
| M002 | lsd:2-6 | 750 | t0001161 | Marcia Johnson | 595.00 | 625.00 | 399.00 | 0.00 | 06/30/2012 | 07/31/2013 |
| M003 | lsd:1-6 | 700 | peteri | Eric Peterson | 540.00 | 540.00 | 399.00 | 0.00 | 11/30/2011 | 12/31/2012 |
| M004 | lsd:1-6 | 700 | holcar | Carla Hollowell | 590.00 | 183.00 | 99.00 | 0.00 | 06/22/2010 | 06/30/2013 |
| M006 | lsd:1-6 | 700 | t0001252 | Kent Reed | 575.00 | 560.00 | 1,080.00 | 0.00 | 06/30/2012 | 07/31/2013 |
| M008 | lsd:1-6 | 700 | VACANT | VACANT | 580.00 | 0.00 | 0.00 | 0.00 | | |
| M009 | lsd:1-7 | 555 | mccpat | Patricia McClatchey | 560.00 | 560.00 | 99.00 | 0.00 | 04/30/2011 | 05/31/2013 |
| M010 | lsd:1-6 | 700 | locbes | Bessie Lockette | 575.00 | 176.00 | 100.00 | 0.00 | 10/01/2010 | 09/30/2012 |
| M011 | lsd:1-6 | 700 | barwil | Willie Barnes | 540.00 | 540.00 | 1,080.00 | 0.00 | 10/31/2011 | 12/30/2012 |
| M012 | lsd:1-6 | 700 | VACANT | VACANT | 540.00 | 0.00 | 0.00 | 0.00 | | |
| M013 | lsd:1-6 | 700 | t0000773 | Murrell Porche | 575.00 | 575.00 | 399.00 | 0.00 | 04/30/2012 | 05/31/2013 |
| M014 | lsd:1-6 | 700 | ridtom | Tomorah Riddle | 595.00 | 595.00 | 555.00 | 0.00 | 04/30/2008 | 05/31/2013 |

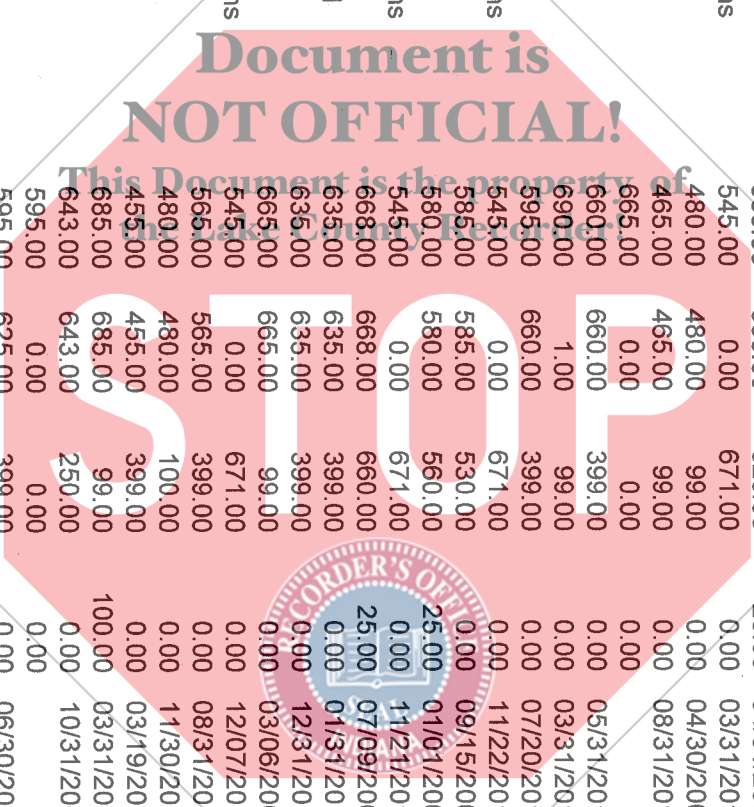

Rent Roll
Lakeshore Dunes LP (lsd)
As of: 07/23/2012

| UNIT | UNIT TYPE | UNIT SF | RESIDENT | RESIDENT NAME | MARKET RENT | ACTUAL RENT | DEPOSIT | OTHER DEPOSIT | MOVE IN | MOVE OUT |
|------|-----------|---------|-----------|------------------------------|-------------|-------------|----------|---------------|------------|------------|
| M015 | lsd:2-6 | 750 | holver | Veronica Holmes | 635.00 | 635.00 | 1,000.00 | 0.00 | 03/01/2011 | 03/31/2013 |
| M016 | lsd:2-6 | 750 | VACANT | VACANT | 595.00 | 0.00 | 0.00 | 0.00 | | |
| M101 | lsd:2-6 | 750 | VACANT | VACANT | 595.00 | 0.00 | 0.00 | 0.00 | | |
| M102 | lsd:2-6 | 750 | grafit | Tiffany Grady | 655.00 | 655.00 | 99.00 | 0.00 | 12/31/2008 | 02/28/2013 |
| M103 | lsd:1-6 | 700 | limwes | Weston Limehouse | 540.00 | 540.00 | 399.00 | 0.00 | 12/31/2011 | 01/31/2013 |
| M104 | lsd:1-6 | 700 | kinash | Ashton King | 570.00 | 570.00 | 847.50 | 0.00 | 01/15/2011 | 02/28/2013 |
| M105 | lsd:1-6 | 700 | crabia | Bianca Crawford | 582.00 | 582.00 | 525.00 | 25.00 | 09/29/2004 | 10/31/2012 |
| M106 | lsd:1-6 | 700 | morlar | Larry Morris | 587.00 | 587.00 | 525.00 | 25.00 | 05/01/2005 | 04/30/2013 |
| M107 | lsd:1-6 | 700 | carger | Geraldine Cartegena | 610.00 | 0.00 | 1,050.00 | 25.00 | 08/13/2004 | 09/30/2012 |
| M108 | lsd:1-6 | 700 | nelran | Randy Nelson | 570.00 | 570.00 | 100.00 | 0.00 | 11/12/2010 | 12/31/2012 |
| M109 | lsd:1-6 | 700 | dencam | Carnille Dennie | 569.00 | 569.00 | 512.00 | 25.00 | 09/01/2004 | 08/31/2013 |
| M110 | lsd:1-6 | 700 | miden | Denella Mitchell | 560.00 | 560.00 | 99.00 | 0.00 | 11/30/2010 | 12/31/2012 |
| M111 | lsd:1-6 | 700 | boumar | Marvin Bourn | 594.00 | 594.00 | 555.00 | 0.00 | 01/31/2008 | 03/31/2013 |
| M112 | lsd:1-6 | 700 | joyque | Quest Joyner | 575.00 | 575.00 | 99.00 | 0.00 | 07/31/2011 | 08/31/2013 |
| M113 | lsd:1-6 | 700 | thomla | Latasha Thomas | 545.00 | 545.00 | 545.00 | 0.00 | 02/01/2011 | 03/31/2013 |
| M114 | lsd:1-6 | 700 | VACANT | VACANT | 560.00 | 0.00 | 0.00 | 0.00 | | |
| M115 | lsd:2-6 | 750 | jonekat | Katherine Jones | 680.00 | 680.00 | 100.00 | 0.00 | 04/16/2010 | 05/31/2013 |
| M116 | lsd:2-6 | 750 | browhi | Whitney Brooks | 640.00 | 640.00 | 639.00 | 0.00 | 03/22/2011 | 03/31/2013 |
| M201 | lsd:2-6 | 750 | t0000960 | Linda Sconiers | 625.00 | 625.00 | 399.00 | 0.00 | 05/31/2012 | 06/30/2013 |
| M202 | lsd:2-6 | 750 | VACANT | VACANT | 650.00 | 0.00 | 0.00 | 0.00 | | |
| M203 | lsd:1-6 | 700 | joneter | Terrell Jones | 540.00 | 540.00 | 99.00 | 0.00 | 10/20/2011 | 11/30/2012 |
| M204 | lsd:1-6 | 700 | canake | Akeva Cannon | 575.00 | 575.00 | 99.00 | 0.00 | 02/28/2011 | 03/31/2013 |
| M205 | lsd:1-6 | 700 | t0000742 | Aaron Sims | 575.00 | 575.00 | 399.00 | 0.00 | 04/30/2012 | 05/31/2013 |
| M206 | lsd:1-6 | 700 | dislar | Laron Dishmon | 570.00 | 570.00 | 480.00 | 0.00 | 01/01/2011 | 12/31/2012 |
| M207 | lsd:1-6 | 700 | thojac | Jacob Thomas III | 585.00 | 585.00 | 99.00 | 0.00 | 04/30/2010 | 05/31/2013 |
| M208 | lsd:1-6 | 700 | johalm | Alma Johnson | 540.00 | 540.00 | 1,080.00 | 0.00 | 11/30/2011 | 12/31/2012 |
| M209 | lsd:1-6 | 700 | t0000564 | Adrene Patterson | 565.00 | 565.00 | 565.00 | 0.00 | 03/31/2012 | 04/30/2013 |
| M210 | lsd:1-6 | 700 | tayray | Ray Taylor | 575.00 | 575.00 | 99.00 | 0.00 | 07/31/2009 | 08/31/2013 |
| M211 | lsd:1-6 | 700 | t0000037 | Alecia Rogers | 550.00 | 550.00 | 399.00 | 0.00 | 01/31/2012 | 02/28/2013 |
| M212 | lsd:1-6 | 700 | t0000112 | Nicholas Christopher Andrzej | 550.00 | 550.00 | 1,100.00 | 0.00 | 01/20/2012 | 02/28/2013 |
| M213 | lsd:1-6 | 700 | t00000810 | Virgil Coulter | 575.00 | 575.00 | 399.00 | 0.00 | 05/10/2012 | 05/31/2013 |
| M214 | lsd:1-6 | 700 | barlea | Jean Barnlund | 540.00 | 540.00 | 399.00 | 0.00 | 11/30/2011 | 12/31/2012 |
| M215 | lsd:2-6 | 750 | t0000483 | Erica Emerson | 600.00 | 600.00 | 399.00 | 0.00 | 05/14/2012 | 05/31/2013 |
| M216 | lsd:2-6 | 750 | mccris | Risha McCain | 640.00 | 640.00 | 640.00 | 0.00 | 10/31/2011 | 11/30/2012 |
| N001 | lsd:3-1 | 950 | t0000160 | Tonya Kidd | 800.00 | 800.00 | 399.00 | 0.00 | 01/31/2012 | 02/28/2013 |
| N002 | lsd:3-1 | 950 | t0000780 | Sabrina Turner | 850.00 | 850.00 | 399.00 | 0.00 | 04/30/2012 | 10/31/2012 |
| N003 | lsd:eff2 | 462 | fegire | Gregory Feguer | 462.00 | 462.00 | 215.00 | 0.00 | 10/31/2008 | 11/30/2012 |
| N004 | lsd:eff2 | 462 | curtia | Tiaa Curry | 445.00 | 445.00 | 890.00 | 0.00 | 09/16/2011 | 09/30/2012 |
| N005 | lsd:2-4 | 700 | johber | Bernice Johnson | 625.00 | 123.00 | 99.00 | 0.00 | 11/08/2010 | 11/30/2012 |

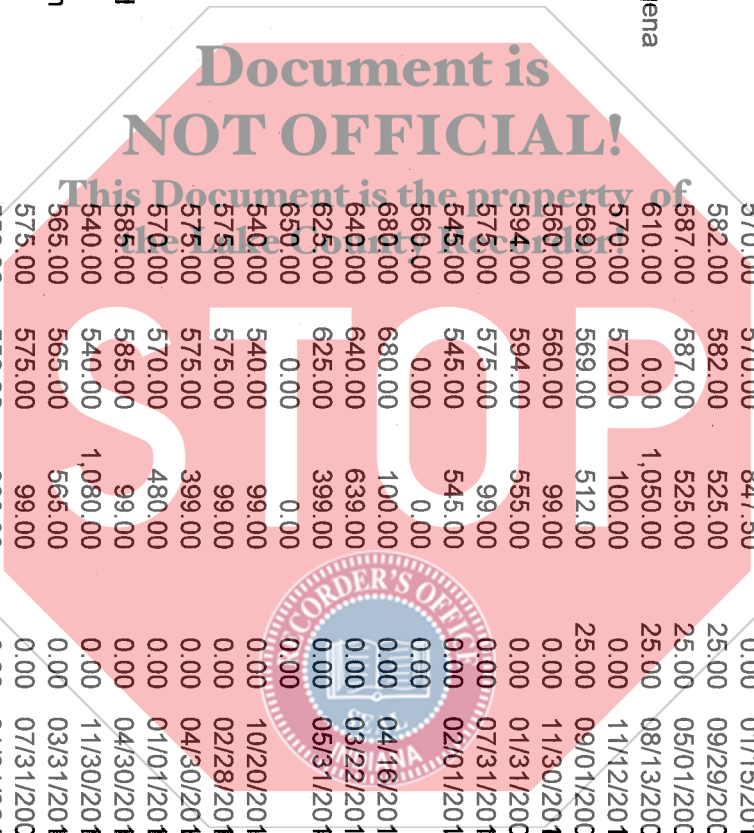

Rent Roll
Lakeshore Dunes LP (lsd)
As of: 07/23/2012

| UNIT | UNIT TYPE | UNIT SF | RESIDENT | RESIDENT NAME | MARKET RENT | ACTUAL RENT | DEPOSIT | OTHER DEPOSIT | MOVE IN | MOVE OUT |
|------|-----------|---------|----------|---------------------|-------------|-------------|----------|---------------|------------|------------|
| N006 | lsd:2-4 | 700 | VACANT | VACANT | 650.00 | 0.00 | 0.00 | 0.00 | | |
| N007 | lsd:2-4 | 700 | VACANT | VACANT | 555.00 | 0.00 | 0.00 | 0.00 | | |
| N009 | lsd:2-4 | 700 | VACANT | VACANT | 555.00 | 0.00 | 0.00 | 0.00 | | |
| N011 | lsd:2-4 | 700 | VACANT | VACANT | 555.00 | 0.00 | 0.00 | 0.00 | | |
| N013 | lsd:eff2 | 462 | piejon | Jonas Pierce | 465.00 | 465.00 | 99.00 | 0.00 | 10/09/2008 | 11/30/2012 |
| N014 | lsd:eff2 | 462 | schsea | Sean Schuster | 475.00 | 475.00 | 475.00 | 0.00 | 07/31/2011 | 08/31/2012 |
| N015 | lsd:3-1 | 950 | curthen | Henry Curtis | 875.00 | 875.00 | 99.00 | 0.00 | 06/30/2011 | 07/31/2013 |
| N016 | lsd:3-1 | 950 | lesmel | Melanie Lester | 875.00 | 875.00 | 399.00 | 0.00 | 09/30/2011 | 10/31/2012 |
| N101 | lsd:3-1 | 950 | hiliang | Angella Hillard | 940.00 | 0.00 | 599.00 | 0.00 | 04/01/2010 | 03/31/2013 |
| N102 | lsd:3-1 | 950 | cretam | Tamara Crews | 860.00 | 860.00 | 99.00 | 0.00 | 09/30/2008 | 10/31/2012 |
| N103 | lsd:eff2 | 462 | t0000934 | Charles Pheal | 460.00 | 460.00 | 399.00 | 0.00 | 05/25/2012 | 06/30/2013 |
| N104 | lsd:eff2 | 462 | klegeo | George Klepper | 495.00 | 495.00 | 410.00 | 25.00 | 06/01/2005 | 05/31/2013 |
| N105 | lsd:2-4 | 700 | VACANT | VACANT | 555.00 | 0.00 | 0.00 | 0.00 | | |
| N106 | lsd:2-4 | 700 | VACANT | VACANT | 555.00 | 0.00 | 0.00 | 0.00 | | |
| N107 | lsd:2-4 | 700 | t0000952 | Alana Hightower | 595.00 | 595.00 | 335.89 | 0.00 | 05/30/2012 | 06/30/2013 |
| N108 | lsd:1-8 | 620 | gibkev | Kevin Gibson | 585.00 | 585.00 | 480.00 | 0.00 | 08/01/2010 | 07/31/2013 |
| N109 | lsd:2-4 | 700 | VACANT | VACANT | 625.00 | 0.00 | 0.00 | 0.00 | | |
| N110 | lsd:1-7 | 555 | edwbat | Edgewater Systems | 575.00 | 0.00 | 671.00 | 0.00 | 12/29/2011 | 12/31/2012 |
| N111 | lsd:2-4 | 700 | VACANT | VACANT | 555.00 | 0.00 | 0.00 | 0.00 | | |
| N112 | lsd:2-4 | 700 | VACANT | VACANT | 640.00 | 0.00 | 0.00 | 0.00 | | |
| N113 | lsd:eff2 | 462 | smidon | Donna Smith | 495.00 | 495.00 | 200.00 | 0.00 | 03/31/2009 | 04/30/2013 |
| N114 | lsd:eff2 | 462 | garcar | Carol Garth | 450.00 | 450.00 | 99.00 | 0.00 | 12/24/2011 | 01/31/2013 |
| N115 | lsd:3-1 | 950 | motcan | Candice Moten | 825.00 | 0.00 | 975.00 | 0.00 | 11/21/2011 | 11/30/2012 |
| N116 | lsd:3-1 | 950 | wilicar | Carolyn Williams | 800.00 | 800.00 | 399.00 | 0.00 | 12/31/2011 | 01/31/2013 |
| N201 | lsd:3-1 | 740 | t0000771 | Beverly Winfield | 850.00 | 850.00 | 850.00 | 0.00 | 04/30/2012 | 05/31/2013 |
| N202 | lsd:3-1 | 950 | lehdon | Donielle Lehmann | 885.00 | 885.00 | 99.00 | 0.00 | 06/30/2011 | 07/31/2012 |
| N203 | lsd:eff2 | 462 | t0000973 | Vanessa Little | 460.00 | 460.00 | 399.00 | 0.00 | 05/31/2012 | 06/30/2013 |
| N204 | lsd:eff2 | 462 | barnic | Nicole Barnes | 465.00 | 465.00 | 300.00 | 0.00 | 02/28/2010 | 03/31/2013 |
| N205 | lsd:2-4 | 700 | spathe | Theresa Spann | 645.00 | 645.00 | 287.50 | 0.00 | 10/31/2008 | 11/30/2012 |
| N206 | lsd:2-4 | 700 | t0000293 | Reginald Johnson | 575.00 | 575.00 | 1,150.00 | 0.00 | 02/13/2012 | 02/28/2013 |
| N207 | lsd:2-7 | 720 | t0000839 | Joanne Cochran | 595.00 | 595.00 | 399.00 | 0.00 | 05/12/2012 | 05/31/2013 |
| N208 | lsd:1-8 | 620 | t0000203 | Latrice Riley | 475.00 | 475.00 | 99.00 | 0.00 | 01/31/2012 | 02/28/2013 |
| N209 | lsd:2-7 | 720 | t0000676 | Michelle Dumas | 590.00 | 590.00 | 399.00 | 0.00 | 04/16/2012 | 05/31/2013 |
| N210 | lsd:1-7 | 555 | t0000882 | Jaime Corrales | 560.00 | 560.00 | 399.00 | 0.00 | 05/16/2012 | 10/31/2012 |
| N211 | lsd:2-4 | 700 | t0000844 | Christopher Robbins | 595.00 | 595.00 | 399.00 | 0.00 | 05/11/2012 | 05/31/2013 |
| N212 | lsd:2-4 | 700 | t0000982 | Latrice Sorrells | 595.00 | 595.00 | 399.00 | 0.00 | 05/31/2012 | 06/30/2013 |
| N213 | lsd:eff2 | 462 | crucyn | Cynthia Cruz | 460.00 | 460.00 | 440.00 | 0.00 | 03/28/2008 | 04/30/2013 |
| N214 | lsd:eff2 | 462 | mitsie | Steven Mitchell | 470.00 | 470.00 | 410.00 | 0.00 | 06/30/2008 | 07/31/2012 |
| N215 | lsd:3-1 | 950 | dixlea | Leah Dixon | 875.00 | 42.00 | 300.00 | 0.00 | 10/01/2010 | 09/30/2012 |

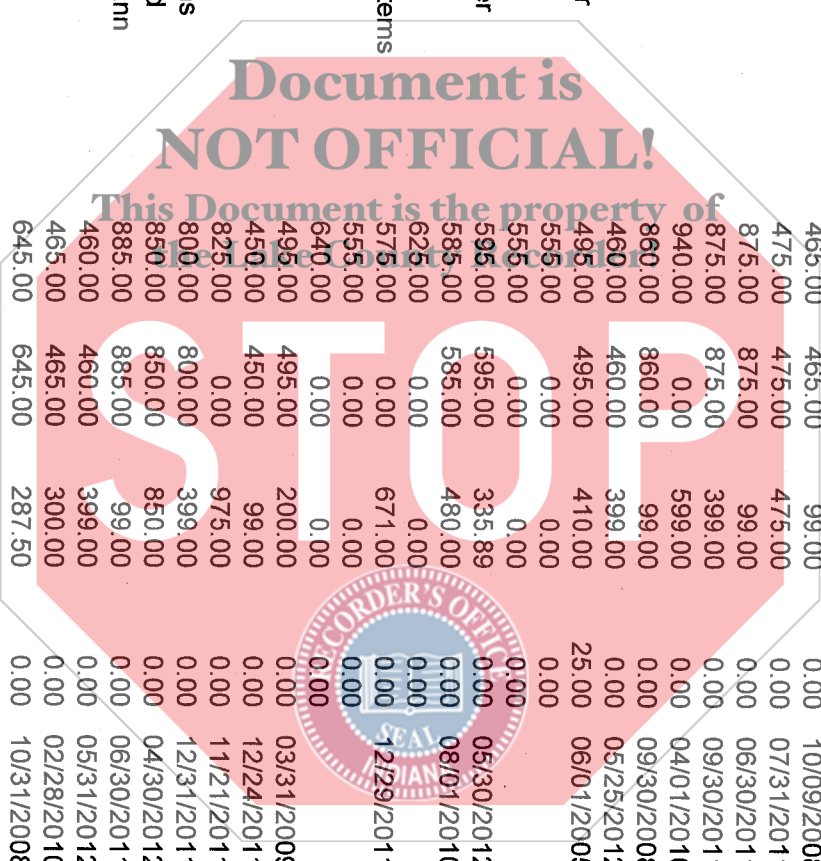

Rent Roll
Lakeshore Dunes LP (Isd)
As of: 07/23/2012

| UNIT | UNIT TYPE | UNIT SF | RESIDENT | RESIDENT NAME | MARKET RENT | ACTUAL RENT | DEPOSIT | OTHER DEPOSIT | MOVE IN | MOVE OUT |
|------|-----------|---------|----------|--------------------|-------------|-------------|----------|---------------|------------|------------|
| N216 | Isd:3-1 | 950 | wallat | Latonya Walker | 825.00 | 0.00 | 975.00 | 0.00 | 09/30/2011 | 09/30/2012 |
| N301 | Isd:3-1 | 950 | johtal | Talea Johnson | 825.00 | 0.00 | 975.00 | 0.00 | 09/30/2011 | 09/30/2012 |
| N302 | Isd:3-1 | 950 | chalat | Latonya Charleston | 899.00 | 96.00 | 756.00 | 25.00 | 04/01/2005 | 03/31/2013 |
| N303 | Isd:eff2 | 462 | kimtor | Torreyon Kimbrow | 450.00 | 450.00 | 399.00 | 0.00 | 11/30/2011 | 12/31/2012 |
| N304 | Isd:eff2 | 462 | moscha | Charita Mosley | 475.00 | 475.00 | 460.00 | 0.00 | 08/31/2010 | 09/30/2012 |
| N305 | Isd:2-4 | 700 | shejul | Julius Sherrod | 580.00 | 580.00 | 300.00 | 0.00 | 01/31/2012 | 09/30/2012 |
| N306 | Isd:2-4 | 700 | t0001009 | Tiana Frazier | 595.00 | 595.00 | 399.00 | 0.00 | 05/31/2012 | 06/30/2013 |
| N307 | Isd:2-7 | 720 | t0001149 | Marsha Lightning | 575.00 | 595.00 | 399.00 | 0.00 | 06/30/2012 | 07/31/2013 |
| N308 | Isd:1-8 | 620 | spalou | Louis Spann | 577.00 | 577.00 | 475.00 | 25.00 | 12/01/2004 | 11/30/2012 |
| N309 | Isd:2-7 | 750 | t0000524 | Kyra Handford | 595.00 | 595.00 | 399.00 | 0.00 | 03/31/2012 | 04/30/2013 |
| N310 | Isd:1-7 | 555 | t0000382 | Ronnie Gordon | 550.00 | 550.00 | 550.00 | 0.00 | 02/29/2012 | 03/31/2013 |
| N311 | Isd:2-4 | 700 | t0001171 | Ivana Jenkins | 555.00 | 595.00 | 399.00 | 0.00 | 06/30/2012 | 07/31/2013 |
| N312 | Isd:2-4 | 700 | dyetab | Tabitha Dye | 665.00 | 0.00 | 300.00 | 0.00 | 07/28/2010 | 07/31/2012 |
| N313 | Isd:eff2 | 462 | t0000119 | Bryce Ross | 450.00 | 450.00 | 399.00 | 0.00 | 01/17/2012 | 01/31/2013 |
| N314 | Isd:eff2 | 462 | edwedn | Edna Edwards | 480.00 | 480.00 | 425.00 | 0.00 | 11/30/2007 | 12/31/2011 |
| N315 | Isd:3-1 | 950 | VACANT | VACANT | 870.00 | 0.00 | 0.00 | 0.00 | | |
| N316 | Isd:3-1 | 950 | puglat | Latrina Pugh | 895.00 | 108.00 | 1,225.00 | 0.00 | 11/05/2010 | 11/30/2012 |

OCCUPIED UNITS 580
 OCCUPANCY PEF 85.29

