

3

STATE OF INDIANA
LAKE COUNTY
RECORDER'S OFFICE

2012 042292

2012 JUN 26 PM 4:21

MIDWESTERN
RECORDING

Recording requested by: _____ Space above reserved for use by Recorder's Office

When recorded, mail to:

Document prepared by:

Name: Cletus Potts

Name Carol Potts

Address: 1111 Westwood Dr.

Address 2428 W. Oriole Dr.

City/State/Zip: Shelby, IN 46377

City/State/Zip Wheatfield, IN 46392

Property Tax Parcel/Account Number: 45-24-33-177-001.006-007

Quitclaim Deed

Document is

NOT OFFICIAL!

This Quitclaim Deed is made on _____, between

Cletus N. Potts, Grantor, of 1111 Westwood Dr.

_____, City of Shelby, State of INDIANA,

and Cletus N. Potts and Darren N. Potts Grantee, of 1111 Westwood Dr.

_____, City of Shelby, State of INDIANA.

For valuable consideration, the Grantor hereby quitclaims and transfers all right, title, and interest held by the Grantor in the following described real estate and improvements to the Grantee, and his or her heirs and assigns, to have and hold forever, located at 1111 Westwood Dr.

_____, City of Shelby, State of INDIANA.

Legal description: PT NW S.33 T.32 R.8 .863 AC
NEW LOT 77 Unrecorded PLAT OF
SHADY shores

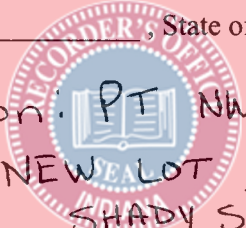

See attached legal

Subject to all easements, rights of way, protective covenants, and mineral reservations of record, if any.

Taxes for the tax year of 2012 shall be prorated between the Grantor and Grantee as of the date of recording of this deed.

DULY ENTERED FOR TAXATION SUBJECT TO FINAL ACCEPTANCE FOR TRANSFER
JUN 26 2012
PEGGY WOLING, CLERK
LAKE COUNTY, INDIANA

20th
CS
RR

★NOVA Quitclaim Deed Pg.1 (07-09)

013030

D

Dated: 5-25-12

Cletus N. Potts
Signature of Grantor

"I AFFIRM, UNDER THE PENALTIES FOR PERJURY, THAT I HAVE TAKEN REASONABLE CARE TO REDACT EACH SOCIAL SECURITY NUMBER IN THIS DOCUMENT, UNLESS REQUIRED BY LAW."

PREPARED BY: NP

Cletus N. Potts
Name of Grantor

Roscoe Wireman
Signature of Witness #1

Roscoe Wireman
Printed Name of Witness #1

Beverly Wireman
Signature of Witness #2

Beverly Wireman
Printed Name of Witness #2

State of Indiana County of Jasper

On May 25, 2012, the Grantor, Cletus N Potts,

personally came before me and, being duly sworn, did state and prove that he/she is the person described in the above document and that he/she signed the above document in my presence.

Hannah E Gunter
Notary Signature Hannah E Gunter



Notary Public,

In and for the County of Jasper State of Indiana

My commission expires: November 18, 2018 Seal

Send all tax statements to Grantee.
1111 Westwood Dr
PO Box 47
Shelby, IN 46377

PART OF THE NORTHWEST 1/4 OF SECTION 33, TOWNSHIP 32 NORTH, RANGE 8 WEST OF THE 2ND PRINCIPAL MERIDIAN, IN LAKE COUNTY, INDIANA, MORE PARTICULARLY DESCRIBED AS FOLLOWS: COMMENCING AT THE NORTHEAST CORNER OF THE NORTHWEST 1/4 OF SAID SECTION 33, AND RUNNING THENCE SOUTH 1190 FEET, THENCE WEST 362.95 FEET, THENCE SOUTH 28 DEGREES 02 MINUTES EAST, 112 FEET, THENCE SOUTH 60 DEGREES 38 MINUTES WEST, 190.20 FEET, THENCE NORTH 41 DEGREES 27 MINUTES WEST, 96.70 FEET, THENCE SOUTH 63 DEGREES 08 MINUTES WEST, 115.90 FEET TO THE POINT OF BEGINNING OF THIS DESCRIPTION, THENCE NORTH 70 DEGREES 27 MINUTES WEST, 53.35 FEET, THENCE NORTH 56 DEGREES 11 MINUTES WEST 84.70 FEET, THENCE NORTH 85 DEGREES 03 MINUTES WEST 70.90 FEET, THENCE SOUTH 63 DEGREES 20 MINUTES WEST 71.0 FEET, THENCE SOUTH 22 DEGREES 54 MINUTES WEST 37.30 FEET TO THE SOUTHWESTERLY CORNER OF LOT 77 UNRECORDED SHADY SHORES SUBDIVISION, THENCE SOUTH 68 DEGREES 02 MINUTES EAST ALONG THE SOUTHERLY LINE OF SAID LOT 77, 81.45 FEET TO THE WESTERLY BANK OF SHADY SHORE CHANNEL, THENCE NORTHEASTERLY AND EASTERLY ALONG THE BANK OF SAID CHANNEL 200 FEET, MORE OR LESS, TO A POINT WHICH IS SOUTH 15 DEGREES 19 MINUTES WEST, 31 FEET OF THE PLACE OF BEGINNING, THENCE NORTH 15 DEGREES 19 MINUTES EAST, 31 FEET TO THE POINT OF BEGINNING, ALSO KNOWN AS THE NEW LOT 77 UNRECORDED SHADY SHORES SUBDIVISION.



