

2

STATE OF INDIANA  
LAKE COUNTY  
FILED FOR RECORD

2012 041695

2012 JUN 25 AM 9:11

MICHELLE P. FAJMAN  
RECORDER

**PARTIAL RELEASE OF OPEN-END MORTGAGE, ASSIGNMENT OF RENTS AND  
LEASES, SECURITY AGREEMENT, AND FIXTURE FILING**



**First Financial Bank, N.A.**, current holder of a certain mortgage executed by **SADDLE CREEK DEVELOPMENT LLC**, as Mortgagor, to **Original Beneficiary Name: First Financial Bank, N.A.**, as Mortgagee, dated **09/04/2007**, and filed for record **Original Recording Date: 09/07/2007**, **Instrument No: 2007 072345** as , in the office of the Recorder of Lake County, Indiana, and secured upon:

hereby certifies that the mortgage is, with the indebtedness thereby secured, paid and satisfied with respect to **ONLY THE PORTION** of the property described as follows:

**Legal Description: See attached legal description for lot 22**

It is acknowledged and agreed that the release described herein is partial only as to the property described above. This partial release shall not affect the lien secured by the above mentioned mortgage as to the remaining property described in the therein.

Lender:  
**First Financial Bank, N.A.**

*Jennifer Saylor*  
By: **Jennifer Saylor**  
Its: **Assistant Vice President**

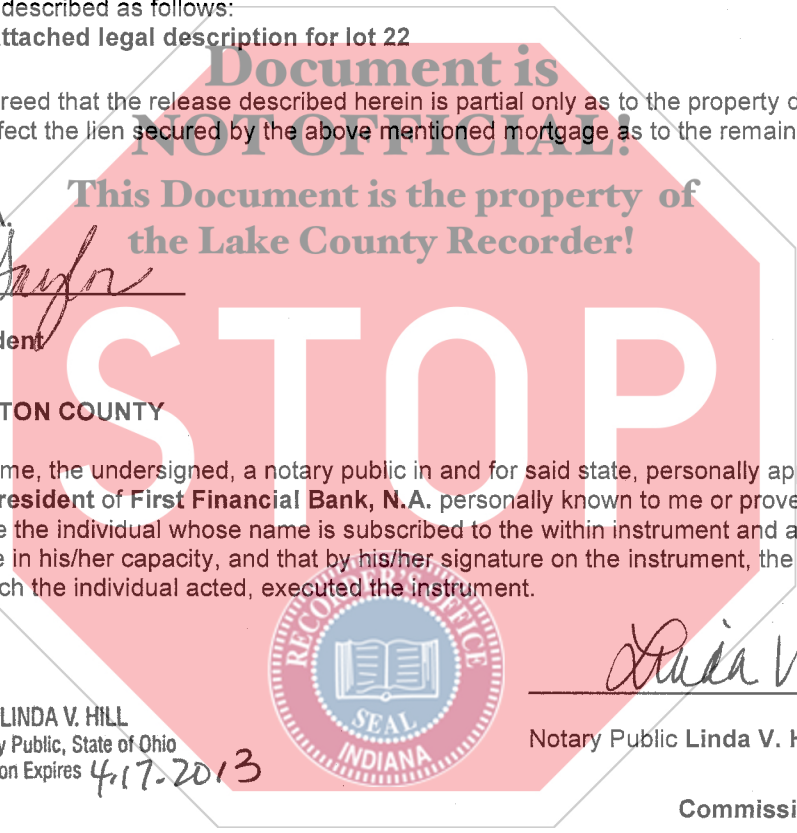

STATE OF OHIO, HAMILTON COUNTY

On **June 18, 2012** before me, the undersigned, a notary public in and for said state, personally appeared **Jennifer Saylor, Assistant Vice President** of **First Financial Bank, N.A.** personally known to me or proved to me on the basis of satisfactory evidence to be the individual whose name is subscribed to the within instrument and acknowledged to me that he/she executed the same in his/her capacity, and that by his/her signature on the instrument, the individual, or the person upon behalf of which the individual acted, executed the instrument.



**LINDA V. HILL**  
Notary Public, State of Ohio  
My Commission Expires **4-17-2013**



*Linda V. Hill*  
Notary Public **Linda V. Hill**

Commission Expires: **04/17/2013**

Return to:  
**CT LIEN SOLUTIONS**  
**PO BOX 29071**  
**GLENDALE, CA 91209-9071**  
Phone # **800-331-3282**

This Instrument was Prepared by:  
**FIRST FINANCIAL BANK, N.A.**  
**ELIZABETH DEFFINGER**  
**225 PICTORIA DRIVE SUITE 700**  
**CINCINNATI, OH 45246**

I affirm, under the penalties for perjury, that I have taken reasonable care to redact each Social Security number in this document, unless required by law.

*Elizabeth Deffinger*  
**ELIZABETH DEFFINGER**

14.00  
3952318  
44  
E

**EXHIBIT "A"**

Lot 22 Saddle Creek Subdivision - Phase II, as per plat thereof, recorded in Plat Book 101 page 26, in the Office of the Recorder of Lake County, Indiana.

Property Address: 10240 Rolling Meadows Lane, Dyer, IN 46311

