

2011 054282

2011 SEP 30 PM 1:47

MICHELLE R. FAJMAN

SWORN STATEMENT OF INTENTION TO HOLD LIEN (NOTICE OF MECHANIC'S LIEN)

To: Christopher Homes, 21 E. Lincolnway Suite B
Valparaiso, IN. 46383

Owner's Name and Address

State of Indiana, County of Porter ss

The undersigned, being first duly sworn, makes this sworn statement of intention to hold a lien upon the property described below and says that:

1. The undersigned Fashion Flooring, LLC, 2510 Beech St.
Valparaiso, IN 46383

intends to hold a lien on land legally described as follows:

Lot 48 in Schmidt farms Phase 1. Crown Point, IN.

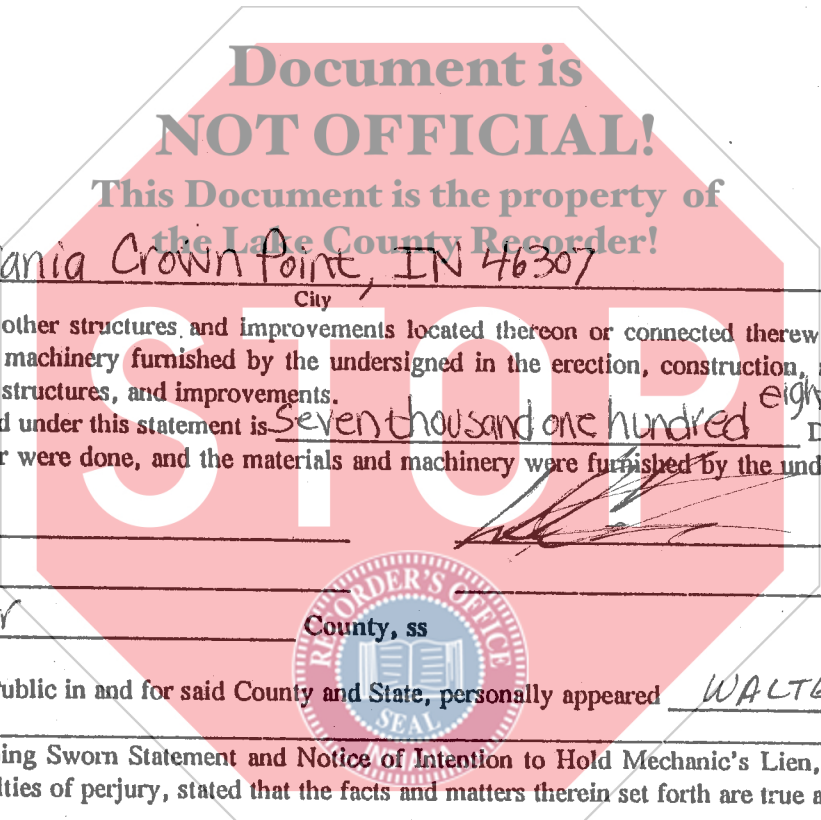

and commonly known as:

12550 Pennsylvania Crown Point, IN 46307

as well as on all building, other structures and improvements located thereon or connected therewith for work and labor done and/or materials and machinery furnished by the undersigned in the erection, construction, altering, repairing, and removing of said buildings, structures, and improvements.

2. The amount claimed under this statement is Seven thousand one hundred eighty five and 94/100 Dollars (\$ 7185.94).

3. The work and labor were done, and the materials and machinery were furnished by the undersigned within the last sixty (60) days.

State of Indiana, Porter County, ss

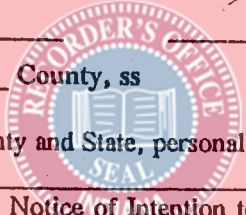

Before me, a Notary Public in and for said County and State, personally appeared WALTER CARTER and _____ who acknowledged the execution of the foregoing Sworn Statement and Notice of Intention to Hold Mechanic's Lien, and who, having been duly sworn, under the penalties of perjury, stated that the facts and matters therein set forth are true and correct.

Witness my hand and Notarial Seal this date September 30, 2011.

My commission expires 9-13-15 DANA M. HAND Notary Public

Resident of PORTER County DANA M. HAND (Printed)

I hereby certify that I have this date September 30, 2011, 2011, mailed a duplicate of this notice, first class, postage prepaid, to the within named property owner at (latest address shown on tax records) ABOVE Address

Recorder of _____ County

This instrument prepared by: _____ Resident of _____ County

AMOUNT \$ 13.00 2/c
CASH _____ CHARGE _____
CHECK # 12269
OVERAGE _____
COPY 2
NON-COM _____
CLERK JFB
E