

2011 054004

2011 SEP 30 AM 9:57

Parcel No. 45-07-26-126-006.000-006

MICHELLE T. FAJMAN  
RECORDER

**WARRANTY DEED**

ORDER NO. BT1100518

THIS INDENTURE WITNESSETH, That Gregory A. Irvin

\_\_\_\_\_ (Grantor)  
of Lake County, in the State of INDIANA CONVEY(S) AND WARRANT(S)  
to Mahmoud B Issa

\_\_\_\_\_ (Grantee)  
of Lake County, in the State of INDIANA, for the sum of \_\_\_\_\_  
ONE DOLLAR AND 00/100 Dollars (\$ 1.00 )

and other valuable consideration, the receipt and sufficiency of which is hereby acknowledged, the following described real estate in Lake County, State of Indiana:

Lot 40 in Lohman Manor, in the Town of Griffith, as per plat thereof, recorded in Plat Book 29 page 103 in the office of the recorder of Lake County, Indiana.

Subject to covenants and restrictions, easements and building lines as contained in plat of subdivision and as contained in all other documents of record; and real estate taxes and assessments for 2010 payable 2011 together with delinquency and penalty, if any, and all real estate taxes and assessments due and payable thereafter which the grantee herein assumes and agrees to pay.

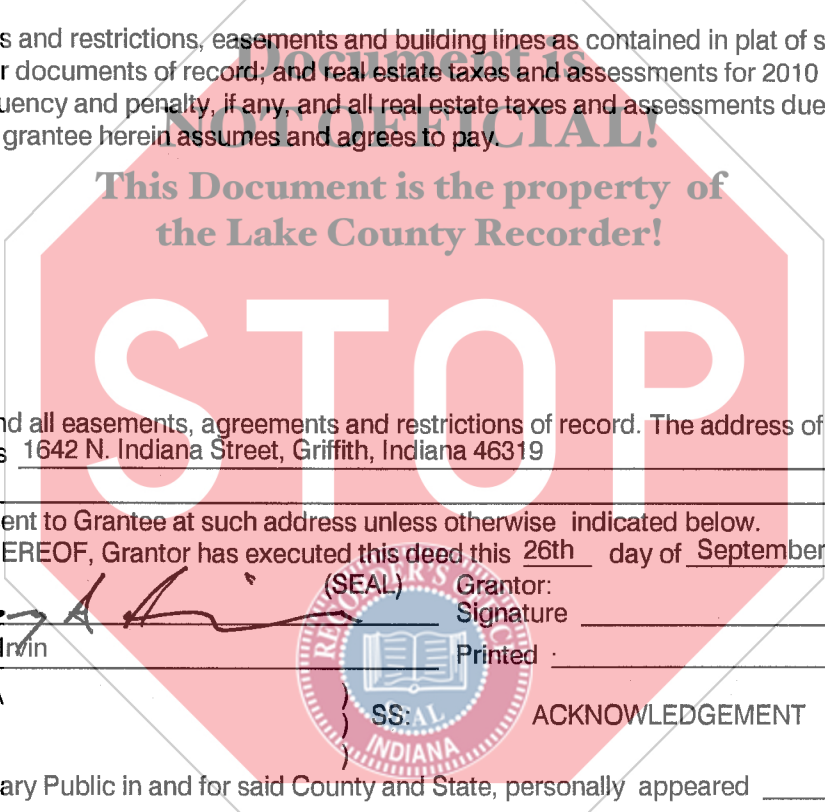

Subject to any and all easements, agreements and restrictions of record. The address of such real estate is commonly known as 1642 N. Indiana Street, Griffith, Indiana 46319

Tax bills should be sent to Grantee at such address unless otherwise indicated below.

IN WITNESS WHEREOF, Grantor has executed this deed this 26th day of September, 2011.

Grantor: \_\_\_\_\_ (SEAL) Grantor: \_\_\_\_\_ (SEAL)  
Signature \_\_\_\_\_ Signature \_\_\_\_\_  
Printed Gregory A. Irvin Printed \_\_\_\_\_

STATE OF INDIANA

COUNTY OF Lake

Before me, a Notary Public in and for said County and State, personally appeared Gregory A. Irvin

who acknowledge the execution of the foregoing Warranty Deed, and who, having been duly sworn, stated that any representations therein contained are true.

Witness my hand and Notarial Seal this 26th day of September 2011

My commission expires:  
DECEMBER 28, 2014

Signature \_\_\_\_\_  
Printed Brenda Sohovich, Notary Name  
Resident of Porter County, Indiana.

This instrument prepared by Donna LaMere, Attorney at Law, #03089-64 Igk/sch

I affirm, under the penalties for perjury, that I have taken reasonable care to redact each Social Security number in this document, unless required by law. Brenda Sohovich

Return deed to 1642 N. Indiana Street, Griffith, Indiana 46319 MI

Send tax bills to 1642 N. Indiana Street, Griffith, Indiana 46319  
(Grantee Mailing Address)

AMOUNT \$ 16.00  
CASH \_\_\_\_\_ CHARGE CT **003457**  
CHECK # \_\_\_\_\_  
OVERAGE \_\_\_\_\_  
COPY \_\_\_\_\_  
NON-COM \_\_\_\_\_  
CLERK CR

DULY ENTERED FOR TAXATION SUBJECT TO  
FINAL ACCEPTANCE FOR TRANSFER

SEP 29 2011

PEGGY HOLINGA KATONA  
LAKE COUNTY AUDITOR

CHICAGO TITLE INSURANCE COMPANY