

2

STATE OF INDIANA)
)SS:
COUNTY OF LAKE 2011 053874

IN THE LAKE CIRCUIT COURT
CROWN POINT, INDIANA

RHINO ACQUISITIONS, LLC,)
Plaintiff)
-vs-)
DAVID GOETZ, GARY SANITARY)
DISTRICT, BANK OF NEW YORK,)
MORTGAGE ELECTRONIC)
REGISTRATION SYSTEMS, INC.,)
FARM BUREAU INSURANCE)
COMPANY, CACV OF COLORADO,)
CITY OF HAMMOND AND ANY)
UNKNOWN PERSONS,)
Defendants)

CAUSE NO. 45C01-0805-PL-127

2011 053874
Filed in Open Court
OCT 23 2009

Thomas R. Philpot
CLERK LAKE CIRCUIT COURT

DECREE OF QUIET TITLE

Comes now Plaintiff, Rhino Acquisitions, LLC, by Counsel, DOUGLAS R. KVACHKOFF, and having filed Proof of Publication now submit the Application for Default Judgment and Decree of Quiet Title.

And the Court having reviewed Plaintiff's Application for Decree of Quiet Title now grants same and orders the following:

That Plaintiff, Rhino Acquisitions, LLC, be and hereby is granted sole title to the following described parcel of real estate:

Lot 38 and the South half of Lot 39, Carl Bolius First Addition to Gary, Lake County, Indiana, as shown in Plat Book 10, page 32.

Key No. 25-41-0085-0049

Commonly known as 3935 Monroe Street, Gary, IN 46408

SO ORDERED THIS _____ day of October, 2009.

RECEIVED

OCT 23 2009

Thomas R. Philpot
CLERK LAKE CIRCUIT COURT

JUDGE, LAKE CIRCUIT COURT

Return to
INDIANA TITLE NETWORK COMPANY
325 NORTH MAIN
CROWN POINT, IN 46307

AMOUNT \$ 18⁰⁰
CASH _____ CHARGE _____
CHECK # 19601
OVERAGE _____
COPY _____
NON-COM _____
CLERK RB

CR # 19601

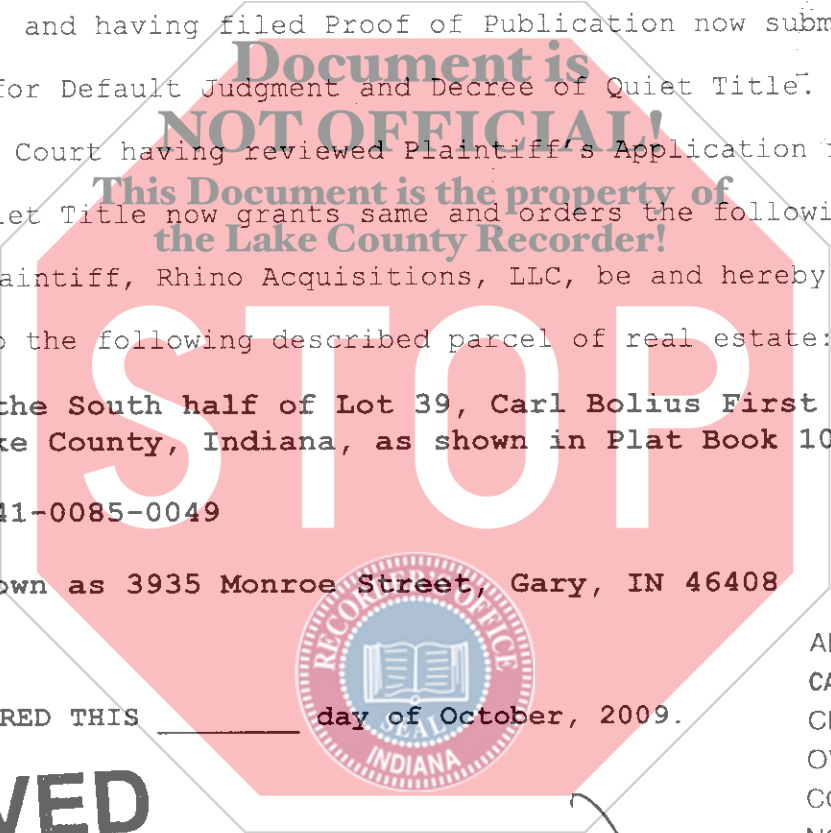

2011 SEP 29 AM 11:40

Cause No. 45C01-0805-PL-00127

So Found and Recommended this 19 day of October, 2009.

Richard McDermott

MAGISTRATE, LAKE CIRCUIT COURT

SO ORDERED this 23 day of Oct, 2009.

Document is

~~NOT OFFICIAL~~

This Document is the property of
the Lake County Recorder!

James ...
JUDGE, LAKE CIRCUIT COURT

STOP

I AFFIRM, UNDER THE PENALTIES FOR PERJURY, THAT I HAVE TAKEN REASONABLE CARE TO REDACT EACH SOCIAL SECURITY NUMBER IN THIS DOCUMENT, UNLESS REQUIRED BY LAW.

Jolene Kratochvil
Jolene Kratochvil

