

2

STATE OF INDIANA
LAKE COUNTY
FILED FOR RECORD

LF298-04

2011 045140

2011 AUG 19 PM 3:58

MICHELLE FAJMAN
RECORDER

QUITCLAIM DEED

THIS QUITCLAIM DEED, executed this 19 day of August, 2011 (year),

by first party, Grantor, RONADE. Kingery
 whose post office address is 148 W. Timber Point Ct.
VALPARAISO, IN. 46385
 to second party, Grantee, SYLVA KINGERY
 whose post office address is 148 W. Timber Point Ct.
VALPARAISO, IN. 46385

DULY ENTERED FOR TAXATION SUBJECT TO
 FINAL ACCEPTANCE FOR TRANSFER
 AUG 19 2011
 PEGGY HOLINGA KATONA
 LAKE COUNTY AUDITOR

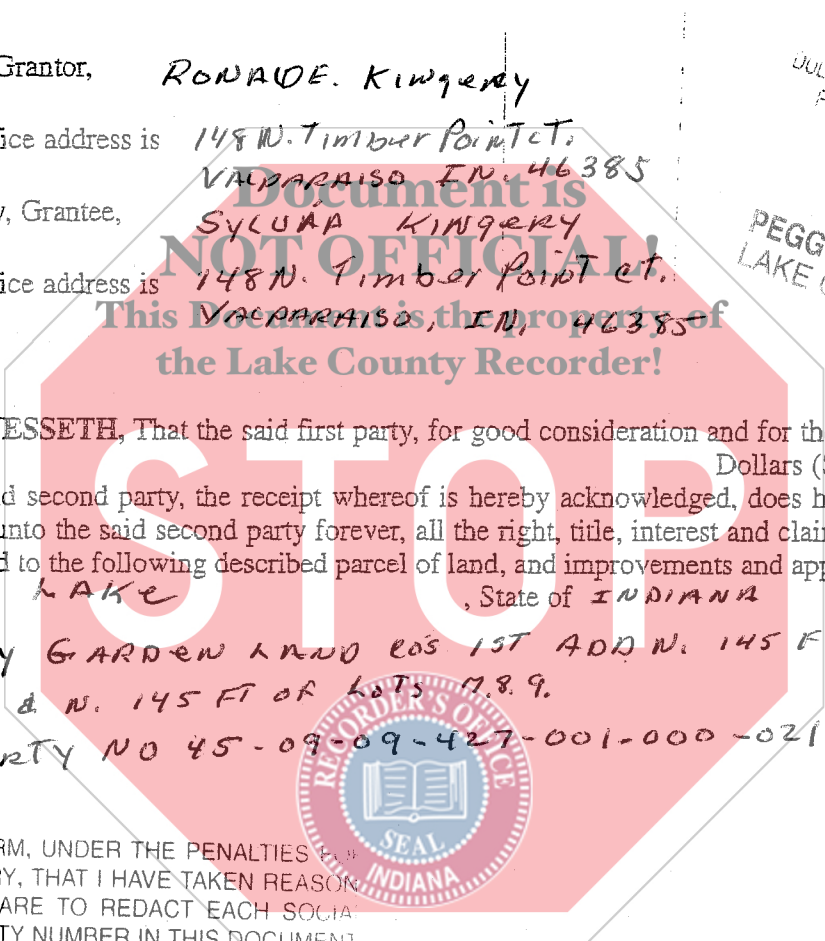

WITNESSETH, That the said first party, for good consideration and for the sum of _____ Dollars (\$ _____) paid by the said second party, the receipt whereof is hereby acknowledged, does hereby remise, release and quitclaim unto the said second party forever, all the right, title, interest and claim which the said first party has in and to the following described parcel of land, and improvements and appurtenances thereto in the County of LAKE, State of INDIANA to wit:

E. GARY GARDEN AND LOS 1ST ADD N. 145 FT 4.6 EXE
34.1 FT & N. 145 FT OR LOTS 17, 8, 9.
PROPERTY NO 45-09-09-427-001-000-021

"I AFFIRM, UNDER THE PENALTIES OF PERJURY, THAT I HAVE TAKEN REASONABLE CARE TO REDACT EACH SOCIAL SECURITY NUMBER IN THIS DOCUMENT UNLESS REQUIRED BY LAW."

PREPARED BY: Sylvia Kingery

028457

18.00
CS
YN

IN WITNESS WHEREOF, The said first party has signed and sealed these presents the day and year first above written. Signed, sealed and delivered in presence of:

Signature of Witness

Ronald E Kingery
Signature of First Party

Print name of Witness

RONALD E KINGERY
Print name of First Party

Signature of Witness

Sylvia Kingery
Signature of First Party

Print name of Witness

Sylvia Kingery
Print name of First Party

State of Indiana

County of Porter

On Aug 19, 2011
appeared

before me,

Ronald E and Sylvia Kingery
personally known to me (or proved to me on the basis of satisfactory evidence) to be the person(s) whose name(s) is/are subscribed to the within instrument and acknowledged to me that he/she/they executed the same in his/her/their authorized capacity(ies), and that by his/her/their signature(s) on the instrument the person(s), or the entity upon behalf of which the person(s) acted, executed the instrument. WITNESS my hand and official seal.

Sundae H. Kubacki
Signature of Notary

Document is NOT OFFICIAL!
This Document is the property of the Lake County Recorder's Office

Affiant Known Produced ID Drivers License
Type of ID Drivers License (Seal)

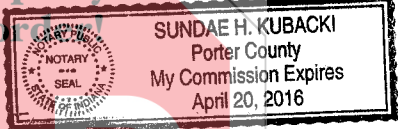

State of Indiana

County of Porter

On Aug 19, 2011
appeared

before me,

Ronald E and Sylvia Kingery
personally known to me (or proved to me on the basis of satisfactory evidence) to be the person(s) whose name(s) is/are subscribed to the within instrument and acknowledged to me that he/she/they executed the same in his/her/their authorized capacity(ies), and that by his/her/their signature(s) on the instrument the person(s), or the entity upon behalf of which the person(s) acted, executed the instrument. WITNESS my hand and official seal.

Sundae H. Kubacki
Signature of Notary

Document is NOT OFFICIAL!
This Document is the property of the Lake County Recorder's Office

Affiant Known Produced ID Drivers License
Type of ID Drivers License (Seal)

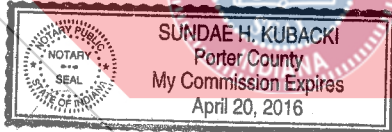

Signature of Preparer

Print Name of Preparer

Address of Preparer

↓
TAXES:

P.O. Box 342
Hobart IN
46342