

2

2011 044562

2011 AUG 18 PM 2:18

RECORDER

SHERIFF'S DEED

THIS INDENTURE WITNESSETH, that John Buncich, as Sheriff of Lake County, State of Indiana, conveys to Wells Fargo Bank, N.A., as Trustee for ABFC 2004-OPT5 Trust, ABFC Asset-Backed Certificates, Series 2004-OPT5, in consideration of the sum of \$63,000.00, the receipt of which is hereby acknowledged, on sale made by virtue of a decree judgment, issued from The Superior Court of Lake County, in the State of Indiana, pursuant to the laws of said State on March 11, 2011, in Cause Number 45D02-1004-MF-00278, wherein Wells Fargo Bank, N.A., as Trustee for ABFC 2004-OPT5 Trust, ABFC Asset-Backed Certificates, Series 2004-OPT5, was the Plaintiff and James L. Graham; Victoria A. Graham; Chase Bank of Texas, National Association; Account Management Services, Inc.; The Neurological Institute and Specialty Centers, P.C., dba Indy Orthopedics; and Chase Manhattan Bank were the Defendants, in consideration of said sum, aforesaid, the following described real estate in Lake County, Indiana, to-wit:

LOT 96, BLOCK 1, AND THE SOUTH ONE-HALF (1/2) OF LOT 95, BLOCK 1, STAFFORD & TRANKLES SOUTH CENTRAL CALUMET ADDITION TO HAMMOND, AS SHOWN IN PLAT BOOK 10, PAGE 30, IN LAKE COUNTY, INDIANA.

Commonly known as 4847 Columbia Ave., Hammond, Indiana 46327 (hereafter referred to as "Real Estate").

Parcel No.: 45-03-30-457-017.000-023

To have and to hold the premises aforesaid with the privileges and appurtenances to said purchaser, their grantees and assigns, forever, in full and ample manner with all rights, title and interest held or claimed by the aforesaid Defendants. This is an attempt to collect a debt and any information obtained will be used for that purpose.

IN WITNESS WHEREOF, I, THE UNDERSIGNED, Sheriff aforesaid have hereunto set my hand and seal this 5 day of Aug., 2011.

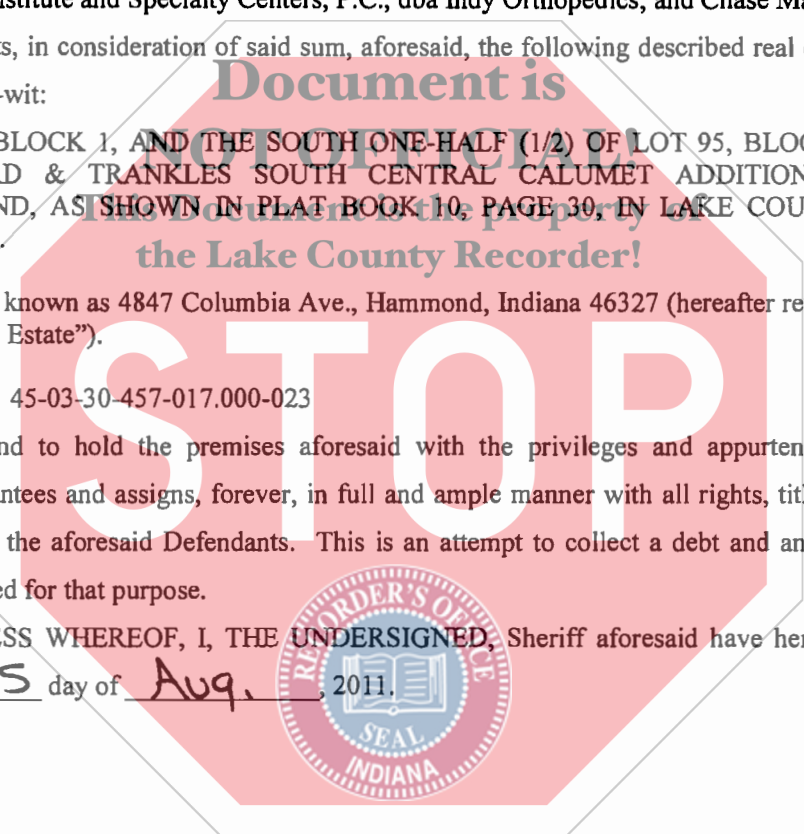

DULY ENTERED FOR TAXATION SUBJECT
FINAL ACCEPTANCE FOR TRANSFER

AUG 17 2011

054873

PEGGY HOLINGA KATONA
LAKE COUNTY AUDITOR

AMOUNT \$ 18⁰⁰
CASH _____ CHARGE _____
CHECK # 91916
OVERAGE _____
COPY _____
NON-COM _____
CLERK AB

E

